

LAYOUT 10/24/06 INSP 4 10/24/06  
 INSP 2 9/28/06 INSP 5 10/25/06  
 INSP 3 10/2/06 INSP 6 \_\_\_\_\_

ISSUE DATE: 9/14/06

APPROVAL DATE: 10/25/06

P 525557

A 515042-A

**PERMIT**  
**INDEXED**  
**TAX ID #05-441293**

**ON-SITE SEWAGE DISPOSAL SYSTEM**  
**HOWARD COUNTY HEALTH DEPARTMENT**  
**BUREAU OF ENVIRONMENTAL HEALTH**

Fogles Septic Clean, Inc IS PERMITTED TO INSTALL  ALTER

ADDRESS: 580 Obrecht Road PHONE NUMBER: 410-795-5670

SUBDIVISION: Homewood Crossing LOT NUMBER: 1

ADDRESS: 11401 Hunt Crossing Court  
~~4903 Valley View Overlook~~ PROPERTY OWNER: Toll MD III, LP

SEPTIC TANK CAPACITY (GALLONS): 1250 OUTLET BAFFLE FILTER REQUIRED

PUMP CHAMBER CAPACITY (GALLONS): n/a COMPARTMENTED TANK REQUIRED

NUMBER OF BEDROOMS: 4

SQUARE FEET PER BEDROOM: 180

LINEAR FEET OF TRENCH REQUIRED: 170 HOUSE SERVED BY PUBLIC WATER

TRENCHES:	Trench to be 3.0 feet wide. Inlet 3.0 feet below original grade. Bottom maximum depth 7.0 feet below original grade. Effective area begins at 5.5 feet below original grade. 4.0 feet of stone below distribution pipe.
LOCATION:	
NOTES:	Basement gravity service.

PLANS APPROVED: Sara Fegel Reviewed by: \_\_\_\_\_ DATE: 6/8/06

NOTES: PERMIT VOID AFTER 2 YEARS  
 CONTRACTOR IS RESPONSIBLE FOR SCHEDULING A PRE-CONSTRUCTION INSPECTION FOR ALL INSTALLATIONS  
 WATERTIGHT SEPTIC TANKS REQUIRED  
 ALL PARTS OF SEPTIC SYSTEM SHALL BE 100 FEET FROM ANY WATER WELL UNLESS SPECIFICALLY AUTHORIZED  
 MANHOLE RISERS REQUIRED ON ALL SEPTIC TANKS AND PUMP CHAMBERS UNLESS SPECIFICALLY AUTHORIZED  
 CONTRACTOR RESPONSIBLE FOR COMPLIANCE WITH APPLICABLE REGULATIONS, GUIDELINES AND THE TERMS OF THIS PERMIT

**NEITHER THE HOWARD COUNTY COUNCIL NOR THE HEALTH DEPARTMENT IS RESPONSIBLE FOR THE SUCCESSFUL OPERATION OF ANY SYSTEM PERMITTEE RESPONSIBLE FOR OBTAINING FINAL APPROVAL ON THIS PERMIT CALL 410-313-1771 FOR INSPECTION OF SEPTIC SYSTEM**

A315042-A

NOT TO SCALE

Hunt Crossing Ct.

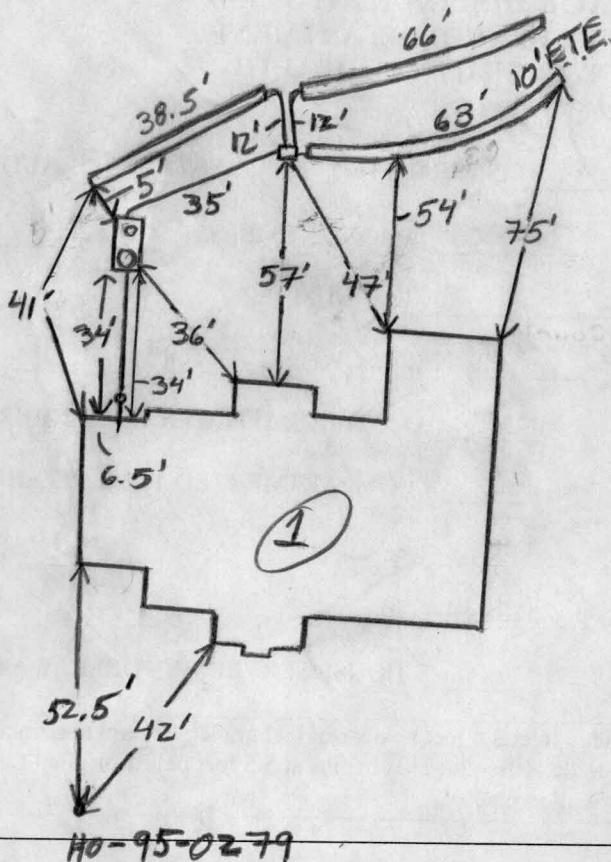

H0-95-0279

ROAD

TRENCH/DRAINFIELD DATA		
WIDTH	INLET	BOTTOM
3'	3'	7'
NUMBER OF TRENCHES		3
TOTAL LENGTH		167.5
ABSORPTION AREA		502.5 + SW
DISTRIBUTION BOX LEVEL		Yes
DISTRIBUTION BOX BAFFLE		Yes
DISTRIBUTION BOX PORT		Yes

SEPTIC TANK DATA	
SEPTIC TANK 1 LEVEL	Level
Capacity	1500 GAL
SEAM LOC	Top
TANK LID DEPTH	1.5-30'
BAFFLES	Yes
BAFFLE FILTER	NA
MANHOLE LOC	Front
6" PORT LOC	Rear
WATERTIGHT TEST	NA
<del>SEPTIC TANK 2 LEVEL</del>	
<del>CAPACITY</del>	<del>_____ GAL</del>
<del>SEAM LOC</del>	<del>_____</del>
<del>TANK LID DEPTH</del>	<del>_____</del>
<del>BAFFLES</del>	<del>_____</del>
<del>BAFFLE FILTER</del>	<del>_____</del>
<del>MANHOLE LOC</del>	<del>_____</del>
<del>6" PORT LOC</del>	<del>_____</del>
<del>WATERTIGHT TEST</del>	<del>_____</del>

PRE-CONSTRUCTION 9/28/06 Too much Fill @ top left

corners of SOA. Do not proceed w/ layout and installation

INSTALLATION until fill is removed (KW) 10/2/06 Contacted Toll

Brothers Project Manager, told him to remove fill and Re-Survey SOA.

Need new layout (KW) 10/24/06 Fill removed. To install

two 65' trenches on contour towards left lot line

and one 40' trench running towards right lot line. Tank

and plumbing into house connected. D box set, one

63' trench dug out no pipe. (KW) 10/25/06 All 3 trenches

installed per installation. Made contractor install 42" riser on

FINAL INSPECTOR [Signature] DATE OF APPROVAL 10/25/06

front of S.T. → Builder should not have no more than 40" of fill

on Tank. (156) System OK to cover (KW)

