

C1 3288

SEQUENCE NO. (OEP USE ONLY)

STATE OF MARYLAND WELL COMPLETION REPORT

THIS REPORT MUST BE SUBMITTED WITHIN 45 DAYS AFTER WELL IS COMPLETED.

(THIS NUMBER IS TO BE PUNCHED IN COLS. 3'S ON ALL CARDS)

Date Received (OEP use only)

DATE WELL COMPLETED 120982

Depth of Well 203

PERMIT NO. FROM "PERMIT TO DRILL WELL" 40-23-24172

OWNER Jacobs James

STREET OR RD 2621 Howard Lodge Road

SUBDIVISION Indian Hill TOWN Sykesville

WELL LOG SECTION LOT 35

STATE THE KIND OF FORMATIONS PENETRATED, THEIR COLOR, DEPTH, THICKNESS AND IF WATER BEARING

Table with columns: DESCRIPTION, FEET FROM, FEET TO, Check if water bearing. Rows include: Dirt, Soft Brown Clay, Soft Brown Mica & Sand, Hard Blue Mica, Soft Brown Sand, Hard Brown Sandstone, Hard Blue Sandstone, Brown Sandstone, Blue Sandstone, Brown, Blue, Blue.

WELL HAS BEEN GROUTED (Circle Appropriate Box) Y N

TYPE OF GROUTING MATERIAL CEMENT CM BENTONITE CLAY BC NO OF BAGS NO OF POUNDS GALLONS OF WATER DEPTH OF GROUT SEAL

CASING RECORD casing types insert appropriate code below STEEL CONCRETE PLASTIC OTHER

MAIN CASING TYPE Nominal diameter top of man casing Total depth of man casing

OTHER CASING (if used) diameter depth from to

SCREEN RECORD screen type or open hole insert appropriate code below STEEL BRASS BRONZE PLASTIC OTHER

DEPTH (nearest ft.) 51 203

SLOT SIZE DIAMETER OF SCREEN (NEAREST INCH)

GRAVEL PACK IF WELL DRILLED WAS FLOWING WELL CIRCLE BOX F

TELESCOPE CASING LOG INDICATOR OTHER DATA

PUMPING TEST C3 HOURS PUMPED 6

PUMPING RATE (gal. per min. to nearest gal.) METHOD USED TO MEASURE PUMPING RATE Flowmeter

WATER LEVEL (distance from land surface) BEFORE PUMPING 63

WHEEL PUMPING 101 TYPE OF PUMP USED (for test) A air P piston T turbine C centrifugal R rotary Q other (describe below) J jet S submersible

DRILLER WILL INSTALL PUMP (CIRCLE APPROPRIATE BOX) Y N

IF DRILLER INSTALLS PUMP, THIS SECTION MUST BE COMPLETED FOR ALL WELLS EXCEPT HOME USE

TYPE OF PUMP (WRITE APPROPRIATE LETTER IN BOX - SEE ABOVE: A, C, J, P, R, S, T, O) CAPACITY: GALLONS PER MINUTE PUMP HORSE POWER PUMP COLUMN LENGTH

CASING HEIGHT (circle appropriate box and enter casing height) LAND SURFACE

LOCATION OF WELL ON LOT SHOW PERMANENT STRUCTURE SUCH AS BUILDING, SEPTIC TANKS, AND/OR LANDMARKS AND INDICATE NOT LESS THAN TWO DISTANCES (MEASUREMENTS TO WELL)

- CIRCLE APPROPRIATE BOX A A WELL WAS ABANDONED AND SEALED WHEN THIS WELL WAS COMPLETED E ELECTRIC LOG OBTAINED P TEST WELL CONVERTED TO PRODUCTION WELL

I HEREBY CERTIFY THAT THIS WELL HAS BEEN CONSTRUCTED IN ACCORDANCE WITH COMAR 10.17.13. WELL CONSTRUCTION AND PERFORMANCE WITH ALL CONDITIONS STATED IN THE ABOVE CAPTIONED PERMIT AND THAT THE INFORMATION PRESENTED HEREIN IS ACCURATE AND COMPLETE TO THE BEST OF MY KNOWLEDGE.

DRILLERS IDENT NO.

DRILLERS SIGNATURE MUST MATCH SIGNATURE ON APPLICATION

SITE SUPERVISOR (sign of driller or journeyman responsible for stikework if different from permittee)

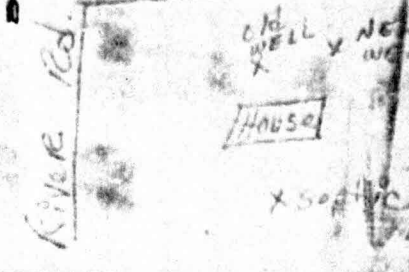

WR-W-4  
4-66

State Office Building  
ANNAPOLIS, MARYLAND 21401

STATE OF MARYLAND  
DEPARTMENT OF  
WATER RESOURCES 9 AM 11:13

THIS REPORT  
MUST BE SUBMITTED  
WITHIN 30 DAYS  
AFTER COMPLETION  
OF THE WELL

WELL COMPLETION REPORT A-12545 OF  
WATER RESOURCES

WELL DESCRIPTION

WELL LOG  
State the kind of formations penetrated, their color, their depth, their thickness, and if water-bearing

CASING AND SCREEN RECORD  
State the kind and size and position of casing, liner, shoe, screen, and other accessories (if no casing used, give diameter of well).

FORMATION	FEET from to	CASING	DIAM. (inches)	FEET from to
Shale	0-68	Casing	6 1/4	0-42
Sand Rock	68-75			
Shale	75-80			
Water in Shale				

Permit Number HO-67-40830  
Owner COUNTRY HOMES  
Address INDIA HILL  
Subdivision INDIA HILL  
Section 33 Lot 33

PUMPING TEST  
Hours Pumped 2  
Type of Pump Used Bailer  
Pumping Rate 14 GPM  
Gallons per Minute 14

WATER LEVEL  
Distance from land surface to water)  
Before Pumping 4' Ft.  
When Pumping 60' Ft.

APPEARANCE OF WATER  
Clear  Cloudy   
Taste N/O  
Odor N/O

Height of Casing Above Land Surface 6" Ft.

PUMP INSTALLED  
Type \_\_\_\_\_  
Capacity \_\_\_\_\_  
Gallons per Minute \_\_\_\_\_  
Gallons per Hour \_\_\_\_\_  
Pump Column Length \_\_\_\_\_ Ft.

LOCATION OF WELL ON LOT  
Show permanent structures such as building(s), septic tank, and/or other landmarks and indicate not less than 2 distances (measurements) to well.

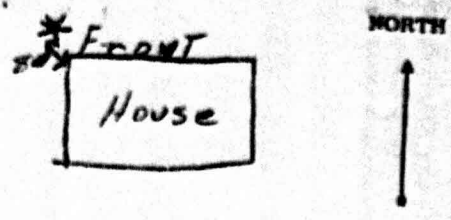

DATE WELL WAS COMPLETED

May 5

I hereby affirm that this report contains no willful misrepresentations or falsifications and that information given in this report is true, accurate and complete to the best of my knowledge and belief.

George S Hart, Well Driller

Well Driller License No.: 279



---

HOWARD COUNTY HEALTH DEPARTMENT

---

*Diane L. Matuszak, M.D., M.P.H., County Health Officer*

November 16, 2001

Susan McTague  
12621 Howard Lodge Drive  
Sykesville, MD 21784

RE: **Abandoned Well Issues**  
12621 Howard Lodge Road  
Well Permit #: HO-67-W230

Dear Ms. McTague:

During a septic system repair on your property on July 16, 2001, it was observed that an old and apparently unused well was located in front of your house. According to COMAR 26.04.04, the Health Department can require that any well that has been permanently disconnected from service be sealed.

This sealing process helps to restore the normal subsurface geologic conditions that existed before the well was drilled, and more importantly, serves to protect the groundwater resource from potential contamination.

The well sealing process can best be accomplished by a licensed well driller. They may perform the work without our supervision. The driller then completes an abandonment report that is sent to our office and the Maryland Department of the Environment.

**Not complying with an abandonment schedule could result in the issuance of an order to abandon and seal the replacement well in accordance with COMAR 26.04.04.**

If you have any questions, or would like to discuss this matter further, please call me directly at (410) 313-2643. Thank you for your attention to these important matters.

Respectfully,

*Brian Baker*

Brian Baker, R.S.  
Well and Septic Program

cc: File