

PERMIT

P 515274

SEWAGE DISPOSAL SYSTEM

A REPAIR

HOWARD COUNTY HEALTH DEPARTMENT

BUREAU OF ENVIRONMENTAL HEALTH

410-313-2640

ISSUE DATE 6/1/2001

APPROVAL DATE 7/16/01

11/10/01
LATE
C.O.
03-288102

Dry well is near Full

INDEXED

Jack Fyock Septic Service

IS PERMITTED TO INSTALL ALTER

ADDRESS P.O. Box 89, Glenelg, MD 21737

PHONE 410-988-9270

SUBDIVISION Indian Hill

LOT NUMBER 35

ADDRESS 12621 Howard Lodge Road

PROPERTY OWNER Susan McTague

PROPERTY OWNER'S ADDRESS Same

SEPTIC TANK CAPACITY 950 ^{existing} GALLONS

410-442-4071 (Home)

301-688-8150 (Work)

PUMP CHAMBER CAPACITY 14 GALLONS

NUMBER OF BEDROOMS 3 ^{existing upgrade to 4 bdr}

SQUARE FEET PER BEDROOM 180

LINEAR FEET OF TRENCH REQUIRED 18' x 40' = 720' Bed (at owner/contractor's request to minimize tree damage)

TRENCHES: ^{Bed} Trenches to be 18 feet wide. Inlet ^{x 40' Long} 6 feet below original grade. Bottom maximum depth 8 feet below original grade. 2 feet of stone below distribution box.

LOCATION:

REPAIR - PURPOSE - Existing septic system has failed. Call for inspection when ground is opened so sanitarian can recommend repair. 5/31/01

Soil this sandy loam below 5 1/2 ft to 14 ft + Bed Repair System used to minimize impact to nearby trees and avoid rear of lot which is reported to have surface water runoff. (Soil indicate deep trench system also a viable option.)

PLANS APPROVED PP/Inley DATE 7/11/01

PERMIT VOID AFTER 2 YEARS

NOTE: CONTRACTOR RESPONSIBLE FOR SCHEDULING A PRE-CONSTRUCTION INSPECTION FOR ALL INSTALLATIONS

NOTE: TOP OF SEPTIC TANKS ARE TO BE NO DEEPER THAN 3.0 FEET BELOW FINISH GRADE

NOTE: WATERTIGHT SEPTIC TANKS REQUIRED

NOTE: CLEANOUT REQUIRED EVERY 70 FEET OF SEWER LINE AND/OR AT 90° SWEEPS IN LINES FROM HOUSE TO DRAIN FIELDS, 90° ELBOWS ARE NOT ACCEPTABLE

NOTE: ALL PARTS OF SEPTIC SYSTEMS (I.E. TANK, DISTRIBUTION BOX, DRAINFIELDS) TO BE 100 FEET FROM ANY WATER WELL UNLESS OTHERWISE SPECIFICALLY AUTHORIZED

BUILDING PERMIT SIGNED

NOTE: NO ABSORPTION TRENCH TO EXCEED 100 FEET IN LENGTH UNLESS SPECIFICALLY AUTHORIZED

AND RETURNED

NOTE: ALL PIPE FROM HOUSE TO SEPTIC TANK MUST BE CAST IRON OR SCHEDULE 35/40 PVC OR ABS 10/24/05-600156742-DECK

NOTE: MANHOLE RISERS REQUIRED ON ALL SEPTIC TANKS AND PUMP CHAMBERS

NOTE: DISTRIBUTION BOXES MUST HAVE BAFFLES

NOTE: IF PUMPED SEPTIC SYSTEM REQUIRED, (1) SEPTIC PUMP DETAIL TO BE PROVIDED BY INSTALLER PRIOR TO ISSUANCE OF SEPTIC PERMIT (2) PUMP PERFORMANCE TEST IS NECESSARY PRIOR TO HEALTH DEPARTMENT APPROVAL OF SEPTIC PERMIT

NEITHER THE HOWARD COUNTY COUNCIL NOR THE HEALTH DEPARTMENT IS RESPONSIBLE FOR THE SUCCESSFUL OPERATION OF ANY SYSTEM

PERMITTEE RESPONSIBLE FOR OBTAINING FINAL APPROVAL ON THIS PERMIT

CALL 410-313-2640 FOR INSPECTION OF SEPTIC SYSTEM

- 6' Grey Brn CL
- 18' Red Brn h L
- 5 1/2' h L - CL - SCL
- 8-9' Red Brn SL-L
- 14' Red Brn Puro SL

NOT TO SCALE

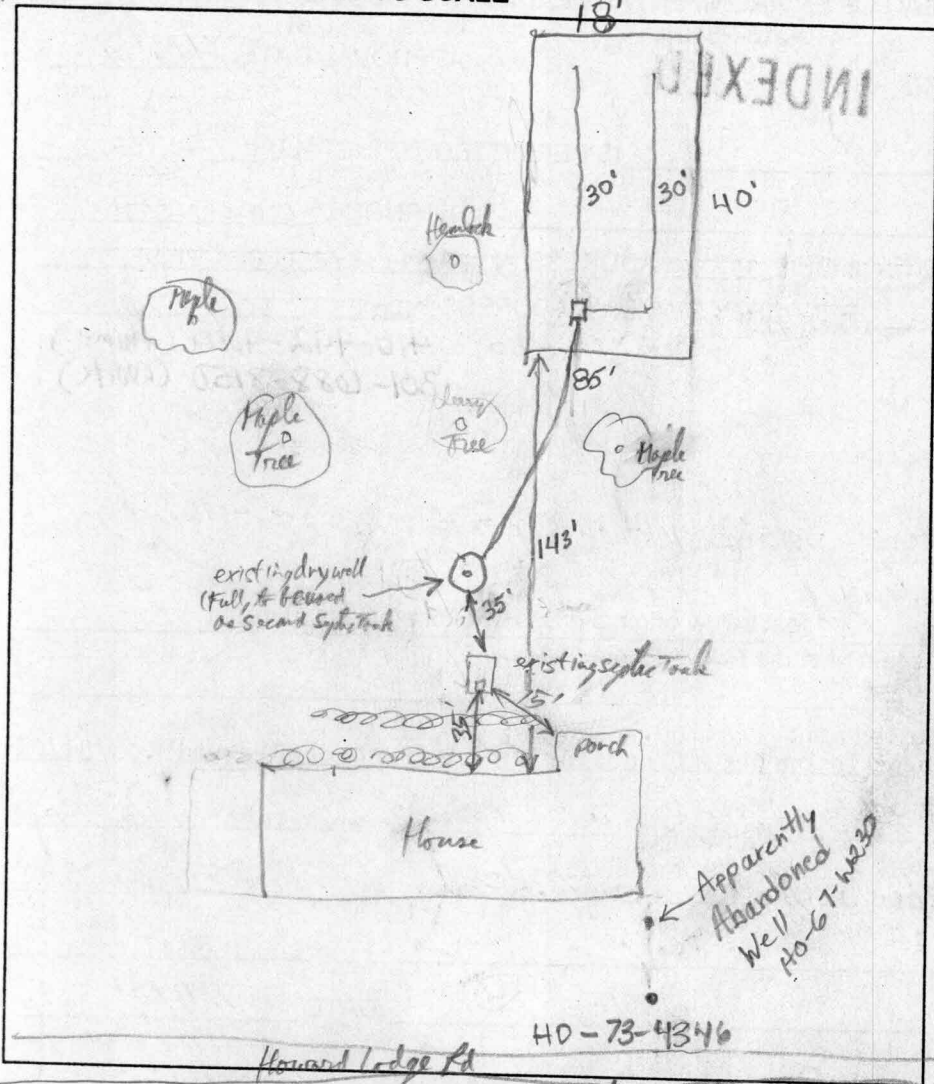

TRENCH DATA

TRENCH WIDTH 18' x 40'
 TRENCH INLET DEPTH 6'
 TRENCH BOTTOM DEPTH 8'
 DEPTH OF STONE 2'
 NUMBER OF TRENCHES 1
 TOTAL TRENCH LENGTH 18' x 40'
 ABSORBENT AREA 720 sq ft
 DISTRIBUTION BOX LEVEL Yes
 BAFFLE IN DISTRIBUTION BOX No - Not Required

SEPTIC TANK DATA

SEPTIC TANK Existing 750 GALLONS
 MANHOLE RISER No
 6 INCH INSPECTION PORT Yes

PUMP CHAMBER DATA N/A

~~PUMP CHAMBER GALLONS _____
 MANHOLE RISER _____
 ALARM _____
 PUMP PERFORMANCE TEST _____~~

PRE-CONSTRUCTION INSPECTION: Existing dry well to be used in lieu of septic tank, will have 1/2" baffle in it running to a dist box + 2 feet of main line in 18' x 40' Box 11/19/01

INSPECTION COMMENTS: 7/16/01 Leach bed finished. Distribution box hooked up to drywell. Tryock is going to replace line from tank to drywell after tank is pumped out. O.K. to cover (BB)

INSPECTOR B. Baker

DATE SYSTEM APPROVED 7/16/01