

LAYOUT _____
INSP 1 10/11/2011 INSP 3 _____
INSP 2 _____ INSP 5 _____

ISSUE DATE: 10/11
APPROVAL DATE: _____

PERMIT

SHARED SEPTIC SYSTEM

P 535989
A _____

1/24/2012

Tax ID # 05-449286
HOUSE SEWER LINE CONNECTION

**HOWARD COUNTY HEALTH DEPARTMENT
BUREAU OF ENVIRONMENTAL HEALTH**

South Carroll Beckhoe Trac. IS PERMITTED TO INSTALL ALTER

ADDRESS: 4410 Salem Bottom Rd Westmore PHONE NUMBER: 410-596-3618
MD 21157

SUBDIVISION Walnut Grove LOT NUMBER: 64

ADDRESS: 5111 Holly Creek Lane PROPERTY OWNER: Walnut Grove Holdings LLC

NUMBER OF BEDROOMS: 5

HOUSE SERVED BY PUBLIC WATER? NO

LOCATION:	Install 4" house sewer line connection per the approved site plan.
NOTES:	This permit is limited to the installation of the individual house sewer line connection and installation of the grinder pump, if applicable. The Howard County Bureau of Utilities must be contacted for scheduling of inspection of these items as well, at 410-313-4900.

PLANS APPROVED: Heidi Scott DATE: 4/4/11

PERMIT VOID AFTER 2 YEARS

1. CONTRACTOR IS RESPONSIBLE FOR SCHEDULING A PRE-CONSTRUCTION INSPECTION FOR ALL INSTALLATIONS.
2. ALL PARTS OF SEPTIC SYSTEM SHALL BE 100 FEET FROM ANY WATER WELL UNLESS SPECIFICALLY AUTHORIZED.
3. MANHOLE RISERS REQUIRED ON ALL SEPTIC TANKS AND PUMP CHAMBERS UNLESS SPECIFICALLY AUTHORIZED.
4. CONTRACTOR RESPONSIBLE FOR COMPLIANCE WITH APPLICABLE REGULATIONS, GUIDELINES AND THE TERMS OF THIS PERMIT.
5. NEITHER THE HOWARD COUNTY COUNCIL NOR THE HEALTH DEPARTMENT IS RESPONSIBLE FOR THE SUCCESSFUL OPERATION OF ANY SYSTEM.
6. PERMITTEE RESPONSIBLE FOR OBTAINING FINAL APPROVAL ON THIS PERMIT.

CALL 410-313-1771 FOR INSPECTION HOUSE CONNECTION

140-95-0415

NOT TO SCALE

53'

97'

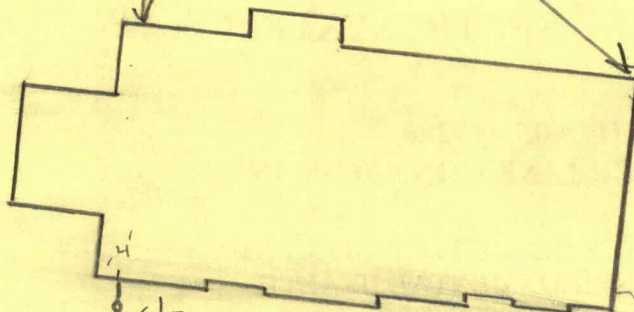

clo

81'

clo

clo

ROAD NAME

TRENCH/DRAINFIELD DATA

WIDTH	INLET	BOTTOM
_____	_____	_____

NUMBER OF TRENCHES _____

TOTAL LENGTH _____

ABSORPTION AREA _____

DISTRIBUTION BOX LEVEL _____

DISTRIBUTION BOX BAFFLE _____

DISTRIBUTION BOX PORT _____

SEPTIC TANK DATA

SEPTIC TANK 1 LEVEL _____

MANUFACTURER _____

CAPACITY _____ GAL

SEAM LOC _____

TANK LID DEPTH _____

BAFFLES _____

BAFFLE FILTER _____

MANHOLE LOC _____

6" PORT LOC _____

WATERTIGHT TEST _____

SLOTTED _____

DATE ON LID _____

PUMP/SEPTIC TANK LEVEL _____

MANUFACTURER _____

CAPACITY _____ GAL

SEAM LOC _____

TANK LID DEPTH _____

BAFFLES _____

BAFFLE FILTER _____

MANHOLE LOC _____

6" PORT LOC _____

WATERTIGHT TEST _____

SLOTTED _____

DATE ON LID _____

PRE-CONSTRUCTION:

INSTALLATION:

10/11/11 gravity 4" s/c installed @ 2% 6'x 6'

backfill. Need p/a approval from utilities (P)

1/24/2012 Grinder pump start-up approved by utilities (BB)

FINAL INSPECTOR

B. Baker

DATE OF APPROVAL

1/24/2012

Martin, Sharhonda

From: Tudor, Matt
Sent: Tuesday, January 24, 2012 3:31 PM
To: Scott, Heidi; Harris, Leslie
Cc: Pickett, Tom; Hart, Amy; Alcorn, John; Rocco, Anthony; Baker, Brian; Wolf, Kevin; Martin, Sharhonda; Williams, Jeffrey; Tudor, Matt; Joe Clair
Subject: U&O Release 5111 Holly Creek Lane

This afternoon, I observed the start-up of a Sewage Grinder Pump at the Walnut Grove Shared Septic System:

Walnut Grove, Contract 50-4330-D
Goodier Homes, Lot #64
5111 Holly Creek Lane
Clarksville, MD 21029

The Sewage Grinder Pump test was successful ; the Bureau of Utilities releases its hold on this property for U&O.

This is the 46th lot on the shared septic system at this location.

Matt
410-313-4934 office
410-978-1320 mobile