

PERMIT

SEWAGE DISPOSAL SYSTEM
HOWARD COUNTY HEALTH DEPARTMENT
BUREAU OF ENVIRONMENTAL HEALTH
410-313-2640

P 515225

A 57679-K

ISSUE DATE 5/2/2001

APPROVAL DATE 5/7/01

04-364236

INDEXED

Union Paving Company, Inc

IS PERMITTED TO INSTALL ALTER

ADDRESS 5977 Sandy Ridge Road, Elkridge, MD 21075 PHONE 410-379-6463

SUBDIVISION Rosebar Property LOT NUMBER 22 ADDRESS 3010 Hobbs Road

PROPERTY OWNER Patuxent Builders Inc. PROPERTY OWNER'S ADDRESS 3330 Sang Road

SEPTIC TANK CAPACITY 1250 GALLONS * TOP SEAMED SEPTIC TANK REQUIRED *

PUMP CHAMBER CAPACITY N/A GALLONS

NUMBER OF BEDROOMS 4

SQUARE FEET PER BEDROOM 180

LINEAR FEET OF TRENCH REQUIRED 240

TRENCHES: Trenches to be 3 feet wide. Inlet 3 feet below original grade. Bottom maximum depth 5 feet below original grade. 2 feet of stone below distribution ~~box~~ pipe.

LOCATION: Begin trenches 155 feet down the right lot line and 25 feet off that same lot line as seen when facing the lot from Hobbs Road. Run trenches on contour toward the left property line. OK/MP

PLANS APPROVED Amy McMillen, R.S. DATE 1/17/2001

PERMIT VOID AFTER 2 YEARS

NOTE: CONTRACTOR RESPONSIBLE FOR SCHEDULING A PRE-CONSTRUCTION INSPECTION FOR ALL INSTALLATIONS

NOTE: TOP OF SEPTIC TANKS ARE TO BE NO DEEPER THAN 3.0 FEET BELOW FINISH GRADE

NOTE: WATERTIGHT SEPTIC TANKS REQUIRED

NOTE: CLEANOUT REQUIRED EVERY 70 FEET OF SEWER LINE AND/OR AT 90° SWEEPS IN LINES FROM HOUSE TO DRAIN FIELDS, 90° ELBOWS ARE NOT ACCEPTABLE

NOTE: ALL PARTS OF SEPTIC SYSTEMS (I.E. TANK, DISTRIBUTION BOX, DRAINFIELDS) TO BE 100 FEET FROM ANY WATER WELL UNLESS OTHERWISE SPECIFICALLY AUTHORIZED

NOTE: NO ABSORPTION TRENCH TO EXCEED 100 FEET IN LENGTH UNLESS SPECIFICALLY AUTHORIZED

NOTE: ALL PIPE FROM HOUSE TO SEPTIC TANK MUST BE CAST IRON OR SCHEDULE 35/40 PVC OR ABS

NOTE: MANHOLE RISERS REQUIRED ON ALL SEPTIC TANKS AND PUMP CHAMBERS

NOTE: DISTRIBUTION BOXES MUST HAVE BAFFLES

NOTE: IF PUMPED SEPTIC SYSTEM REQUIRED, (1) SEPTIC PUMP DETAIL TO BE PROVIDED BY INSTALLER PRIOR TO ISSUANCE OF SEPTIC PERMIT (2) PUMP PERFORMANCE TEST IS NECESSARY PRIOR TO HEALTH DEPARTMENT APPROVAL OF SEPTIC PERMIT

NEITHER THE HOWARD COUNTY COUNCIL NOR THE HEALTH DEPARTMENT IS RESPONSIBLE FOR THE SUCCESSFUL OPERATION OF ANY SYSTEM
PERMITTEE RESPONSIBLE FOR OBTAINING FINAL APPROVAL ON THIS PERMIT
CALL 410-313-2640 FOR INSPECTION OF SEPTIC SYSTEM

BUILDING PERMIT SIGNED AND RETURNED

4/10/2003 B00141191 DECK

P 515225

5/2/01
5/4/01
all day
5/7/01
All Day

NOT TO SCALE

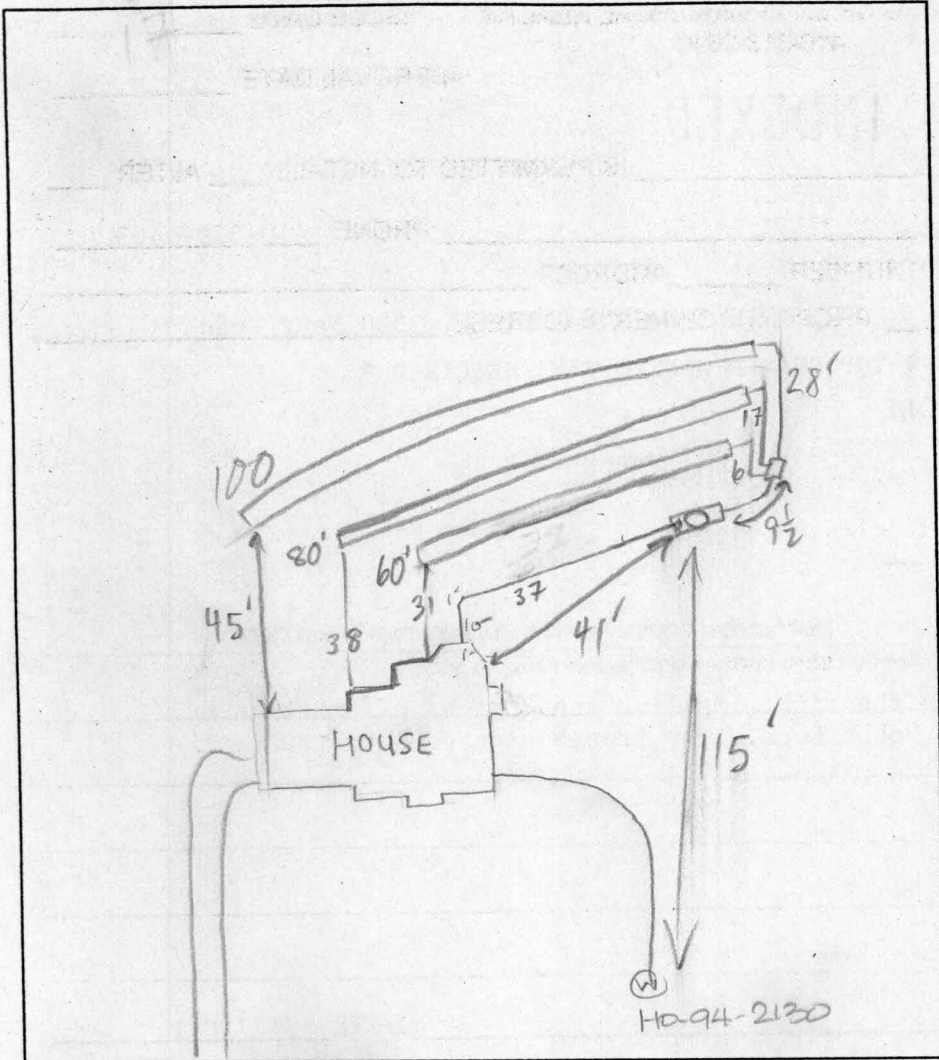

TRENCH DATA

TRENCH WIDTH 3
 TRENCH INLET DEPTH 3
 TRENCH BOTTOM DEPTH 5
 DEPTH OF STONE 2
 NUMBER OF TRENCHES 3
 TOTAL TRENCH LENGTH 240
 ABSORBENT AREA 720
 DISTRIBUTION BOX LEVEL
 BAFFLE IN DISTRIBUTION BOX

SEPTIC TANK DATA

SEPTIC TANK 1250 TS GALLONS
 MANHOLE RISER
 6 INCH INSPECTION PORT

PUMP CHAMBER DATA

~~PUMP CHAMBER GALLONS _____
 MANHOLE RISER _____
 ALARM _____
 PUMP PERFORMANCE TEST _____~~

HOBBS RD

PRE-CONSTRUCTION INSPECTION: 5/3/01 layout confirmed - SDA started -

OK to install septic system as specified. OK

INSPECTION COMMENTS: 5/7/01 11:30 OK CONTINUE (MR)

5/7/01 2:30 OK TO COVER (MR)

INSPECTOR M. Ripkin DATE SYSTEM APPROVED 5/7/01