

3/17/94
house connection
3:00

PERMIT ✓

SEWAGE DISPOSAL SYSTEM

DEPARTMENT OF HEALTH AND MENTAL HYGIENE

P 49816

A 39049

DISTRICT 3rd

DATE 4/6/94

HOWARD COUNTY HEALTH DEPARTMENT

BUREAU OF ENVIRONMENTAL HEALTH

~~XXXXXXXX~~ 313-2640

INDEXED

DATE SYSTEM APPROVED 3/17/94

INSPECTOR (CW)

Paul Schissler/South Carroll Backhoe IS PERMITTED TO INSTALL X ALTER

ADDRESS 4410 Salem Bottom Road, Westminster, Maryland 21157 PHONE 875-4197

SUBDIVISION Amberwoods LOT 16 ROAD 12828 Forest View Court

PROPERTY OWNER Grayson Homes, Inc.

ADDRESS _____

SEPTIC TANK CAPACITY 1500 GALLONS TOP SEAMED TANK

NUMBER OF BEDROOMS 4

210 SQUARE FEET PER BEDROOM

210
840

LINEAR FEET OF TRENCH REQUIRED 280

TRENCHES - Trench to be 3 feet wide. Inlet 2½ feet below original grade. Bottom maximum depth 4½ feet below original grade. Effective area begins at 2½ feet below original grade. 2 feet of stone below distribution pipe.

LOCATION - Place distribution box 120 feet down the right (156') lot line and 90 feet off that lot line. Run trenches along contour in both directions being certain to maintain 100 feet separation from any well.

NOTES - No trench to exceed 100 feet in length. Provide 6" - 8" diameter cleanout and cap to grade or above on septic tank.

PLANS APPROVED BY C. Williams ox/cw DATE 7/16/89

COVER NO WORK UNTIL INSPECTED AND APPROVED

NEITHER THE HOWARD COUNTY COUNCIL NOR THE HEALTH DEPARTMENT IS RESPONSIBLE FOR THE SUCCESSFUL OPERATION OF ANY SYSTEM

NOTE: CLEANOUT REQUIRED EVERY 70 FEET OF SEWER LINE AND/OR AT 90° SWEEPS IN LINES FROM HOUSE TO DRAIN FIELDS, 90° ELBOWS NOT ACCEPTABLE.

NOTE: ALL PARTS OF SEPTIC SYSTEMS (I.E. TANK, DISTRIBUTION BOX TRENCHES) TO BE 100 FEET FROM WELL (UNLESS OTHERWISE SPECIFICALLY AUTHORIZED)

NOTE: IF DEEP TRENCH(ES) ARE USED CALL FOR INSPECTION BEFORE AND AFTER PLACING GRAVEL IN TRENCH(ES)

NOTE: NO DRY WELL SHALL EXCEED 15 FOOT IN DIAMETER NO ABSORPTION TRENCH TO EXCEED 100 FEET IN LENGTH

NOTE: ALL PIPE FROM HOUSE TO SEPTIC TANK MUST BE CAST IRON OR SCHEDULE 35/40 PVC OR ABS

PERMIT VOID AFTER TWO YEARS

NOTE: INSTALL STAND PIPE ON SEPTIC TANK AND DRY WELL STAND PIPES MUST BE 6 INCHES IN DIAMETER CAST IRON. CONCRETE OR TERRA COTTA OR PVA OR ABS ACCEPTED. IF TOP OF SEPTIC TANK IS DEEPER THAN 3 FEET. MANHOLE TO GRADE REQUIRED.

NOTE: DISTRIBUTION BOXES MUST HAVE BAFFLES

***INSTALLER IS RESPONSIBLE FOR OBTAINING FINAL APPROVAL ON THIS PERMIT**

A
39049

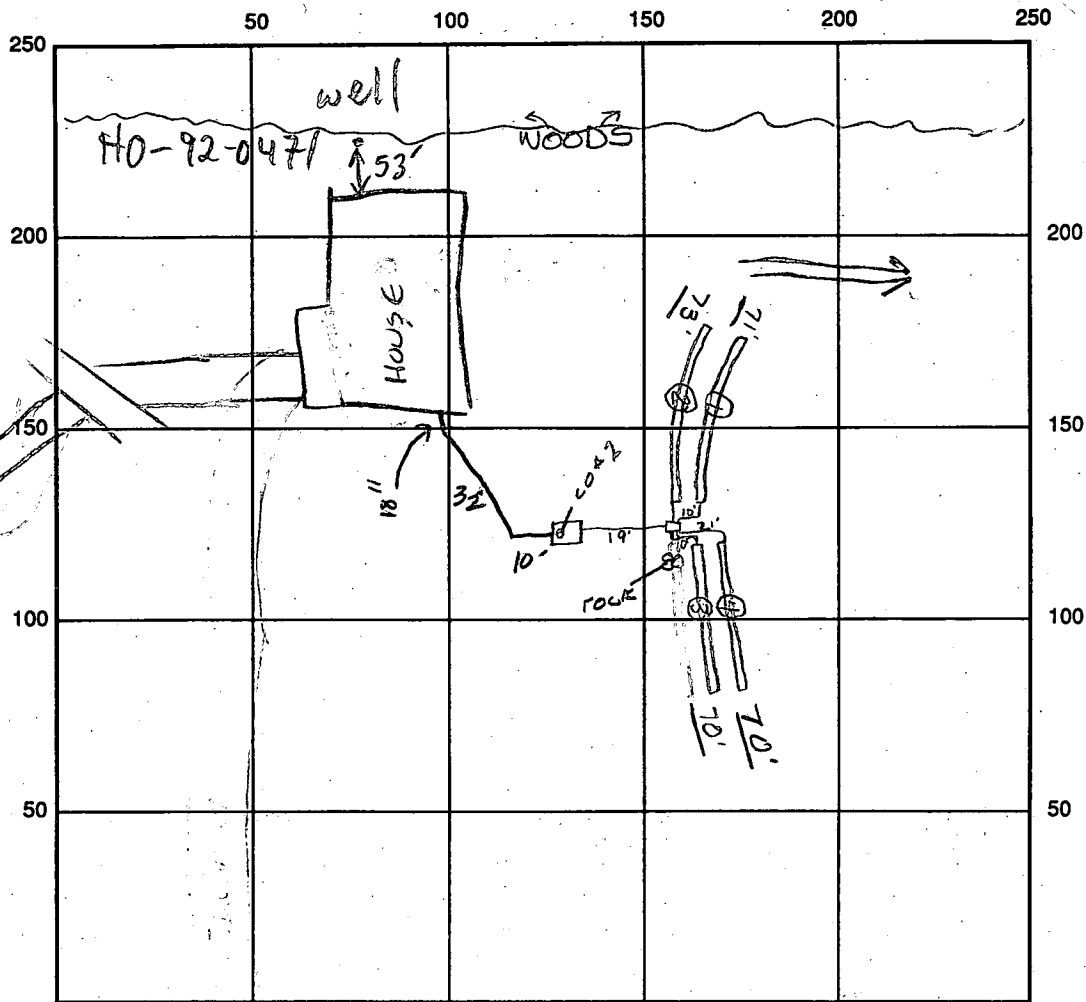

INDICATE NORTH - NAME ADJOINING ROADWAY AS BASE LINE

SEPTIC TANK LEVEL 1500 gal OK CLEANOUTS OK = 1
 DISTRIBUTION BOX LEVEL OK baffle is in
 DRAIN FIELD/TITLE DEPTH 4 - 34 1/2' FT. TRENCH WIDTH 3' FT. INLET DEPTH 2 - 2 1/2' FT.
 EFFECTIVE GRAVEL DEPTH 2' FT. TOTAL LENGTH 284 FT. ① 71' ③ 70'
 ② 73' ④ 70'
 NUMBER OF TRENCHES 4 ONE SIDEWALL/BOTTOM AREA SQ. FT.
 DRYWALL INSIDE DIAMETER FT. EFFECTIVE DEPTH BELOW INLET FT.
 ABSORBENT AREA 852 SQ. FT.

REMARKS: 1/11/93 OK to cover trenches 1, 2 & 3. Put baffle, CO trench 4 in. All work complete and OK to cover except no house connection from
3/17/94 HOUSE CONNECTION COMPLETE (CW)

1/11/94 No WPT. Allow
 DATE SYSTEM APPROVED 3/17/94 INSPECTOR Cwelltra

DORIS FOLLMER
677/200

FRANCIS H.
BAER PROPERTY
PLAT 4263

LOT 16
3.1615 AC.

LOT 17
3.4116 AC.
BASEMENT ELEVATION AS SHOWN
NOT SEWERABLE BY GRAVITY.

LOT 15
(OPEN SPA...)

DARRELL HOLSTON
830/300

Approved Site System Plan
Howard County Health Department
Signature: *Stephen Buckner*
Date: 2/27/93

STEPHEN BUCKNER
1212/482

GERALD W. HEARSAY
490/625

HENRY F. HERZING, JR.
836/325

DEVELOPER'S/BUILDER'S CERTIFICATE
I WE CERTIFY THAT ALL DEVELOPMENT AND CONSTRUCTION WILL BE DONE ACCORDING TO THESE PLANS, AND THAT ALL RESPONSIBLE PERSONS INVOLVED IN THE CONSTRUCTION PROJECT WILL HAVE A CERTIFICATE OF ATTENDANCE AT A DEPT. OF NATURAL RESOURCES APPROVED TRAINING PROGRAM FOR THE CONTROL OF SEDIMENT AND EROSION CONTROL BEFORE BEGINNING THE PROJECT. I ALSO AUTHORIZE PERIODIC ON-SITE INSPECTION BY THE HOWARD SOIL CONSERVATION DISTRICT OR THEIR AUTHORIZED AGENTS AS DEEMED NECESSARY.

ENGINEER'S CERTIFICATE
I CERTIFY THAT THIS PLAN FOR EROSION AND SEDIMENT CONTROL REPRESENTS A PRACTICAL AND WORKABLE PLAN BASED ON MY PERSONAL KNOWLEDGE OF THE SITE CONDITIONS. THIS WAS PREPARED IN ACCORDANCE WITH THE REQUIREMENTS OF THE HOWARD SOIL CONSERVATION DISTRICT.



LANDSCAPE ARCHITECT Ernest C. Peak, ASLA
DATE 11/16/89

REVIEWED FOR HOWARD S.C.D. AND MEETS TECHNICAL REQUIREMENTS

U.S. SOIL CONSERVATION SERVICE DATE

THIS DEVELOPMENT PLAN IS APPROVED FOR SOIL EROSION AND SEDIMENT CONTROL BY THE HOWARD SOIL CONSERVATION DISTRICT

HOWARD S.C.D. DATE

#	N/A	#	N/A	#	16	#	17	LOT NUMBER
		529.28		524.40				BASEMENT ELEVATION (if applicable)
		542.00		532.85				FIRST FLOOR ELEVATION
		537.00		529.00				INVERT OUT OF HOUSE
		534.40		528.70				INVERT INTO SEPTIC TANK
		526.20		528.45				INVERT OUT OF SEPTIC TANK
		532.2		528.15				INVERT INTO DISTRIBUTION BOX (if applicable)
		532.0		528.0				INVERT INTO TRENCH(S)
		538.7		529.5				EXISTING GRADE AT SEPTIC TANK
		534.5		531.0				EXISTING GRADE AT DISTRIBUTION BOX (if applicable)
		534.5		531.8				EXISTING GRADE AT TRENCH(S)
		538.5		538.1				ELEVATION OF WELL AT GRADE

LEGEND

- B.R.L. BUILDING RESTRICTION LINE
- BOUNDARY LINE
- 500 EXISTING CONTOUR
- 500 PROPOSED CONTOUR
- EXISTING TREES
- S.C.E. STABILIZED CONSTRUCTION
- ENTRANCE
- SILT FENCE

MINIMUM DISTANCES REQUIRED

- HOUSE TO WELL: 30'
- HOUSE TO SEWAGE EASEMENT: 20'
- HOUSE TO SEPTIC TANK: 10'
- WELL TO SEPTIC TANK OR SEWAGE EASEMENT: 100'
(OR AS APPROVED BY HEALTH DEPARTMENT)
- WELL TO LOT LINES: 10'
- WELL TO ROADS: 15'
- SEWAGE EASEMENT TO LOT LINES: 10'

NOTES:

- MAXIMUM SLOPE OF SEWER PIPES: 1/4"/1'
- MINIMUM SLOPE OF SEWER PIPES: 1/8"/1'
- NO CONSTRUCTION TO IMPACT SEWAGE EASEMENT, INCLUDING DRIVEWAYS

