

11/31/86
RH

PERMIT

SEWAGE DISPOSAL SYSTEM

MARYLAND STATE DEPARTMENT OF HEALTH

HOWARD COUNTY
BUREAU OF ENVIRONMENTAL HEALTH
461-9933

INDEXED

ELLICOTT CITY

DISTRICT 5th

DATE 12/30/85

36356

62380

515293

T & R Plumbing & Heating, Inc.

IS PERMITTED TO INSTALL ALTER

ADDRESS 11974 Scroggsville Road, Fulton, MD 20759 PHONE 725-2392

SUBDIVISION 5418 Harris Farm Lane ROAD 5304 Ten Oaks Road LOT 19A

PROPERTY OWNER Allan Weintraub Barbelle Christian Karen Caccia Duffy

ADDRESS _____

IF GARBAGE GRINDER IS USED INCREASE SEPTIC TANK CAPACITY BY 50% AND ABSORPTION AREA BY 25%

GARBAGE GRINDER? YES _____ NO

SEPTIC TANK CAPACITY 1250 GALLONS NUMBER OF BEDROOMS 4

Addition Garage
BLDG PERMIT BONES
ISSUED 4-19-86
Sewer # 64,224

TRENCHES - 158 sq. ft. per bedroom. Trench to be 2 feet wide. Inlet 4 feet below original grade. Bottom maximum depth 9 feet below original grade. Effective area begins at 4 feet below original grade. 4 1/2 feet of stone below distribution pipe.

LOCATION: Start the trench 290 feet from the front 175 ft. lot line and 25 feet from the right 587 ft. lot line as seen when facing the lot from right-of-way. Run trench on contour toward left 613.81 ft. lot line as seen from right-of-way.

NOTE: NO TRENCH TO EXCEED 100 FEET IN LENGTH. IF MORE THAN ONE TRENCH USED, A DISTRIBUTION BOX IS REQUIRED. Call for inspection of trench(s) before and after gravel is installed. Provide 6" - 8" diameter cleanout and cap to grade or above on septic tank.

11/2/86 - OK TO MAKE INLET 5 FT DEEP & ONLY
PUT IN 4 FT OF STONE

BLDG PERMIT SIGNED
AND RETURNED
11/25/85

PLANS APPROVED BY S. Abel DATE 11/25/85

COVER NO WORK UNTIL INSPECTED AND APPROVED.

NEITHER THE HOWARD COUNTY COUNCIL NOR THE HEALTH DEPARTMENT IS RESPONSIBLE FOR THE SUCCESSFUL OPERATION OF ANY SYSTEM.

NOTE: IF TRENCH IS USED CALL FOR INSPECTION BEFORE AND AFTER PLACING GRAVEL IN TRENCH.

NOTE: NO DRY WELL SHALL EXCEED 15 FOOT IN DIAMETER. NO ABSORPTION TRENCH TO EXCEED 100 FEET IN LENGTH.

NOTE: ALL PIPE FROM HOUSE TO SEPTIC TANK MUST BE CAST IRON OR SCHEDULE 40 PVC OR ABS.

PERMIT VOID AFTER THREE YEARS.

NOTE: INSTALL STAND PIPE ON SEPTIC TANK AND DRY WELL. STAND PIPES MUST BE 6 INCHES IN DIAMETER. CAST IRON, CONCRETE OR TERRA COTTA OR PVC OR ABS ACCEPTED. IF TOP OF SEPTIC TANK IS DEEPER THAN 3 FEET MANHOLE TO GRADE REQUIRE _____

BLDG PERMIT SIGNED
AND RETURNED
11/25/85
BLDG PERMIT SIGNED
AND RETURNED
11/25/85

12309

***INSTALLER IS RESPONSIBLE FOR OBTAINING FINAL APPROVAL ON THIS PERMIT**

FOR INSPECTION OF SEPTIC SYSTEMS.

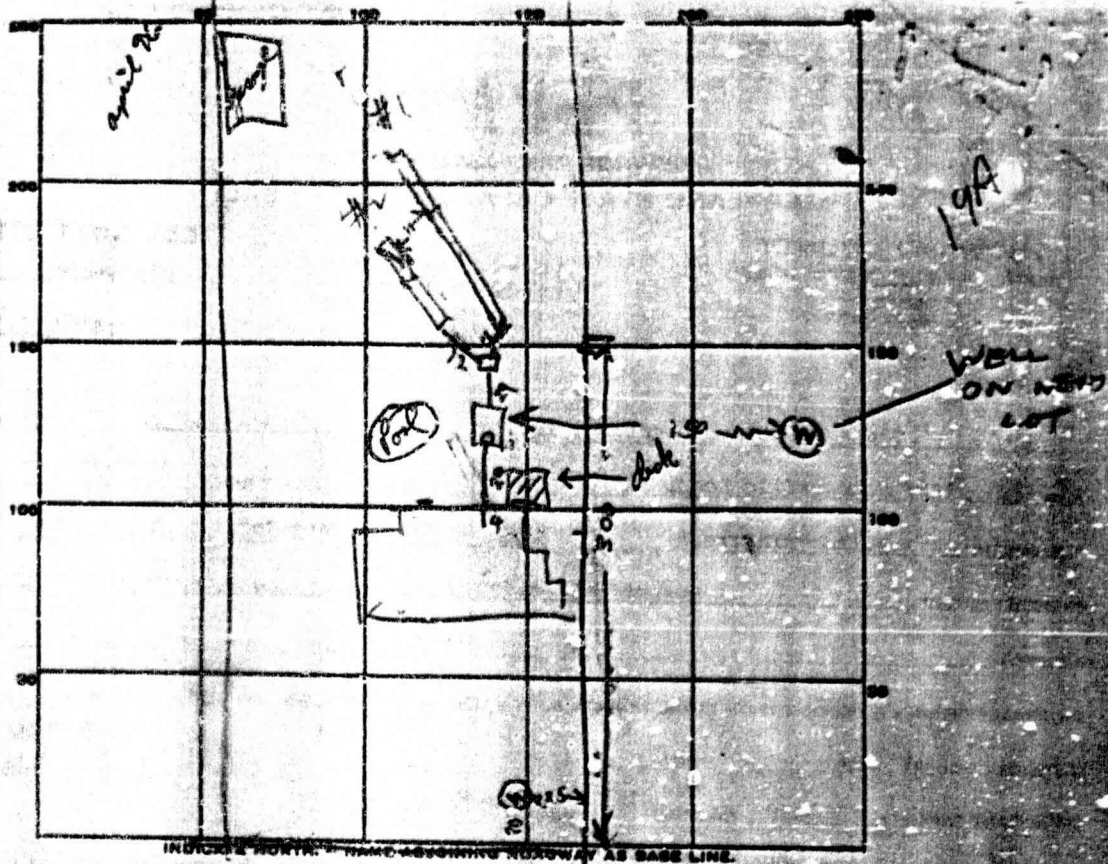

5718 Harris Dr.

PERMIT CARD

SEPTIC TANK, LEVEL 1250 ← ST
 TOP BELOW GRADE CLEANOUTS OK
 DISTRIBUTION BOX, LEVEL OK TANK TOP NOW ONLY 2 1/2 FT

TILE FIELD, DEPTH 9 1/2 FT. TRENCH WIDTH 2 FT.

	#1	#2	#	#2	TOTAL
GRAVEL DEPTH	55	5	65	50	150
NUMBER OF TRENCHES	2		ONE SIDE	290	825

SEPTAGE PIPES, INSIDE DIAMETER _____ FT. DEPTH BELOW INLET _____ FT.

ABSORBENT AREA _____ SQ. FT.

1/2/86 - LOCATION OK PER PLAN. 1ST 65 FT OF FIRST TRENCH OK
 TANK SET. FINISH DIGGING TRENCH #1 DIG TRENCH #2 ADD
 STONE TO FIRST PART OF TRENCH #1 MANHOLE NEEDED ON TANK
 UNLESS GROUND CUT 1 FT OVER RMC 1/2/86 - DIG TRENCH #2
 LONGER & ADD STONE TO BOTH TRENCHES RE 1/3/86 TRENCH
 #2 DIG LONGER RE 1/3/86 632 SQ FT NEEDED BOC INSTALLED
 GROUND CUT NEAR T

DATE SYSTEM APPROVED 1/3/86 INSPECTOR Raymond J. [Signature]