

2/11/02
10:00

SITE INSPECTION SHEET

OWNER: Tiffany Martin

DATE REQUESTED: _____

PHONE #: 410-531-5899/443-691-6754

CONTRACTOR: _____

ADDRESS: 7934 Harriet Tubman La
Map 35, P. 324

WELL TAG #: _____

COUNTY #: _____

PROPOSAL: Ex. drilled well dry 100%, request emergency
inclusion in Metro District

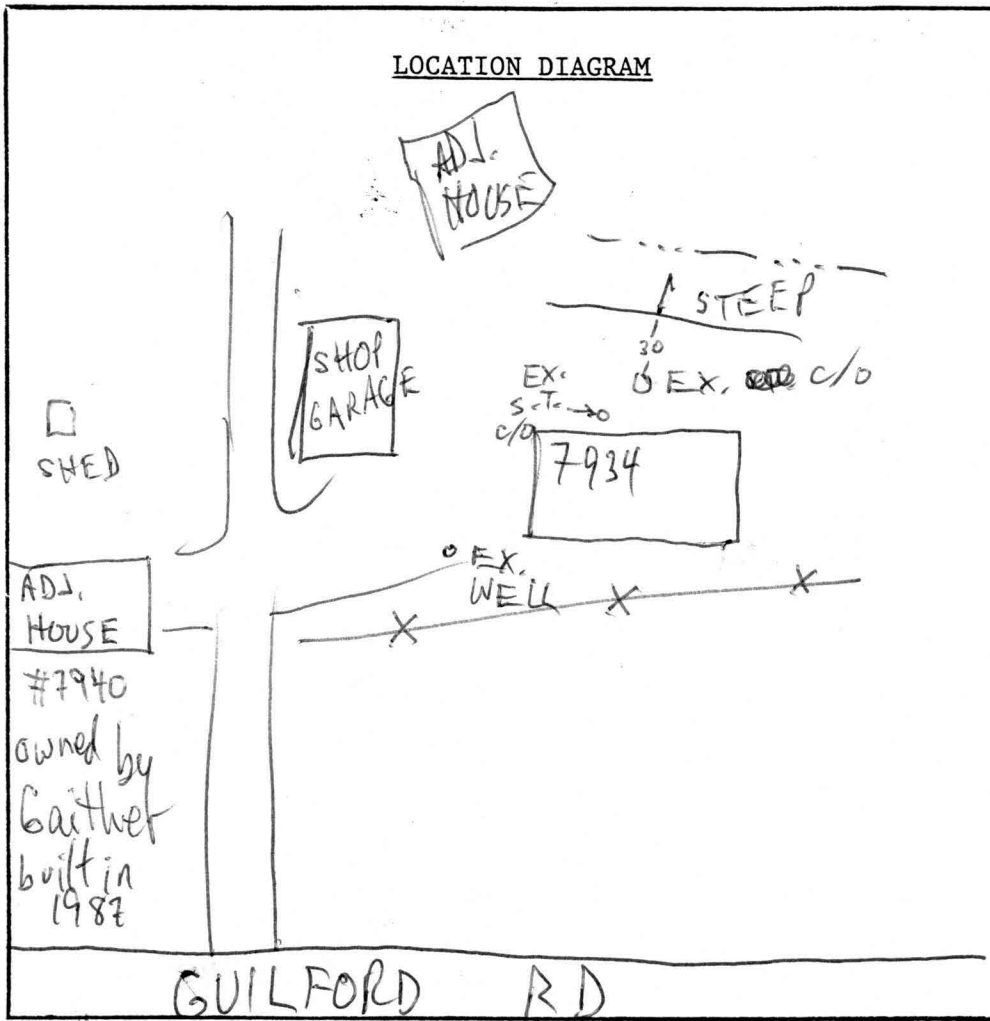

COMMENTS: 12/4/02 MET OWNER @ SITE; NO WATER @ KITCHEN TAP;

RECOMMENDATION FOR EM. INCLUSION GRANTED; @ S.S. UNCERTAIN

DUE TO 2ND C/O IN YARD, ALTHO RECORD (BELIEVED TO BE CORRECT)

SHOWS TRENCH DESIGN W/NO DRYWELL; OWNER ADVISED SEPTIC REPAIR

OPTIONS LIKELY LIMITED DUE TO TOPO & SHE SHOULD ALSO ACCESS PUB. SEWER

DATE: _____ INSPECTOR: _____

ASAP
MR

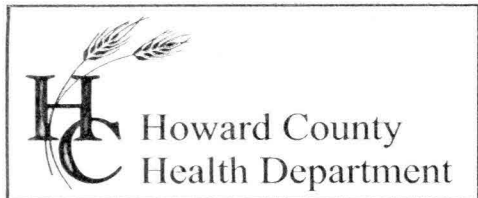

3525 H Ellicott Mills Drive, Ellicott City, MD 21043
(410) 313-2640 Fax (410) 313-2648
TDD (410) 313-2323 Toll Free 1-866-313-6300
website: www.hchealth.org

faxed
this
date

Penny E. Borenstein, M.D., M.P.H., Health Officer

December 6, 2002

MEMORANDUM

TO: Charlotte Dryden
Division of Real Estate Services

FROM: Mark Rifkin *MR*
Well and Septic Program

RE: Property of Tiffany Martin
7934 Harriet Tubman Lane
Tax Map 35, Parcel 324

The Howard County Health Department recommends emergency inclusion of the referenced property into the Metropolitan Service District.

An inspection conducted December 4, 2002 revealed that opening the kitchen tap produced no water. The existing well is therefore incapable of meeting any sanitary needs.

Provision of an alternate water supply should be completed as soon as possible.

MR

cc:

File

Tiffany Martin

A516050-F