

600009221

DEPARTMENT OF INSPECTIONS, LICENSES AND PERMITS
3400 COURT HOUSE DRIVE
ELKINGTON CITY, MD 21043
PERMITS (410) 313-2456 INSPECTIONS (410) 313-1810
AUTOMATED INFORMATION (410) 313-3800

HOWARD COUNTY PERMIT APPLICATION

PERMIT NUMBER

B0053080

Building Address 11946 Hampstead Green
~~EC 21042 Ellicott City, MD~~
~~Ellicott St 21042~~
 Suite/Apt. #: SDP/WP/Petition #: SDP-03-030
 Census Tract 6030 Subdivision Homeland Ellicott Meadows
 Section _____ Area _____ Lot 70
 Tax Map 16 Parcel 406 Grid 16/22
 Zoning RC Map Coordinates 11A7 Lot size _____

Property Owner's Name NVR Inc
 Address 6085 Manhalce Drive Ste 130
 City Ellicott City State MD Zip Code 21075
 Home Phone _____ Work Phone 410-389-5501
 Applicant's Name & Mailing Address, (if other than stated hereon):
Kim Cecil - Permit App. Services
1547 Grays Ford Rd
Alexton, MD 21113
 Phone 413-994-9702 Fax _____

Existing Use Vacant Lot
 Proposed Use STN
 Estimated Construction Cost \$ 80,000
 Description of Work Construct "Belle Via"
Plans Attached To Be Ruled On Fall

Contractor Company NVR Inc
 Contact Person Kimberly Cecil
 Address 1146 Lewisville Rd
 City Mechanic State MD Zip Code 21222
 License No. 56
 Phone 413-994-9702 Fax _____

Occupant or Tenant _____
 Contact Name _____
 Address _____
 City _____ State _____ Zip Code _____
 Phone _____ Fax _____

Engineer or Architect Company _____
 Contact Person _____
 Address Jim Kerwin 443-309-7792
 City _____ State _____ Zip Code _____
 Phone _____ Fax _____

BUILDING DESCRIPTION - COMMERCIAL

BUILDING DESCRIPTION - RESIDENTIAL

Building Characteristics	Utilities
Height: _____	Water Supply: <input type="checkbox"/> Public <input type="checkbox"/> Private
No. of stories: _____	Sewage Disposal: <input type="checkbox"/> Public <input type="checkbox"/> Private
Gross area, sq. ft. per floor: _____	Electric Yes <input type="checkbox"/> No <input type="checkbox"/> Gas Yes <input type="checkbox"/> No <input type="checkbox"/>
Use group: _____	Heating System: Electric <input type="checkbox"/> Oil <input type="checkbox"/> Natural Gas <input type="checkbox"/> Propane Gas <input type="checkbox"/>
Construction type: <input type="checkbox"/> Reinforced Concrete <input type="checkbox"/> Structural Steel <input type="checkbox"/> Masonry <input type="checkbox"/> Wood Frame <input type="checkbox"/> State Certified Modular	Sprinkler system: <u>N/A</u> <input type="checkbox"/> Full _____ Partial _____ Other Suppression _____ # of Heads _____

Building Characteristics	Utilities
SF Dwelling <input type="checkbox"/> SF Townhouse <input checked="" type="checkbox"/> Depth _____ Width _____	Water Supply: <input type="checkbox"/> Public <input type="checkbox"/> Private
1st floor: _____	Sewage Disposal: <input type="checkbox"/> Public <input type="checkbox"/> Private
2nd floor: _____	Electric Yes <input type="checkbox"/> No <input type="checkbox"/> Gas Yes <input type="checkbox"/> No <input type="checkbox"/>
Basement: _____	Heating System: Electric <input type="checkbox"/> Oil <input type="checkbox"/> Natural Gas <input checked="" type="checkbox"/> Propane Gas <input type="checkbox"/>
Finished Basement <input type="checkbox"/> Unfinished Basement <input type="checkbox"/> Crawl space <input type="checkbox"/> Slab on Grade <input type="checkbox"/> No. of Bedrooms <u>X 2</u>	Sprinkler system: <u>N/A</u> <input type="checkbox"/> NEPA #13D _____ NFPA #13R _____ Other: _____
Multi-family dwellings: No. of efficiency units: _____ No. of 1 BR units: _____ No. of 2 BR units: _____ No. of 3 BR units: _____	Other Structure: _____ Dimensions: _____ Footings: _____ Roof: _____
_____ State Certified Modular _____ Manufactured Home	

THE UNDERSIGNED HEREBY CERTIFIES AND AGREES AS FOLLOWS: (1) THAT HE/SHE IS AUTHORIZED TO MAKE THIS APPLICATION; (2) THAT THE INFORMATION IS CORRECT; (3) THAT HE/SHE WILL COMPLY WITH ALL REGULATIONS OF HOWARD COUNTY WHICH ARE APPLICABLE THERETO; (4) THAT HE/SHE WILL PERFORM NO WORK ON THE ABOVE REFERENCED PROPERTY NOT SPECIFICALLY DESCRIBED IN THIS APPLICATION; (5) THAT HE/SHE GRANTS COUNTY OFFICIALS THE RIGHT TO ENTER ONTO THIS PROPERTY FOR THE PURPOSE OF INSPECTING THE WORK PERMITTED AND POSTING NOTICES.

Kim Cecil - Permit Applications
 Applicant's Signature _____
 Title/Company _____

NVR Inc
 Print Name _____
4-12-09
 Date _____

Checks payable to: **DIRECTOR OF FINANCE OF HOWARD COUNTY** Fee Due: 10353.00
 ** PLEASE WRITE NEATLY AND LEGIBLY. **
 - FOR OFFICE USE ONLY -

AGENCY	DATE	SIGNATURE APPROVAL
Land Development, DPZ		
State Highways		
Building Official	<u>5/16/05</u>	<u>[Signature]</u>
Dev. Engineering, DPZ		
Health	<u>5/19/05</u>	<u>[Signature]</u>
Fire Protection		

Is Sediment Control approval required prior to issuance?
 YES NO

CONTINGENCY CONSTRUCTION START:
 ONE STOP SHOP:

PROPERTY ID#: 65246
 DPZ SETBACK INFORMATION
 Front: _____
 Rear: _____
 Side: _____
 Side St.: _____
 All minimum setbacks met? YES NO
 Is Entrance Permit required? YES NO
 Historic District? YES NO
 Lot Coverage for New Town Zone _____
 SDP/Red-line approval date _____

PROPERTY ID#	AMOUNT
Filing fee \$	<u>100</u>
Permit fee	<u>882.93</u>
Excise tax	<u>322.14</u>
Add'l per. fee	<u>89.94</u>
TOTAL FEES	<u>1394.01</u>
Sub-total paid	\$ _____
Balance due	\$ _____
Check #	<u>210790</u>
Validation #	_____

Accepted by [Signature]

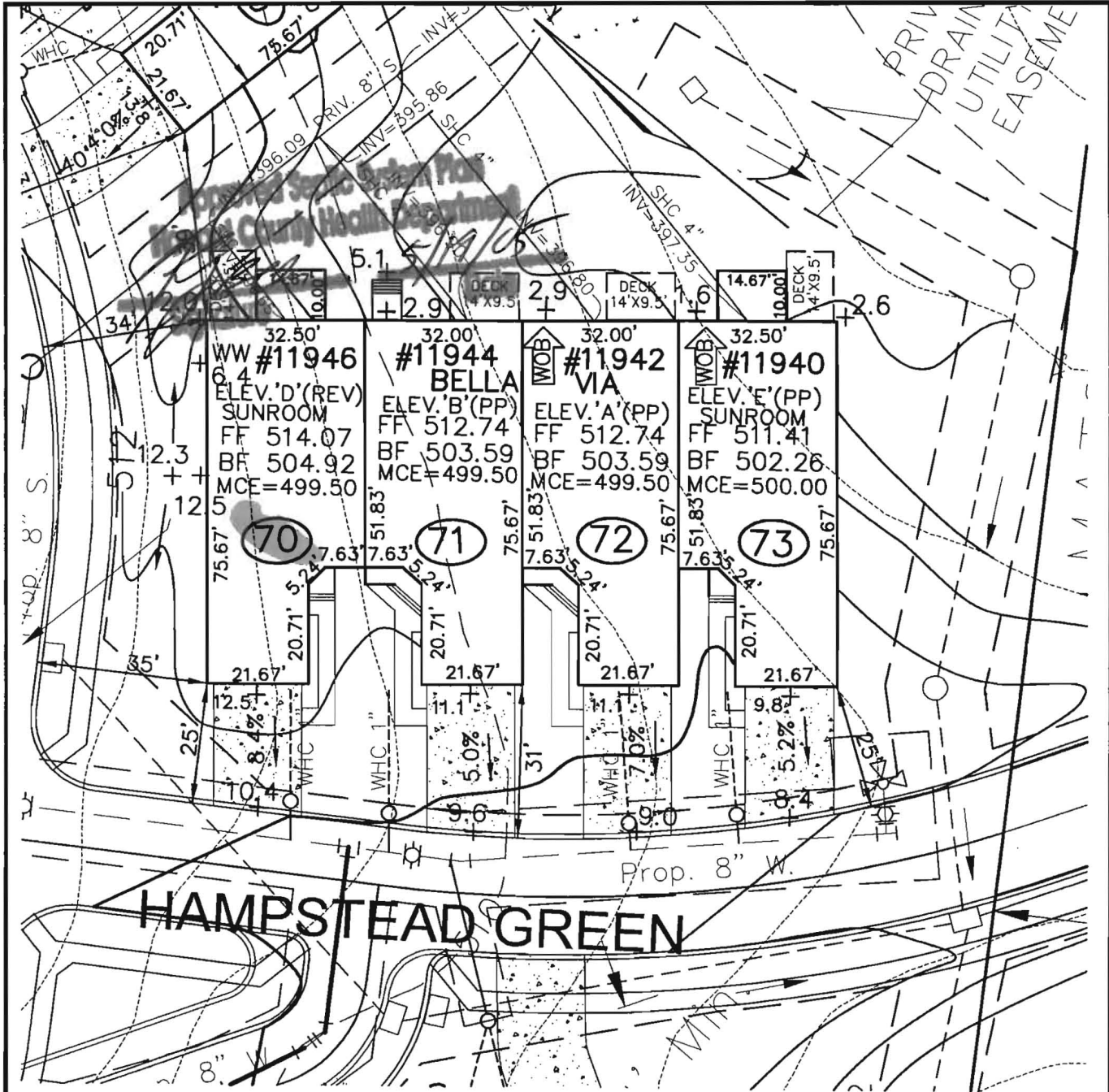

HAMPSTEAD GREEN

ROBERT H. VOGEL
ENGINEERING, INC.
 ENGINEERS • SURVEYORS • PLANNERS
 8407 MAIN STREET TEL: 410.461.7666
 ELLICOTT CITY, MD 21043 FAX: 410.461.8961

SCALE 1"=30'
 DRAWN BY JCO
 CHECKED BY RHV
 DATE APRIL, 2005
 W. O. # 04-87.00
 SHEET# 1 OF 1

NV HOMES
ELLICOTT MEADOWS
UNITS 70-73

HOMELAND SDP-03-30
 TAX MAP 16
 3RD ELECTION DISTRICT

PARCEL 53,96,165&204
 HOWARD COUNTY, MARYLAND