

69221

DEPARTMENT OF INSPECTIONS, LICENSES AND PERMITS
3430 COURT HOUSE DRIVE
ELICOTT CITY, MD 21043
PERMITS (410) 313-2454 INSPECTIONS (410) 313-1810
AUTOMATED INFORMATION (410) 313-3900

HOWARD COUNTY PERMIT APPLICATION

PERMIT NUMBER

000153084

Building Address 11940 Hampstead Green
~~2221048 Elmdale MD EC 21042~~
 Suite/Apt. #: _____ SDP/WP/Petition #: 03-030
 Census Tract 6030 Subdivision Honolulu
~~Ellicott Meadows~~
 Section _____ Area _____ Lot 43
 Tax Map 16 Parcel 110406 Grid 16/22
 Zoning RC Map Coordinates 11A2 Lot size _____

Property Owner's Name NVR Ltd.
 Address 6085 Manaloe Dr. Ste 100
 City Elmdale State MD Zip Code 21075
 Home Phone _____ Work Phone 410-374-5756
 Applicant's Name & Mailing Address, (if other than stated hereon):
Kim Cecil - Permit App Services
1847 Grays Ford Rd
Odenton, MD 21113
 Phone 443-444-9102 Fax _____

Existing Use Vacant Lot
 Proposed Use SFTH
 Estimated Construction Cost \$ 80,000
 Description of Work Construct "Seven"
Pans Attached To Perceid On 174

Contractor Company NVR Ltd.
 Contact Person Kimberly Cecil
 Address 11460 Lewinsville Rd.
 City Meheun State VA Zip Code 22102
 License No. 36
 Phone 443-444-4922 Fax _____

Occupant or Tenant _____
 Contact Name _____
 Address _____
 City _____ State _____ Zip Code _____
 Phone _____ Fax _____

Engineer or Architect Company _____
 Contact Person _____
 Address _____
 City _____ State _____ Zip Code _____
 Phone _____ Fax _____

BUILDING DESCRIPTION - COMMERCIAL

BUILDING DESCRIPTION - RESIDENTIAL

Building Characteristics	Utilities
Height: _____	Water Supply: <input type="checkbox"/> Public <input type="checkbox"/> Private
No. of stories: _____	Sewage Disposal: <input type="checkbox"/> Public <input type="checkbox"/> Private
Gross area, sq. ft. per floor: _____	Electric Yes <input type="checkbox"/> No <input type="checkbox"/> Gas Yes <input type="checkbox"/> No <input type="checkbox"/>
Use group: _____	Heating System: <input type="checkbox"/> Electric <input type="checkbox"/> Oil <input type="checkbox"/> <input type="checkbox"/> Natural Gas <input type="checkbox"/> <input type="checkbox"/> Propane Gas <input type="checkbox"/>
Construction type: <input type="checkbox"/> Reinforced Concrete <input type="checkbox"/> Structural Steel <input type="checkbox"/> Masonry <input type="checkbox"/> Wood Frame <input type="checkbox"/> State Certified Modular	Sprinkler system: N/A <input type="checkbox"/> <input type="checkbox"/> Full <input type="checkbox"/> Partial <input type="checkbox"/> Other Suppression <input type="checkbox"/> # of Heads _____

Building Characteristics	Utilities
SF Dwelling <input type="checkbox"/> SF Townhouse <input type="checkbox"/> Depth _____ Width _____	Water Supply: <input type="checkbox"/> Public <input type="checkbox"/> Private
1st floor: _____	Sewage Disposal: <input type="checkbox"/> Public <input type="checkbox"/> Private
2nd floor: _____	Electric Yes <input type="checkbox"/> No <input type="checkbox"/> Gas Yes <input type="checkbox"/> No <input type="checkbox"/>
Basement: _____	Heating System: <input type="checkbox"/> Electric <input type="checkbox"/> Oil <input type="checkbox"/> <input checked="" type="checkbox"/> Natural Gas <input type="checkbox"/> <input type="checkbox"/> Propane Gas <input type="checkbox"/>
Finished Basement <input type="checkbox"/> Unfinished Basement <input type="checkbox"/> Crawl space <input type="checkbox"/> Slab on Grade <input type="checkbox"/> No. of Bedrooms _____	Sprinkler system: N/A <input type="checkbox"/> <input type="checkbox"/> NFPA #13D <input type="checkbox"/> NFPA #13R <input type="checkbox"/> Other: _____
Multi-family dwellings: No. of efficiency units: _____ No. of 1 BR units: _____ No. of 2 BR units: _____ No. of 3 BR units: _____	
Other Structure: _____ Dimensions: _____ Footings: _____ Roof: _____	
<input type="checkbox"/> State Certified Modular <input type="checkbox"/> Manufactured Home	

THE UNDERSIGNED HEREBY CERTIFIES AND AGREES AS FOLLOWS: (1) THAT HE/SHE IS AUTHORIZED TO MAKE THIS APPLICATION, (2) THAT THE INFORMATION IS CORRECT, (3) THAT HE/SHE WILL COMPLY WITH ALL REGULATIONS OF HOWARD COUNTY WHICH ARE APPLICABLE THERETO; (4) THAT HE/SHE WILL PERFORM NO WORK ON THE ABOVE REFERENCED PROPERTY NOT SPECIFICALLY DESCRIBED IN THIS APPLICATION, (5) THAT HE/SHE GRANTS COUNTY OFFICIALS THE RIGHT TO ENTER ONTO THIS PROPERTY FOR THE PURPOSE OF INSPECTING THE WORK PERMITTED AND POSTING NOTICES.

Kim Cecil - Permit App Serv
 Applicant's Signature _____
NVR Ltd
 Title/Company _____

NVR Ltd
 Print Name _____
4-12-05
 Date _____

Checks payable to: **DIRECTOR OF FINANCE OF HOWARD COUNTY**
 ** PLEASE WRITE NEATLY AND LEGIBLY. **
 - FOR OFFICE USE ONLY -

AGENCY	DATE	SIGNATURE APPROVAL
Land Development, DPZ		
State Highways		
Building Official	<u>5/16/05</u>	<u>[Signature]</u>
Dev. Engineering, DPZ		
Health	<u>5/25/05</u>	<u>[Signature]</u>
Fire Protection		
Is Sediment Control approval required prior to issuance? YES <input type="checkbox"/> NO <input type="checkbox"/>		
CONTINGENCY CONSTRUCTION START: <input type="checkbox"/>		
ONE STOP SHOP: <input type="checkbox"/>		

DPZ SETBACK INFORMATION

Front: _____
 Rear: _____
 Side: _____
 Side St.: _____

All minimum setbacks met?
YES NO

Is Entrance Permit required?
YES NO

Historic District?
YES NO

Lot Coverage for New Town Zone _____
 SDP/Red-line approval date _____

PROPERTY ID# 65250

Filing fee \$ 100

Permit fee \$ 953

Excise tax \$ 4185

Add'l per. fee \$ 99

TOTAL FEES \$ 5781

Sub-total paid \$ _____

Balance due \$ _____

Check # 210790

Validation # 89024

Accepted by [Signature]

Distribution of Copies: White: Building Official Green: LDD, DPZ Yellow: DED, DPZ Pink: Health Gold: SHA

T:\forms\PERMIT.FRM

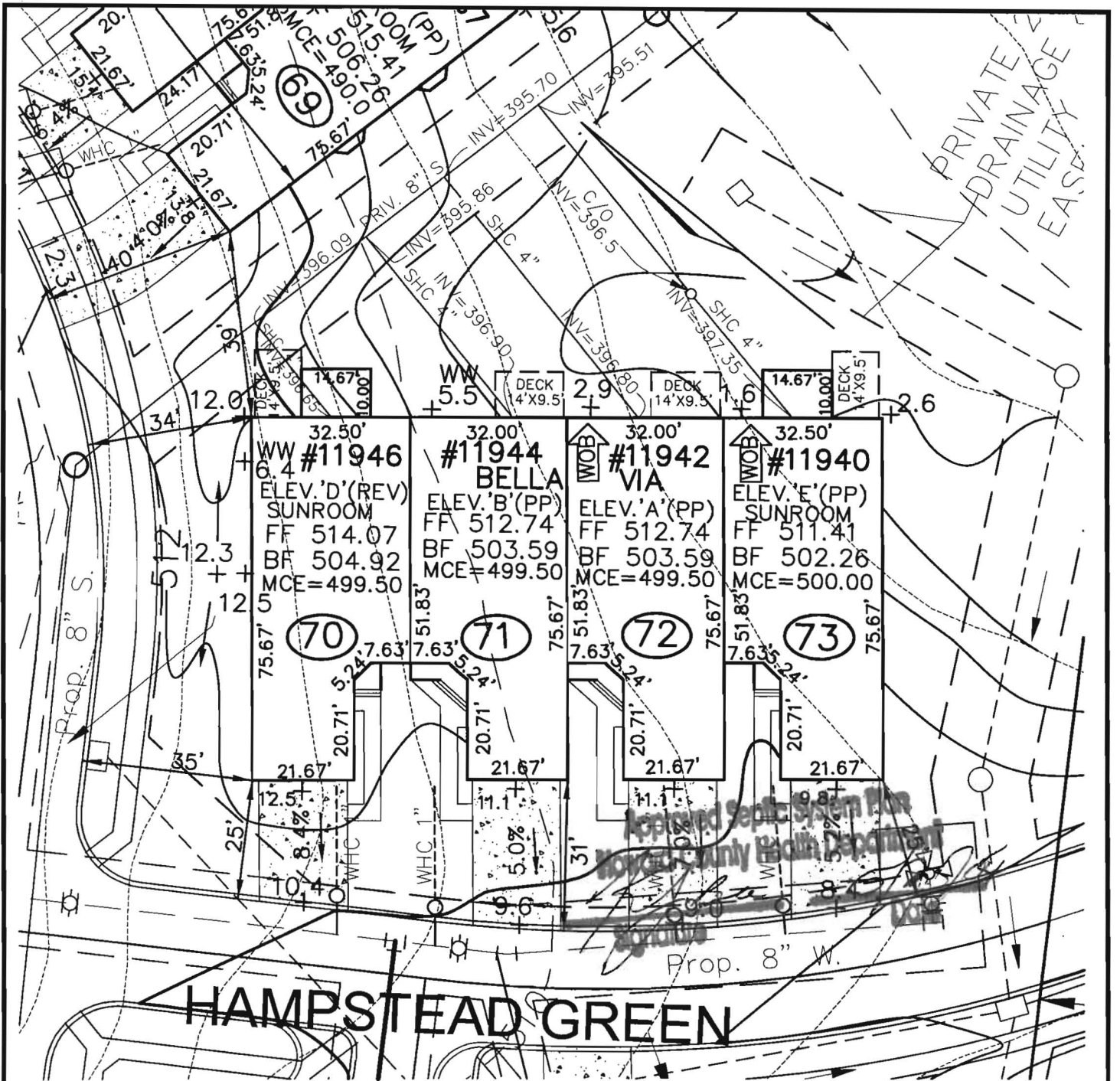

HAMPSTEAD GREEN



**ROBERT H. VOGEL
ENGINEERING, INC.**

ENGINEERS • SURVEYORS • PLANNERS

8407 MAIN STREET TEL: 410.461.7666
ELLCOTT CITY, MD 21043 FAX: 410.461.8961

SCALE _____ 1"=30'
DRAWN BY _____ JCO
CHECKED BY _____ RHV
DATE _____ APRIL, 2005
W. O. # _____ 04-87.00
SHEET# _____ 1 OF 1

NV HOMES ELLCOTT MEADOWS UNITS 70-73

HOMELAND SDP-03-30
TAX MAP 16
3RD ELECTION DISTRICT

PARCEL 53,96,165&204
HOWARD COUNTY, MARYLAND