

3/19/01
2-0-0

3/20/01
Repair Final
ASAP

05-370663

PERMIT

SEWAGE DISPOSAL SYSTEM

HOWARD COUNTY HEALTH DEPARTMENT
BUREAU OF ENVIRONMENTAL HEALTH
410-313-2640

P 514966
A REPAIR
ISSUE DATE 3/7/2001
APPROVAL DATE 3/20/01

INDEXED

Jack Fvock Septic Systems IS PERMITTED TO INSTALL ALTER X

ADDRESS P.O. Box 89 Triadelphia Road Glenelg, Md PHONE 410-988-9270

SUBDIVISION _____ LOT NUMBER _____ ADDRESS 12496 Hall Shop Road

PROPERTY OWNER Baar PROPERTY OWNER'S ADDRESS same

SEPTIC TANK CAPACITY ex 1500 GALLONS

PUMP CHAMBER CAPACITY NA GALLONS

NUMBER OF BEDROOMS 4

SQUARE FEET PER BEDROOM 180ft²

LINEAR FEET OF TRENCH REQUIRED 180'

TRENCHES: Trenches to be 2 feet wide. Inlet 3' feet below original grade. Bottom maximum depth 7' feet below original grade. 4' feet of stone below distribution box.

LOCATION: _____

REPAIR: PURPOSE: SEPTIC SYSTEM HAS FAILED
Call for inspection when tank is in place so that a sanitarian can recommend repair.

Set distribution box off of tank and run 4' Trenches angled on contour as discussed. try to keep trenches equal in length. -SRK

PLANS APPROVED Steven R. Krieg DATE 2/12/01

PERMIT VOID AFTER 2 YEARS

NOTE: CONTRACTOR RESPONSIBLE FOR SCHEDULING A PRE-CONSTRUCTION INSPECTION FOR ALL INSTALLATIONS

NOTE: TOP OF SEPTIC TANKS ARE TO BE NO DEEPER THAN 3.0 FEET BELOW FINISH GRADE

NOTE: WATERTIGHT SEPTIC TANKS REQUIRED

NOTE: CLEANOUT REQUIRED EVERY 70 FEET OF SEWER LINE AND/OR AT 90° SWEEPS IN LINES FROM HOUSE TO DRAIN FIELDS, 90° ELBOWS ARE NOT ACCEPTABLE

NOTE: ALL PARTS OF SEPTIC SYSTEMS (I.E. TANK, DISTRIBUTION BOX, DRAINFIELDS) TO BE 100 FEET FROM ANY WATER WELL UNLESS OTHERWISE SPECIFICALLY AUTHORIZED

NOTE: NO ABSORPTION TRENCH TO EXCEED 100 FEET IN LENGTH UNLESS SPECIFICALLY AUTHORIZED

NOTE: ALL PIPE FROM HOUSE TO SEPTIC TANK MUST BE CAST IRON OR SCHEDULE 35/40 PVC OR ABS

NOTE: MANHOLE RISERS REQUIRED ON ALL SEPTIC TANKS AND PUMP CHAMBERS

NOTE: DISTRIBUTION BOXES MUST HAVE BAFFLES

NOTE: IF PUMPED SEPTIC SYSTEM REQUIRED, (1) SEPTIC PUMP DETAIL TO BE PROVIDED BY INSTALLER PRIOR TO ISSUANCE OF SEPTIC PERMIT (2) PUMP PERFORMANCE TEST IS NECESSARY PRIOR TO HEALTH DEPARTMENT APPROVAL OF SEPTIC PERMIT

NEITHER THE HOWARD COUNTY COUNCIL NOR THE HEALTH DEPARTMENT IS RESPONSIBLE FOR THE SUCCESSFUL OPERATION OF ANY SYSTEM
PERMITTEE RESPONSIBLE FOR OBTAINING FINAL APPROVAL ON THIS PERMIT
CALL 410-313-2640 FOR INSPECTION OF SEPTIC SYSTEM

0514966

streambed
NOT TO SCALE

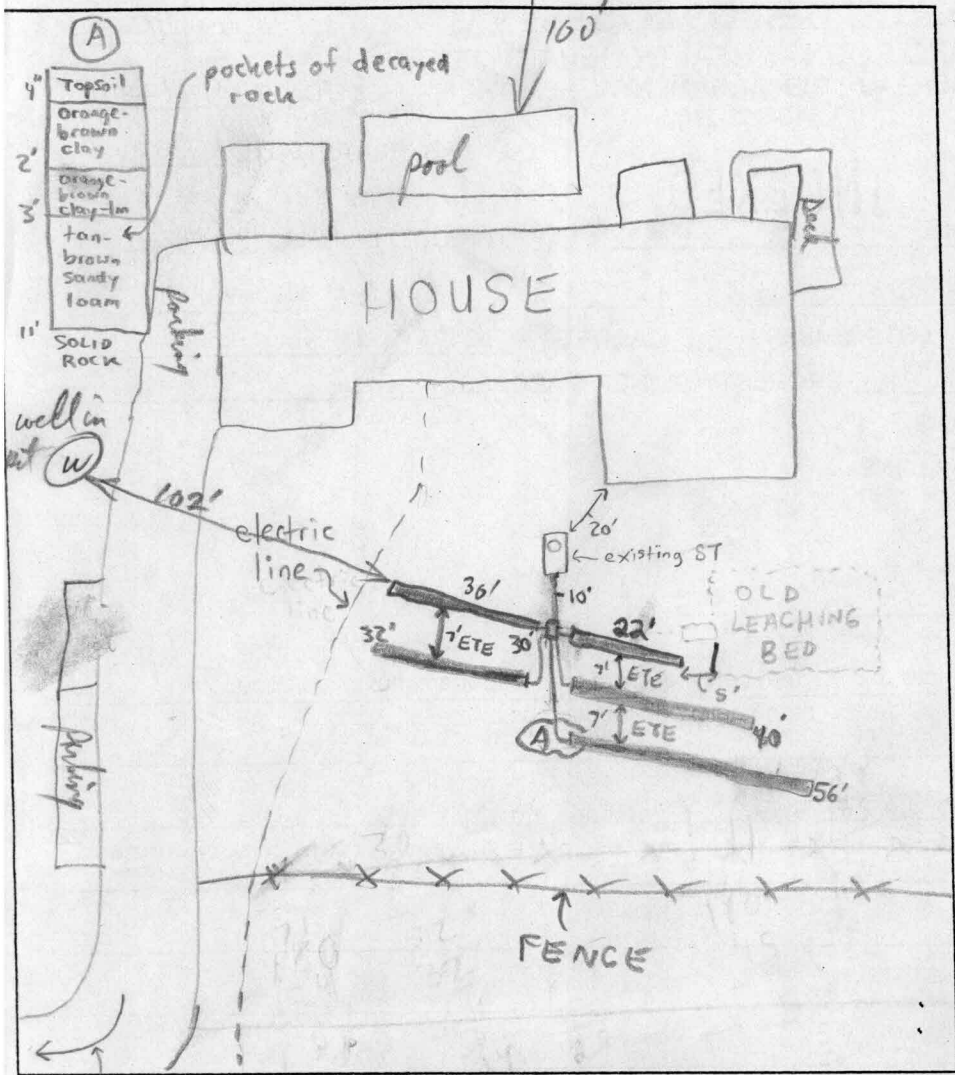

TRENCH DATA	
TRENCH WIDTH	<u>2</u>
TRENCH INLET DEPTH	<u>3</u>
TRENCH BOTTOM DEPTH	<u>7'</u>
DEPTH OF STONE	<u>4'</u>
NUMBER OF TRENCHES	<u>5</u>
TOTAL TRENCH LENGTH	<u>180</u>
ABSORBENT AREA	<u>180 ft²</u>
DISTRIBUTION BOX LEVEL	<input checked="" type="checkbox"/>
BAFFLE IN DISTRIBUTION BOX	<input checked="" type="checkbox"/>

SEPTIC TANK DATA	
SEPTIC TANK	<u>ex 1500</u> GALLONS
MANHOLE RISER	<u>NO</u>
6 INCH INSPECTION PORT	<u>existing</u>
<u> pump out ok</u>	
PUMP CHAMBER DATA	
PUMP CHAMBER GALLONS	<u>NA</u>
MANHOLE RISER	<u>NA</u>
ALARM	<u>NA</u>
PUMP PERFORMANCE TEST	<u>NA</u>

TO HALL SHOP ROAD
PRE-CONSTRUCTION INSPECTION: 2/12/01 - MET INSTALLER, DUG PERCHOLE IN LOCATION (A) SEE SOIL PROFILE, INSTALL SYSTEM AS DISCUSSED ON REVERSE (SRV)

INSPECTION COMMENTS: Hit all lead fill on one side, near electric line on other.
1st trench only 50' long (inlet @ 3', bottom @ 7') - open trench OK,
ok to continue work, RP 3/19/01

3/20/01 - BAFFLES IN EX. SEPTIC TANK OK, ex. terracotta 6" cleanout OK, OK TO COVER ALL WORK (SRV)

INSPECTOR Steven R. Krieg DATE SYSTEM APPROVED 3/20/01