

LAYOUT 4/2/07 INSP 4 6/7/07
INSP 2 4/3/07 INSP 5 _____
INSP 3 4/4/07 INSP 6 _____

ISSUE DATE: 02/21/2007

APPROVAL DATE: 06/11/2007

PERMIT

INDEXED

TAX ID # 03-342387

ON-SITE SEWAGE DISPOSAL SYSTEM HOWARD COUNTY HEALTH DEPARTMENT BUREAU OF ENVIRONMENTAL HEALTH

P 526247

A 515958 - D

Rylea Homes IS PERMITTED TO INSTALL ALTER

ADDRESS: PO Box 68, Glenwood, MD 21738 PHONE NUMBER: _____

SUBDIVISION: Foxtail Run LOT NUMBER: 7

ADDRESS: 13719 Greyfox Run PROPERTY OWNER: Rylea Homes

SEPTIC TANK CAPACITY (GALLONS): 1250 OUTLET BAFFLE FILTER REQUIRED

PUMP CHAMBER CAPACITY (GALLONS): 1250 COMPARTMENTED TANK REQUIRED

NUMBER OF BEDROOMS: 4

SQUARE FEET PER BEDROOM: 180

LINEAR FEET OF TRENCH REQUIRED: 200

TRENCHES:	Trench to be 3.0 feet wide. Inlet 3.0 feet below original grade. Bottom maximum depth 5.5 feet below original grade. Effective area begins at 4.5 feet below original grade. 2.5 feet of stone below distribution pipe.
LOCATION:	
NOTES:	System must be installed at the highest portion of the Sewage Disposal Area. Septic line located under driveway needs to be sleeved. Basement will not sewer by gravity.

PLANS APPROVED: Ashley Trump/Sara Fegel DATE: 12/05/2006

- NOTE: PERMIT VOID AFTER 2 YEARS
- NOTE: CONTRACTOR RESPONSIBLE FOR SCHEDULING A PRE-CONSTRUCTION INSPECTION FOR ALL INSTALLATIONS
- NOTE: WATERTIGHT SEPTIC TANKS REQUIRED
- NOTE: ALL PARTS OF SEPTIC SYSTEM SHALL BE 100 FEET FROM ANY WATER WELL
- NOTE: MANHOLE RISERS REQUIRED ON ALL SEPTIC TANKS AND PUMP CHAMBERS UNLESS SPECIFICALLY AUTHORIZED

**NEITHER THE HOWARD COUNTY COUNCIL NOR THE HEALTH DEPARTMENT IS
RESPONSIBLE FOR THE SUCCESSFUL OPERATION OF ANY SYSTEM
PERMITTEE RESPONSIBLE FOR OBTAINING FINAL APPROVAL ON THIS PERMIT
CALL 410-313-1771 FOR INSPECTION OF SEPTIC SYSTEM**

A 515958-D

HO-94-3809

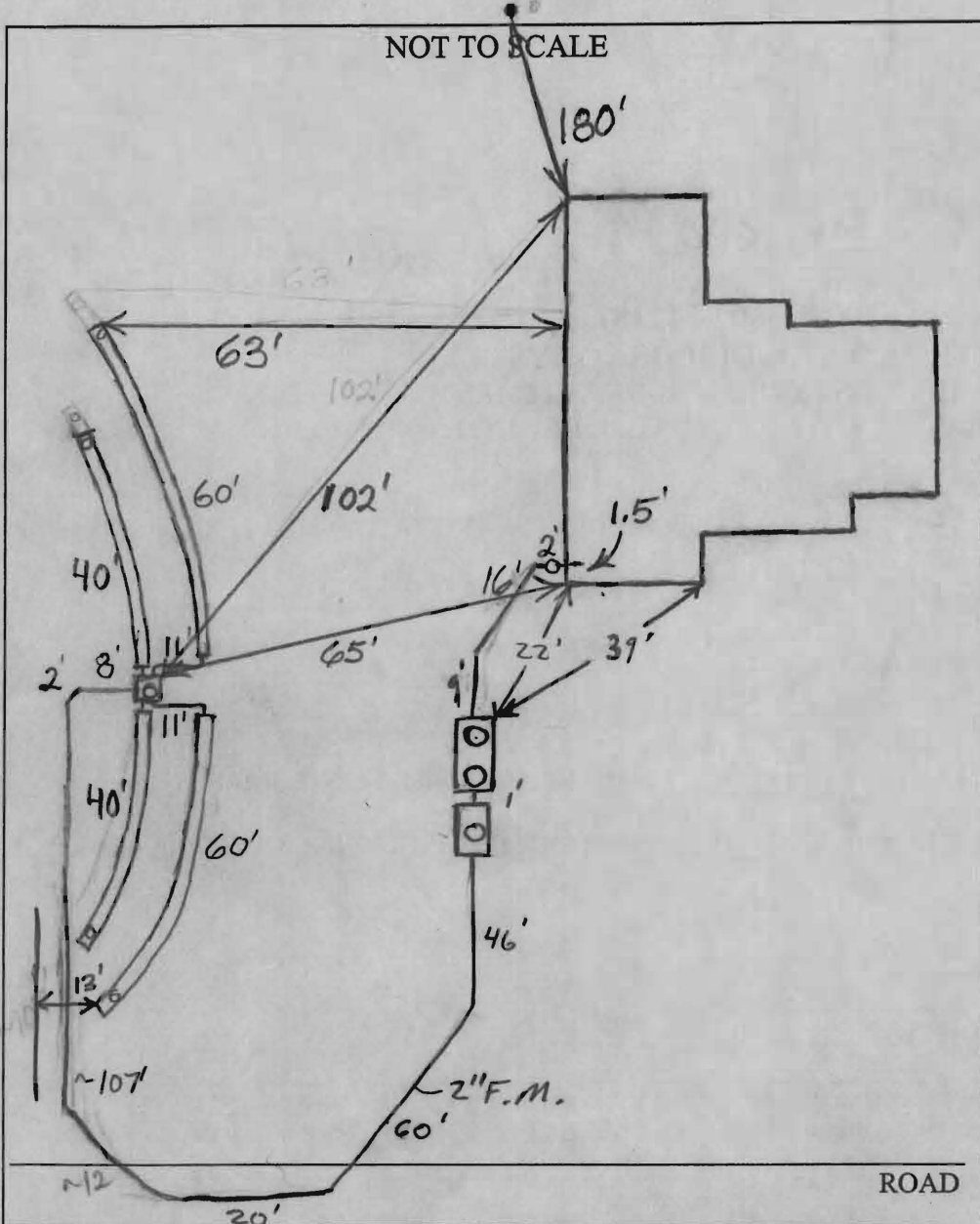

TRENCH/DRAINFIELD DATA		
WIDTH	INLET	BOTTOM
3'	3'	5.5'
NUMBER OF TRENCHES		4
TOTAL LENGTH		200'
ABSORPTION AREA		600+ Sidewalk
DISTRIBUTION BOX LEVEL		Yes
DISTRIBUTION BOX BAFFLE		Yes
DISTRIBUTION BOX PORT		Yes

SEPTIC TANK DATA		
SEPTIC TANK 1 LEVEL		
SEPTIC TANK 1 LEVEL		Yes
Capacity	1500	GAL
SEAM LOC	Top	
TANK LID DEPTH	2'	
BAFFLES	Yes	6" F
BAFFLE FILTER	-	
MANHOLE LOC	F/R	
6" PORT LOC	-	
WATERTIGHT TEST	-	
SEPTIC TANK 2 LEVEL		
SEPTIC TANK 2 LEVEL		Yes
Capacity	1250	GAL
SEAM LOC	Top	
TANK LID DEPTH	2.5'	
BAFFLES	Yes	Front
BAFFLE FILTER	-	
MANHOLE LOC	Center	
6" PORT LOC	-	
WATERTIGHT TEST	-	

PRE-CONSTRUCTION 4/2/07 Place the distribution box near the highest part of the easement and install a 40' and 60' trench on contour in both directions. (PB)

INSTALLATION 4/3/07 Both tanks set. Plumbing from house to tanks installed. Installing 2" F.M. (KW) 4/4/07 Trenches done. System finished. Need pump and alarm test. (PB) 6/7/07 P/A failed. Alarm not looked up. pump's failed to operate. (KW) 6/11/07 P/A OK. System complete. (KW)

FINAL INSPECTOR J. Waff DATE OF APPROVAL 6/11/07

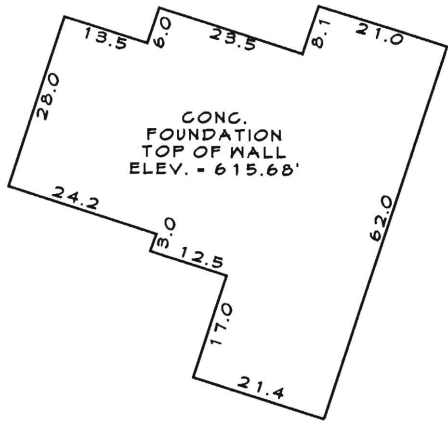

HOUSE DETAIL
SCALE: 1"=30'

OPEN SPACE LOT 8
(DEDICATED TO HOMEOWNERS
ASSOCIATION)

20' PUBLIC DRAINAGE
& UTILITY EASEMENT

GREY FOX

LOT 7
55,893 SQ.FT. +/-

SEPTIC RESERVE AREA

GRAVEL DRIVEWAY

WELL ENVELOPE

EX WELL
HO-94-3809

*Wall
Check OK
3/29/07* (CET)

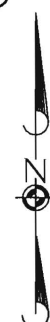

FOUNDATION CERTIFICATION

LOT 7
13719 GREY FOX RUN
FOXTAIL RUN

3rd ELECTION DISTRICT HOWARD COUNTY, MD.
PLATBOOK: 17124

A licensed Maryland Surveyor either personally prepared this Foundation Certification, or was in responsible charge over its preparation and the surveying work reflected in it, in compliance with the Maryland Minimum Standards of Practice for Land Surveyors.

I hereby certify that I have surveyed the property shown hereon for the sole purpose of locating the improvements. This plan is a benefit to the consumer only in so far as it is required by a lender or a title insurance company or its agent in connection with contemplated transfer, financing or refinancing. It is not to be relied upon for the establishment of boundary, easement or right-of-way lines for any reason, such as the location of fences, garages, buildings, or other existing or future improvements.

By *Dennis E. Meckley* Date *3/19/07*
Dennis E. Meckley Property Line Surveyor No. 10844



FREDERICK OFFICE:
8445 Progress Drive, Suite 88
Frederick, MD 21701-4879
(301) 662-1799
FAX (301) 662-8004

WESTMINSTER OFFICE:
439 East Main Street
Westminster, MD 21157-5539
(410) 848-1790
FAX (410) 848-1791

DRAWN BY:	CDD
DESIGN BY:	
REVIEW BY:	DEM
DATE:	1-31-07
SCALE:	1"=50'
JOB NO:	2005003
SHEET:	1 OF 1