

APPLICATION

PERCOLATION TESTING

A 517386

P _____

HOWARD COUNTY HEALTH DEPARTMENT
BUREAU OF ENVIRONMENTAL HEALTH
3525-H ELLICOTT MILLS DRIVE/ELLICOTT CITY, MARYLAND 21043
TELEPHONE: 313-2640

DISTRICT _____

DATE July 26, 2002

TO: THE COUNTY HEALTH OFFICER
ELLICOTT CITY, MARYLAND

I HEREBY APPLY FOR THE NECESSARY TEST PRIOR TO APPLICATION FOR PERMIT TO CONSTRUCT (OR RECONSTRUCT) A SEWAGE DISPOSAL SYSTEM.

PROPERTY OWNER Christopher R. Cole and Victoria Carl Gray

ADDRESS 12182 Scaggsville Rd, Fulton, MD PHONE 301-776-0181

AGENT OR PROSPECTIVE BUYER James M. Jost & Co., Inc.

ADDRESS 7370 Grace Drive, Columbia, MD PHONE 443-535-9200

PROPERTY LOCATION:

SUBDIVISION Cecil Cole Property LOT NO. 11

ROAD AND DESCRIPTION MD. Route 216, 12,200 block, north side
of road

TAX MAP 41 PARCEL # Z

SIZE OF LOT 1 Acre TYPE BLDG. SFD
(SINGLE FAMILY DWELLING OR COMMERCIAL)

THE SYSTEM INSTALLED UNDER THIS APPLICATION IS ACCEPTABLE ONLY UNTIL PUBLIC FACILITIES BECOME AVAILABLE. I FULLY UNDERSTAND THE FEE CONNECTED WITH THE FILING OF THIS PERC TEST APPLICATION IS NON-REFUNDABLE UNDER ANY CIRCUMSTANCES. I ALSO AGREE TO COMPLY WITH ALL M.O.S.H.A. REQUIREMENTS IN TESTING THIS LOT.

James M. Jost
(SIGNATURE OF APPLICANT)

APPROVED BY _____ FOR _____ DATE _____

DISAPPROVED BY _____ FOR _____ DATE _____

HOLD PENDING FURTHER TESTS _____

REASONS FOR REJECTION OR HOLDING _____

PERCOLATION TEST PLAT/PRELIMINARY PLAT - TITLE OR I.D. # _____ DATE _____

SITE DEVELOPMENT PLAN/FINAL PLAT - TITLE OR I.D. # _____ DATE _____

THIS IS NOT A PERMIT

COUNTY #

SOIL PROFILE

SOIL PROFILE

0'
 (136)
 Red Br Heavy Loam 7.5'
 Light Red Br Sa Loam ~20% Rock and Saprolite 14.5'

0'

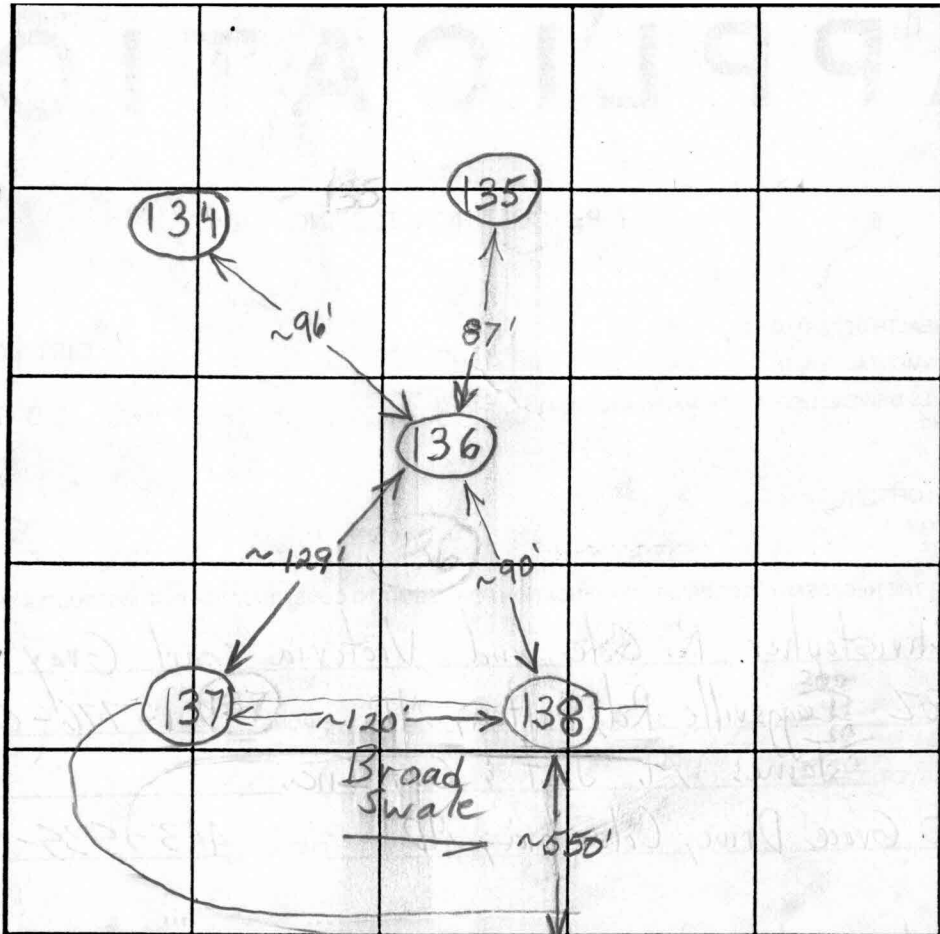

INDICATE NORTH - NAME ADJOINING ROADWAY AS BASE LINE.

Route 216

(138)
 Red Br Heavy Loam 4'
 Red Br S. Loam 5.5'
 Light Red Purple Sa Loam 10-15% Rock and Saprolite 14'

(137)
 Red Br Heavy Loam 5'
 Red Br Heavy S. Loam Trace Rock 14.5'

DATE	TEST NO.	DEPTH	PRE-WET		TEST - 1" DROP		TIME	
			START	STOP	START	STOP		
9/12/02	136	6'10"/14.5'V	12:12		Not Down to Second Peg After 25 minutes		Slow	(F)
	138	6'/14'V	12:24	12:25:30	12:25:30	12:29	3 1/2	O.K.
	137	7'/14.5'V	1:02		Hasn't Reached Second Peg in 25 min		Slow	(F)

REMARKS _____

TYPE OF SOIL _____

TESTED BY B. Baker ALSO PRESENT _____

TRENCH DESIGN DATA: AVERAGE PERCOLATION TIME _____ TRENCH WIDTH _____

INLET DEPTH _____ MAXIMUM BOTTOM DEPTH _____ SQ. FT./BEDROOM _____

APPLICATION

PERCOLATION TESTING

A 517386

P _____

HOWARD COUNTY HEALTH DEPARTMENT
BUREAU OF ENVIRONMENTAL HEALTH
3525-H ELLICOTT MILLS DRIVE/ELLICOTT CITY, MARYLAND 21043
TELEPHONE: 313-2840

DISTRICT _____

DATE _____

TO: THE COUNTY HEALTH OFFICER
ELLICOTT CITY, MARYLAND

I HEREBY APPLY FOR THE NECESSARY TEST PRIOR TO APPLICATION FOR PERMIT TO CONSTRUCT (OR RECONSTRUCT) A SEWAGE DISPOSAL SYSTEM.

PROPERTY OWNER Cole Property

ADDRESS _____ PHONE _____

AGENT OR PROSPECTIVE BUYER James Jost

ADDRESS _____ PHONE (443) 535-9200

PROPERTY LOCATION:

SUBDIVISION _____ LOT NO. _____

ROAD AND DESCRIPTION 12182 Rt. 216

TAX MAP 41 PARCEL # 2

SIZE OF LOT _____ TYPE BLDG. _____
(SINGLE FAMILY DWELLING OR COMMERCIAL)

THE SYSTEM INSTALLED UNDER THIS APPLICATION IS ACCEPTABLE ONLY UNTIL PUBLIC FACILITIES BECOME AVAILABLE. I FULLY UNDERSTAND THE FEE CONNECTED WITH THE FILING OF THIS PERC TEST APPLICATION IS NON-REFUNDABLE UNDER ANY CIRCUMSTANCES. I ALSO AGREE TO COMPLY WITH ALL M.O.S.H.A. REQUIREMENTS IN TESTING THIS LOT. _____
(SIGNATURE OF APPLICANT)

APPROVED BY _____ FOR _____ DATE _____

DISAPPROVED BY _____ FOR _____ DATE _____

HOLD PENDING FURTHER TESTS _____

REASONS FOR REJECTION OR HOLDING _____

PERCOLATION TEST PLAT/PRELIMINARY PLAT - TITLE OR I.D. # _____ DATE _____

SITE DEVELOPMENT PLAN/FINAL PLAT - TITLE OR I.D. # _____ DATE _____

THIS IS NOT A PERMIT

COUNTY #

SOIL PROFILE

(134A)

Red Br and Or Br Heavy Loam
Less Than 10% Rock
6-7"

Or Br Loam
Less Than 10% Rock

Or Br Sa Loam
15-20% Rock and Saprolite

(133C)

Red Br and Or Br Loam

Or Br and Red Br Loam
~10-15% Rock
Gradually Turning to a Red Br Sa Loam
~20% Rock and Saprolite

(132D)

Red Br and Or Br Heavy Loam

Or Br Loam and Red Br Sa Loam
~20% Rock

Red Br Sa Loam
~25% Rock and Saprolite

SOIL PROFILE

(135A)

Red Br and Or Br Heavy Loam

Or Br Loam and Red Br Si Loam
Less Than 10% Rock

Red Br Sa Loam
~20% Rock and Saprolite

(135C)

Or Tan Cl Loam

Red Br Heavy Cl Loam

Red Br Si Cl Loam

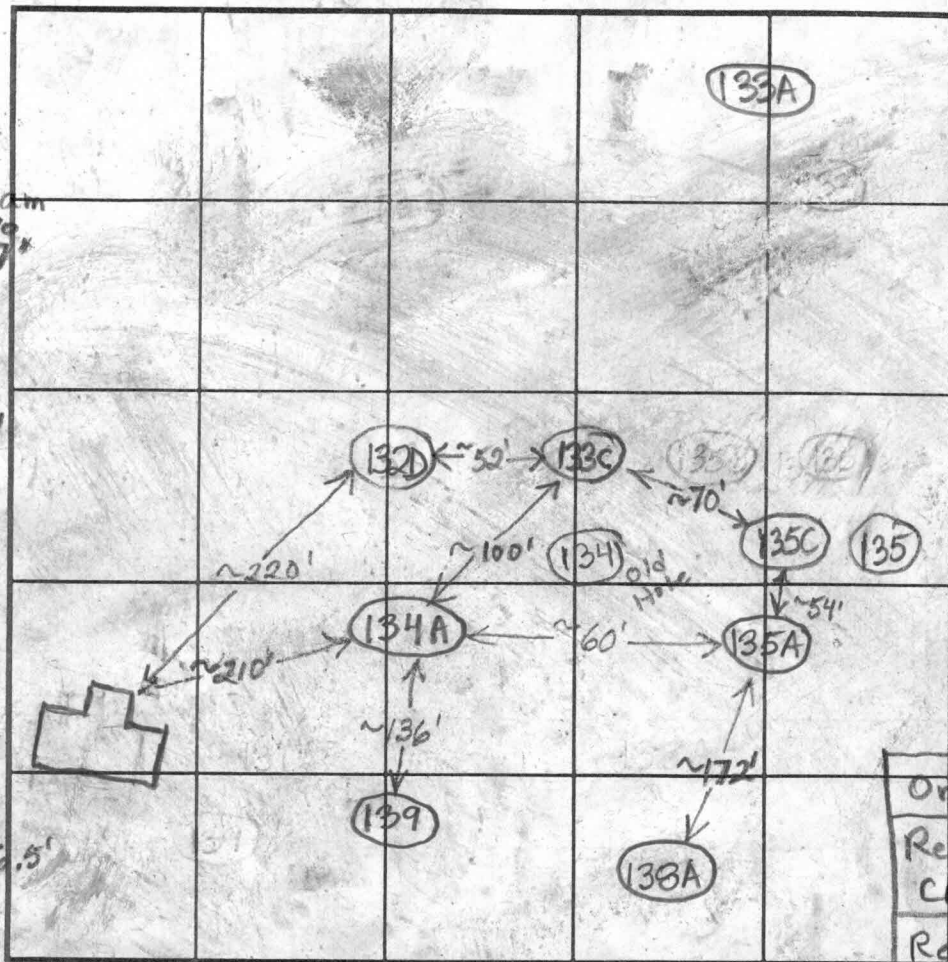

INDICATE NORTH - NAME ADJOINING ROADWAY AS BASE LINE.

DATE	TEST NO.	DEPTH	PRE-WET		TEST - 1" DROP		TIME	
			START	STOP	START	STOP		
1/31/03	134A	5' 13" V	12:14	~1/8" in 10 minutes			Slow (F)	
		6' 9"	12:12	~1/4" in 15 minutes			Slow (F)	
	133C	6' 8" 13" V	12:51	~3/8" in 17 minutes			Slow (F)	
	132D	5' 3" 13" V	12:56	~1/4" in 10 minutes			Slow OK.	
		7'	12:54	12:56:30	12:56:30	12:59	2 1/2	
	135A	6' 8" 13" V	1:11	~1/4" in 15 minutes			Slow (F)	
	135C	6' 5" 13" V	11:37	2:08	2:08	@ 2:30 1/4" in 22 min	(F)	
			Rock Content O.K. - Slow Rates					

REMARKS _____

TYPE OF SOIL _____

TESTED BY B. Baker / F. Alfonso ALSO PRESENT _____

TRENCH DESIGN DATA: AVERAGE PERCOLATION TIME _____ TRENCH WIDTH _____

INLET DEPTH _____ MAXIMUM BOTTOM DEPTH _____ SQ. FT./BEDROOM _____

COUNTY #

SOIL PROFILE

(131A)

Red Br and Or Br Heavy Loam With Gray Mottling Below 2'

Or Br Sa Loam >50% Quartz Boulders Below 7' Hard Bottom

3.5' - 5'

11.5'

(130A)

Red Br and Or Br Heavy Loam and Loams Gray Mottling Below 18" + 6.5' - 7'

Beige Sa loam ~20% Rock and Saprolite

13'4"

Dr Br Heavy Loam With Gray Mottling Below 2'
Beige and Or Br Sa Loam, 10-15% Saprolite

3.5' - 4.5'

13'

(131A)

~82'

(130A)

~42'

~112'

(131)

(132B)

(133A)

~60'

133A Stake

~88'

~45'

(133B)

~63'

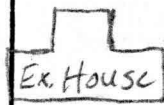

INDICATE NORTH - NAME ADJOINING ROADWAY AS BASE LINE.

SOIL PROFILE (133A)

Red Br and Or Br Heavy Loam and Loams Gray Mottling from 3.5' - 5.5'

Red Br Sa Loam ~20% Rock and Saprolite

(133B)

Red Br and Or Br Heavy Loam
Or Br Loam and Sa Loam
Red Br Sa Loam 15-20% Rock and Saprolite

3.5'

5.5'

6.5'

DATE	TEST NO.	DEPTH	PRE-WET		TEST - 1" DROP		TIME
			START	STOP	START	STOP	
1/28/03	131A	5' / 11.5' V	1:23	1:40	1:40		Slow (F)
		7'	1:22:30	1:25:30	1:25:30	1:30:30	5
	130A	4.5' / 13'4" V	1:43:40	1:59	1:59	Stopped	Slow W.S.
		6.5'	1:43:30	1:47	1:47	1:59	12
	127A	13' V	- See Profile				O.K.
	133B	6'8" / 13'4" V	3:26	3:33	3:33	3:47	14
		4'8"	3:26	~3/8" in 15 minutes			Slow
	133A	4.5' / 12' V	2:47	2:59	2:59	3:23	24 O.K.
		6'10"	2:46	2:54	2:54	3:10	16

REMARKS

TYPE OF SOIL Holes 127A, 130A + 133A May Require Wet Season Testing

TESTED BY B. Baker, F. Alfonso ALSO PRESENT

TRENCH DESIGN DATA: AVERAGE PERCOLATION TIME TRENCH WIDTH

INLET DEPTH MAXIMUM BOTTOM DEPTH SQ FT/BEDROOM

COUNTY #

SOIL PROFILE

0' (133)
 Red Br Heavy Loam
 15-20% Rock and Saprolite
 6.5'

Beige Sa Loam
 Large Vein of >50% Quartzite to Bottom
 Hard Bottom
 9.5'

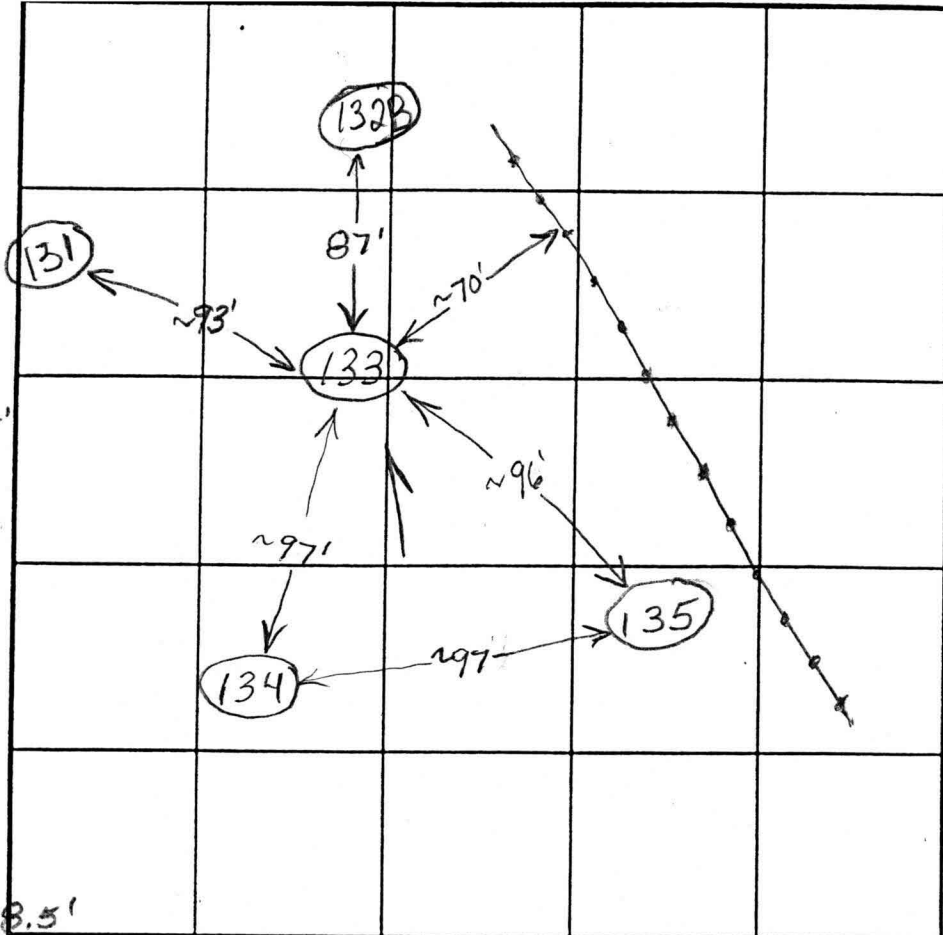

SOIL PROFILE

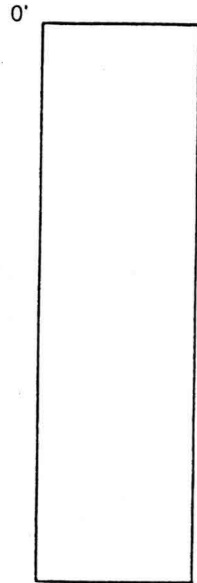

(135)
 Red Br Heavy Loam
 ~10% Rock
 7'-8.5'

Red Br Sa Loam
 15-20% Rock and Saprolite
 15'

INDICATE NORTH - NAME ADJOINING ROADWAY AS BASE LINE.

Route 216

DATE	TEST NO.	DEPTH	PRE-WET		TEST - 1" DROP		TIME
			START	STOP	START	STOP	
9/12/02	133	9.5' V	Hard Bottom				(F)
	135	7' / 15' V	11:20	11:32	11:32	~3/4" in 30 min	slow (F)
	134	5.5' / 4.5' V	11:45	11:46:30	11:46:30	11:50:15	~4" O.K.

(134)
 Red Br Heavy Loam
 4'-5'

Red Br Sa Loam
 15-20% Rock and Saprolite
 14.5'

REMARKS _____

TYPE OF SOIL _____

TESTED BY B. Baker ALSO PRESENT _____

TRENCH DESIGN DATA: AVERAGE PERCOLATION TIME _____ TRENCH WIDTH _____

INLET DEPTH _____ MAXIMUM BOTTOM DEPTH _____ SQ. FT./BEDROOM _____