

LAYOUT 2/15/02 10:00 INSP 4 \_\_\_\_\_  
 INSP 2 4/19/02 1:00 INSP 5 \_\_\_\_\_  
 INSP 3 \_\_\_\_\_ INSP 6 \_\_\_\_\_

ISSUE DATE: 9/25/01

APPROVAL DATE: 4/19/02

**PERMIT  
INDEXED**

P 516046  
516046  
 A 516046 REPAIR

**ON-SITE SEWAGE DISPOSAL SYSTEM  
 HOWARD COUNTY HEALTH DEPARTMENT  
 BUREAU OF ENVIRONMENTAL HEALTH**

**03-287238**

George Hof IS PERMITTED TO INSTALL  ALTER

ADDRESS: 13811 Frederick Road PHONE NUMBER: 410-442-7645

SUBDIVISION: Hof Property LOT NUMBER: TM 15, P 95

ADDRESS: 13811 Frederick Road PROPERTY OWNER: George Hof

SEPTIC TANK CAPACITY (GALLONS): 1250 OUTLET BAFFLE FILTER REQUIRED

PUMP CHAMBER CAPACITY (GALLONS): 1250 COMPARTMENTED TANK REQUIRED

NUMBER OF BEDROOMS: 4

SQUARE FEET PER BEDROOM: 210

LINEAR FEET OF TRENCH REQUIRED: 96

TRENCHES: <i>OK MR 8.5'</i>	Trench to be 2.0 feet wide. Inlet 4.0 feet below original grade. Bottom maximum depth 8.0 feet below original grade. Effective area begins at 4.0 feet below original grade. 4.0 feet of stone below distribution pipe.
LOCATION:	Install the trench 15' uphill of the existing trench, or approximately 135' from the closest corner of the house under construction. Run the trench on level ground to opposite side of lot.
NOTES:	****PUMPED SEPTIC SYSTEM**** Install septic tanks 35' behind house and at least 100' from existing well.

PLANS APPROVED: MER DATE: 2/8/02

- NOTE: PERMIT VOID AFTER 2 YEARS
- NOTE: CONTRACTOR RESPONSIBLE FOR SCHEDULING A PRE-CONSTRUCTION INSPECTION FOR ALL INSTALLATIONS
- NOTE: WATERTIGHT SEPTIC TANKS REQUIRED
- NOTE: ALL PARTS OF SEPTIC SYSTEM SHALL BE 100 FEET FROM ANY WATER WELL
- NOTE: MANHOLE RISERS REQUIRED ON ALL SEPTIC TANKS AND PUMP CHAMBERS UNLESS SPECIFICALLY AUTHORIZED

**NEITHER THE HOWARD COUNTY COUNCIL NOR THE HEALTH DEPARTMENT IS  
 RESPONSIBLE FOR THE SUCCESSFUL OPERATION OF ANY SYSTEM  
 PERMITTEE RESPONSIBLE FOR OBTAINING FINAL APPROVAL ON THIS PERMIT  
 ALL 410-313-2640 FOR INSPECTION OF SEPTIC SYSTEM**

A516046

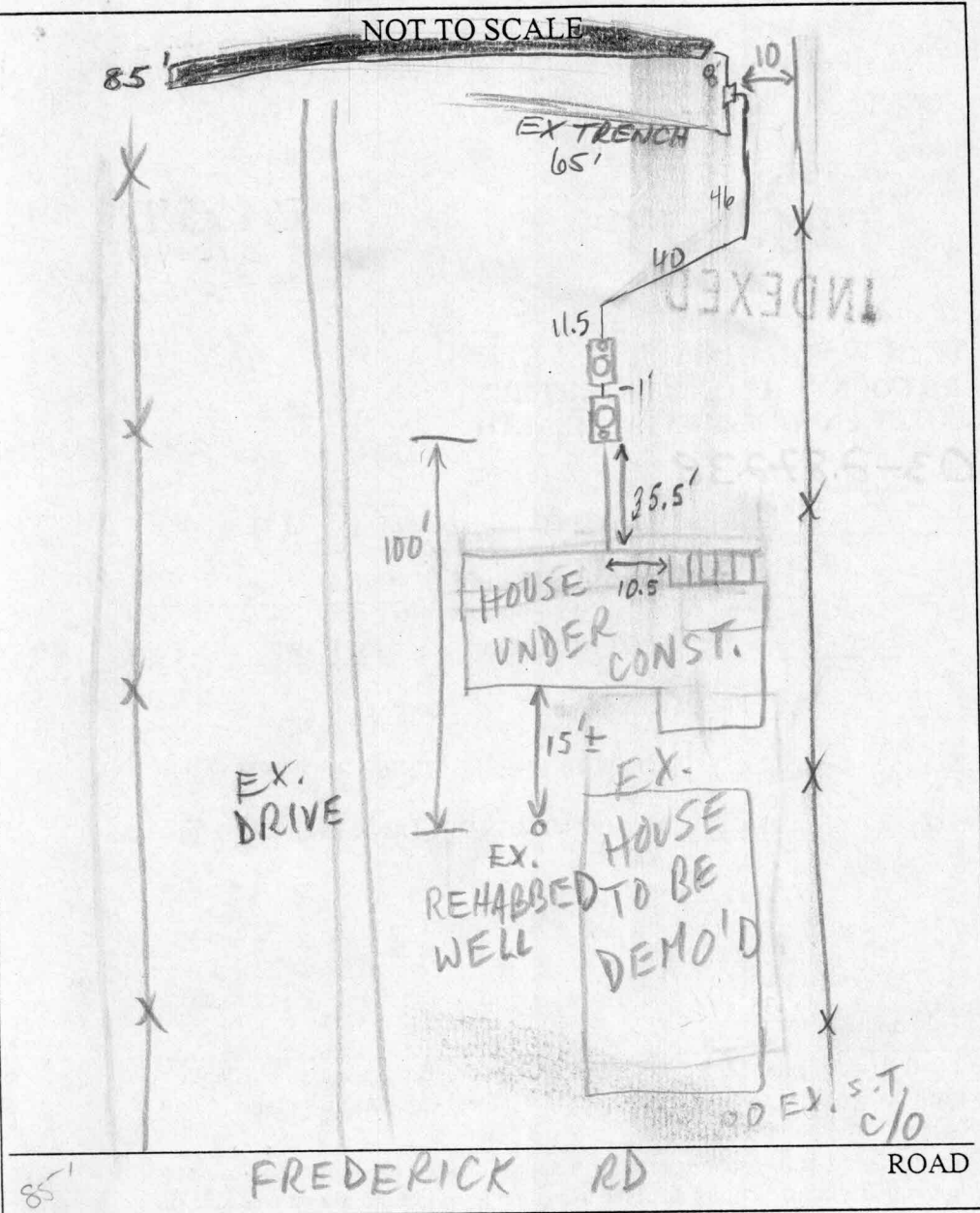

TRENCH/DRAINFIELD DATA		
WIDTH	INLET	BOTTOM
2'	4'	8 1/2'
NUMBER OF TRENCHES		2
TOTAL LENGTH		150
ABSORPTION AREA		675 sq ft
DISTRIBUTION BOX LEVEL		YES
DISTRIBUTION BOX BAFFLE		Y
DISTRIBUTION BOX PORT		Y

SEPTIC TANK DATA	
SEPTIC TANK 1 LEVEL	<input checked="" type="checkbox"/>
CAPACITY	1250 GAL
SEAM LOC	TOP
TANK LID DEPTH	18"
BAFFLES	<input checked="" type="checkbox"/>
BAFFLE FILTER	-
MANHOLE LOC	CTR
6" PORT LOC	FRONT
WATERTIGHT TEST	-
SEPTIC TANK 2 LEVEL	<input checked="" type="checkbox"/>
CAPACITY	1250 GAL
SEAM LOC	TOP
TANK LID DEPTH	18"
BAFFLES	<input checked="" type="checkbox"/>
BAFFLE FILTER	<input checked="" type="checkbox"/>
MANHOLE LOC	CTR
6" PORT LOC	REAR
WATERTIGHT TEST	-

PRE-CONSTRUCTION \_\_\_\_\_

INSTALLATION 2-15-02 OK TO COVER WORK. Need pump inspection for final. (KB) 4/19/02 Pump & Alum tests OK (KB)

FINAL INSPECTOR John D... DATE OF APPROVAL 4/19/02

SITE INSPECTION SHEET

OWNER: Lisa Hof 410 442 5845  
442-7645

DATE REQUESTED: 4/25/01

ADDRESS: 13811 Rt. 144

DRILLER/CONTRACTOR: \_\_\_\_\_

TAX & PARCEL: \_\_\_\_\_

WELL TAG NUMBER: \_\_\_\_\_

COUNTY: \_\_\_\_\_

PROPOSAL: Demolish existing building - rebuild new home

Letter (request <sup>well</sup> protection measures)  
labs  
test fee  
cont.  
seq. of events  
list

LOCATION DIAGRAM

32  
65  
75  
325  
4550  
487.

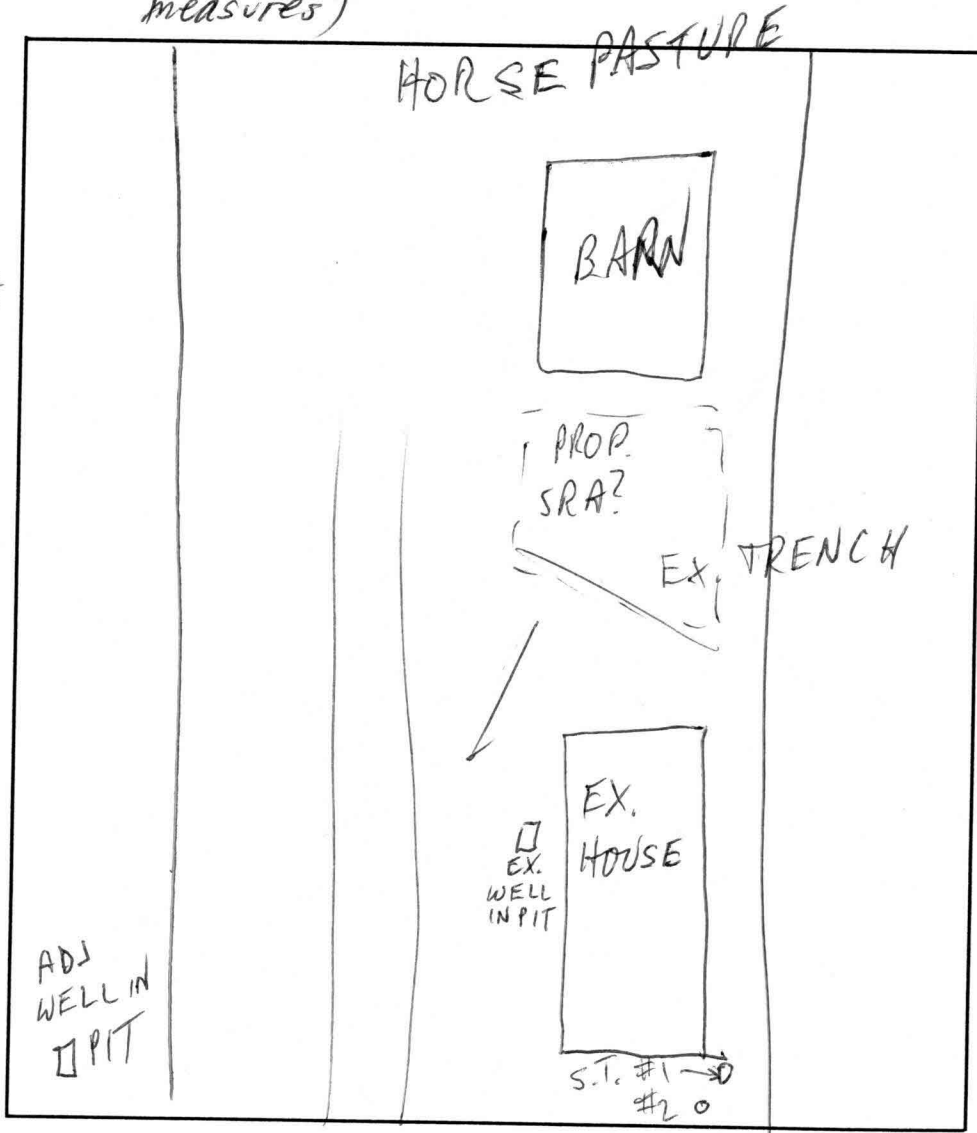

COMMENTS: \_\_\_\_\_

\_\_\_\_\_

\_\_\_\_\_

\_\_\_\_\_

DATE: \_\_\_\_\_

INSPECTOR: \_\_\_\_\_