

PUB. SEWER STATUS VERIFIED BY OK per SRK

03-286584

ISSUE DATE: 5/21/2002

P 516985-A

APPROVAL DATE: 6/11/02

# PERMIT

A REPAIR

## ON-SITE SEWAGE DISPOSAL SYSTEM HOWARD COUNTY HEALTH DEPARTMENT BUREAU OF ENVIRONMENTAL HEALTH

### INDEXED

Jack Fyock Septic Service

IS PERMITTED TO INSTALL  ALTER

ADDRESS: PO Box 89, Glenelg

PHONE NUMBER: 410-988-9270

SUBDIVISION: \_\_\_\_\_

LOT NUMBER: \_\_\_\_\_

ADDRESS: 11434 Frederick Road

PROPERTY OWNER: Hector Aguiniga

SEPTIC TANK CAPACITY (GALLONS): \_\_\_\_\_

PUMP CHAMBER CAPACITY (GALLONS): \_\_\_\_\_

NUMBER OF BEDROOMS: 4

SQUARE FEET PER BEDROOM: 180

LINEAR FEET OF TRENCH REQUIRED: 144

TRENCHES:	Trench to be <u>2</u> feet wide. Inlet <u>4.5'</u> feet below original grade. Bottom maximum depth <u>9.5'</u> feet below original grade. Effective area begins at <u>4.5</u> feet below original grade. <u>5.0</u> feet of stone below distribution pipe.
LOCATION:	Existing septic system is failing. Call for inspection when ground is opened.
PURPOSE:	

PLANS APPROVED: \_\_\_\_\_

DATE: 4/22/02

NOTE: PERMIT VOID AFTER 2 YEARS

NOTE: CONTRACTOR RESPONSIBLE FOR SCHEDULING A PRE-CONSTRUCTION INSPECTION FOR ALL INSTALLATIONS

NOTE: WATERTIGHT SEPTIC TANKS REQUIRED

NOTE: ALL PARTS OF SEPTIC SYSTEM SHALL BE 100 FEET FROM ANY WATER WELL

NOTE: MANHOLE RISERS REQUIRED ON ALL SEPTIC TANKS AND PUMP CHAMBERS

**NEITHER THE HOWARD COUNTY COUNCIL NOR THE HEALTH DEPARTMENT IS RESPONSIBLE FOR THE SUCCESSFUL OPERATION OF ANY SYSTEM PERMITTEE RESPONSIBLE FOR OBTAINING FINAL APPROVAL ON THIS PERMIT CALL 410-313-2640 FOR INSPECTION OF SEPTIC SYSTEM**

A516985-A

NOT TO SCALE

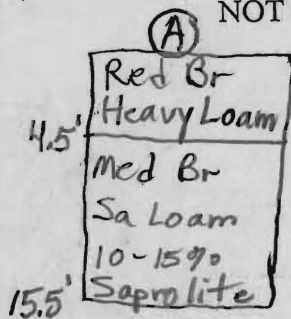

INDEXED

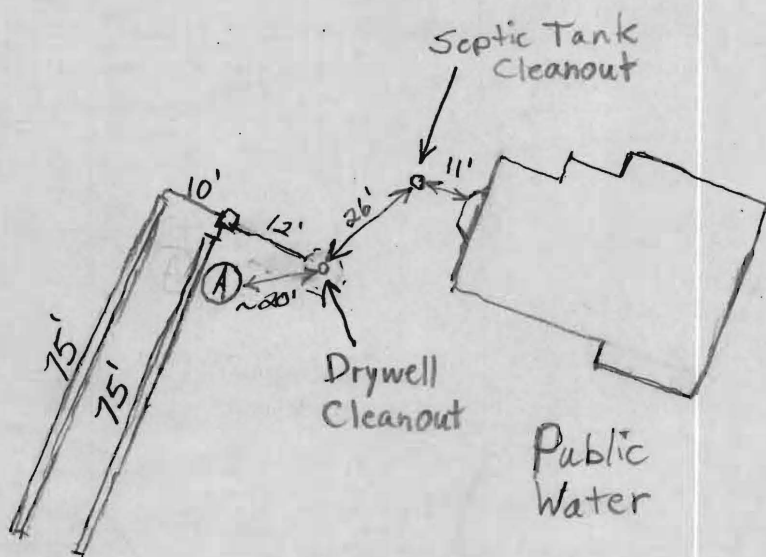

Route 144

ROAD

TRENCH/DRAINFIELD DATA		
WIDTH	INLET	BOTTOM
2.0	4.5	9.5
NUMBER OF TRENCHES		2
TOTAL LENGTH		150
ABSORPTION AREA		750 sq ft
DISTRIBUTION BOX LEVEL		
DISTRIBUTION BOX BAFFLE		
DISTRIBUTION BOX PORT		

SEPTIC TANK DATA	
SEPTIC TANK 1 LEVEL	Existing
CAPACITY	? GAL
SEAM LOC	
TANK LID DEPTH	
BAFFLES	
BAFFLE FILTER	
MANHOLE LOC	
6" PORT LOC	
WATERTIGHT TEST	
SEPTIC TANK 2 LEVEL	N/A
CAPACITY	GAL
SEAM LOC	
TANK LID DEPTH	
BAFFLES	
BAFFLE FILTER	
MANHOLE LOC	
6" PORT LOC	
WATERTIGHT TEST	

PRE-CONSTRUCTION 6/10/02 To place distribution box off of drywell and run 2 trenches towards Rt. 144. (BB)

INSTALLATION 6/11/02 System satisfactory. O.K. to cover all work. (SO) BB

FINAL INSPECTOR Stuart Oster

DATE OF APPROVAL 6/11/02

BB