

HOWARD COUNTY PERMIT APPLICATION

PERMIT NUMBER
 300126269

Building Address 14308 Fox Creek Ct.
Cooksville, MD 21723 21723 2163
Woodstock
 Suite/Apt. #: _____ SDP/WP/Petition #: _____
 Census Tract 6046 Subdivision Monticello
 Section _____ Area _____ Lot 29
 Tax Map 8 Parcel 110 Grid 18
 Zoning RC Map Coordinates 410 Lot size 1.131 AC

Property Owner's Name D.R. HORTON CUSTOM HOMES
 Address 1370 PICCALD DR, ST 230
 City Rockville State MD Zip Code 20850
 Home Phone _____ Work Phone _____
 Applicant's Name & Mailing Address, (if other than stated hereon):
Vicky Meyer
MD Bldg. Permits, Inc.
 Phone 410-602-8779 Fax _____

Existing Use Vacant lot
 Proposed Use New Single Fam. Dwell.
 Estimated Construction Cost \$ 250,000 w/ SWARM opt.
 Description of Work Somerset w/fin L/C
2 stories, full BSMT, 11R, 3FB,
1 HB, FP & 3CA1 & 1A2 (14BR)

Contractor Company D.R. Horton Custom Homes
 Contact Person Vicky Meyer
 Address 1370 PICCALD DR, ST. 230
 City Rockville State MD Zip Code 20850
 License No. _____
 Phone 301-670-6144 Fax _____

Occupant or Tenant See Property Owner
 Contact Name _____
 Address _____
 City _____ State _____ Zip Code _____
 Phone _____ Fax _____

Engineer or Architect Company SEARCHMARK LLC
 Contact Person Juan CAINCY
 Address 8480 BATH NATIONAL PK.
 City Ellicott City State MD Zip Code 21043
 Phone 465-6105 Fax _____

BUILDING DESCRIPTION - COMMERCIAL

Building Characteristics	Utilities
Height: _____	Water Supply: <input type="checkbox"/> Public <input type="checkbox"/> Private
No. of stories: _____	Sewage Disposal: <input type="checkbox"/> Public <input type="checkbox"/> Private
Gross area, sq. ft. per floor: _____	Electric Yes <input type="checkbox"/> No <input type="checkbox"/> Gas Yes <input type="checkbox"/> No <input type="checkbox"/>
Use group: _____	Heating System: <input type="checkbox"/> Electric <input type="checkbox"/> Oil <input type="checkbox"/> <input type="checkbox"/> Natural Gas <input type="checkbox"/> <input type="checkbox"/> Propane Gas <input type="checkbox"/>
Construction type: <input type="checkbox"/> Reinforced Concrete <input type="checkbox"/> Structural Steel <input type="checkbox"/> Masonry <input type="checkbox"/> Wood Frame <input type="checkbox"/> State Certified Modular	Sprinkler system: <u>N/A</u> <input type="checkbox"/> <input type="checkbox"/> Full <input type="checkbox"/> Partial <input type="checkbox"/> Other Suppression <input type="checkbox"/> # of Heads _____

BUILDING DESCRIPTION - RESIDENTIAL

Building Characteristics	Utilities
SF Dwelling <input type="checkbox"/> SF Townhouse <input type="checkbox"/> Depth _____ Width _____ 1st floor: <u>80</u> <u>52</u> 2nd floor: <u>80</u> <u>46</u> Basement: <u>60</u> <u>52</u> Finished Basement <input type="checkbox"/> Unfinished Basement <input type="checkbox"/> Crawl space <input type="checkbox"/> Slab on Grade <input type="checkbox"/> No. of Bedrooms <u>4</u>	Water Supply: <input type="checkbox"/> Public <input checked="" type="checkbox"/> Private Sewage Disposal: <input type="checkbox"/> Public <input checked="" type="checkbox"/> Private Electric Yes <input type="checkbox"/> No <input type="checkbox"/> Gas Yes <input type="checkbox"/> No <input type="checkbox"/>
Multi-family dwellings: No. of efficiency units: _____ No. of 1 BR units: _____ No. of 2 BR units: _____ No. of 3 BR units: _____	Heating System: <input type="checkbox"/> Electric <input type="checkbox"/> Oil <input type="checkbox"/> <input type="checkbox"/> Natural Gas <input type="checkbox"/> <input type="checkbox"/> Propane Gas <input type="checkbox"/>
Other Structure: _____ Dimensions: <u>20' x 80'</u> Footings: _____ Roof: _____ <input type="checkbox"/> State Certified Modular <input type="checkbox"/> Manufactured Home	Sprinkler system: <u>N/A</u> <input type="checkbox"/> <input type="checkbox"/> NFPA #13D <input type="checkbox"/> NFPA #13R <input type="checkbox"/> Other: _____

THE UNDERSIGNED HEREBY CERTIFIES AND AGREES AS FOLLOWS: (1) THAT HE/SHE IS AUTHORIZED TO MAKE THIS APPLICATION; (2) THAT THE INFORMATION IS CORRECT; (3) THAT HE/SHE WILL COMPLY WITH ALL REGULATIONS OF HOWARD COUNTY WHICH ARE APPLICABLE THERETO; (4) THAT HE/SHE WILL PERFORM NO WORK ON THE ABOVE REFERENCED PROPERTY NOT SPECIFICALLY DESCRIBED IN THIS APPLICATION; (5) THAT HE/SHE GRANTS COUNTY OFFICIALS THE RIGHT TO ENTER ONTO THIS PROPERTY FOR THE PURPOSE OF INSPECTING THE WORK PERMITTED AND POSTING NOTICES.

Applicant's Signature Victoria Meyer
 Title/Company _____

Print Name Victoria Meyer
 Date 8/31/00 9/1/2000

Checks payable to: DIRECTOR OF FINANCE OF HOWARD COUNTY
 ** PLEASE WRITE NEATLY AND LEGIBLY. **
 - FOR OFFICE USE ONLY -

AGENCY	DATE	SIGNATURE APPROVAL
Land Development, DPZ		
State Highways		
Building Official		
Dev. Engineering, DPZ	<u>9/12/00</u>	<u>Mark Riffkin</u>
Health		
Fire Protection		

Is Sediment Control approval required prior to issuance?
 YES NO

SETBACK INFORMATION

Front: _____
 Rear: _____
 Side: 2.700
 Side St.: _____
 All minimum setbacks met?
 YES NO
 Is Entrance Permit required?
 YES NO
 Historic District?
 YES NO
 Lot Coverage for New Town Zone _____
 SDP/Red-line approval date _____

PROPERTY ID#: 117 927

Filing fee	\$ _____
Permit fee	\$ _____
Excise tax	\$ _____
Sub-total paid	\$ _____
Add'l permit fee	\$ _____
TOTAL FEES	\$ _____
Balance due	\$ <u>460456</u>
Check	# _____
Validation	# _____

CONTINGENCY CONSTRUCTION START:
 ONE STOP SHOP:

Distribution of Copies- White: Building Official Green: LDD, DPZ Yellow: DED, DPZ Pink: Health Gold: SHA

Total linear feet of trench required 240 feet
 Width of trench(es) 2 feet
 Depth of trench(es) 6-5 feet
 Depth of stone required below distribution pipe 3 feet

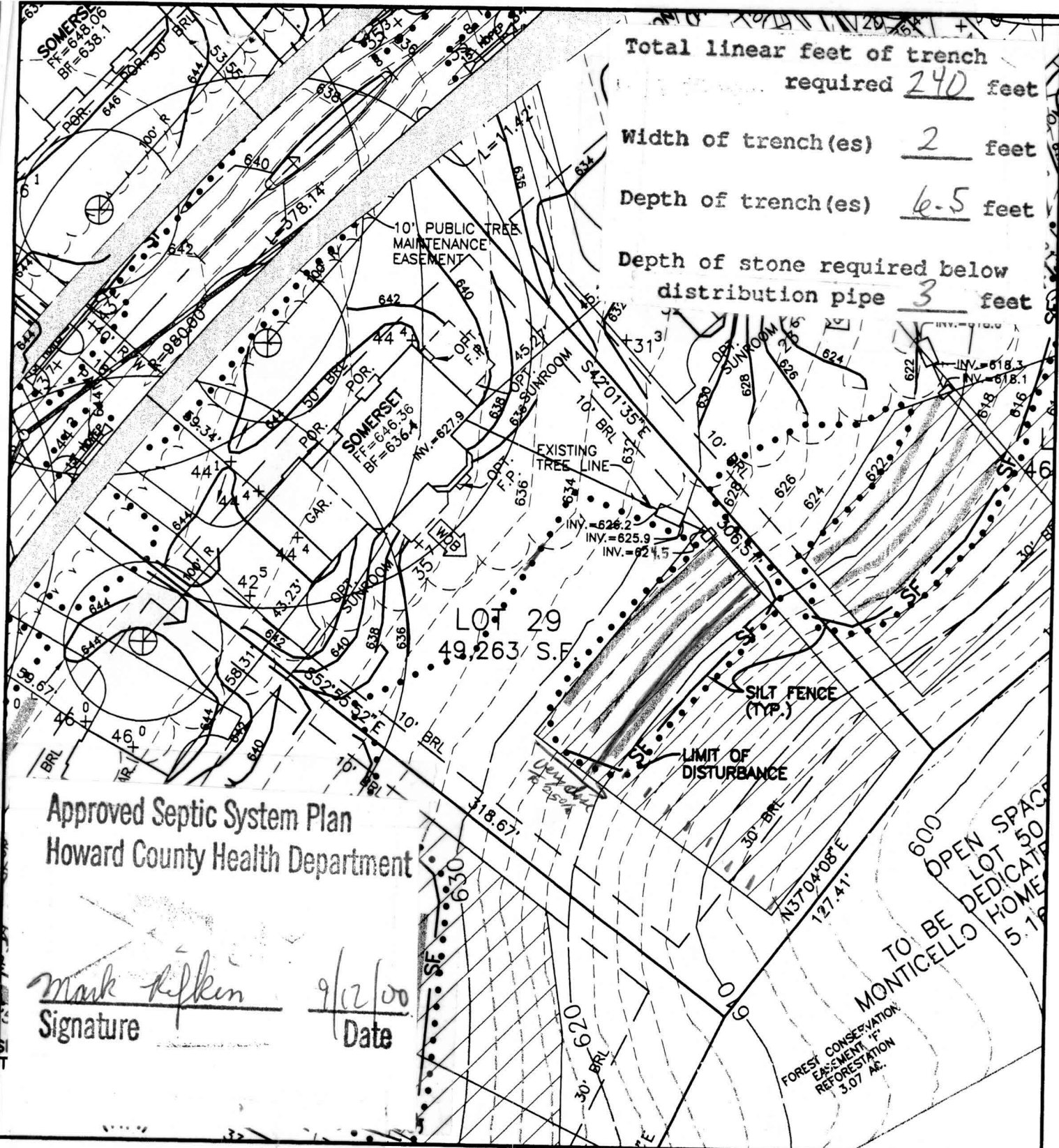

Approved Septic System Plan
 Howard County Health Department

Mark Kiffin
 Signature 9/12/00
 Date

FIRST FLOOR ELEVATION = 646.36
 BASEMENT ELEVATION = 635.4
 SPOT ELEVATION AT GARAGE = 644.4

SLOPE OF DRIVEWAY = N/A
 NUMBER OF RISERS IN GAR. = 3
 NUMBER OF RISERS ON LEAD WALK = 3

BENCHMARK
 ENGINEERS • LAND SURVEYORS • PLANNERS
ENGINEERING, INC.

8480 BALTIMORE NATIONAL PIKE • SUITE 418 • ELLICOTT CITY, MD 21043
 PHONE: 410-465-6105 FAX: 410-465-6644

MONTICELLO
 LOT 29 - REVISED

FOURTH ELECTION DISTRICT
 HOWARD COUNTY, MARYLAND
 SCALE: 1" = 50' DATE: 8/21/00