

11/27/01

10:00

ISSUE DATE: 10/18/2001

PERMIT

P 516074

APPROVAL DATE: 11/27/01

A REPAIR

INDEXED

ON-SITE SEWAGE DISPOSAL SYSTEM HOWARD COUNTY HEALTH DEPARTMENT BUREAU OF ENVIRONMENTAL HEALTH

04-329201

Arnold's Backhoe & Septic Service, Inc IS PERMITTED TO INSTALL ALTER

ADDRESS: P.O. Box 15, Woodbine 21797 PHONE NUMBER: 410-795-7873

SUBDIVISION: _____ LOT NUMBER: _____

ADDRESS: 2900 Florence Road PROPERTY OWNER: Rita Bruin

SEPTIC TANK CAPACITY (GALLONS): ex 1000
PUMP CHAMBER CAPACITY (GALLONS): N/A
Mary Ellen Putnam (buyer)

NUMBER OF BEDROOMS: 4 w/ADD'N

SQUARE FEET PER BEDROOM: 210 TOTAL 840 - 500 = 340 REQ'D

LINEAR FEET OF TRENCH REQUIRED: 70

TRENCHES:	Trench to be <u>2</u> feet wide. Inlet <u>4</u> feet below original grade. Bottom maximum depth <u>9</u> feet below original grade. Effective area begins at <u>4</u> feet below original grade. <u>5</u> feet of stone below distribution pipe.
LOCATION:	
PURPOSE:	To determine potential for repair in support of building permit. Call when ground is opened so sanitarian can recommend repair.

PLANS APPROVED: Mark Rifkin DATE: 10/17/01

- NOTE: PERMIT VOID AFTER 2 YEARS
- NOTE: CONTRACTOR RESPONSIBLE FOR SCHEDULING A PRE-CONSTRUCTION INSPECTION FOR ALL INSTALLATIONS
- NOTE: WATERTIGHT SEPTIC TANKS REQUIRED
- NOTE: ALL PARTS OF SEPTIC SYSTEM SHALL BE 100 FEET FROM ANY WATER WELL
- NOTE: MANHOLE RISERS REQUIRED ON ALL SEPTIC TANKS AND PUMP CHAMBERS

11/27/01
00133209 removed for + ADD

NEITHER THE HOWARD COUNTY COUNCIL NOR THE HEALTH DEPARTMENT IS RESPONSIBLE FOR THE SUCCESSFUL OPERATION OF ANY SYSTEM PERMITTEE RESPONSIBLE FOR OBTAINING FINAL APPROVAL ON THIS PERMIT CALL 410-313-2640 FOR INSPECTION OF SEPTIC SYSTEM

*ABDent
FRM*

516074

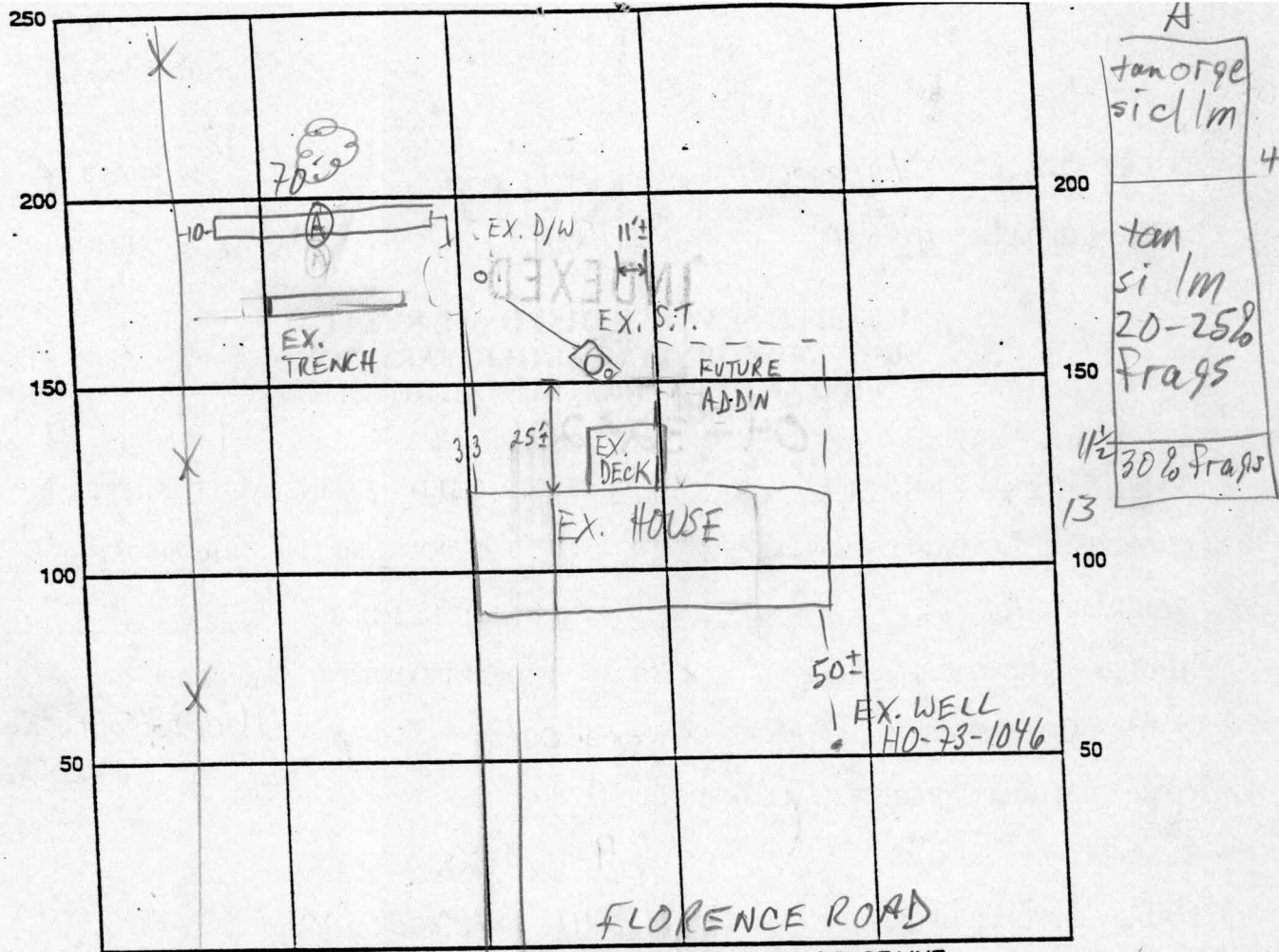

INDICATE NORTH - NAME ADJOINING ROADWAY AS BASE LINE

SEPTIC TANK LEVEL EX. 1000 GAL - OK

CLEANOUTS EX. 6" @ S.T.; NEW MH @ S.T.

REMARKS: 11/27/01 TR. BOT 9 WIDTH 2 INLET 4

GRAVEL DEPTH 5' LENGTH 70'

TOTAL CAPACITY 350 + 500 ± (EX. SYS.) = 840

OK TO COVER (MR)

DATE SYSTEM APPROVED 11/27/01

INSPECTOR M. Riffkin