

7/23/02 1 p.m. LAYOUT

PUB. SEWER STATUS VERIFIED BY SRK-NA

515291-A  
P 517000-A  
A REPAIR

ISSUE DATE: 6/3/2002

# PERMIT INDEXED

APPROVAL DATE: 7/23/02

## ON-SITE SEWAGE DISPOSAL SYSTEM HOWARD COUNTY HEALTH DEPARTMENT BUREAU OF ENVIRONMENTAL HEALTH 03-284115

Fogles Septic Clean, Inc IS PERMITTED TO INSTALL  ALTER

ADDRESS: 580 Obrecht Road, Sykesville PHONE NUMBER: 410-795-5670

SUBDIVISION: Green Henge LOT NUMBER: 34

ADDRESS: 2893 Evergreen Way PROPERTY OWNER: John Galick

SEPTIC TANK CAPACITY (GALLONS): new 1000

PUMP CHAMBER CAPACITY (GALLONS): NA

NUMBER OF BEDROOMS: 3

SQUARE FEET PER BEDROOM: NA

LINEAR FEET OF TRENCH REQUIRED: NA

TRENCHES:	Trench to be _____ feet wide. Inlet _____ feet below original grade. Bottom maximum depth _____ feet below original grade. Effective area begins at _____ feet below original grade. _____ feet of stone below distribution pipe.
LOCATION:	In support of building permit. Call for inspection when ground is opened.
PURPOSE:	ABANDON EXISTING S.T. & REPLACE W/ NEW ONE 10' FROM FAMILY ROOM. RE-PIPE EX. SYSTEM.

PLANS APPROVED: \_\_\_\_\_ DATE: 4/22/02

- NOTE: PERMIT VOID AFTER 2 YEARS
- NOTE: CONTRACTOR RESPONSIBLE FOR SCHEDULING A PRE-CONSTRUCTION INSPECTION FOR ALL INSTALLATIONS
- NOTE: WATERTIGHT SEPTIC TANKS REQUIRED
- NOTE: ALL PARTS OF SEPTIC SYSTEM SHALL BE 100 FEET FROM ANY WATER WELL
- NOTE: MANHOLE RISERS REQUIRED ON ALL SEPTIC TANKS AND PUMP CHAMBERS

**NEITHER THE HOWARD COUNTY COUNCIL NOR THE HEALTH DEPARTMENT IS RESPONSIBLE FOR THE SUCCESSFUL OPERATION OF ANY SYSTEM PERMITTEE RESPONSIBLE FOR OBTAINING FINAL APPROVAL ON THIS PERMIT CALL 410-313-2640 FOR INSPECTION OF SEPTIC SYSTEM**

515291-A

NOT TO SCALE

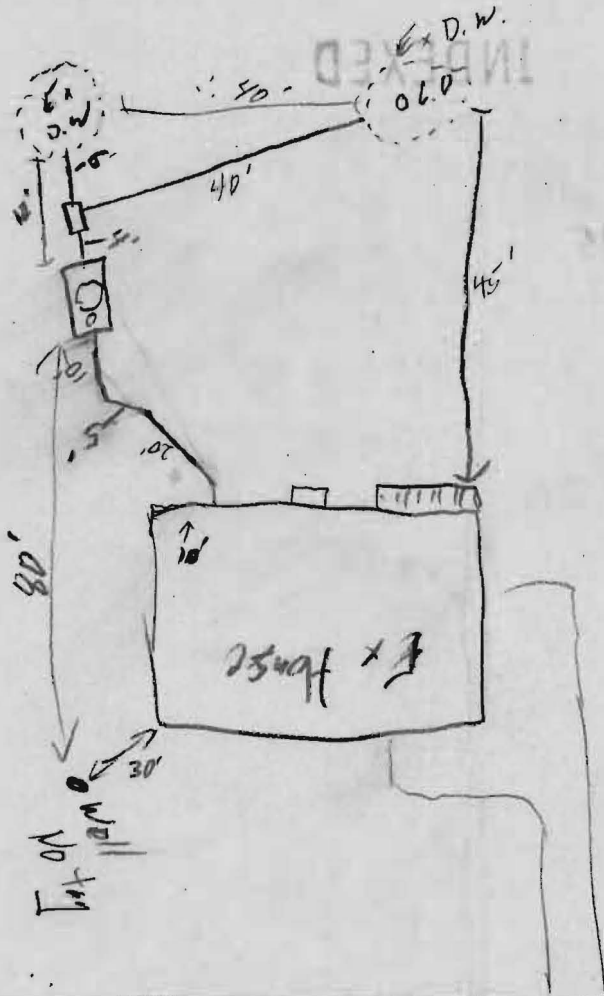

*Evergreen Way*

ROAD

**TRENCH/DRAINFIELD DATA**

WIDTH	INLET	BOTTOM
_____	_____	_____

NUMBER OF TRENCHES \_\_\_\_\_

TOTAL LENGTH \_\_\_\_\_

ABSORPTION AREA \_\_\_\_\_

DISTRIBUTION BOX LEVEL \_\_\_\_\_

DISTRIBUTION BOX BAFFLE \_\_\_\_\_

DISTRIBUTION BOX PORT \_\_\_\_\_

**SEPTIC TANK DATA**

SEPTIC TANK 1 LEVEL

CAPACITY 1250 GAL

SEAM LOC Top

TANK LID DEPTH 4.5'

BAFFLES

BAFFLE FILTER \_\_\_\_\_

MANHOLE LOC Crater

6" PORT LOC Front

WATERTIGHT TEST

SEPTIC TANK 2 LEVEL \_\_\_\_\_

CAPACITY \_\_\_\_\_ GAL

SEAM LOC \_\_\_\_\_

TANK LID DEPTH \_\_\_\_\_

BAFFLES N/A

BAFFLE FILTER \_\_\_\_\_

MANHOLE LOC \_\_\_\_\_

6" PORT LOC \_\_\_\_\_

WATERTIGHT TEST \_\_\_\_\_

PRE-CONSTRUCTION \_\_\_\_\_

INSTALLATION 7/23/02 OK to cover all work (SC)

FINAL INSPECTOR *[Signature]*

DATE OF APPROVAL 7/23/02