

6/20/01
10:00

PERMIT

SEWAGE DISPOSAL SYSTEM
HOWARD COUNTY HEALTH DEPARTMENT
BUREAU OF ENVIRONMENTAL HEALTH
410-313-2640

P 515291-A

A REPAIR

ISSUE DATE 6/13/01

APPROVAL DATE 6/20/01

INDEXED

Fogles Septic Clean, Inc. IS PERMITTED TO INSTALL ALTER X

ADDRESS 580 Obrecht Road, Sykesville, Md. 21797 PHONE 410-795-5670

SUBDIVISION Green Henge ~~Evergreen Valley Est.~~ LOT NUMBER 34 ADDRESS 2893 Evergreen Way

PROPERTY OWNER John Galik PROPERTY OWNER'S ADDRESS "

SEPTIC TANK CAPACITY ex: 1000 GALLONS " " PHONE # = 410-988-9319

PUMP CHAMBER CAPACITY NA GALLONS

NUMBER OF BEDROOMS 3

SQUARE FEET PER BEDROOM _____

LINEAR FEET OF TRENCH REQUIRED NA

TRENCHES: Trenches to be _____ feet wide. Inlet _____ feet below original grade. Bottom maximum depth _____ feet below original grade. _____ feet of stone below distribution box.

LOCATION: _____

REPAIR-PURPOSE- for drywell-collapsing
Call for inspection when ground is opened so sanitarian can recommend repair. 3/15/2001

DRYWELL REHABILITATION (SEE REVERSE)

PLANS APPROVED Steven R. Krieg DATE 6/21/01

PERMIT VOID AFTER 2 YEARS

NOTE: CONTRACTOR RESPONSIBLE FOR SCHEDULING A PRE-CONSTRUCTION INSPECTION FOR ALL INSTALLATIONS

NOTE: TOP OF SEPTIC TANKS ARE TO BE NO DEEPER THAN 3.0 FEET BELOW FINISH GRADE

NOTE: WATERTIGHT SEPTIC TANKS REQUIRED

NOTE: CLEANOUT REQUIRED EVERY 70 FEET OF SEWER LINE AND/OR AT 90° SWEEPS IN LINES FROM HOUSE TO DRAIN FIELDS, 90° ELBOWS ARE NOT ACCEPTABLE

NOTE: ALL PARTS OF SEPTIC SYSTEMS (I.E. TANK, DISTRIBUTION BOX, DRAINFIELDS) TO BE 100 FEET FROM ANY WATER WELL UNLESS OTHERWISE SPECIFICALLY AUTHORIZED

NOTE: NO ABSORPTION TRENCH TO EXCEED 100 FEET IN LENGTH UNLESS SPECIFICALLY AUTHORIZED

NOTE: ALL PIPE FROM HOUSE TO SEPTIC TANK MUST BE CAST IRON OR SCHEDULE 35/40 PVC OR ABS

NOTE: MANHOLE RISERS REQUIRED ON ALL SEPTIC TANKS AND PUMP CHAMBERS

NOTE: DISTRIBUTION BOXES MUST HAVE BAFFLES

NOTE: IF PUMPED SEPTIC SYSTEM REQUIRED, (1) SEPTIC PUMP DETAIL TO BE PROVIDED BY INSTALLER PRIOR TO ISSUANCE OF SEPTIC PERMIT (2) PUMP PERFORMANCE TEST IS NECESSARY PRIOR TO HEALTH DEPARTMENT APPROVAL OF SEPTIC PERMIT

NEITHER THE HOWARD COUNTY COUNCIL NOR THE HEALTH DEPARTMENT IS RESPONSIBLE FOR THE SUCCESSFUL OPERATION OF ANY SYSTEM
PERMITTEE RESPONSIBLE FOR OBTAINING FINAL APPROVAL ON THIS PERMIT
CALL 410-313-2640 FOR INSPECTION OF SEPTIC SYSTEM

P515291-A

Drywell lid

Solid SCH 40

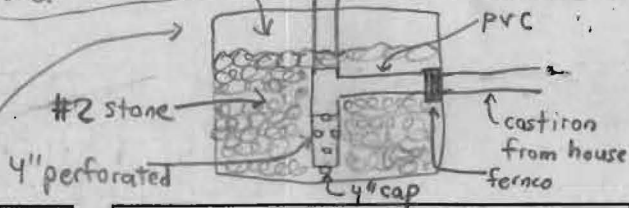

NOT TO SCALE

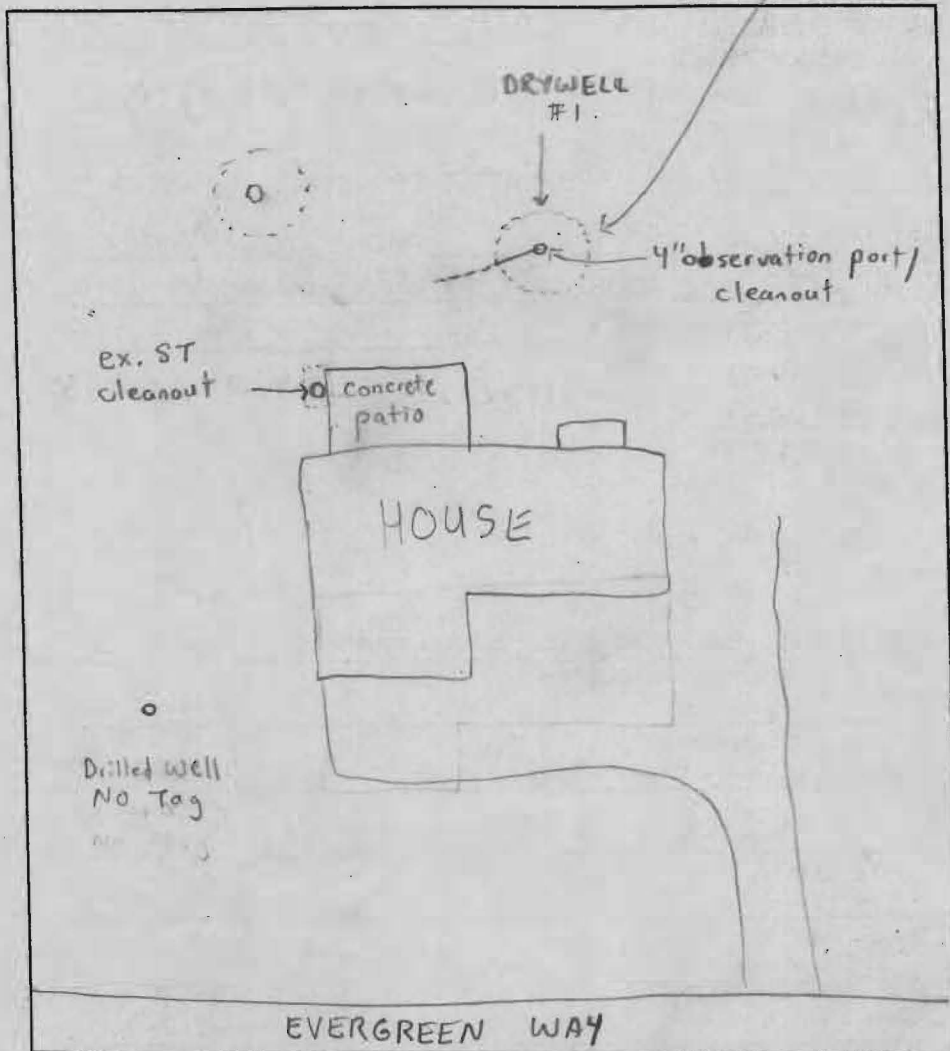

TRENCH DATA

TRENCH WIDTH	NA
TRENCH INLET DEPTH	NA
TRENCH BOTTOM DEPTH	NA
DEPTH OF STONE	NA
NUMBER OF TRENCHES	NA
TOTAL TRENCH LENGTH	NA
ABSORBENT AREA	NA
DISTRIBUTION BOX LEVEL	NA
BAFFLE IN DISTRIBUTION BOX	NA

SEPTIC TANK DATA

SEPTIC TANK	^{existing} 1000	GALLONS
MANHOLE RISER	NO	
6 INCH INSPECTION PORT	^{existing} Terracotta	

PUMP CHAMBER DATA

PUMP CHAMBER GALLONS	NA
MANHOLE RISER	NA
ALARM	NA
PUMP PERFORMANCE TEST	NA

PRE-CONSTRUCTION INSPECTION: 6/20/01 - EX. DRYWELL EXCAVATED, LIDS SLIGHTLY COLLAPSED, SEWAGE LEVEL ABOUT 14" ABOVE DRYWELL BOTTOM, OWNER WOULD RATHER TRY TO REHABILITATE DRYWELL BY PUMPING, FILLING WITH #2 STONE AND PLACING 4" PERFORATED PIPE IN CENTER TO HELP SERVE AS A MONITORING PIPE/DISTRIBUTION PIPE - THIS ARRANGEMENT ACCEPTABLE (SRK)
 INSPECTION COMMENTS: 6/20/01 - (DRYWELL ONLY) 5' DEEP (MEASURED FROM LID TO BOTTOM OF DRYWELL)

DRYWELL HAS 6' OF COVER TO LID, INLET INTO DRYWELL 7' DEEP - PVC HOOKED TO EX. CAST IRON W/ FERRO COUPLING, TEE IN CENTER OF DRYWELL, OK TO COVER ALL WORK STONE ADDED INTO DRYWELL (MAKING A CIRCULAR LEACHING BED) (SRK)

INSPECTOR Steven R. Krieg

DATE SYSTEM APPROVED 6/20/01