

APPLICATION

SEWAGE DISPOSAL TESTING

STATE OF MARYLAND - DEPARTMENT OF HEALTH AND MENTAL HYGIENE

HOWARD COUNTY HEALTH DEPARTMENT
ENVIRONMENTAL HEALTH SERVICES
P. O. BOX 476, ELLICOTT CITY, MARYLAND 21043
TELEPHONE: 485-5000, EXT. 300

DISTRICT 3rd

DATE 4-30-73

TO: THE COUNTY HEALTH OFFICER
ELLICOTT CITY, MARYLAND

I, HEREBY, APPLY FOR THE NECESSARY TEST IN ORDER TO CONSTRUCT (OR RECONSTRUCT) A SEWAGE DISPOSAL SYSTEM.

PROPERTY OWNER ~~Mark Wakarfield~~ Jane Cox

ADDRESS Carnoll Hill Rd., E.C.M. PHONE 531-5972

PROPERTY LOCATION:

SUBDIVISION Woodmark LOT NO. 23, Blk. E, Sec. 11

ROAD AND DESCRIPTION Stehansen Rd.

SIZE OF LOT 70,600 sq. ft. TYPE BLDG. 3 of 4 Bedrooms
NUMBER OF BEDROOMS

IF NOT SINGLE RESIDENCE DESCRIBE _____

THE SYSTEM INSTALLED UNDER THIS APPLICATION IS ACCEPTABLE ONLY UNTIL PUBLIC FACILITIES BECOME AVAILABLE.

SIGNATURE OF APPLICANT Mark Wakarfield /s/

APPROVED BY _____ FOR _____ DATE _____
(KIND OF SYSTEM)

REJECTED BY _____ FOR _____ DATE _____
(KIND OF SYSTEM)

HOLD PENDING FURTHER TESTS _____ DATE _____

REASONS FOR REJECTION OR HOLDING _____

OLD PERMITS DEPT
AND RETURNED 5/11/01
1300129780 LP TANK

THIS IS NOT A PERMIT

A515240-B

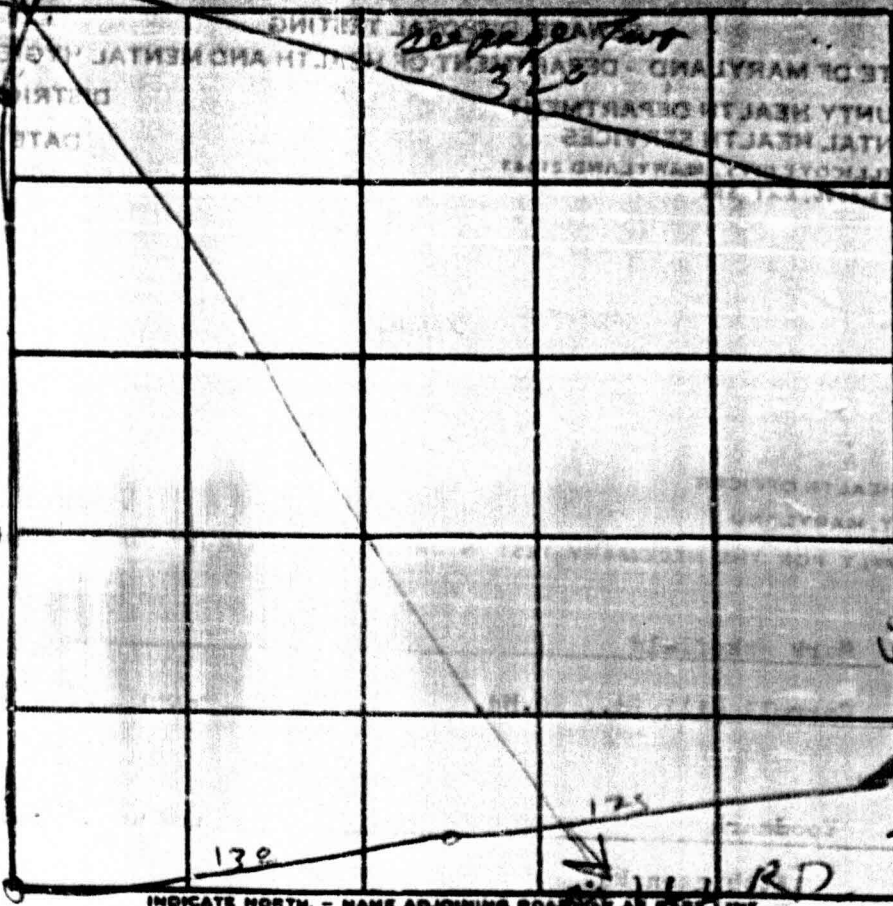

INDICATE NORTH. - NAME ADJOINING ROADWAY AS BASE LINE
 CARROLL RD

DATE	TEST NO.	DEPTH	PRE-WET		TEST - 1" DROP		TIME
			START	STOP	START	STOP	
4/14/77	1S	6	1058	1100	1100	1104	4
	1D	13	1059	1104	1104	1108	4
	2S	4	1105	1106	1106	1108	2
	2V	10'	ALL SANDY				
	2M	8	NOT TESTED				
undec	3V	8	WATER 7 1/2 FT. FROM GRADE TO P 4 FT. CLAY				
	4V	11	TOP 4 FT. CLAY BOT. 7 FT. SANDY				
	5V	10	WATER COMES IN 9 FT. TOP 3 FT. CLAY BOT. 7 FT. SANDY				
	6V	10	WATER COMES IN 9 FT. TOP 5 FT. CLAY BOT. SANDY				
4/14/77	7V	11 1/2	TOP 4 1/2 FT. CLAY BOT. 7 SANDY				
			WATER COMES IN 11 FT.				

REMARKS

Water @ 11' 7" 73

TYPE OF SOIL

RH8 DM 4/14/77

also present PREVIOUS RITTON M WAKEFIELD 4/14/77 OTHERS

Lot 23 - Sect. 11

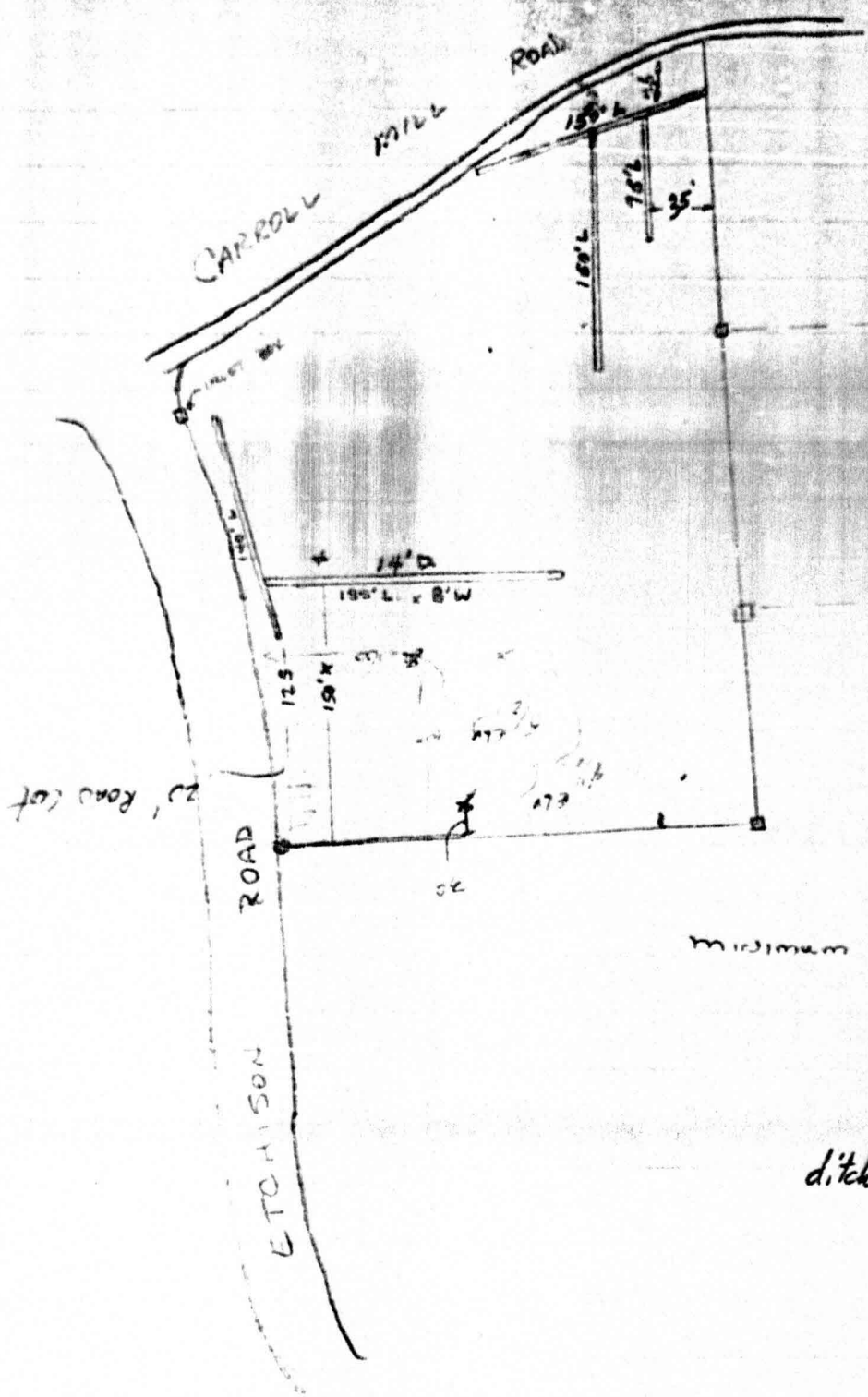

minimum 12" #2 stone
4" perforated pipe
Plastic over stone
Backfilled
ditch 8' wide

WOODMARK
 LOT 23, BLOCK E, SECTION 11
 ADDITIONAL PERCOLATION DATA
 December 14, 1981

House may be located directly adjoining sewage easement.

Septic system must be installed prior to the issuance of a building permit.

Building Restriction Line

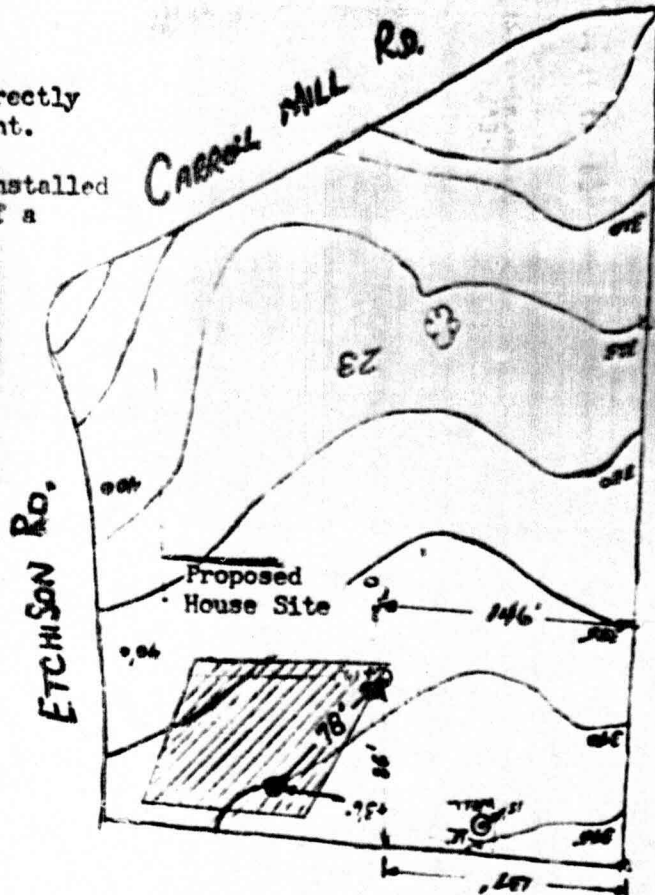

● Visual holes 12/8/81

 This area indicates a private sewage easement. Improvements of any kind in this area are restricted until public sewage is available and servicing any residential structure constructed on this site. This easement shall become null and void upon connection to a public sewage system.

APPROVED : For Private Water and Private Sewerage Systems,
 Howard County Health Dept.

 County Health Officer

12-29-81
 Date

