

APPLICATION

SEWAGE DISPOSAL TESTING

STATE OF MARYLAND - DEPARTMENT OF HEALTH AND MENTAL HYGIENE

A 30626
P _____

HOWARD COUNTY HEALTH DEPARTMENT
ENVIRONMENTAL HEALTH SERVICES
P.O. BOX 476 ELLICOTT, MARYLAND 21043
TELEPHONE: 992-2330

DISTRICT 3RD

DATE 1/19/70

TO: THE COUNTY HEALTH OFFICER
ELLICOTT CITY, MARYLAND

I, HEREBY, APPLY FOR THE NECESSARY TEST IN ORDER TO CONSTRUCT (OR RECONSTRUCT) A SEWAGE DISPOSAL SYSTEM.

PROPERTY OWNER Mr. RONALD ROLL

ADDRESS 8388 COURT AVE. PHONE 441-5855

PROPERTY LOCATION:

SUBDIVISION PROPERTY OF RONALD ROLL LOT NO. 1

ROAD AND DESCRIPTION 2100' ± SOUTHWEST FROM INTERSECTION OF FOLLY QUARTER ROAD AND
JARROLL MILL ROAD

SIZE OF LOT 16 AC ± TYPE BLDG. SINGLE FAMILY

THE SYSTEM INSTALLED UNDER THIS APPLICATION IS ACCEPTABLE ONLY UNTIL PUBLIC FACILITIES BECOME AVAILABLE.

I FULLY UNDERSTAND THE FEE CONNECTED WITH THE FILING OF THIS PERC TEST APPLICATION IS NON-REFUNDABLE UNDER

ANY CIRCUMSTANCES.

SIGNATURE OF APPLICANT _____

APPROVED BY _____ FOR _____ DATE _____

REJECTED BY _____ FOR _____ DATE _____

HOLD PENDING FURTHER TESTS _____ DATE _____

REASONS FOR ~~REJECTION~~ OR HOLDING ADD FOR CERTIFIED HOLES, HOUSE PLANS, WELL SITE, +
SUPERVISOR. 4-25-80 SK (195)

THIS IS NOT A PERMIT

SOIL PROFILE

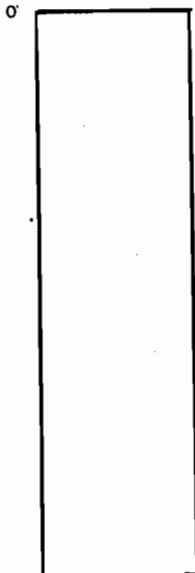

FIELD SHEET

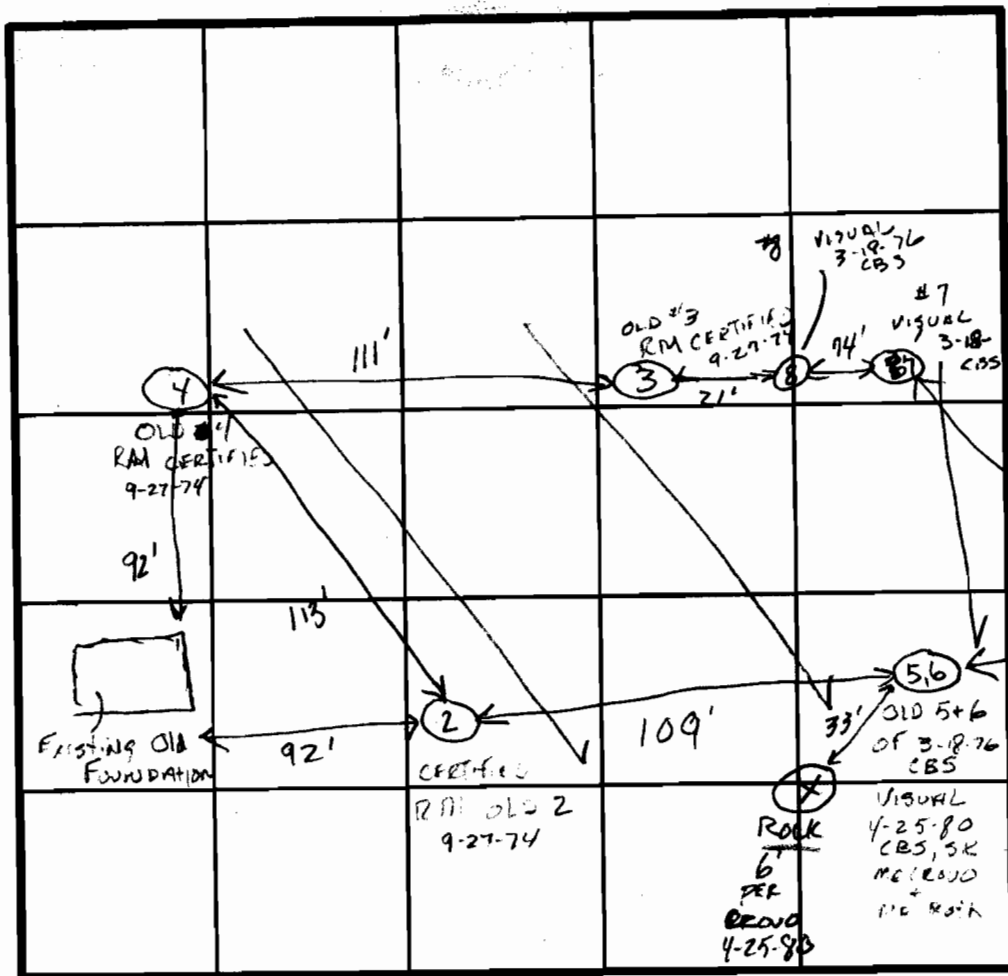

INDICATE NORTH - NAME ADJOINING ROADWAY AS BASE LINE.

Carroll's Mill Rd

DATE	TEST NO.	DEPTH	PRE-WET		TEST - 1" DROP		TIME
			START	STOP	START	STOP	
4-25-80	OLD 5+6	3'-10'	SANDY	LOAM	VISUAL		
4-25-80	1	3 1/2 - 12'	SANDY	LOAM	VISUAL		

REMARKS: Wooded lot. Sold for Certified User & Supervisor
copy given Mr Prout 4-25-80

TYPE OF SOIL: _____

TESTED BY: CBS, SK. ALSO PRESENT: Mr Prout MR Roth + Skip