

LAYOUT 7/6/05 INSP 4 _____
 INSP 2 7/7/05 INSP 5 _____
 INSP 3 _____ INSP 6 _____

ISSUE DATE: 6/30/2005

APPROVAL DATE: 7/7/05

PERMIT
 INDEXED

P 522844

A 514952-I

TAX ID #04-368037

**ON-SITE SEWAGE DISPOSAL SYSTEM
 HOWARD COUNTY HEALTH DEPARTMENT
 BUREAU OF ENVIRONMENTAL HEALTH**

Fogle's Septic Clean, Inc. IS PERMITTED TO INSTALL ALTER

ADDRESS: 580 Obrecht Rd., Sykesville 21784 PHONE NUMBER: 410-795-5670

SUBDIVISION: Waterford Farms LOT NUMBER: 37

ADDRESS: 3255 Eleanors Garden Way PROPERTY OWNER: Toll MD II, LP

SEPTIC TANK CAPACITY (GALLONS): 1250 OUTLET BAFFLE FILTER REQUIRED

PUMP CHAMBER CAPACITY (GALLONS): N/a WITH EFFLUENT FILTER
 COMPARTMENTED TANK REQUIRED

NUMBER OF BEDROOMS: 4

SQUARE FEET PER BEDROOM: 180

LINEAR FEET OF TRENCH REQUIRED: 200 HOUSE SERVED BY PUBLIC WATER
~~150~~

TRENCHES:	Trench to be 3.0 feet wide. Inlet 3.0 ^{5'} feet below original grade. Bottom maximum depth 3.0 ^{2.0} feet below original grade. Effective area begins at 3.0 feet below original grade. 2.0 ^{1'} feet of stone below distribution pipe.
LOCATION:	Place the distribution box in the highest elevation of the approved SDA.
NOTES:	No basement gravity service. Must install an effluent filter.

PLANS APPROVED: Pete A Yencsik Reviewed by: _____ DATE: 4/7/2005

NOTES: PERMIT VOID AFTER 2 YEARS
 CONTRACTOR IS RESPONSIBLE FOR SCHEDULING A PRE-CONSTRUCTION INSPECTION FOR ALL INSTALLATIONS
 WATERTIGHT SEPTIC TANKS REQUIRED
 ALL PARTS OF SEPTIC SYSTEM SHALL BE 100 FEET FROM ANY WATER WELL UNLESS SPECIFICALLY AUTHORIZED
 MANHOLE RISERS REQUIRED ON ALL SEPTIC TANKS AND PUMP CHAMBERS UNLESS SPECIFICALLY AUTHORIZED
 CONTRACTOR RESPONSIBLE FOR COMPLIANCE WITH APPLICABLE REGULATIONS, GUIDELINES AND THE TERMS OF THIS PERMIT

**NEITHER THE HOWARD COUNTY COUNCIL NOR THE HEALTH DEPARTMENT IS
 RESPONSIBLE FOR THE SUCCESSFUL OPERATION OF ANY SYSTEM
 PERMITTEE RESPONSIBLE FOR OBTAINING FINAL APPROVAL ON THIS PERMIT**

**BUILDING PERMIT SIGNED - 313-1771 FOR INSPECTION OF SEPTIC SYSTEM
 AND RETURNED**

0-13-05 B00156499-IG POOL

A514 952-I

NOT TO SCALE

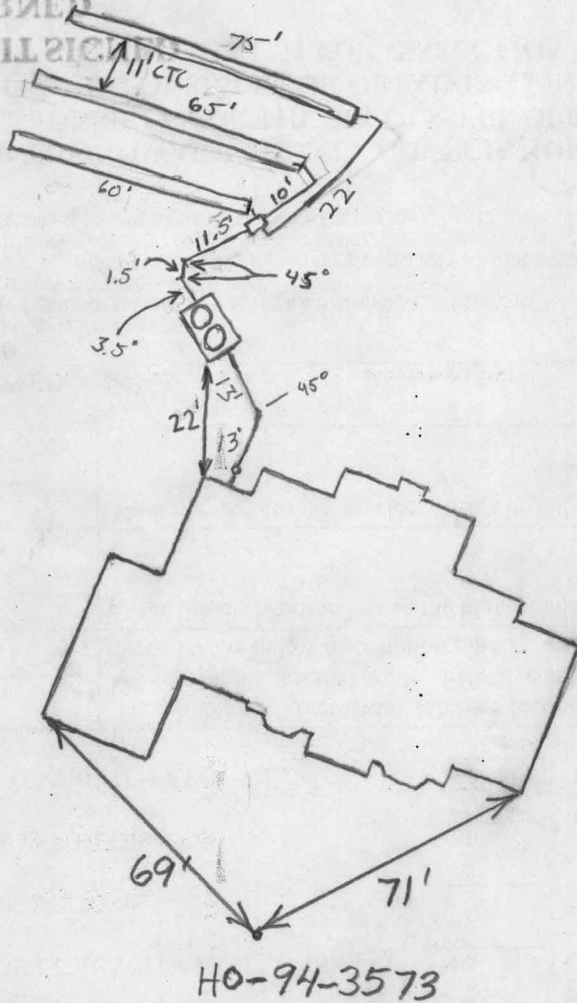

Eleanors Garden Way

TRENCH/DRAINFIELD DATA		
WIDTH	INLET	BOTTOM
3'	5	6
NUMBER OF TRENCHES		3
TOTAL LENGTH		200'
ABSORPTION AREA		600 sqft + SW
DISTRIBUTION BOX LEVEL		✓
DISTRIBUTION BOX BAFFLE		✓
DISTRIBUTION BOX PORT		No

SEPTIC TANK DATA	
SEPTIC TANK 1 LEVEL	✓
CAPACITY	1500 GAL
SEAM LOC	Top
TANK LID DEPTH	6'
BAFFLES	✓
BAFFLE FILTER	✓
MANHOLE LOC	Inlet & Outlet
6" PORT LOC	N/A
WATERTIGHT TEST	N/A

SEPTIC TANK 2 LEVEL	
CAPACITY	_____ GAL
SEAM LOC	_____
TANK LID DEPTH	_____
BAFFLES	_____
BAFFLE FILTER	_____
MANHOLE LOC	_____
6" PORT LOC	_____
WATERTIGHT TEST	_____

Traffic Bearing

PRE-CONSTRUCTION 7/6/05 O.K. to install trenches with a 5' inlet and a 6' bottom. 5' inlet required for gravity service.

INSTALLATION Will need 200' of trench because there will be only 1' of sidewalk now. I not all 3 trenches starting at highest point of easement. Will require tank with traffic bearing lid. (BB) 7/7/05 Traffic bearing tank set 6-7' due to House Connection Being made under footer. Top trench is only using 6" of stone that was best possible due to depth. OK to cover all work (GAC)

FINAL INSPECTOR D. Crighton DATE OF APPROVAL 7/7/05

ELEANORS GARDEN WAY

(50'R/W)

S27°05'31"W 87.78'

L=27.63' L=35.06'
R=50.00' R=100.00'

WELL
HO-94-3573

10' PUBLIC
TREE MAINTENANCE
AND UTILITY EASEMENT

GRID NORTH

LOT 38

LOT 37

LOT 36

11'±

28'±

10' BRL

50' BRL

64.4'

S62°54'29"E

S62°54'29"E

10' BRL

10' BRL

331.36'

300.60'

30' BRL

N27°05'31"E 140.00'

ENVIRONMENTAL
NON-BUILDABLE
PRESERVATION
PARCEL 'G'

NATURAL CONSERVATION
AREA CREDIT
EASEMENT 1

STORMWATER MANAGEMENT
NON-BUILDABLE
PRESERVATION PARCEL 'F'

Privately Owned
12.085ac±
Easement Holder:
HOA and Howard County

*well &
wall
check OK*
[Signature]

630-05

TOP OF FOUNDATION WALL ELEVATION = 554.3'
OFFSET DIMENSIONS TO PROPERTY LINES ARE ± 1'

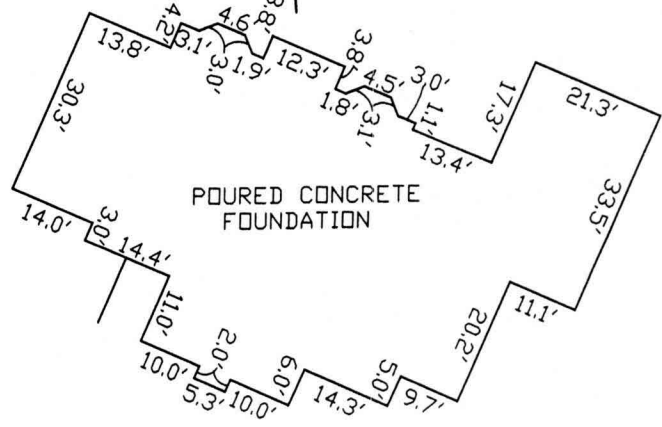

~FOUNDATION DETAIL~

SCALE: 1" = 30'

WALL CHECK

WATERFORD FARMS
LOTS 1 THRU 45

LOT No. 37

3255 ELEANORS GARDEN WAY

4TH ELECTION DISTRICT

HOWARD COUNTY, MARYLAND

SCALE: 1" = 50' DATE: 05/23/05

SURVEYOR'S CERTIFICATE

I HEREBY CERTIFY TO THE BEST OF MY PROFESSIONAL KNOWLEDGE, INFORMATION AND BELIEF, THAT THE DIMENSIONS OF THE BUILDING WALLS SHOWN HEREON ARE CORRECT; THAT THEY ARE BASED ON A FIELD RUN SURVEY PERFORMED BY BENCHMARK ENGINEERING, INC. ON 05/23/05 ; AND THAT THE PROPERTY OUTLINE SHOWN HEREON IS BASED ON THE PLAT PREPARED BY FSH ASSOCIATES, INC. ENTITLED " WATERFORD FARMS LOTS 1THRU 45 ", AND RECORDED AMONG THE LAND RECORDS OF HOWARD COUNTY AS PLAT No.16167

[Signature]
DAVID M. HARRIS
REGISTERED PROFESSIONAL LAND SURVEYOR
MD REG. No. 10978
FOR BENCHMARK ENGINEERING, INC.
MD REG. No. 351
RECORD PLAT No. 16167
FEMA FIRM No. 240044 0013 B
ZONE: C
DATED: 12/04/86



BENCHMARK
ENGINEERS • LAND SURVEYORS • PLANNERS
ENGINEERING, INC.

8480 BALTIMORE NATIONAL PIKE • SUITE 418
ELLCOTT CITY, MARYLAND 21043
phone: 410-465-6105 • fax: 410-465-6644
email: Benchmark@coils.com