

LAYOUT _____ INSP 4 _____
INSP 2 _____ INSP 5 _____
INSP 3 _____ INSP 6 _____

ISSUE DATE: 4/25/05

APPROVAL DATE: 4/29/05

PERMIT

INDEXED

TAX ID # 04-368029

P 522421

A 514952-H

ON-SITE SEWAGE DISPOSAL SYSTEM HOWARD COUNTY HEALTH DEPARTMENT BUREAU OF ENVIRONMENTAL HEALTH

Fogles Septic Clean, Inc IS PERMITTED TO INSTALL ALTER

ADDRESS: 580 Obrecht Road, Sykesville PHONE NUMBER: 410-795-5670

SUBDIVISION: Waterford Farms LOT NUMBER: 36

ADDRESS: 3247 Eleanors Garden Way PROPERTY OWNER: Toll MDII LP

SEPTIC TANK CAPACITY (GALLONS): 1500 1250 OUTLET BAFFLE FILTER REQUIRED

PUMP CHAMBER CAPACITY (GALLONS): _____ WITH/Effluent filter
COMPARTMENTED TANK REQUIRED

NUMBER OF BEDROOMS: 4

SQUARE FEET PER BEDROOM: 180

LINEAR FEET OF TRENCH REQUIRED: 200

TRENCHES:	Trench to be 3.0 feet wide. Inlet 2.0 feet below original grade. Bottom maximum depth 4.0 feet below original grade. Effective area begins at 3.0 feet below original grade. 2.0 feet of stone below distribution pipe.
LOCATION:	Place the distribution box at the highest elevation within the approved sewage disposal area.
NOTES:	Shallow system only, effluent filter needed.

PLANS APPROVED: SRK/PAY / KN DATE: 2/9/05

- NOTE: PERMIT VOID AFTER 2 YEARS
- NOTE: CONTRACTOR RESPONSIBLE FOR SCHEDULING A PRE-CONSTRUCTION INSPECTION FOR ALL INSTALLATIONS
- NOTE: WATERTIGHT SEPTIC TANKS REQUIRED
- NOTE: ALL PARTS OF SEPTIC SYSTEM SHALL BE 100 FEET FROM ANY WATER WELL
- NOTE: MANHOLE RISERS REQUIRED ON ALL SEPTIC TANKS AND PUMP CHAMBERS UNLESS SPECIFICALLY AUTHORIZED

NEITHER THE HOWARD COUNTY COUNCIL NOR THE HEALTH DEPARTMENT IS RESPONSIBLE FOR THE SUCCESSFUL OPERATION OF ANY SYSTEM PERMITTEE RESPONSIBLE FOR OBTAINING FINAL APPROVAL ON THIS PERMIT CALL 410-313-2640 FOR INSPECTION OF SEPTIC SYSTEM

514952-H

NOT TO SCALE

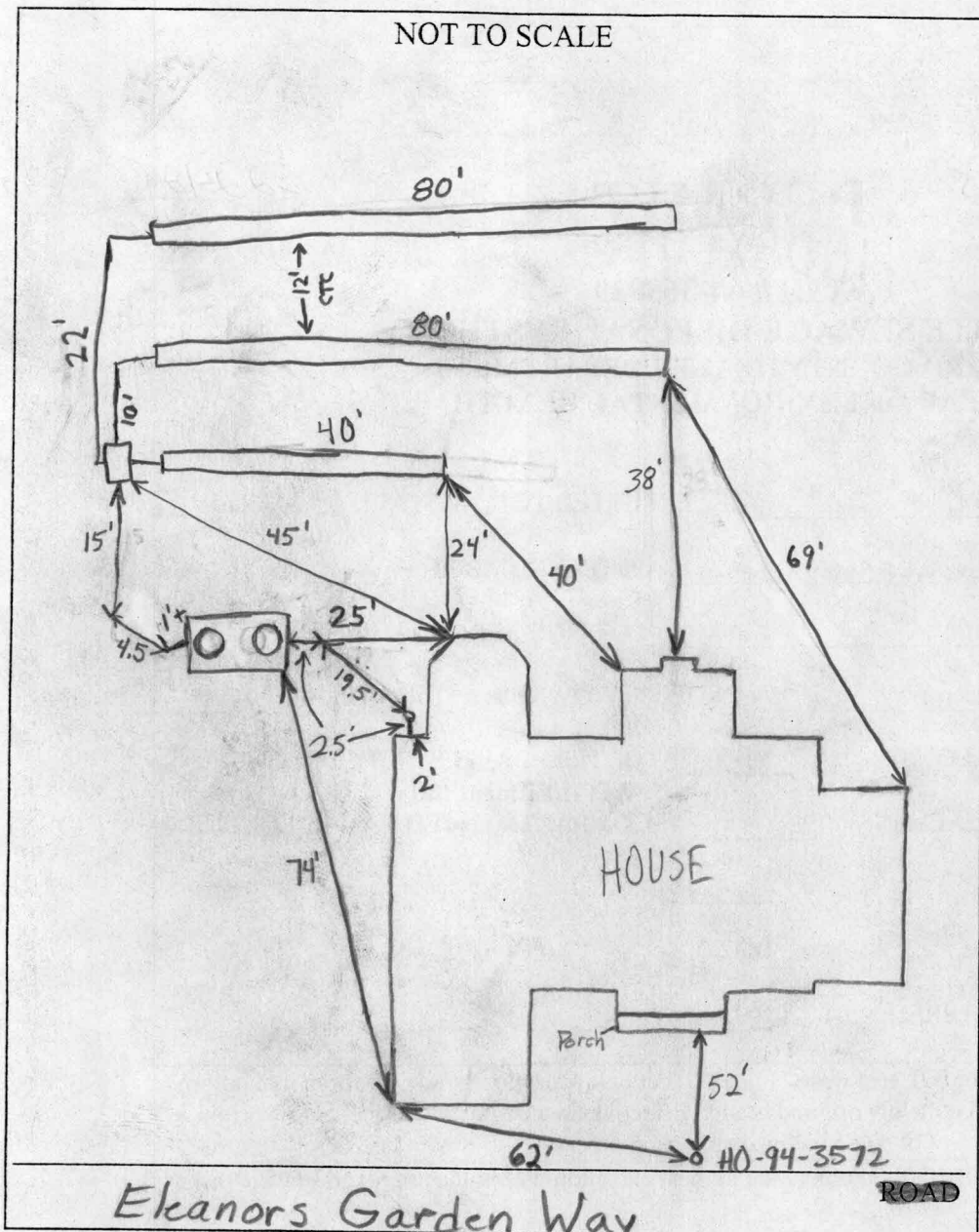

TRENCH/DRAINFIELD DATA		
WIDTH	INLET	BOTTOM
3'	2'	4'
NUMBER OF TRENCHES		3
TOTAL LENGTH		200'
ABSORPTION AREA		600' + sidewalk
DISTRIBUTION BOX LEVEL		Yes
DISTRIBUTION BOX BAFFLE		Yes
DISTRIBUTION BOX PORT		No

SEPTIC TANK DATA	
SEPTIC TANK 1 LEVEL	Yes
CAPACITY	1500 GAL
SEAM LOC	Top
TANK LID DEPTH	1 1/2 - 2 1/2
BAFFLES	Yes
BAFFLE FILTER	Yes
MANHOLE LOC	Front/Rear
6" PORT LOC	N/A
WATERTIGHT TEST	N/A
SEPTIC TANK 2 LEVEL	
CAPACITY	_____ GAL
SEAM LOC	_____
TANK LID DEPTH	_____
BAFFLES	_____
BAFFLE FILTER	_____
MANHOLE LOC	_____
6" PORT LOC	_____
WATERTIGHT TEST	_____

PRE-CONSTRUCTION 4/26/05 Install one short trench and 2 longer trenches to maximize use of area with dist box near area

INSTALLATION shown on building permit plan. Tank set and house connection made. BB GC 4/28/05 System installed. O.K. to cover. BB GC

FINAL INSPECTOR B. Baker DATE OF APPROVAL 4/29/05

