

**HOWARD COUNTY
 PERMIT APPLICATION**

PERMIT NUMBER

B00149697 ^{K15B}

Building Address 3240 ELEANORS GARDEN WAY
WOODBRINE, MD 21797

Property Owner's Name TOLL MD II, LP
 Address 7164 Columbia Gateway Dr., #230
 City Columbia State MD Zip Code 21046
 Home Phone _____ Work Phone 443-535-1276
 Applicant's Name & Mailing Address, (if other than stated hereon):

Suite/Apt. #: _____ SDP/WP/Petition #: _____
 Census Tract 100162 Subdivision WATERFORD FARMS
 Section _____ Area _____ Lot 414
 Tax Map 20 Parcel 139 Grid #26
 Zoning R1D Map Coordinates 3611 Lot size _____

Phone DAP 410-489-6292 Fax _____

Existing Use Vacant Lot
 Proposed Use Residential Home
 Estimated Construction Cost \$ 300,000

Contractor Company TOLL MD II, LP
 Contact Person Nathan Brandenburg
 Address 7164 Columbia Gateway Dr., #230
 City Columbia State MD Zip Code 21046
 License No. 678
 Phone 443-535-9296 Fax 443-535-9297

Description of Work Herley Williamsburg, D.I. at
Basement, Great Room Like Addition, Backyard
Sinks Above Like Addition

Engineer or Architect Company FSH Associates
 Contact Person Zach Fish
 Address 8730 Forrest St.
 City Ellicott City State MD Zip Code 21113
 Phone 410-750-2251 Fax 410-750-7350

Occupant or Tenant TOLL MD II, LP
 Contact Name Nathan Brandenburg
 Address 7164 Columbia Gateway Dr., #230
 City Columbia State MD Zip Code 21046
 Phone 443-535-9296 Fax 443-535-9297

BUILDING DESCRIPTION - COMMERCIAL

BUILDING DESCRIPTION - RESIDENTIAL

Building Characteristics	Utilities
Height: _____	Water Supply: _____ Public _____ Private _____
No. of stories: _____	Sewage Disposal: _____ Public _____ Private _____
Gross area, sq. ft. per floor: _____	Electric Yes <input type="checkbox"/> No <input type="checkbox"/> Gas Yes <input type="checkbox"/> No <input type="checkbox"/>
Use group: _____	Heating System: _____ Electric <input type="checkbox"/> Oil <input type="checkbox"/> Natural Gas <input type="checkbox"/> Propane Gas <input type="checkbox"/>
Construction type: _____ Reinforced Concrete _____ Structural Steel _____ Masonry _____ Wood Frame _____	Sprinkler system: N/A <input type="checkbox"/> Full _____ Partial _____ Other Suppression _____ # of Heads _____
State Certified Modular _____	

Building Characteristics	Utilities
SF Dwelling <input checked="" type="checkbox"/> SF Townhouse <input type="checkbox"/>	Water Supply: _____ Public _____ Private <input checked="" type="checkbox"/>
1st floor: Depth <u>6'10"</u> Width <u>6'2"</u>	Sewage Disposal: _____ Public _____ Private <input checked="" type="checkbox"/>
2nd floor: <u>6'5"</u> <u>6'8"</u>	Electric Yes <input checked="" type="checkbox"/> No <input type="checkbox"/> Gas Yes <input type="checkbox"/> No <input checked="" type="checkbox"/>
Basement: <u>6'2"</u> <u>6'8"</u>	Heating System: _____ Electric <input type="checkbox"/> Oil <input type="checkbox"/> Natural Gas <input type="checkbox"/> Propane Gas <input checked="" type="checkbox"/>
Finished Basement <input type="checkbox"/> Unfinished Basement <input checked="" type="checkbox"/>	Sprinkler system: N/A <input type="checkbox"/> NFPA #13D _____ NFPA #13R _____ Other: _____
Crawl space <input type="checkbox"/> Slab on Grade <input type="checkbox"/>	
No. of Bedrooms <u>4</u>	
Multi-family dwellings: _____ No. of efficiency units: _____ No. of 1 BR units: _____ No. of 2 BR units: _____ No. of 3 BR units: _____	
Other Structure: _____	
Dimensions: _____	
Footings: _____	
Roof: _____	
State Certified Modular _____ Manufactured Home _____	

THE UNDERSIGNED HEREBY CERTIFIES AND AGREES AS FOLLOWS: (1) THAT HE/SHE IS AUTHORIZED TO MAKE THIS APPLICATION; (2) THAT THE INFORMATION IS CORRECT; (3) THAT HE/SHE WILL COMPLY WITH ALL REGULATIONS OF HOWARD COUNTY WHICH ARE APPLICABLE THERETO; (4) THAT HE/SHE WILL PERFORM NO WORK ON THE ABOVE REFERENCED PROPERTY NOT SPECIFICALLY DESCRIBED IN THIS APPLICATION; (5) THAT HE/SHE GRANTS COUNTY OFFICIALS THE RIGHT TO ENTER ONTO THIS PROPERTY FOR THE PURPOSE OF INSPECTING THE WORK PERMITTED AND POSTING NOTICES.

Applicant's Signature [Signature]
 Title/Company Asst. Project Manager

Print Name Daniel W. Skyles
 Date 7-26-04

Checks payable to: **DIRECTOR OF FINANCE OF HOWARD COUNTY**
 ** PLEASE WRITE NEATLY AND LEGIBLY. **
 - FOR OFFICE USE ONLY -

AGENCY	DATE	SIGNATURE APPROVAL
Planning and Development - DPZ		
Building Official		
Dev. Engineering - DPZ	<u>7/15/04</u>	<u>[Signature]</u>
Health		
Fire Protection		
Sediment Control approval required prior to issuance		
YES <input checked="" type="checkbox"/> NO <input type="checkbox"/>		
CONTINGENCY CONSTRUCTION START: <input type="checkbox"/>		
ONE STOP SHOP: <input type="checkbox"/>		

DPZ SETBACK INFORMATION

Front: _____
 Side: _____
 Side St.: _____
 All minimum setbacks met? YES NO
 Is Entrance Permit required? YES NO
 Historic District? YES NO
 Lot Coverage for NewTown Zone _____
 SDP/Red-line approval date _____

PROPERTY ID# 63034

Permit fee \$ _____
 Excise tax \$ _____
 Add'l per. fee \$ _____
 TOTAL FEES \$ _____
 Sub-total paid \$ _____
 Balance due \$ _____
 Check # 356964
 Validation # 76336

Distribution of Copies: White: Building Official Green: LDD, DPZ Yellow: DED, DPZ Pink: Health Gold: SHA

Forms/ PERMIT FRM

DAISY ROAD

(MAJOR COLLECTOR)
(PUBLIC COUNTY ROAD)
Vehicular Ingress and
Egress Restricted

Maryland State Grid (NAD 83/91)

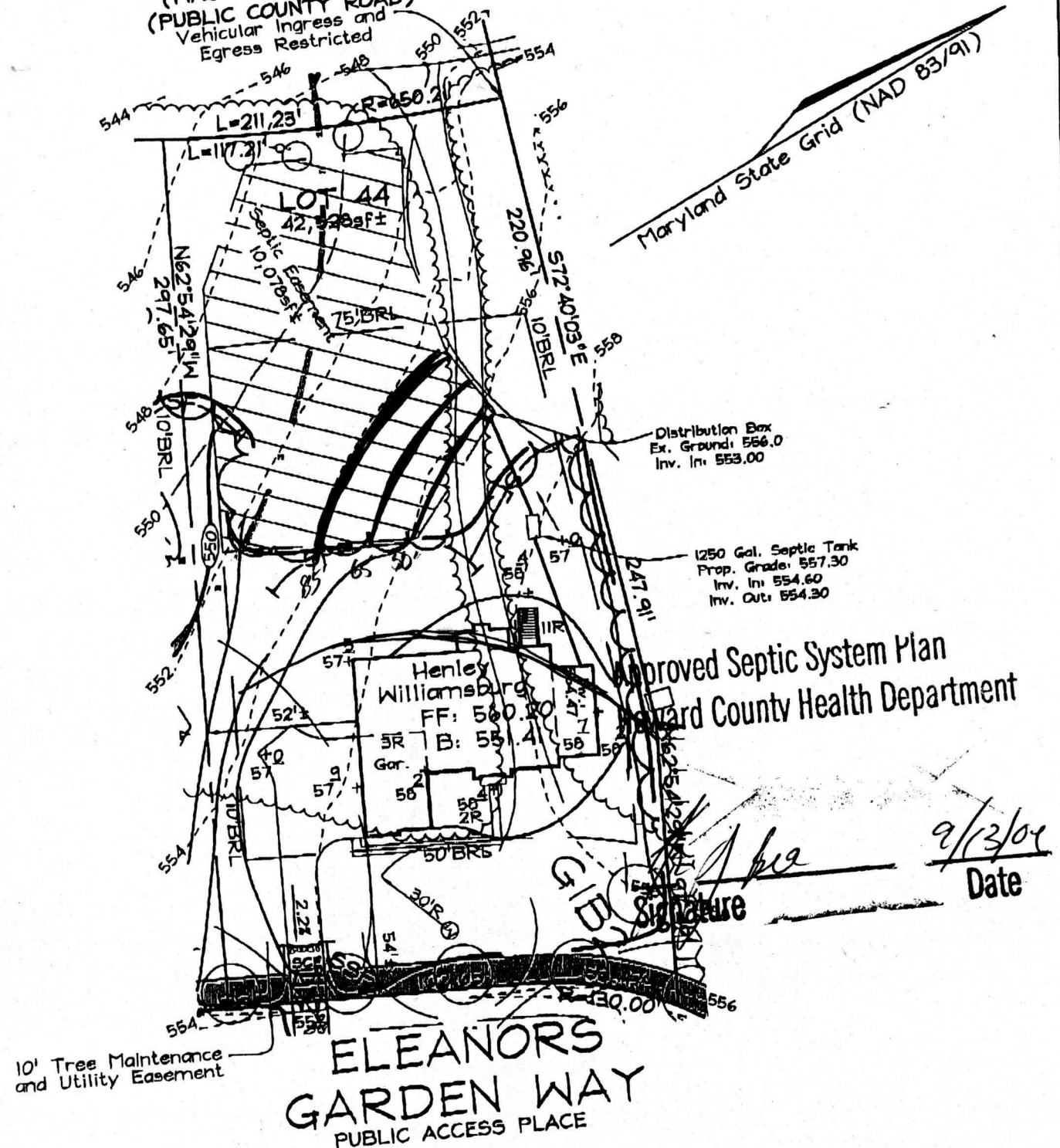

Approved Septic System Plan
Howard County Health Department

[Signature]
Signature
9/13/04
Date

OWNER/DEVELOPER

Toll MD II, LP
7164 Columbia Gateway Drive
Suite 230
Columbia, Maryland 21046
410.872.9185

FSH Associates

Engineers Planners Surveyors
8318 Forrest Street Ellicott City, MD 21043
Tel: 410-750-2251 Fax: 410-750-7350
E-mail: FSHAssociates@cs.com

Note: 1. See Approved Grading Plan GP-04-39 For Entire Site.
2. The existing well shown on this plan (identified with the attached well tag number: HO-94-3580) has been field located by C. B. Miller professional surveyor and is accurately shown.

DESIGN BY: PS
DRAWN BY: BB
CHECKED BY: ZYF
SCALE: 1"=50'
DATE: July 28, 2004
W.O. No.: 3217
SHEET No.: 1 OF 1

LOT RESITE
LOT 44
CATTAIL TRACE
TAX MAPS 13, 14, 20 & 21
GRIDS 7, 12, 19 & 24
4TH ELECTION DISTRICT
PARCELS 20, 67 & 312
HOWARD COUNTY, MARYLAND
GP-04-39