

HOWARD COUNTY  
 PERMIT APPLICATION

PERMIT NUMBER

B00001922

Building Address 3355 FLORENCE RD  
WOODRIDGE MD 21797

Suite/Apt. #: \_\_\_\_\_ SDP/WP/Petition #: \_\_\_\_\_

Census Tract \_\_\_\_\_ Subdivision \_\_\_\_\_

Section \_\_\_\_\_ Area \_\_\_\_\_ Lot \_\_\_\_\_

Tax Map \_\_\_\_\_ Parcel \_\_\_\_\_ Grid \_\_\_\_\_

Zoning \_\_\_\_\_ Map Coordinates \_\_\_\_\_ Lot size \_\_\_\_\_

Property Owner's Name MCNEAFANT, THOMAS

Address 3355 FLORENCE RD

City WOODRIDGE State MD Zip Code 21797

Phone 410-484-0917 Phone \_\_\_\_\_

Applicant's Name & Mailing Address, (if other than stated hereon):

Phone \_\_\_\_\_ Fax \_\_\_\_\_

Existing Use SINGLE FAMILY

Proposed Use POULTRY BARN

Estimated Construction Cost \$ 9,775.00

Description of Work 3 sided pole building 12' x 40' FOR STORAGE USE

Contractor Company NESTORA BUILDINGS

Contact Person Jim Jorosh

Address 212 OCEAN RD

City NEW HOLLAND State PA Zip Code 17557

License No. \_\_\_\_\_ Phone 717-544-4414 Fax 717-555-4170

Occupant or Tenant \_\_\_\_\_

Contact Name \_\_\_\_\_

Address \_\_\_\_\_

City \_\_\_\_\_ State \_\_\_\_\_ Zip Code \_\_\_\_\_

Phone \_\_\_\_\_ Fax \_\_\_\_\_

Engineer or Architect Company \_\_\_\_\_

Contact Person \_\_\_\_\_

Address \_\_\_\_\_

City \_\_\_\_\_ State \_\_\_\_\_ Zip Code \_\_\_\_\_

Phone \_\_\_\_\_ Fax \_\_\_\_\_

BUILDING DESCRIPTION - COMMERCIAL

BUILDING DESCRIPTION - RESIDENTIAL

Building Characteristics

Utilities

Height: 10'  
 No. of stories: 1  
 Gross area, sq. ft. per floor: 480  
 Use group: NA  
 Construction type:  
 Reinforced Concrete  
 Structural Steel  
 Masonry  
 Wood Frame  
 State Certified Modular

Water Supply:  
 Public  
 Private  
 Sewage Disposal:  
 Public  
 Private  
 Electric Yes  No   
 Gas Yes  No   
 Heating System:  
 Electric  Oil   
 Natural Gas   
 Propane Gas   
 Sprinkler system: N/A   
 Full  
 Partial  
 Other Suppression  
 # of Heads

Building Characteristics

Utilities

SF Dwelling  SF Townhouse   
 Depth  Width  
 1st floor: \_\_\_\_\_  
 2nd floor: \_\_\_\_\_  
 Basement:  
 Finished Basement  Unfinished Basement  
 Crawl space  Slab on Grade   
 No. of Bedrooms: \_\_\_\_\_  
 Height: \_\_\_\_\_  
 Multi-family dwellings:  
 No. of efficiency units: \_\_\_\_\_  
 No. of 1 BR units: \_\_\_\_\_  
 No. of 2 BR units: \_\_\_\_\_  
 No. of 3 BR units: \_\_\_\_\_  
 Other Structure: POLE BUILDING  
 Dimensions: 12' x 40'  
 Footings: NONE  
 Roof Height: 10'  
 State Certified Modular  
 Manufactured Home

Water Supply:  
 Public  
 Private  
 Sewage Disposal:  
 Public  
 Private  
 Electric Yes  No   
 Gas Yes  No   
 Heating System:  
 Electric  Oil   
 Natural Gas   
 Propane Gas   
 Sprinkler system: N/A   
 NFPA #13D  
 NFPA #13R  
 Other:

THE UNDERSIGNED HEREBY CERTIFIES AND AGREES AS FOLLOWS: (1) THAT HE/SHE IS AUTHORIZED TO MAKE THIS APPLICATION; (2) THAT THE INFORMATION IS CORRECT; (3) THAT HE/SHE WILL COMPLY WITH ALL REGULATIONS OF HOWARD COUNTY WHICH ARE APPLICABLE THERETO; (4) THAT HE/SHE WILL PERFORM NO WORK ON THE ABOVE REFERENCED PROPERTY NOT SPECIFICALLY DESCRIBED IN THIS APPLICATION; (5) THAT HE/SHE GRANTS COUNTY OFFICIALS THE RIGHT TO ENTER ONTO THIS PROPERTY FOR THE PURPOSE OF INSPECTING THE WORK PERMITTED AND POSTING NOTICES.

Thomas F. McNeafant  
 Applicant's Signature

THOMAS F. MCNEAFANT  
 Print Name

\_\_\_\_\_  
 Title/Company

\_\_\_\_\_  
 Date

Checks payable to: **DIRECTOR OF FINANCE OF HOWARD COUNTY**

\*\* PLEASE WRITE NEATLY AND LEGIBLY. \*\*

FOR OFFICE USE ONLY

AGENCY	DATE	SIGNATURE APPROVAL
Land Development, DPZ		
State Highways		
Building Official		
Dev. Engineering, DPZ	<u>7/2/08</u>	<u>[Signature]</u>
Health		
Fire Protection		
Is Sediment Control approval required prior to issuance?		
YES <input type="checkbox"/> NO <input type="checkbox"/>		

DPZ SETBACK INFORMATION	PROPERTY ID#:
Front: _____	Filing fee \$ <u>25.00</u>
Rear: _____	Permit fee \$ _____
Side: _____	Excise tax \$ _____
Side St.: _____	Add'l per. fee \$ _____
All minimum setbacks met?	TOTAL FEES \$ _____
YES <input type="checkbox"/> NO <input type="checkbox"/>	Sub-total paid \$ _____
Is Entrance Permit required?	Balance due \$ _____
YES <input type="checkbox"/> NO <input type="checkbox"/>	Check # <u>128</u>
Historic District?	Validation # _____
YES <input type="checkbox"/> NO <input type="checkbox"/>	
Lot Coverage for NewTown Zone _____	

CONTINGENCY CONSTRUCTION START:   
 ONE STOP SHOP:

SDP/Red-line approval date \_\_\_\_\_ Accepted by [Signature]

LOT 3  
MILLER PROPERTY  
#610 / 11

S. 49° 24' 03" E

245.96'

N. 46° 50' 05" E  
130.00'

THOMAS F. BONIFANT  
& LOIS A. BONIFANT  
L. 881 F. 691  
3,000 ACRES ±

4610 / 11  
LOT 3 MILLER PROPERTY

NEW BUILDING  
POLE BARN 16' x 40'

N. 40° 35' 57" E  
708.71'

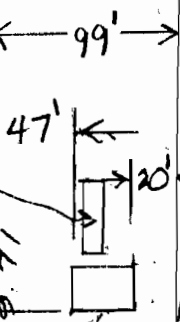

24' x 32' GARAGE

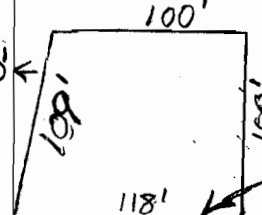

SEPTIC TANK

899.58'

R. W. MENCHAKO 881 / 698

pole building  
1/8/88

EXISTING SEPTIC FIELD

HOUSE LOCATION SURVEY  
LINES CONVEYED TO:

THOMAS F. BONIFANT  
& LOIS A. BONIFANT  
L. 881 F. 691

3356 FLORENCE ROAD  
FOURTH ELECTION DISTRICT  
HOWARD COUNTY, MARYLAND

SCALE: 1" = 100'  
MARCH 1986

N. 35° 24' 15" E 250.00'  
FLORENCE ROAD



I CERTIFY THIS PLAN TO BE CORRECT; IT IS THE RESULT OF AN ACTUAL FIELD SURVEY, BASED ON DATA FOUND AMONG THE LAND RECORDS OF HOWARD COUNTY, MARYLAND.

**SHELADIA ASSOCIATES, INC.**  
CONSULTING ENGINEERS  
7658 WOODVILLE ROAD  
MOUNT AIRY, MARYLAND 21771  
301-329-2890



REFERENCE L. 881 F. 691 JOB NO. 251-85