

8/29/01
Eugene
Arroyo

8-31
10 AM FINAL
& WPT

10/25/01 Pump Test
1-2:00 Final

ISSUE DATE:

8/17/01

PERMIT

P 515990

APPROVAL DATE:

SO 10/25/01

A 21804

ON-SITE SEWAGE DISPOSAL SYSTEM HOWARD COUNTY HEALTH DEPARTMENT BUREAU OF ENVIRONMENTAL HEALTH

04-320425

INDEXED

J. Joseph Gartland, Inc IS PERMITTED TO INSTALL ALTER

ADDRESS: 1835 West Old Liberty Road PHONE NUMBER: 410-875-2400

SUBDIVISION: Rover Mill Estates LOT NUMBER: 26

ADDRESS: 3162 Danmark Drive PROPERTY OWNER: Carrigan Homes

SEPTIC TANK CAPACITY (GALLONS): 1000

PUMP CHAMBER CAPACITY (GALLONS): 1000

NUMBER OF BEDROOMS: 3

SQUARE FEET PER BEDROOM: 180

LINEAR FEET OF TRENCH REQUIRED: 135

OK to set tanks in front of house so amount of cover is limited. Force main to be routed around "garage" side of house. SRU 7/13/01

| | |
|-----------|---|
| TRENCHES: | Trench to be 2.0 feet wide. Inlet 4.0 feet below original grade. Bottom maximum depth 8.0 feet below original grade. Effective area begins at 4.0 feet below original grade. 4.0 feet of stone below distribution pipe. |
| LOCATION: | Place the distribution box 70' off the left (928.09') lot line and 30' off the rear lot line. Run (2) trenches on contour toward left side of lot. |
| NOTES: | |

PLANS APPROVED: MER 6/21/01 OK (BB) DATE: 6/18/01

- NOTE: PERMIT VOID AFTER 2 YEARS
- NOTE: CONTRACTOR RESPONSIBLE FOR SCHEDULING A PRE-CONSTRUCTION INSPECTION FOR ALL INSTALLATIONS
- NOTE: WATERTIGHT SEPTIC TANKS REQUIRED
- NOTE: ALL PARTS OF SEPTIC SYSTEM SHALL BE 100 FEET FROM ANY WATER WELL
- NOTE: MANHOLE RISERS REQUIRED ON ALL SEPTIC TANKS AND PUMP CHAMBERS

NEITHER THE HOWARD COUNTY COUNCIL NOR THE HEALTH DEPARTMENT IS RESPONSIBLE FOR THE SUCCESSFUL OPERATION OF ANY SYSTEM PERMITTEE RESPONSIBLE FOR OBTAINING FINAL APPROVAL ON THIS PERMIT

BUILDING PERMIT SIGNED AND RETURNED

CALL 410-313-2640 FOR INSPECTION OF SEPTIC SYSTEM

28/2003 800142091 INGROUND POOL

P 515990

NOT TO SCALE

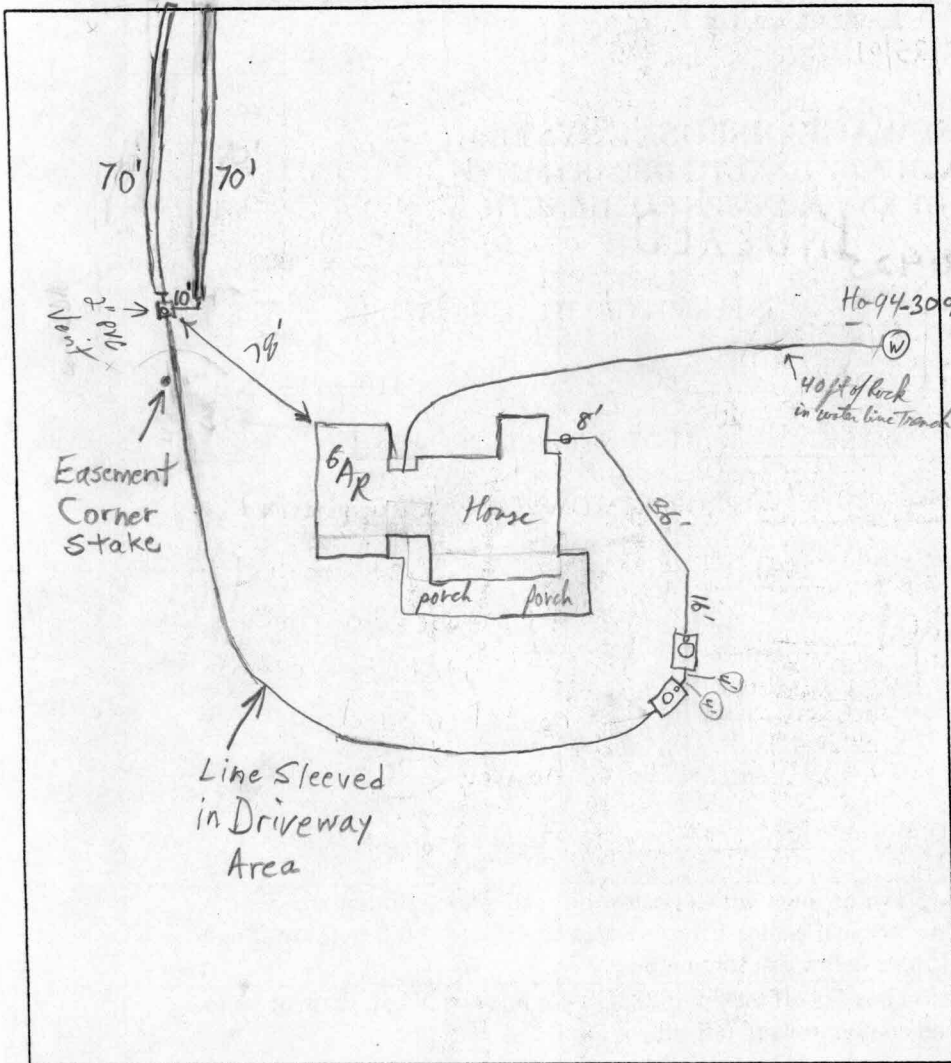

TRENCH DATA

TRENCH WIDTH 2'
 TRENCH INLET DEPTH 4' - 4.5'
 TRENCH BOTTOM DEPTH 8' - 8.5'
 DEPTH OF STONE 4'
 NUMBER OF TRENCHES 2
 TOTAL TRENCH LENGTH 140'
 ABSORBENT AREA 560 sq ft
 DISTRIBUTION BOX LEVEL Yes
 BAFFLE IN DISTRIBUTION BOX Yes

SEPTIC TANK DATA

SEPTIC TANK 1000 T.S. GALLONS
 MANHOLE RISER (16")
 6 INCH INSPECTION PORT

PUMP CHAMBER DATA

PUMP CHAMBER GALLONS 1000 T.S.
 MANHOLE RISER (24") w/ support
 ALARM
 PUMP PERFORMANCE TEST

PRE-CONSTRUCTION INSPECTION: Layout inspection OK - Trench orientation same as on B.P. Plan. OK to proceed 8/29/01

INSPECTION COMMENTS: Septic Tank + pump chamber OK to cover, House Connection OK RPP 8/29/01
8/31/01 System satisfactory. O.K. to cover. Need pump and alarm test for final approval. (BB) 10/25/01 Pump & Alarm test OK
Signed permit DB has 2" pipe for vent in 1" shape (BB)

BUILDING PERMIT SIGNED
AND RETURNED

INSPECTOR Justin Deo

DATE SYSTEM APPROVED 10/25/01

