

C1 8757

SEQUENCE NO. (MDE USE ONLY)

STATE OF MARYLAND WELL COMPLETION REPORT

FILL IN THIS FORM COMPLETELY PLEASE TYPE

THIS REPORT MUST BE SUBMITTED WITHIN 45 DAYS AFTER WELL IS COMPLETED.

1 2 3 4 5 6
(THIS NUMBER IS TO BE PUNCHED IN COLS. 3-6 ON ALL CARDS)

COUNTY NUMBER **(13) A517422**

ST/CO USE ONLY
DATE RECEIVED
MM DD YY
8 13

DATE WELL COMPLETED
MM DD YY
01 19 07

Depth of Well
22 122 26
122
(TO NEAREST FOOT)

PERMIT NO.
FROM "PERMIT TO DRILL WELL"
HO 75 - 0583

OWNER **DeFrancis**
STREET OR RFD **Daniel Circle Lane** first name
SUBDIVISION **Walnut Grove** SECTION TOWN **Clarksville** LOT **29**

WELL LOG

Not required for driven wells

STATE THE KIND OF FORMATIONS PENETRATED, THEIR COLOR, DEPTH, THICKNESS AND IF WATER BEARING

DESCRIPTION (Use additional sheets if needed)	FEET		check if water bearing
	FROM	TO	
Top Soil	0	1	
Clay	1	8	
Sandy	8	22	✓
Sand Stone	22	28	
MICKA	28	70	
Sand Stone	70	75	✓
MICKA	75	122	

NUMBER OF UNSUCCESSFUL WELLS: **0**

WELL HYDROFRACTURED YES NO

CIRCLE APPROPRIATE LETTER
A A WELL WAS ABANDONED AND SEALED WHEN THIS WELL WAS COMPLETED
E ELECTRIC LOG OBTAINED
P TEST WELL CONVERTED TO PRODUCTION WELL

I HEREBY CERTIFY THAT THIS WELL HAS BEEN CONSTRUCTED IN ACCORDANCE WITH COMAR 26.04.04 "WELL CONSTRUCTION" AND IN CONFORMANCE WITH ALL CONDITIONS STATED IN THE ABOVE CAPTIONED PERMIT, AND THAT THE INFORMATION PRESENTED HEREIN IS ACCURATE AND COMPLETE TO THE BEST OF MY KNOWLEDGE.

DRILLERS LIC. NO. **M S D 112**
Will E. Myer
DRILLERS SIGNATURE (MUST MATCH SIGNATURE ON APPLICATION)
LIC. NO. **D**

SITE SUPERVISOR (sign. of driller or journeyman responsible for sitework if different from permittee)

GROUTING RECORD

WELL HAS BEEN GROUTED (Circle Appropriate Box) YES NO
TYPE OF GROUTING MATERIAL (Circle one) CEMENT BENTONITE CLAY
NO. OF BAGS **17** NO. OF POUNDS **1700**
GALLONS OF WATER **102**
DEPTH OF GROUT SEAL (to nearest foot) **30+**
from **8** TOP **52** ft. to **54** BOTTOM **58** ft.
(enter 0 if from surface)

CASING RECORD
casing types insert appropriate code below
 STEEL CONCRETE
 PLASTIC OTHER

MAIN CASING TYPE **PL** Nominal diameter top (main) casing (nearest inch) **6** Total depth of main casing (nearest foot) **35**

EACH CASING	OTHER CASING (if used)	
	diameter inch	depth (feet) from to
PL	4 1/2	5 0
PL	4 1/2	80 122

SCREEN RECORD
screen type or open hole insert appropriate code below
 STEEL BRASS OPEN HOLE
 PLASTIC BRONZE OTHER

DEPTH (nearest ft.)
170 **33** **122**
E 8 9 11 15 17 21
C 23 24 26 30 32 36
S **PL** **60** **80**
R 38 39 41 45 47 51
E SLOT SIZE **1 1/16** 2 3
DIAMETER OF SCREEN **4 1/2** (NEAREST INCH)
from to

GRAVEL PACK IF WELL DRILLED WAS FLOWING WELL INSERT F IN BOX 68

MDE USE ONLY (NOT TO BE FILLED IN BY DRILLER)
T (E.R.O.S.) W Q
70 72 74 75 76
TELESCOPE CASING LOG INDICATOR OTHER DATA

PUMPING TEST

HOURS PUMPED (nearest hour) **3**
PUMPING RATE (gal. per min.) **15**
METHOD USED TO MEASURE PUMPING RATE **Bucket**
WATER LEVEL (distance from land surface)
BEFORE PUMPING **13** ft.
WHEN PUMPING **15** ft.
TYPE OF PUMP USED (for test)
 air piston turbine
 centrifugal rotary other (describe below)
 jet submersible

PUMP INSTALLED

DRILLER INSTALLED PUMP (CIRCLE) (YES or NO) YES NO
IF DRILLER INSTALLS PUMP, THIS SECTION MUST BE COMPLETED FOR ALL WELLS.
TYPE OF PUMP INSTALLED PLACE (A,C,J,P,R,S,T,O) IN BOX 29. **120**
CAPACITY: GALLONS PER MINUTE (to nearest gallon) **31** **35**
PUMP HORSE POWER **37** **41**
PUMP COLUMN LENGTH (nearest ft.) **43** **47**
CASING HEIGHT (circle appropriate box and enter casing height)
 above } LAND SURFACE
 below } **2** (nearest foot)

LOCATION OF WELL ON LOT
SHOW PERMANENT STRUCTURE SUCH AS BUILDING, SEPTIC TANKS, AND /OR LANDMARKS AND INDICATE NOT LESS THAN TWO DISTANCES (MEASUREMENTS TO WELL)

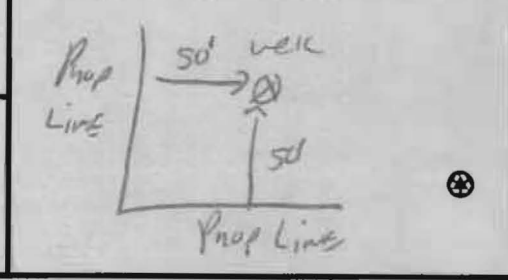

B 1 0548

SEQUENCE NO. (MDE USE ONLY)

STATE OF MARYLAND APPLICATION FOR PERMIT TO DRILL WELL 525642 please type

STATE PERMIT NUMBER HO-95-0583 fill in this form completely

Date Received (APA)

OWNER INFORMATION

8 MM DD YY 13 Land Manufacturing Consultants 15 Last Name Owner First Name 34 36 3060 Rt. 97 Street or RFD 55 57 Glenwood MD. 21238 70 Town State 72 Zip 76

B 3 LOCATION OF WELL

8 COUNTY Howard 21 Walnut Grove 23 SUBDIVISION 42 52 NEAREST TOWN CLARKSVILLE 71 52 MILES FROM TOWN (enter 0 if in town) 2 M I 73 76 77 78

DRILLER INFORMATION

Driller's Name RAY E. MAYNE M SD 117 76 License No. 81 Firm Name PAUL E. MAYNE INC Address 17024 Hardy Rd WA Aig MD 21271 Address 226 S. Veterans 11-11-06 Signature Date

B 4 DIRECTION OF WELL FROM TOWN (CIRCLE BOX)

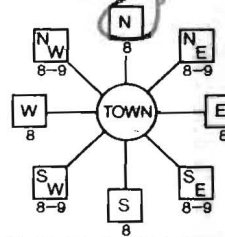

DANIEL CIRCLE LA. 11 NEAR WHAT ROAD 30 ON WHICH SIDE OF ROAD (CIRCLE APPROPRIATE BOX) NORTH 255 WEST 32 EAST SOUTH 34 37 DISTANCE FROM ROAD 1/4 ENTER FT OR MI 38 39 TAX MAP: 28 BLK: 18 PARCEL 74

B 2 WELL INFORMATION APPROX. PUMPING RATE 5 (GAL. PER MIN.) 8 12 AVERAGE DAILY QUANTITY NEEDED 500 (GAL. PER DAY) 14 20

USE FOR WATER (CIRCLE APPROPRIATE BOX)

- D DOMESTIC POTABLE SUPPLY & RESIDENTIAL IRRIGATION F FARMING (LIVESTOCK WATERING & AGRICULTURAL IRRIGATION I INDUSTRIAL, COMMERCIAL, DEWATERING P PUBLIC WATER SUPPLY WELL T TEST, OBSERVATION, MONITORING G GEO-THERMAL

NOT TO BE FILLED IN BY DRILLER HEALTH DEPARTMENT APPROVAL

Howard 13 A517422 COUNTY NAME COUNTY NO. STATE SIGNATURE INSERT S 41 DATE ISSUED 12/4/2006 Brian Baker 12/4/2007 43 MM DD YY 48 CO SIGNATURE EXP. DATE NORTH GRID 507 000 EAST GRID 815 000 55 57 63

APPROXIMATE DEPTH OF WELL 150 24 28 FEET APPROXIMATE DIAMETER OF WELL 6 64 NEAREST INCH

METHOD OF DRILLING (circle one)

BORED (or Augered) JETTED Jetted & DRIVEN 30 AIR-ROTary AIR-PERCussion ROTARY (Hydraulic Rotary) 37 CABLE REVerse-ROTary DRive-POINT other

REPLACEMENT OR DEEPEMED WELLS (CIRCLE APPROPRIATE BOX)

N THIS WELL WILL NOT REPLACE AN EXISTING WELL Y THIS WELL WILL REPLACE A WELL THAT WILL BE ABANDONED AND SEALED S THIS WELL WILL REPLACE A WELL THAT WILL BE USED AS A STANDBY-CONTACT LOCAL APPROVING AUTHORITY FOR POLICY ON STANDBY WELLS D THIS WELL WILL DEEPEM AN EXISTING WELL PERMIT NUMBER OF WELL TO BE REPLACED OR DEEPEMED (IF AVAILABLE) 41 52

Not to be filled in by driller (MDE OR COUNTY USE ONLY)

APPROX. PERMIT NUMBER H02005G006 PERMIT No. H0-95-0583 70 71 72 73 74 75 76 77 78 79

SHOW MAJOR FEATURES OF BOX & LOCATE WELL WITH AN X SOURCES OF DRILLING WATER 1. well 2. 3.

WRITE THE BOX NUMBER FROM THE MAP HERE

E 815 N 507

DRAW A SKETCH BELOW SHOWING LOCATION OF WELL IN RELATION TO NEARBY TOWNS AND ROADS AND GIVE DISTANCE FROM WELL TO NEAREST ROAD JUNCTION

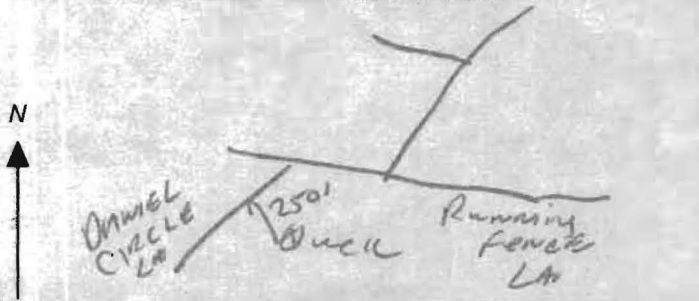

SPECIAL CONDITIONS

NOTE: APPROVING AUTHORITIES SHOULD USE SEPARATE SHEET IF NEEDED.

Need Radium Sample

**HOWARD COUNTY HEALTH DEPARTMENT
BUREAU OF ENVIRONMENTAL HEALTH
WATER AND SEWERAGE PROGRAM
TEL: (410)313-2640 FAX: (410)313-2648**

Information Form for the Installation of the Well Pump, Pitless Adapter, and Supply Piping

NOTE: The installer is responsible for requesting an inspection prior to 9 am on the day of the desired inspection. No work is to be covered until approved by the Health Department. All installations must comply with the National Standard Plumbing Code (NSPC, as amended locally) and COMAR 26.04.04 (MD Well Construction Regulations). Submission of a complete form is required prior to Use and Occupancy approval.

Company Name: NATIONAL WATER SUPPLY Telephone #: 301-854-1323
Address: P.O. Box 138
ASHTON, MD 20861

(Must circle one) Licensed Plumber Licensed Well Driller Licensed Well Pump Installer
License # and name of individual responsible for the field installation:
Name (Print): DAVID RUCKE License# P10145

*A licensed individual must perform the actual installation. Apprentices must be under the direct supervision of a licensed journeyman or master plumber, pump installer or well driller. Licenses may be subjected to field verification.

Name of Property Owner: Self/ridge Telephone #: 410-531-8990
Subdivision: Walnut Grove Lot #: 29 Well Tag #: HO-95-0523
Site Address: 12309 Daniel Circle LA
Clarksville, MD

<u>Submersible Pump Data</u>	<u>Pitless Adapter</u>	<u>Well Cap and Electric Conduit</u>
Make: <u>GRUNDFOS</u>	Make: <u>MARTINSON</u>	Two piece watertight cap: <input checked="" type="checkbox"/>
Model #: <u>15GE01H0</u>	Model #: <u>15-10x</u>	Screened, vented well cap: <input checked="" type="checkbox"/>
Pump Capacity: <u>20.15</u> GPM	Depth: <u>42</u> (36" min)	Cap secured to casing: <input checked="" type="checkbox"/>
Well Yield: <u>15</u> GPM	NSF approved: <input checked="" type="checkbox"/>	Conduit min 18" B.G.: <input checked="" type="checkbox"/>
Depth of well encountered at time of pump installation: <u>123</u> (feet)		Conduit secured to well cap: <input checked="" type="checkbox"/>

If pump capacity exceeds well yield, a low water cut off switch is required by NSPC 1990 Section 17.8.4
Torque arrestors or Cable guards are required - Must circle one
Safety rope, if used, attached to inside of well casing with eye bolt:

Piping to house
Type: POLY
PSI: 110 (160 psi min)
Depth of supply line: 42 (36" min)

House Connection
PVC sleeved to undisturbed soil at wall penetration:
Approximate length of sleeve:
Sleeve caulked and sealed properly:

The water supply line is required to be at least ten feet from the septic tank, pump chamber, sewage piping, distribution box, drainfields, and sewage reserve area. If this cannot be accomplished, contact this office for approval prior to installation.

Signature of company representative responsible for installation: _____ date: 10-14-09

For Health Department Use Only - Not to be completed by Installer

Date Insp. Requested: _____ Date Insp. Approved: 8/12/09 BB
Inspection Data: Pitless adapter and water supply line at least 36" below grade
Two piece cap installed and attached to casing securely
Elec. conduit extends at least 18" below grade/attached to cap properly
Safety rope installed inside of well casing
Correct well tag attached properly and casing 8" above finished grade
Water supply line sleeved adequately at house connection
Adequate grout observed below pitless adapter

GROUT 5' BELOW GRADE

DANIEL CIRCLE LN.

6+00

5+00

4+00

394

12/4/06

Well site to be staked by surveyor.

BB

398

400

FOE

402

FOE

402

FOE

30

400

29

402

398

W-29

FOE

396

398

400

402

404

394

FOE

FOE

FOE

394

394

394

394

LEGEND

- PROPOSED LPSS
- PROPOSED STORM DRAIN

HOUSE BOX



WELL BOX

W-05

WELL SURVEY POINT

WELL LOCATION EXHIBIT - LOT 29

WALNUT GROVE

Lots 1 thru 88, Buildable Preservation Parcel "A", Non-Buildable Preservation Parcels "B" Thru "I" And and Non-Buildable Bulk Parcel "J"

GLWGUTSCHICK LITTLE & WEBER, P.A.

CIVIL ENGINEERS, LAND SURVEYORS, LAND PLANNERS, LANDSCAPE ARCHITECTS
3909 NATIONAL DRIVE - SUITE 250 - BURTONSVILLE OFFICE PARK
BURTONSVILLE, MARYLAND 20866
TEL: 301-421-4024 BAL: 410-880-1820 DC/VA: 301-989-2524 FAX: 301-421-4186

SCALE: 1"=50'

ZONING: RC/RR-DEO

TAX MAP/GRID: 28-18/17

GLW JOB NO: 00153

OCT., 2006

1 OF 1



7178 Columbia Gateway Dr., Columbia, MD 21046
 (410) 313-2640 Fax (410) 313-2648
 TDD (410) 313-2323 Toll Free 1-866-313-6300
 website: www.hchealth.org

Penny E. Borenstein, M.D., M.P.H., Health Officer

TO ALL INTERESTED PARTIES

When submitting a well application for a proposed well for new construction, please indicate one of the following:

Well Site Location:

<i>Walnut Grove</i>	<i>29</i>	<i>Daniel Circle Lane</i>
Subdivision/Property Name	Lot #	Road Name

- Staking to take place after initial review (as discussed with Bob Weber).
- The well site has been staked by _____ ,
 (professional land surveyor or company employing professional land surveyors)
 on _____ (date) and does not require a site inspection.
- The well driller, builder or property owner will call the Health Department to schedule a time to meet in the field to verify the proposed well site location.

This sheet, along with two copies of an acceptable well site plan, must be attached to the green well permit application.

Revised 3/11/05

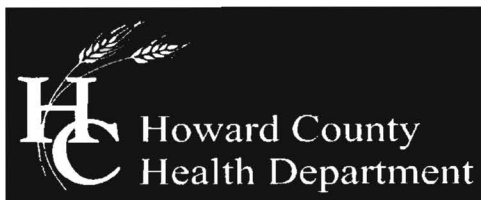

Bureau of Environmental Health
7178 Columbia Gateway Drive, Columbia, MD 21046-2147
(410) 313-2640 Fax (410) 313-2648
TDD (410) 313-2323 Toll Free 1-866-313-6300
website: www.hchealth.org

Peter L. Beilenson, M.D., M.P.H., Health Officer

November 6, 2009

Homowner
12309 Daniel Circle Lane
Clarksville, Maryland 21029

RE: Walnut Grove Lot 29
12309 Daniels Circle Lane
BP#B09000091
Well Tag: HO-95-0583

Dear Sirs:

This is to advise that the septic house connection and grinder pump installation for the referenced property has been installed and inspected. **Final approval was granted on 10/27/09. Final approval of the well line connection to the dwelling was approved on 8/12/09.**

The water sample results indicate that the water samples submitted for testing were free of coliform and fecal coliform bacteria at the time of sampling and are bacteriologically safe for drinking. The water sample results were found to be in compliance with COMAR water quality standards. Enclosed with this certificate is a copy of the septic as-built along with information on your well and how to keep your water quality safe.

INTERIM CERTIFICATE OF POTABILITY

This certifies that the **initial** sampling requirements of COMAR 26.04.04 "Well Regulations" have been met for the water supply installed under well permit #HO-95-0583. Although the submitted sample results are in compliance with COMAR standards, the Health Department does not guarantee water supplies. Based upon satisfactory investigation and evaluation, the Howard County Health Department, as authorized by the Maryland Department of the Environment accepts this well system as required by COMAR 26.04.04.

This certificate may become final upon completion of the second bacteriological test, which is to be taken by the county health department within six months of receipt of this letter. **Please contact (410) 313-1773 to schedule a final water sample appointment. Currently, there is no charge for this final sampling.**

Date of Water Samples: 9/9/09, 10/22/09
Date of Well Completion 1/17/07

Respectfully,

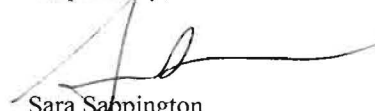

Sara Sappington
Well and Septic Program

cc. Building Inspectors Office
Community Environmental
File



TRACE LABORATORIES, INC
A Methode Electronics, Inc. Company
5 North Park Drive
Hunt Valley, MD 21030 USA
Telephone: 410/584-9099 / Fax: 410/584-9117
Website: www.traceclabs.com / Email: info@traceclabs.com

Maryland State Certified Laboratory # 318

CERTIFICATE OF ANALYSIS

Requester:
James H. Selfridge Builders, Inc
Attn: Bob
4781 Ten Oaks Road
Dayton, Maryland 21036

S/O Number: 74533
Report Date: October 22, 2009

Property Sampled: 12309 Daniel Circle Lane, 21042, Nitrate Retest

County: Howard
Subdivision: Walnut Grove
Lot #: 29
Building Permit #: B09000091
Tax Map #: 28
Parcel #: 74

Date/Time Collected: October 21, 2009 at 12:17 pm
Date/Time Received: October 21, 2009 at 3:13 pm

Sample Location: R/O Tap
Sampler ID: 5745KC
Samples Iced: Yes
Residual Cl₂ <0.1 mg/L: Yes

Well Tag Number: HO-95-0583
Well Condition: 2-Piece Cap
Satisfactory

Water Conditioning/Treatment: R/O

PARAMETER	RESULT	METHOD	MCL	
Nitrate	<1.0 mg/L as N	SM 4500D	10 mg/L as N	Pass

Katie Cammer for
Allison R. Milburn
Manager-Drinking Water Testing

MCL=Maximum Contamination Level

From: TRACE LABS INC

4105849117

09/09/2009 10:22

#196 P.002/002



TRACE LABORATORIES, INC
 A Methode Electronics, Inc. Company
 5 North Park Drive
 Hunt Valley, MD 21030 USA
 Telephone: 410/584-9099 / Fax: 410/584-9117
 Website: www.tracelebs.com / Email: info@tracelabs.com

Maryland State Certified Laboratory # 318

CERTIFICATE OF ANALYSIS

Requester:
 James H. Selfridge Builders, Inc
 Attn: Bob
 4781 Ten Oaks Road
 Dayton, Maryland 21036

S/O Number: 73952
Report Date: September 9, 2009

Property Sampled: 12309 Daniel Circle Lane, 21042

County: Howard
Subdivision: Walnut Grove
Lot #: 29
Building Permit #: B09000091
Tax Map #: 28
Parcel #: 74

Date/Time Collected: September 3, 2009 at 10:45 am
Date/Time Received: September 3, 2009 at 3:55 pm

Sample Location: Pressure Tank
Sampler ID: 5745KC
Samples Iced: Yes
Residual Cl₂ <0.1 mg/L: Yes

Well Tag Number: HO-95-0583
Well Condition: 2-Piece Cap
 Satisfactory

Water Conditioning/Treatment: None

PARAMETER	RESULT	METHOD	MCL/*SMCL	
Nitrate	15.1 mg/L as N	SM 4500D	10 mg/L as N	FAIL
Turbidity	<1.0 NTU	EPA 180.1	10 NTU	Pass
pH	7.5 Units	EPA 150.1	*6.5-8.5 Units	***
Sand	Negative		Negative	
Total Coliform	Absent	SM 9223B	Absent	Pass
E.coli	Absent	SM 9223B	Absent	Pass
Hardness:	240 mg/L as CaCO ₃ or 14 grains per gallon			Hard

Allison R. Milburn
 Manager-Drinking Water Testing

MCL=Maximum Contamination Level

*SMCL=Secondary Maximum Contamination Level

***A non-enforceable parameter that may cause cosmetic effects or aesthetic effects (such as taste, color or odor) in drinking water.

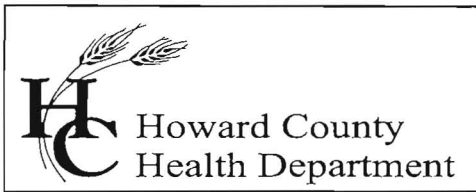

Bureau of Environmental Health
7178 Columbia Gateway Drive, Columbia, MD 21046
(410) 313-2640 Fax (410) 313-2648
TDD (410) 313-2323 Toll Free 1-866-313-6300
website: www.hchealth.org

Penny E. Borenstein, M.D., M.P.H., Health Officer

January 25, 2007

Walnut Grove, LLC
10705 Charter Dr.
Suite 320
Columbia, Maryland 21044

Daniel C. Ln

RE: Walnut Grove, Lot #29
Well Tag: HO-95-0583

To Whom It May Concern:

A sample was collected from a yield test on January 17, 2007 and submitted to GPL Laboratories to assess the possible presence of **Gross Alpha** and **Gross Beta** in the future well water supply. **Gross Alpha** and **Gross Beta** measure the total alpha and beta particle activity in a water supply. In turn, this can provide information regarding naturally occurring radiation (i.e., Radionuclides) that may exist in your area of development within the County.

Results from this screening revealed a **Gross Alpha** of 0.5 ± 0.7 picocuries/liter (pCi/L); while the **Gross Beta** level was 3.0 ± 0.3 pCi/L. The **Gross Alpha** result was below its maximum contaminant level (MCL) of 15 pCi/L, while the **Gross Beta** level was below its target value of 50 pCi/L (roughly equivalent to the annual dose rate of 4 millirems/year).

At the time of testing and with respect to these parameters, the future well water supply appears safe for all uses. No additional testing for these parameters will be required to secure the future Use & Occupancy. However, other standard (potability) testing will still be necessary.

A copy of the test results is enclosed for your information. Please call this office at 410-313-1773 if you have any further questions.

Sincerely,

Bert Nixon, Deputy Director
Bureau of Environmental Health

cc: Eric Dougherty, MDE Water Mgmt., Groundwater
✓ Well & Septic File

Send Report To: _____

State of Maryland
 DHMH - Laboratories Administration
 Division of Environmental Chemistry
RADIATION LABORATORY

201 W. Preston Street, Baltimore, Maryland 21201
 John M. DeBoy, Dr. P.H., Director

LABORATORY ANALYSIS REQUEST

Sample Bottle No. A: KW29 NC 0583 No. B: _____ Field Blank Bottle No. A: _____ No. B: _____

Plant/Site Name: Widout Grove Lot 29 County: Howard

Sample Source: Ground C 4A Location: HO-95-0583
 (well no., lab sink, sample tap, etc.)

County: Plant No.

CHECK (one per box)

Drinking Water <input checked="" type="checkbox"/>	Community <input type="checkbox"/>	Source (raw water) <input checked="" type="checkbox"/>	Emergency <input type="checkbox"/>
Landfill <input type="checkbox"/>	Non-community <input type="checkbox"/>	Distribution (treated) <input type="checkbox"/>	Routine <input checked="" type="checkbox"/>
Stream <input type="checkbox"/>	Private <input type="checkbox"/>	MCL <input type="checkbox"/>	Recheck <input type="checkbox"/>
Other <input type="checkbox"/>	Other <input type="checkbox"/>		Special <input type="checkbox"/>

Collector: K. Wolf Telephone No: 410-313-2645

Date Collected: 1/17/07 Time Collected: _____ a.m. 2:15 p.m.

Nitric Acid Preserved: Yes No Iced: Yes No

Submitters Code: Federal Project: Field Data: _____

Remarks: Sample Taken During Yield Test pH _____ Chlorine _____

✓	Test	EPA Code	Laboratory No.	Results (pCi/L)	Date Reported
✓	Gross Alpha	4000	<u>711195-004</u>	<u>0.5 ± 0.7</u>	<u>1/23/07</u>
✓	Gross Beta	4100		<u>3.0 ± 0.3</u>	
	Radon-222 Bottle A	4004			
	Radon-222 Bottle B	4004			
	Field Blank A	4004			
	Field Blank B	4004			
	Tritium				
	Ra - 226	4020			
	Ra - 228	4030			
	Total Uranium	4006			

Date Received: _____ / _____ / _____

Supervisor: _____