

12/29/01
0:00
4/5/01
12:00:00
4/6/01 1:00

PERMIT

SEWAGE DISPOSAL SYSTEM
HOWARD COUNTY HEALTH DEPARTMENT
BUREAU OF ENVIRONMENTAL HEALTH
410-313-2640

P 515009
A REPAIR

04-320093
Homeowner & John Goodman

ISSUE DATE 3/27/2001
APPROVAL DATE 4/6/01

INDEXED

~~Arnolds Backhoe & Septic Service~~ Homeowner IS PERMITTED TO INSTALL ALTER

ADDRESS P.O. Box 15, Woodbine, MD 21797 PHONE 410-795-7873

SUBDIVISION Cornett Property LOT NUMBER 1 ADDRESS 1818 Daisy Road

PROPERTY OWNER Mark & Ellen James PROPERTY OWNER'S ADDRESS Same

SEPTIC TANK CAPACITY 1000 GALLONS

PUMP CHAMBER CAPACITY NA GALLONS

NUMBER OF BEDROOMS 3

SQUARE FEET PER BEDROOM 210

LINEAR FEET OF TRENCH REQUIRED 200-210

*prev Loudermilk
Johnson Cornett*

TRENCHES: Trenches to be 3 feet wide. Inlet 4 feet below original grade. Bottom maximum depth 6 feet below original grade. 2 feet of stone below distribution box.

LOCATION: REPAIR - PURPOSE - Existing septic system has failed. Call for inspection when ground is opened so sanitarian can recommend repair. 3/27/01

3 TRENCHES 60-70' EACH

PLANS APPROVED Mark Rifkin (SRW) DATE 3/29/01

PERMIT VOID AFTER 2 YEARS

NOTE: CONTRACTOR RESPONSIBLE FOR SCHEDULING A PRE-CONSTRUCTION INSPECTION FOR ALL INSTALLATIONS **BUILDING PERMIT SIGNED**

NOTE: TOP OF SEPTIC TANKS ARE TO BE NO DEEPER THAN 3.0 FEET BELOW FINISH GRADE **AND RETURNED**

NOTE: WATERTIGHT SEPTIC TANKS REQUIRED *10/16/2002 B00138536 NEW MASTER BATH + POWDER RM - EXTEND EX. PORCHES*

NOTE: CLEANOUT REQUIRED EVERY 70 FEET OF SEWER LINE AND/OR AT 90° SWEEPS IN LINES FROM HOUSE TO DRAIN FIELDS, 90° ELBOWS ARE NOT ACCEPTABLE

NOTE: ALL PARTS OF SEPTIC SYSTEMS (I.E. TANK, DISTRIBUTION BOX, DRAINFIELDS) TO BE 100 FEET FROM ANY WATER WELL UNLESS OTHERWISE SPECIFICALLY AUTHORIZED

NOTE: NO ABSORPTION TRENCH TO EXCEED 100 FEET IN LENGTH UNLESS SPECIFICALLY AUTHORIZED

NOTE: ALL PIPE FROM HOUSE TO SEPTIC TANK MUST BE CAST IRON OR SCHEDULE 35/40 PVC OR ABS

NOTE: MANHOLE RISERS REQUIRED ON ALL SEPTIC TANKS AND PUMP CHAMBERS

NOTE: DISTRIBUTION BOXES MUST HAVE BAFFLES

NOTE: IF PUMPED SEPTIC SYSTEM REQUIRED, (1) SEPTIC PUMP DETAIL TO BE PROVIDED BY INSTALLER PRIOR TO ISSUANCE OF SEPTIC PERMIT (2) PUMP PERFORMANCE TEST IS NECESSARY PRIOR TO HEALTH DEPARTMENT APPROVAL OF SEPTIC PERMIT

NEITHER THE HOWARD COUNTY COUNCIL NOR THE HEALTH DEPARTMENT IS RESPONSIBLE FOR THE SUCCESSFUL OPERATION OF ANY SYSTEM
PERMITTEE RESPONSIBLE FOR OBTAINING FINAL APPROVAL ON THIS PERMIT
CALL 410-313-2640 FOR INSPECTION OF SEPTIC SYSTEM

515009

10:58

11:00

11:13

4/3

① 43

10:58

11:01

11:01

11:13

11 min

②

①

NOT TO SCALE

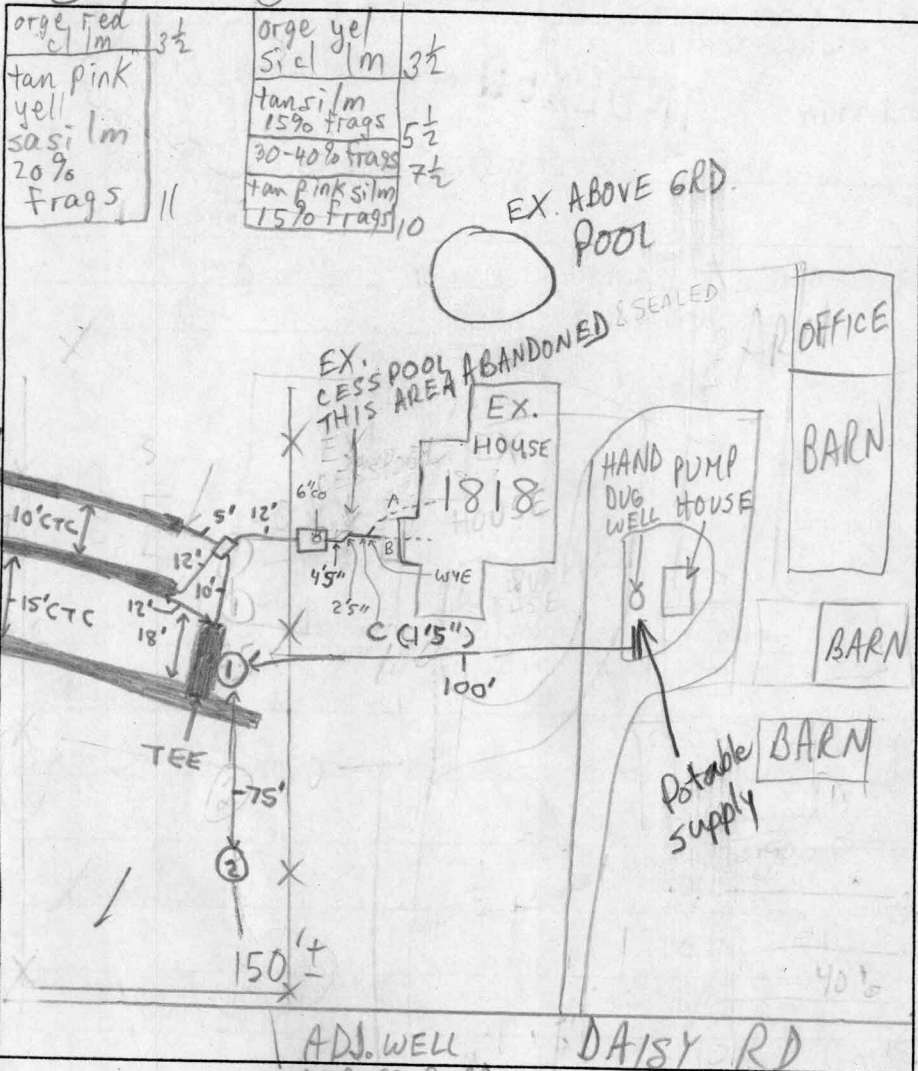

TRENCH DATA

TRENCH WIDTH 3'
 TRENCH INLET DEPTH 4'
 TRENCH BOTTOM DEPTH 6'
 DEPTH OF STONE 2'
 NUMBER OF TRENCHES 3
 TOTAL TRENCH LENGTH 203'
 ABSORBENT AREA 609 ft²
 DISTRIBUTION BOX LEVEL
 BAFFLE IN DISTRIBUTION BOX

SEPTIC TANK DATA

SEPTIC TANK 1500 TS GALLONS
 BAFFLES IN NA
 MANHOLE RISER NA - Tank Shallow
 6 INCH INSPECTION PORT on front

PUMP CHAMBER DATA

PUMP CHAMBER GALLONS NA
 MANHOLE RISER NA
 ALARM NA
 PUMP PERFORMANCE TEST NA

PRE-CONSTRUCTION INSPECTION: 3/29/01 OK TO START (MR)

INSPECTION COMMENTS: 4/5/01 S-T. SET, NO OTHER WORK (MR)

4/6/01 - HOUSE HAS TWO HOUSE SEWERS → A-IS EXISTING PVC COMING FROM KITCHEN, B-IS EX. CAST IRON FROM HOUSE, NEW PVC PIPE CONNECTED W/ PVC WYE
 EX. KITCHEN SEWER & FERNCO COUPLING CONNECTED TO EX. CAST IRON, NEW PVC TO NEW SEPTIC TANK, EX. CESSPOOL ABANDONED & SEALED (SRK)

INSPECTOR Steven R. Krieg

DATE SYSTEM APPROVED 4/6/01