

# APPLICATION

PERCOLATION TESTING

A 517904

F \_\_\_\_\_

HOWARD COUNTY HEALTH DEPARTMENT  
BUREAU OF ENVIRONMENTAL HEALTH  
3525-H ELLICOTT MILLS DRIVE/ELLICOTT CITY, MARYLAND 21043  
TELEPHONE: 313-2640

DISTRICT \_\_\_\_\_

DATE 9/5/02

TO: THE COUNTY HEALTH OFFICER  
ELLICOTT CITY, MARYLAND

I HEREBY APPLY FOR THE NECESSARY TEST PRIOR TO APPLICATION FOR PERMIT TO CONSTRUCT (OR RECONSTRUCT) A SEWAGE DISPOSAL SYSTEM.

PROPERTY OWNER DORSEY MILL L.L.C.  
ADDRESS 14045 GARED DRIVE  
GLENWOOD, MD 21738 PHONE 410-531-8950  
FAX 410-531-8959

AGENT OR PROSPECTIVE BUYER \_\_\_\_\_  
ADDRESS \_\_\_\_\_ PHONE \_\_\_\_\_

PROPERTY LOCATION:

SUBDIVISION DORSEY MILL ROAD LOT NO. \_\_\_\_\_

ROAD AND DESCRIPTION 14445 DORSEY MILL RD, GLENELG, MD 21737

TAX MAP 21 PARCEL # 227

SIZE OF LOT 53.87 AC. TYPE BLDG. SINGLE FAMILY DWELLING  
(SINGLE FAMILY DWELLING OR COMMERCIAL)

THE SYSTEM INSTALLED UNDER THIS APPLICATION IS ACCEPTABLE ONLY UNTIL PUBLIC FACILITIES BECOME AVAILABLE. I FULLY UNDERSTAND THE FEE CONNECTED WITH THE FILING OF THIS PERC TEST APPLICATION IS NON-REFUNDABLE UNDER ANY CIRCUMSTANCES. I ALSO AGREE TO COMPLY WITH ALL M.O.S.H.A. REQUIREMENTS IN TESTING THIS LOT.

James H. Selfish  
(SIGNATURE OF APPLICANT)

APPROVED BY \_\_\_\_\_ FOR \_\_\_\_\_ DATE \_\_\_\_\_

DISAPPROVED BY \_\_\_\_\_ FOR \_\_\_\_\_ DATE \_\_\_\_\_

HOLD PENDING FURTHER TESTS \_\_\_\_\_

REASONS FOR REJECTION OR HOLDING \_\_\_\_\_

PERCOLATION TEST PLAT/PRELIMINARY PLAT - TITLE OR I.D. # \_\_\_\_\_ DATE \_\_\_\_\_

SITE DEVELOPMENT PLAN/FINAL PLAT - TITLE OR I.D. # \_\_\_\_\_ DATE \_\_\_\_\_

# THIS IS NOT A PERMIT

517904

NOT TO SCALE

COUNTY #

SOIL PROFILE 3530

0' org-brn silty clay 1m

4' tan-brn powdery sandy 1m (fine) no obvious signs of redox features

14'6"

3531

2' org-brn silt 1m 20% Rock

4' org-brn sandy clay 1m

tan-brn/org powdery fine sandy 1m no obvious signs of redox features

14'6"

3532

2' brn silt 1m

org-brn sandy clay 1m

4' tan-brn powdery fine sandy 1m

faint grey mottles in parent material depth unknown

15'

SOIL PROFILE 3533

0' brown silt 1m

2' org-brn silty clay 1m

4' tan-brn powdery sandy 1m (fine)

no obvious signs of redox features

14'8"

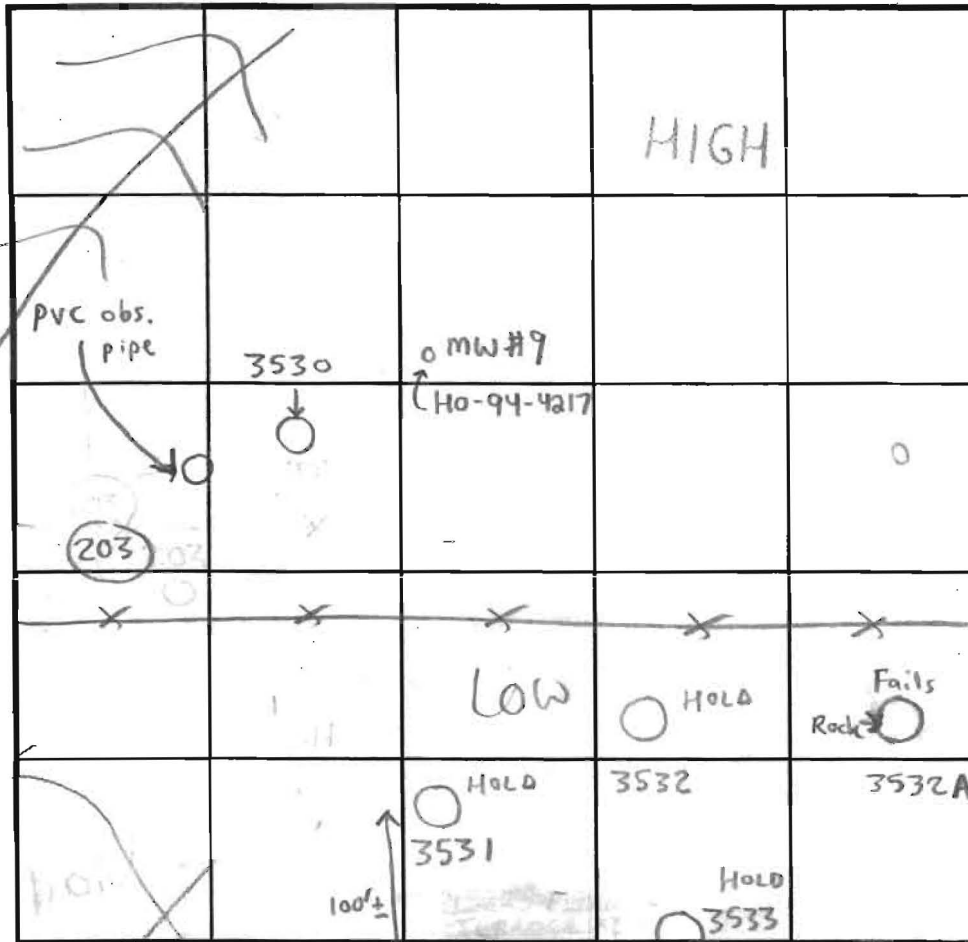

INDICATE NORTH - NAME ADJOINING ROADWAY AS BASE LINE.

DATE	TEST NO.	DEPTH	PRE-WET		TEST - 1" DROP		TIME	
			START	STOP	START	STOP		
12/3/02	3530	5'T / 14'6"V	11:56 am	12:06 pm	12:06 pm	12:10 pm	4 min	OK
	3531	6'T / 14'6"V	10:31 am	10:37 am	10:37 am	10:41 am	4 min	OK
		(WILL PROBABLY PERC HIGHER)						
	3532	5'9" T / 15' V	10:44 am	11:00 am	11:00 am	11:13 am	13 min	OK
	3533	5'T / 14'8"V	11:24 am	11:30 am	11:30 am	11:40 am	10 min	OK
10/28/98	203	4'T / 18'V	(PREVIOUSLY EVAL. BY RON)				8 min	HOLD/RE-EVAL. (GKSRV)
			PINKLEY - Potential		Redox			

REMARKS Site Data, previous Monitoring Well Data, & landscape position, indicate treatment zone

TYPE OF SOIL Manor + could be lithochromatic

TESTED BY SRK Donnie Simpson = Backhoe (Hatfields) ALSO PRESENT Bob Sheesley - 12/3/02 Jim Selfridge - 12/3/02

TRENCH DESIGN DATA: AVERAGE PERCOLATION TIME 2-7min TRENCH WIDTH 3'

INLET DEPTH 3 MAXIMUM BOTTOM DEPTH 5 SQ. FT./BEDROOM 180

SHALLOW SYSTEM ONLY!

517904

1001 10 SCALE

COUNTY #

SOIL PROFILE

0' 3526  
brn lm

1' tan-brn heavy lm

2' yellow-red fine sandy lm micaceous NO ROCK

13'

3527

SEE 3526

15'

3528

2' red-brn loam

4' creamy-white/tan-brn silt lm

tan/beige powdery fine sandy lm

NO ROCK  
No obvious signs of redox features

14'

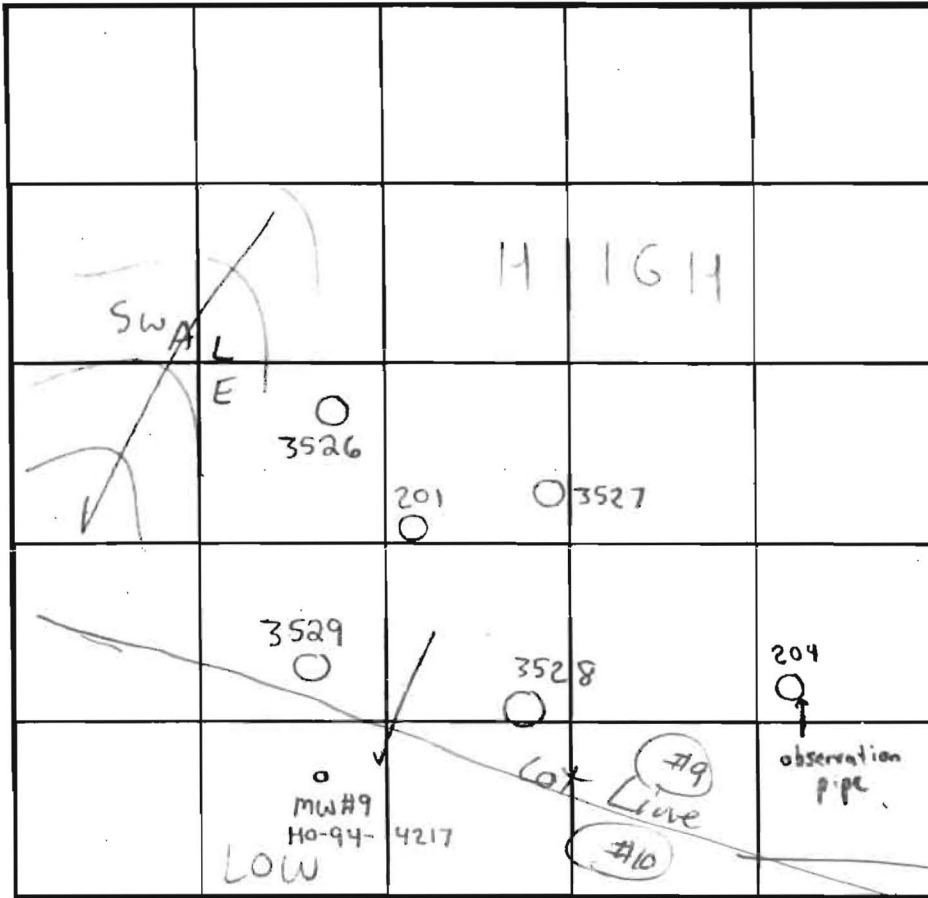

INDICATE NORTH - NAME ADJOINING ROADWAY AS BASE LINE.

SOIL PROFILE 3529

SAME AS 3528

DATE	TEST NO.	DEPTH	PRE-WET		TEST - 1" DROP		TIME
			START	STOP	START	STOP	
12/4/02	3526	13'V	(VISUAL	OK	SEE SOIL PROFILE)	NA	OK
	3527	15'V	("	"	" " "	NA	OK
12/3/02	3528+	14'V	(VISUAL	OK	SEE SOIL PROFILE)	NA	OK
	3529+	6' T / 14'V	12:15pm	12:20pm	12:20pm	12:30pm	10min OK
10/27/98	201	4' T / 18'V	(PREVIOUSLY EVAL. BY RON PINKLEY)			2min	OK

REMARKS + MW #9 - indicates that adequate treatment zone exists downhill & below prop. SDA  
 (addition of extra buffer taken into consideration for MW #9 data in 2000)

TYPE OF SOIL Glenelg

TESTED BY SRK Donnie Simpson - Hatfields ALSO PRESENT Jim Seifridge - 12/3/02 & 12/4  
(Backhoe) Bob Sheedy - 12/3/02

TRENCH DESIGN DATA: AVERAGE PERCOLATION TIME 2-7min OK TRENCH WIDTH 3

INLET DEPTH 3 MAXIMUM BOTTOM DEPTH 5 SQ. FT./BEDROOM 180

Lot 9

