

6/21/01
Repair
10:00

PERMIT

SEWAGE DISPOSAL SYSTEM

HOWARD COUNTY HEALTH DEPARTMENT
BUREAU OF ENVIRONMENTAL HEALTH
410-313-2640

P 515299

A REPAIR

ISSUE DATE 6/21/2001

APPROVAL DATE 6/21/01

INDEXED
05-370280

Jack Fyock Septic Service IS PERMITTED TO INSTALL ALTER X

ADDRESS P.O. Box 89, Glenelg, MD 21737 PHONE (410) 988-9270

SUBDIVISION Mooresfield LOT NUMBER 2 ADDRESS 7550 Cherry Tree Drive

PROPERTY OWNER Squires PROPERTY OWNER'S ADDRESS same

SEPTIC TANK CAPACITY 1000 existing GALLONS

PUMP CHAMBER CAPACITY NA GALLONS

NUMBER OF BEDROOMS 3

SQUARE FEET PER BEDROOM 240

LINEAR FEET OF TRENCH REQUIRED 120

TRENCHES: Trenches to be 2 feet wide. Inlet 3 1/2 feet below original grade. Bottom maximum depth 9 1/2 feet below original grade. 6 feet of stone below distribution box.

LOCATION:

REPAIR - PURPOSE - Existing septic system has failed.
Call for inspection when ground is opened so sanitarian can recommend repair. 6-19-01

Tie existing dry well in parallel via dist Box to new drainfield trenches (2x60L feed) and place an auto breaker set high on pipe to old dry well so it remains dry for several years before resuming its use. RPP 6/21/01

PLANS APPROVED Luella Malley DATE 6/21/01

PERMIT VOID AFTER 2 YEARS

NOTE: CONTRACTOR RESPONSIBLE FOR SCHEDULING A PRE-CONSTRUCTION INSPECTION FOR ALL INSTALLATIONS

NOTE: TOP OF SEPTIC TANKS ARE TO BE NO DEEPER THAN 3.0 FEET BELOW FINISH GRADE

NOTE: WATERTIGHT SEPTIC TANKS REQUIRED

NOTE: CLEANOUT REQUIRED EVERY 70 FEET OF SEWER LINE AND/OR AT 90° SWEEPS IN LINES FROM HOUSE TO DRAIN FIELDS, 90° ELBOWS ARE NOT ACCEPTABLE

NOTE: ALL PARTS OF SEPTIC SYSTEMS (I.E. TANK, DISTRIBUTION BOX, DRAINFIELDS) TO BE 100 FEET FROM ANY WATER WELL UNLESS OTHERWISE SPECIFICALLY AUTHORIZED

NOTE: NO ABSORPTION TRENCH TO EXCEED 100 FEET IN LENGTH UNLESS SPECIFICALLY AUTHORIZED

NOTE: ALL PIPE FROM HOUSE TO SEPTIC TANK MUST BE CAST IRON OR SCHEDULE 35/40 PVC OR ABS

NOTE: MANHOLE RISERS REQUIRED ON ALL SEPTIC TANKS AND PUMP CHAMBERS

NOTE: DISTRIBUTION BOXES MUST HAVE BAFFLES

NOTE: IF PUMPED SEPTIC SYSTEM REQUIRED, (1) SEPTIC PUMP DETAIL TO BE PROVIDED BY INSTALLER PRIOR TO ISSUANCE OF SEPTIC PERMIT (2) PUMP PERFORMANCE TEST IS NECESSARY PRIOR TO HEALTH DEPARTMENT APPROVAL OF SEPTIC PERMIT

NEITHER THE HOWARD COUNTY COUNCIL NOR THE HEALTH DEPARTMENT IS RESPONSIBLE FOR THE SUCCESSFUL OPERATION OF ANY SYSTEM
PERMITTEE RESPONSIBLE FOR OBTAINING FINAL APPROVAL ON THIS PERMIT
CALL 410-313-2640 FOR INSPECTION OF SEPTIC SYSTEM

515299

1106H
 Jack Brunson
 yel. An. CL
 (2 m. 20 ft)
 yellow h.L.
 (HCS 6")
 yel. + Red Pipe
 h.L. - L (HCS 6")
 20 m. 20 ft

A₂ 10:59 1st Nail
 11:03 2nd Nail
 11:43 3rd Nail

estimate Need 240 sq ft / Bdr
 $\div 6$ ft off side wall
 $\times 4$ LF / Bdr
 $\times 3$
 120 LF Trench Total

40 mpi @
 est 10 mpi below 5 ft
 (ave rate of 20 mpi) R/P 6/21/01

NOT TO SCALE

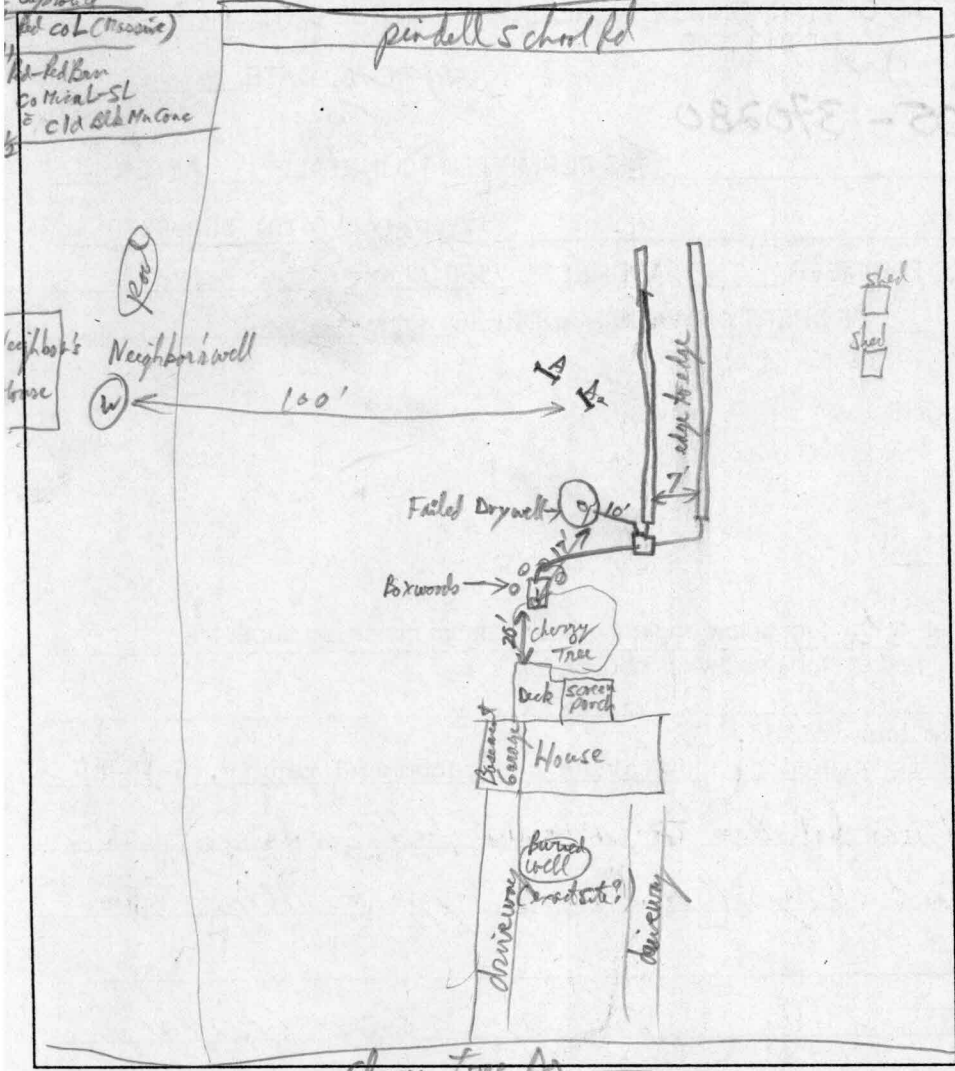

TRENCH DATA	
TRENCH WIDTH	2'
TRENCH INLET DEPTH	4'
TRENCH BOTTOM DEPTH	10'
DEPTH OF STONE	6'
NUMBER OF TRENCHES	2 x 60' each
TOTAL TRENCH LENGTH	120 LF
ABSORBENT AREA	720 sq ft
DISTRIBUTION BOX LEVEL	<input checked="" type="checkbox"/>
BAFFLE IN DISTRIBUTION BOX	<input checked="" type="checkbox"/>

SEPTIC TANK DATA	
SEPTIC TANK	existing 1000 GALLONS
MANHOLE RISER	NA
6 INCH INSPECTION PORT	<input checked="" type="checkbox"/>

PUMP CHAMBER DATA	
PUMP CHAMBER GALLONS	NA
MANHOLE RISER	
ALARM	
PUMP PERFORMANCE TEST	

PRE-CONSTRUCTION INSPECTION: OK to place New Trenches parallel to existing dry well (10 ft sidewall to sidewall separation required) and run trench downhill (about 1/4" drop in elevation). Connect via dist box with auto level set high on pipe to old dry well. R/P 6/21/01

INSPECTION COMMENTS: Dist Box OK (has high auto leveler to old dry well) First trench OK to cover, second trench half done OK to cover when finished. R/P 6/21/01

INSPECTOR R/P Pinby DATE SYSTEM APPROVED 6/21/01