

LAYOUT 7/5/10 INSP 4 _____
 INSP 2 7/12/2010 INSP 5 _____
 INSP 3 7/13/2010 INSP 6 _____

ISSUE DATE: 6/23/10
 APPROVAL DATE: 8/4/2010

PERMIT

P 533304
 A 528887

Tax ID # 05341140

**ON-SITE SEWAGE DISPOSAL SYSTEM
 HOWARD COUNTY HEALTH DEPARTMENT
 BUREAU OF ENVIRONMENTAL HEALTH**

SOUTH CARROLL BACKHOE IS PERMITTED TO INSTALL ALTER

ADDRESS: SALEM BOTTOM RD WESTMINSTER PHONE NUMBER: 410.875.4197

SUBDIVISION: Glen Mary Estates LOT NUMBER: 6

ADDRESS: 5610 Chamblis Drive (Tenant House) PROPERTY OWNER: George Doetsch

SEPTIC TANK CAPACITY (GALLONS): 1500 OUTLET BAFFLE FILTER REQUIRED

PUMP CHAMBER CAPACITY (GALLONS): 1250
1500 COMPARTMENTED TANK REQUIRED

NUMBER OF BEDROOMS: 3 APPLICATION RATE: 0.8

SQUARE FOOTAGE OF HOUSE: 2300

LINEAR FEET OF TRENCH REQUIRED: 160
140

TRENCHES:	Trenches to be <u>3</u> feet wide. Inlet 3.0 feet below original grade. Bottom maximum depth 5.0 feet below grade. Effective area begins at 3.0 feet below original grade with 2.0 feet of stone below distribution pipe.
LOCATION:	Pump tank must be installed (pump not required). Orient septic and pump tanks toward NW portion of septic reserve, per mark up. Set distribution box per layout inspection. Install 2x50' and 1x60' trenches on contour toward south. *Condition: Septic installation permit will not be approved until source for water at barn is confirmed.
NOTES:	Do not order the septic tank until after layout inspection and Sanitarian approval. Stake septic easement corners. Call for layout inspection. Mark utilities. Gravel tickets must be available for Environmental Sanitarians. Stone must be approved by the Howard County Health Department. A written variance request is required for tanks deeper than 3 feet. A traffic bearing lid is required for tanks deeper than 4 feet.

PLANS APPROVED: Robert Bricker DATE: 3/12/10

- NOTE: PERMIT VOID AFTER 2 YEARS
- NOTE: CONTRACTOR RESPONSIBLE FOR SCHEDULING A PRE-CONSTRUCTION INSPECTION FOR ALL INSTALLATIONS
- NOTE: WATERTIGHT SEPTIC TANKS REQUIRED
- NOTE: ALL PARTS OF SEPTIC SYSTEM SHALL BE 100 FEET FROM ANY WATER WELL
- NOTE: MANHOLE RISERS REQUIRED ON ALL SEPTIC TANKS AND PUMP CHAMBERS

NEITHER THE HOWARD COUNTY COUNCIL OR THE HEALTH DEPARTMENT IS RESPONSIBLE FOR THE SUCCESSFUL OPERATION OF ANY SYSTEM PERMITTEE RESPONSIBLE FOR OBTAINING FINAL APPROVAL ON THIS PERMIT CALL 410-313-1771 FOR INSPECTION OF SEPTIC SYSTEM

NOT TO SCALE

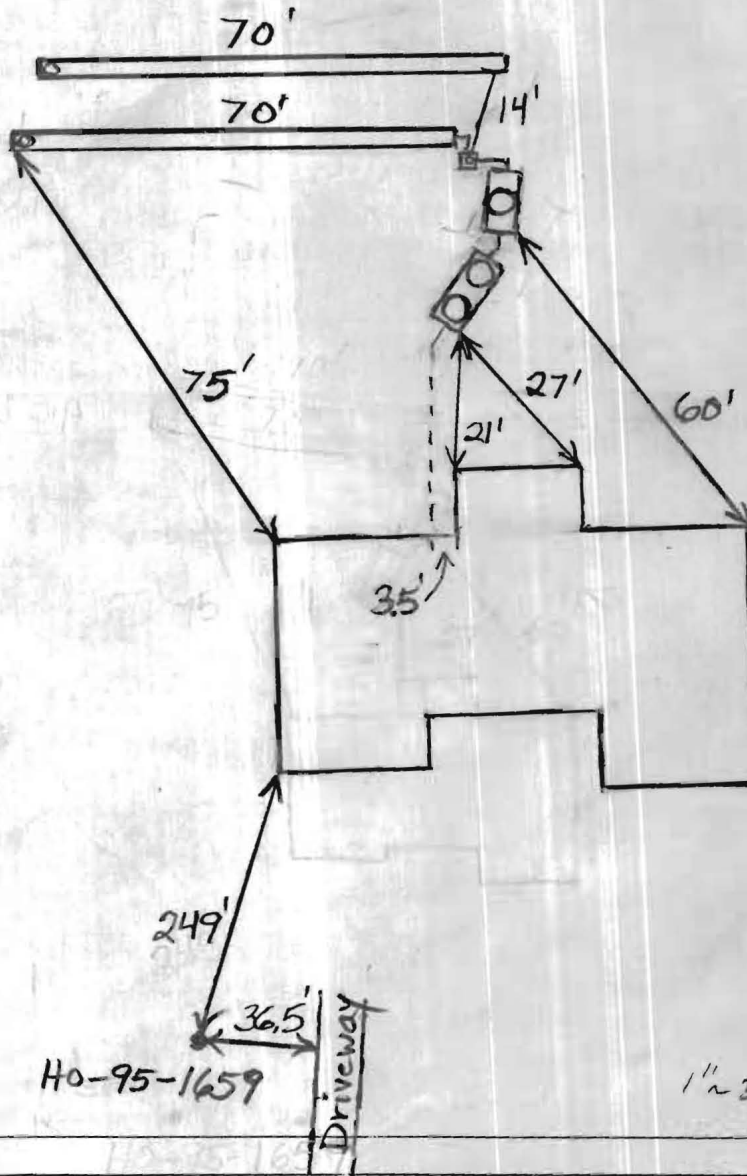

TRENCH/DRAINFIELD DATA

WIDTH	INLET	BOTTOM
3'	3'	5'
NUMBER OF TRENCHES		2
TOTAL LENGTH		140'
ABSORPTION AREA		420 + Sidewall
DISTRIBUTION BOX LEVEL		Yes
DISTRIBUTION BOX BAFFLE		Yes
DISTRIBUTION BOX PORT		Yes

SEPTIC TANK DATA

SEPTIC TANK 1 LEVEL	Yes
MANUFACTURER	Babylon
CAPACITY	1500 GAL
SEAM LOC	Top
TANK LID DEPTH	0.5'-1'
BAFFLES	Yes
BAFFLE FILTER	No
MANHOLE LOC	Front
6" PORT LOC	None
WATERTIGHT TEST	No
SLOTTED	Yes

PUMP/SEPTIC TANK LEVEL

PUMP/SEPTIC TANK LEVEL	Yes
MANUFACTURER	Babylon
CAPACITY	1250 GAL
SEAM LOC	Top
TANK LID DEPTH	0.5'-1'
BAFFLES	Front
BAFFLE FILTER	No
MANHOLE LOC	Middle
6" PORT LOC	None
WATERTIGHT TEST	No
SLOTTED	No

PRE-CONSTRUCTION

7/8/10 Sewer-out not coming out of house as shown. Moved 15' or so to the left. OK to set 1250g Pump

Trenches to be 3' wide, depth's the same. Install 2 x 70' trenches across top part of SRA. Call for inspection 7/13/2010

- INSTALLATION:
- 7/12/2010 Tanks installed. Trenches finished. Need plumbing to house and levelers. (BB)
 - 7/13/2010 Levelers installed. Need house connection. (BB)
 - 8/4/2010 House connection made. (BB)

FINAL INSPECTOR

B. Baker

DATE OF APPROVAL

8/4/2010

LOT 2
GLEN MARY EST.
PLAT # 5471
ZONED RC
N88°43'20"E

Wall Check ok
Approved as Shown
D Bernard
6-23-10

1205.88'

60' BRL

WELL
HO-95-1659



135.5'

1273.3'

1440.6'

LOT 6

SURVEYOR'S CERTIFICATE

THIS DRAWING WAS MADE UNDER MY SUPERVISION

Donald A. Mason

DONALD A. MASON
PROFESSIONAL LAND SURVEYOR
MARYLAND REG. No. 21320
FEMA FIRM No. 240044 0026 b
ZONE: C
DATED: 12/4/86



EXHIBIT TO ACCOMPANY A WALL CHECK

GLEN MARY ESTATES
RECORD PLAT No. 12801
LOT No. 6

5610 SE CHAMBLIS DRIVE

5th ELECTION DISTRICT

HOWARD COUNTY, MARYLAND

SCALE: 1" = 100' DATE: 6-18-10

BENCHMARK

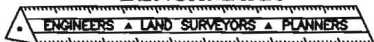

ENGINEERING, INC.

8480 BALTIMORE NATIONAL PIKE ▲ SUITE 418
ELLCOTT CITY, MARYLAND 21043
phone: 410-465-6105 ▲ fax: 410-465-6644
www.bei-civilengineering.com

FIELD OBS. BY
COMP. BY
DRAWN BY

SEPTIC SPECIFICATIONS WORKSHEET

~~Repair~~ Upper Reserve area
~~Partial System~~ only

Subdivision Glen Mary Estates * * *

Street Name 5610 Chambliss Dr Tenant location A _____

Average Percolation Rate (min./in.) 4.7 (split septic Reserve) Lot Number 6

Number of Bedrooms unknown Design Flow (BRx150) _____

Square Footage (of House) unknown Septic Tank Capacity (gal.) 1500 or 2000

Sidewall Credit / % Reduction 4.5133 Total Length of Trench (ft.) 202
per bedroom *

*All Septic/Pump tanks must be top seamed unless otherwise approved by this agency.

*All Septic tanks must be compartmented unless otherwise approved by this agency.

Baffle Filter Required? Yes No

TRENCH DIMENSIONS: Trench to 2 feet wide. Inlet at 3 feet below original grade. Bottom maximum depth 8 feet below original grade. Effective area begins at 3.5 feet below original grade. 5 feet of stone below the distribution pipe.

even # Bedrooms use 2' wide
odd # Bedrooms use 3' wide

PUMP SYSTEM PROPOSED? YES NO probably

Pump system details: 1500 gallon pump chamber

Note 1: Septic pump detail to be provided by installer prior to issuance of septic permit.

Note 2: Pump performance test required prior to Health Department approval of pumped septic system.

LOCATION: Install trenches on contour at upper septic reserve boundary

ADDITIONAL NOTES: Stake septic reserve corners.

RB

12/10/2009