

10:00  
4/20/01  
2:00

# PERMIT

## SEWAGE DISPOSAL SYSTEM

HOWARD COUNTY HEALTH DEPARTMENT  
BUREAU OF ENVIRONMENTAL HEALTH  
410-313-2640

P 515029-A

A 511427-A

ISSUE DATE 4/6/2001

APPROVAL DATE 4/27/01

INDEXED

K & K Excavating IS PERMITTED TO INSTALL  ALTER

ADDRESS 14960 Frederick Road, Woodbine, MD 21797 PHONE 410-442-1336

SUBDIVISION Whispering Pines LOT NUMBER 1 ADDRESS 6585 Cedar Lane

PROPERTY OWNER ADZ Homes Inc PROPERTY OWNER'S ADDRESS Box 436, Stevenson 21153

SEPTIC TANK CAPACITY 1250 GALLONS \*WATERTIGHT SEPTIC TANK REQUIRED\*

PUMP CHAMBER CAPACITY N/A GALLONS

NUMBER OF BEDROOMS 4

SQUARE FEET PER BEDROOM 180

LINEAR FEET OF TRENCH REQUIRED 240

**BUILDING PERMIT SIGNED  
AND RETURNED**

92603 B00

TRENCHES: Trenches to be 3 feet wide. Inlet 4 feet below original grade. Bottom maximum depth 6 feet below original grade. 2 feet of stone below distribution box.

LOCATION: Place the distribution box 130' up the left (279.94') lot line and 45 feet off this same lot line. Run (3) trenches on contour to right side of lot.

BEST

TRENCH LAYOUT WILL BE DETERMINED DURING LAYOUT INSP.

PLANS APPROVED Mark Rifkin, R.S. OK SRU 2/2/01 DATE 1/31/2001

PERMIT VOID AFTER 2 YEARS

NOTE: CONTRACTOR RESPONSIBLE FOR SCHEDULING A PRE-CONSTRUCTION INSPECTION FOR ALL INSTALLATIONS

NOTE: TOP OF SEPTIC TANKS ARE TO BE NO DEEPER THAN 3.0 FEET BELOW FINISH GRADE

NOTE: WATERTIGHT SEPTIC TANKS REQUIRED

NOTE: CLEANOUT REQUIRED EVERY 70 FEET OF SEWER LINE AND/OR AT 90° SWEEPS IN LINES FROM HOUSE TO DRAIN FIELDS, 90° ELBOWS ARE NOT ACCEPTABLE

NOTE: ALL PARTS OF SEPTIC SYSTEMS (I.E. TANK, DISTRIBUTION BOX, DRAINFIELDS) TO BE 100 FEET FROM ANY WATER WELL UNLESS OTHERWISE SPECIFICALLY AUTHORIZED

NOTE: NO ABSORPTION TRENCH TO EXCEED 100 FEET IN LENGTH UNLESS SPECIFICALLY AUTHORIZED

NOTE: ALL PIPE FROM HOUSE TO SEPTIC TANK MUST BE CAST IRON OR SCHEDULE 35/40 PVC OR ABS

NOTE: MANHOLE RISERS REQUIRED ON ALL SEPTIC TANKS AND PUMP CHAMBERS

NOTE: DISTRIBUTION BOXES MUST HAVE BAFFLES

NOTE: IF PUMPED SEPTIC SYSTEM REQUIRED, (1) SEPTIC PUMP DETAIL TO BE PROVIDED BY INSTALLER PRIOR TO ISSUANCE OF SEPTIC PERMIT (2) PUMP PERFORMANCE TEST IS NECESSARY PRIOR TO HEALTH DEPARTMENT APPROVAL OF SEPTIC PERMIT

NEITHER THE HOWARD COUNTY COUNCIL NOR THE HEALTH DEPARTMENT IS RESPONSIBLE FOR THE SUCCESSFUL OPERATION OF ANY SYSTEM  
PERMITTEE RESPONSIBLE FOR OBTAINING FINAL APPROVAL ON THIS PERMIT  
CALL 410-313-2640 FOR INSPECTION OF SEPTIC SYSTEM

PERMIT SIGNED  
AND RETURNED 8/1/2001  
B00131758 - SCREENED PORCH

515029-A

NOT TO SCALE  
Well  
HO-94-2219

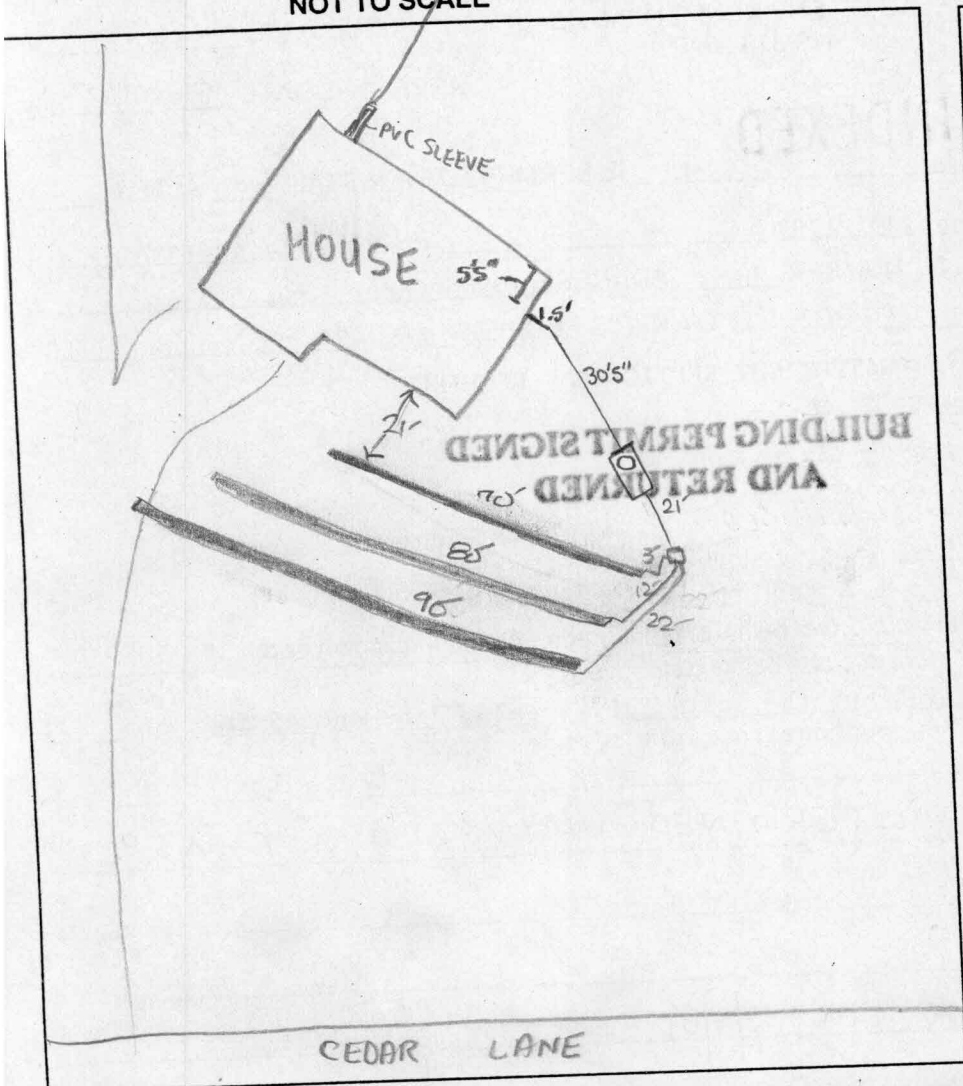

**TRENCH DATA**

TRENCH WIDTH	3
TRENCH INLET DEPTH	4
TRENCH BOTTOM DEPTH	6
DEPTH OF STONE	2
NUMBER OF TRENCHES	3
TOTAL TRENCH LENGTH	240
ABSORBENT AREA	720
DISTRIBUTION BOX LEVEL	<input checked="" type="checkbox"/>
BAFFLE IN DISTRIBUTION BOX	<input checked="" type="checkbox"/>

**SEPTIC TANK DATA**

SEPTIC TANK	1250TS	GALLONS
BAFFLES IN	<input checked="" type="checkbox"/>	
MANHOLE RISER	<input checked="" type="checkbox"/>	
6 INCH INSPECTION PORT	<input type="checkbox"/>	

**PUMP CHAMBER DATA**

PUMP CHAMBER GALLONS	<input type="checkbox"/>
MANHOLE RISER	<input type="checkbox"/>
ALARM	<input type="checkbox"/>
PUMP PERFORMANCE TEST	<input type="checkbox"/>

PRE-CONSTRUCTION INSPECTION: 4/26/01 - OK TO INSTALL BOX AS DISCUSSED AT LAYOUT SEE B<sup>A</sup>

PLAN - SRW

INSPECTION COMMENTS: 4/27/01 FINAL INSP - OK TO COVER ALL SEPTIC WORK. JXC

INSPECTOR: [Signature] DATE SYSTEM APPROVED: 4/27/01