

12/1/01 3/24/01 4/10/01
~~3:00~~ 3:00 3:00
agout Layout septic

PERMIT

SEWAGE DISPOSAL SYSTEM
HOWARD COUNTY HEALTH DEPARTMENT
BUREAU OF ENVIRONMENTAL HEALTH
410-313-2640

P 515050-C

A 59276-C

ISSUE DATE 4/17/01

APPROVAL DATE 6/13/01

04-365097

INDEXED

SK Backhoe

IS PERMITTED TO INSTALL ALTER

ADDRESS 1220 Francis Scott Key Hwy, Keymar, MD 21757 PHONE 410 775-0962
~~301-898-0955~~

PROPERTY DIVISION Peacefields @ Cattail Creek LOT NUMBER 3 ADDRESS 15528 Cattail Oaks

PROPERTY OWNER Trinity Builders PROPERTY OWNER'S ADDRESS 7320 Grace Drive (21044)

SEPTIC TANK CAPACITY 1500 GALLONS * TOP SEAMED SEPTIC TANK REQUIRED *

PUMP CHAMBER CAPACITY N/A GALLONS

NUMBER OF BEDROOMS 5

SQUARE FEET PER BEDROOM 180

MINIMUM DEPTH OF TRENCH REQUIRED 300

TRENCHES: Trenches to be 3 feet wide. Inlet, 2 feet below original grade. Bottom maximum depth
4 feet below original grade. 2 feet of stone below distribution box.

LOCATION: Begin trenches 120 feet down the left lot line and 70 feet off that same lot
line as seen when facing the lot from Cattail Oaks. Run trenches on contour toward
the right side of lot.

EDGE TO EDGE REQUIREMENTS FOR TRENCHES TO BE DETERMINED

AT TIME OF LAYOUT INSP., KEEP TANK & DBOX OUT OF 100' WELL RADIUS

KEEP TANK 10' FROM FUTURE DECK

PLANS APPROVED Amy McMillen, R.S. OK SRK 1/30/01 DATE 1/25/2001

PERMIT VOID AFTER 2 YEARS

NOTE: CONTRACTOR RESPONSIBLE FOR SCHEDULING A PRE-CONSTRUCTION INSPECTION FOR ALL INSTALLATIONS

NOTE: TOP OF SEPTIC TANKS ARE TO BE NO DEEPER THAN 3.0 FEET BELOW FINISH GRADE

NOTE: WATERTIGHT SEPTIC TANKS REQUIRED

NOTE: CLEANOUT REQUIRED EVERY 70 FEET OF SEWER LINE AND/OR AT 90° SWEEPS IN LINES FROM HOUSE TO DRAIN FIELDS, 90° ELBOWS ARE NOT ACCEPTABLE

NOTE: ALL PARTS OF SEPTIC SYSTEMS (I.E. TANK, DISTRIBUTION BOX, DRAINFIELDS) TO BE 100 FEET FROM ANY WATER WELL UNLESS OTHERWISE SPECIFICALLY AUTHORIZED

NOTE: NO ABSORPTION TRENCH TO EXCEED 100 FEET IN LENGTH UNLESS SPECIFICALLY AUTHORIZED

NOTE: ALL PIPE FROM HOUSE TO SEPTIC TANK MUST BE CAST IRON OR SCHEDULE 35/40 PVC OR ABS

NOTE: MANHOLE RISERS REQUIRED ON ALL SEPTIC TANKS AND PUMP CHAMBERS

NOTE: DISTRIBUTION BOXES MUST HAVE BAFFLES

NOTE: IF PUMPED SEPTIC SYSTEM REQUIRED, (1) SEPTIC PUMP DETAIL TO BE PROVIDED BY INSTALLER PRIOR TO ISSUANCE OF SEPTIC PERMIT (2) PUMP PERFORMANCE TEST IS NECESSARY PRIOR TO HEALTH DEPARTMENT APPROVAL OF SEPTIC PERMIT

NEITHER THE HOWARD COUNTY COUNCIL NOR THE HEALTH DEPARTMENT IS RESPONSIBLE FOR THE SUCCESSFUL OPERATION OF ANY SYSTEM

PERMITTEE RESPONSIBLE FOR OBTAINING FINAL APPROVAL ON THIS PERMIT
CALL 410-313-2640 FOR INSPECTION OF SEPTIC SYSTEM

0515050-C

NOT TO SCALE

INDEXED

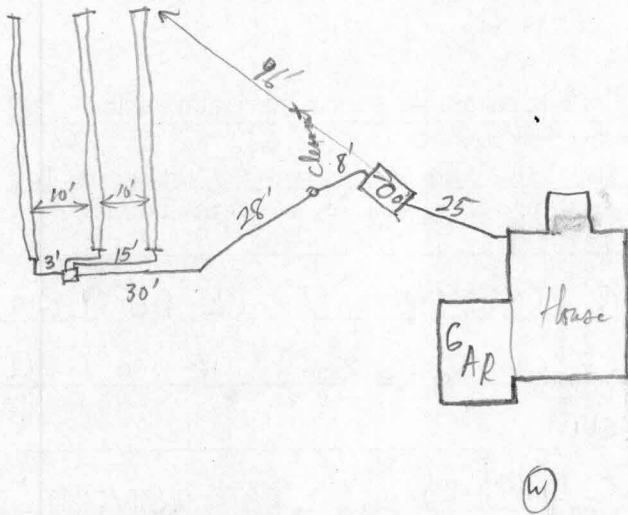

Cattail Oaks

TRENCH DATA

TRENCH WIDTH 3

TRENCH INLET DEPTH 3'

TRENCH BOTTOM DEPTH 5'

DEPTH OF STONE 2'

NUMBER OF TRENCHES 3 (100' each)

TOTAL TRENCH LENGTH 300LF

ABSORBENT AREA 900sqft

DISTRIBUTION BOX LEVEL ✓

BAFFLE IN DISTRIBUTION BOX ✓

SEPTIC TANK DATA

SEPTIC TANK 1500 TS GALLONS

MANHOLE RISER ✓ (2 1/2)

6 INCH INSPECTION PORT ✓

PUMP CHAMBER DATA

PUMP CHAMBER GALLONS NA

MANHOLE RISER ✓

ALARM ✓

PUMP PERFORMANCE TEST ✓

PRE-CONSTRUCTION INSPECTION: 4/19/01 - TELEPHONE CONVERSATION W/INSTALLER, INSTALLER REPORTS

AN INLET AT 2', BOTTOM AT 4' CANNOT WORK BECAUSE OF CONTOUR, I TOLD HIM THE PERCS. DO NOT ALLOW TO DROP THE SYSTEM MUCH BUT A BOTTOM OF 5' AND INLET AT 3' WOULD BE OK IF THIS IS INSPECTION COMMENTS: NOT POSSIBLE: A PUMP SYSTEM IS REQUIRED (SRK) 5/30/01 Contour

not as shown on BP plan. To install 3 long trenches towards 157.18' lot line. To try to stay out of low area near house - 5' trench depth, 7' spacing. S.T., House Connection OK, Dist Box OK, Trench OK, OK to Overall work. RPP 6/13/01

INSPECTOR

Randy Winkler

DATE SYSTEM APPROVED

6/13/01