

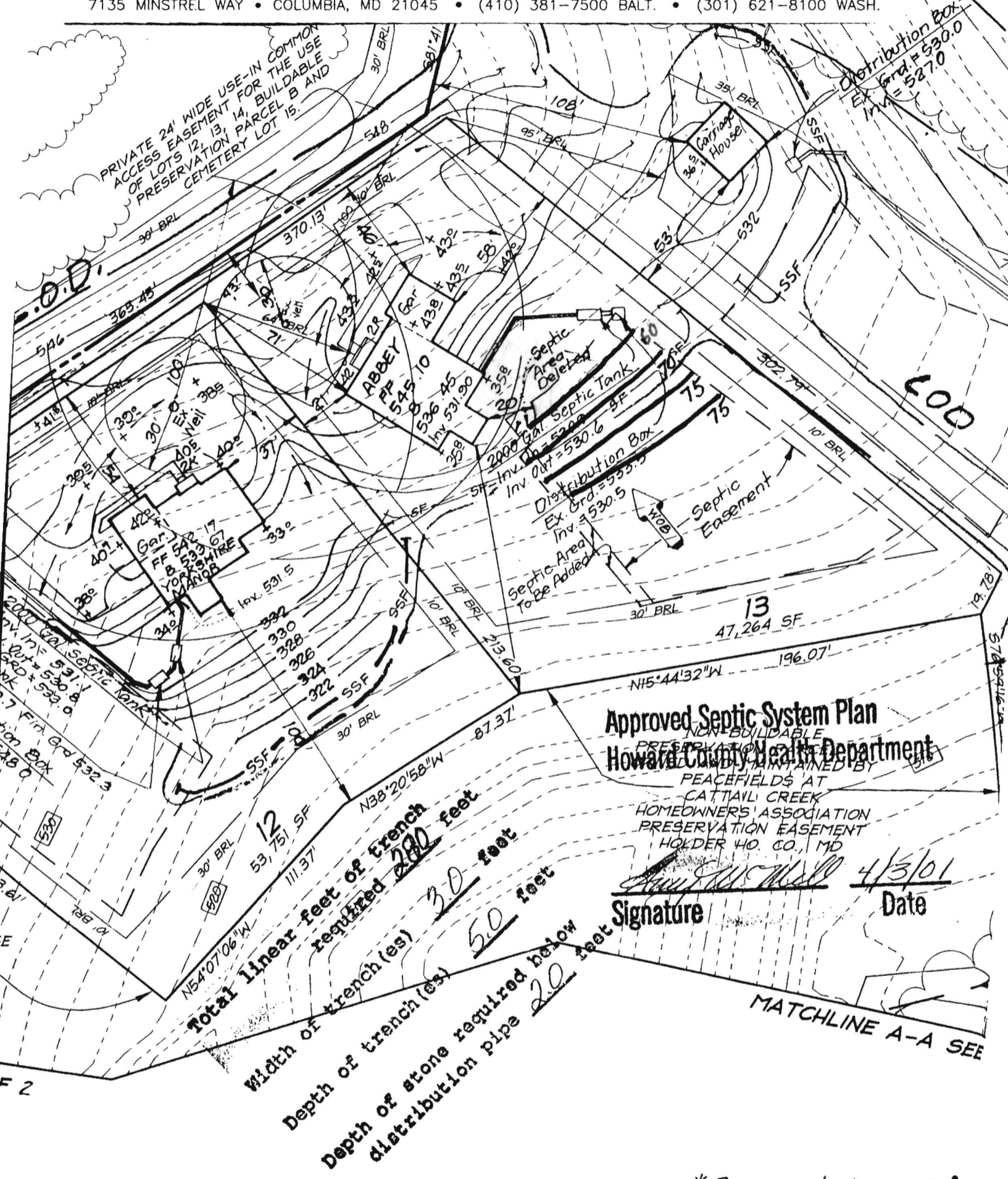

CLARK • FINEFROCK & SACKETT, INC.

ENGINEERS • PLANNERS • SURVEYORS

7135 MINSTREL WAY • COLUMBIA, MD 21045 • (410) 381-7500 BALT. • (301) 621-8100 WASH.



Approved Septic System Plan
Howard County Health Department

NON-BUILDABLE
PRESERVATION EASEMENT
MAINTAINED BY
PEACEFIELDS AT
CATTAIL CREEK
HOMEOWNERS ASSOCIATION
PRESERVATION EASEMENT
HOLDER HO. CO., MD

[Signature] 4/3/01
Signature Date

Total Linear feet of Trench required 200 feet
Width of trench (es) 3.0 feet
Depth of trench (es) 5.0 feet
Depth of stone required below distribution pipe 2.0 feet

MATCHLINE A-A SEE

*Basement does not gen

Reviewed for HOWARD S.C.D.
and meets Technical Requirements
J. G. Warfield 11/7/00
Signature Date
U.S. Natural Resources Conservation Service

THIS DEVELOPMENT PLAN IS APPROVED

DEVELOPER'S
"I/We certify that all devel
to this plan of developmen
that all responsible person
Certificate of Attendance a
Training Program for the
the project. I also authori
Soil Conservation District
necessary"

COSENTINA, INC.
3 BENJAMIN WAY
ELLCOTT CITY, MD 21043
PHONE: (410) 418-4467

1300 SQ'

