

COUNTY #

SOIL PROFILE

7001A

Red Br
Heavy Loam
and Loam

5'-5.5'

Light Br
Sa Loam

~10%
Saprolite

14'

7001B

Red Br
and OrBr
Loam

3.5 4.5'

Med Br
Si Loam
Very Little
Rock

7'-8'

Tan Sa
Loam
~20%
Saprolite

13.5'

SOIL PROFILE

0'

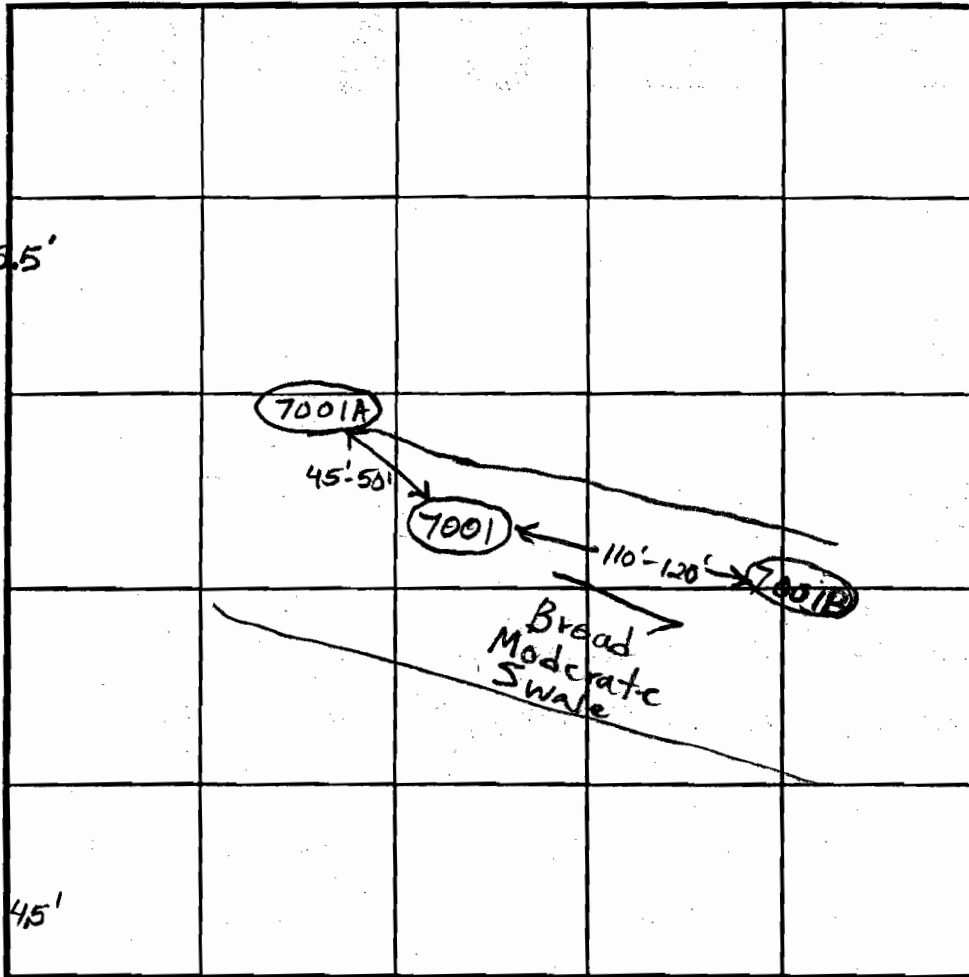

INDICATE NORTH - NAME ADJOINING ROADWAY AS BASE LINE.

DATE	TEST NO.	DEPTH	PRE-WET		TEST - 1" DROP		TIME
			START	STOP	START	STOP	
6/24/03	7001A	5.5' / 14' V	3:34	3:44:30	3:44:30	4:07:30	23
	7001B	5' / 13.5' V	3:52	4:00	4:00	4:14	14

7001 Water at 12' and seeping higher, caving at 9'
Open only short time, filled in by backhoe operator accidentally

REMARKS _____

TYPE OF SOIL _____

TESTED BY _____ ALSO PRESENT _____

TRENCH DESIGN DATA: AVERAGE PERCOLATION TIME _____ TRENCH WIDTH _____

INLET DEPTH _____ MAXIMUM BOTTOM DEPTH _____ SO FT/BEDROOM _____

COUNTY #

SOIL PROFILE

(60C)

Red Br Heavy Loam
Vcin of 750%
Rock From 2' 5'
4.5'
Red Br and Or Br Loam and Sa Loam
~15% Rock
6.5'
Med Br Sa Loam
~25% Rock and Saprolite
May Be Mottling Below 11.5'
Water 14'

(60E)

Red Brand Or Br Loam and Heavy Loams
3-4'
Or Br Loam and Tan Sa Loams
10-15% Rock
8'
Tan Sa Loam
25-30% Rock and Saprolite
Water seeping in at 9'
Water 14.5'

(307) (306)

Red Br Loam and Heavy Loam
2.5'-4'
Light Br Sa Loam
~10% Rock and Saprolite
306 About 20% Rock and Saprolite
15'

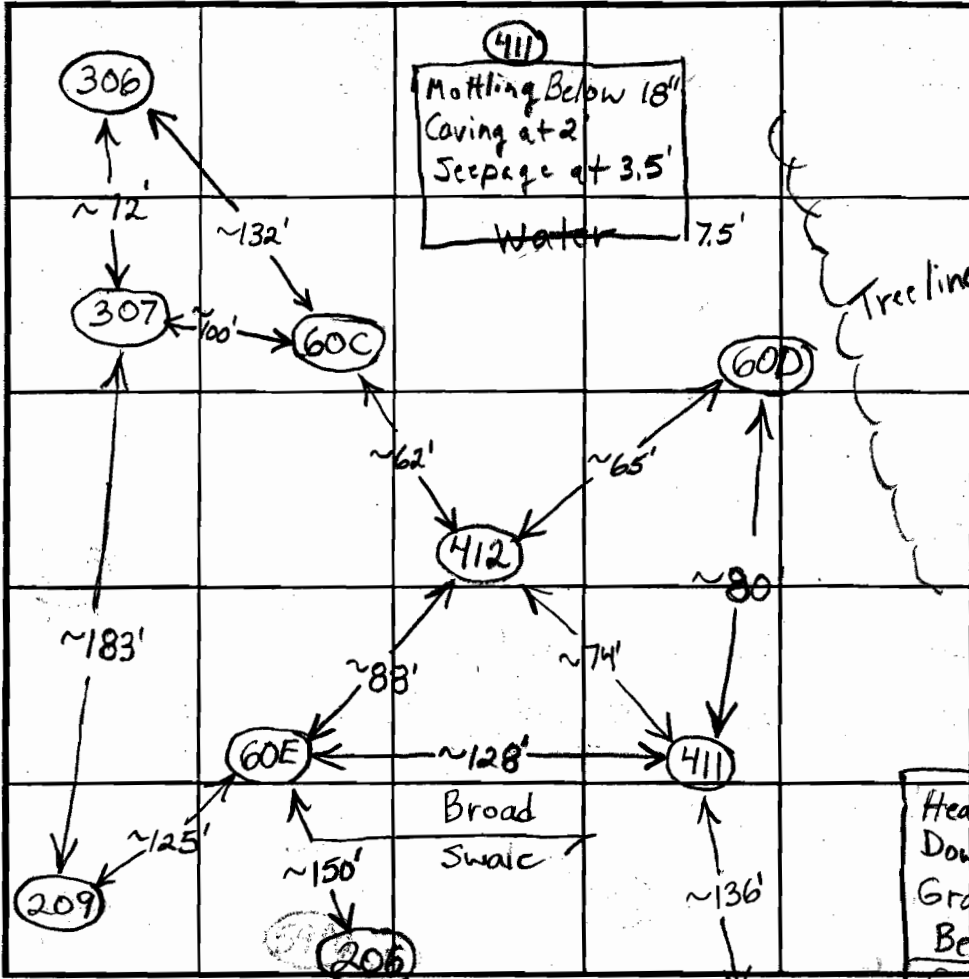

SOIL PROFILE

(412)

Red Br Heavy Loam
Gray Mottling Present
3-4'
Red Br and Or Br Loam Mottled?
~5% Rock
6'-6.5'
Med Br Sa Loam
~25% Saprolite
Gray Mottling at 10', Possibly Higher
Water 11.5'

(60D)

Heavy Loam Down to 4'-4.5' Gray Mottling Below 18"
Caving Water 7'

267 INDICATE NORTH - NAME ADJOINING ROADWAY AS BASE LINE. 206 (204)

DATE	TEST NO.	DEPTH	PRE-WET		TEST - 1" DROP		TIME	
			START	STOP	START	STOP		
3/26/03	60C	6' / 14" V	12:21	12:22:30	12:22:30	12:25	2 1/2	O.K.
		7'	12:18:30	12:24:45	12:24:45	12:34:30	~10	
	60E	3' 9" / 14.5" V	12:46	12:58:30	12:58:30	1:16:30	18	(F)
		5' 8"	12:46:15	~7/8" in 30 minutes			Slow	
	307	4' 3" / 15" V	1:12:15	1:14	1:14	1:16:30	2 1/2	O.K.
		6' 2"	1:12	1:13:15	1:13:15	1:15	~2	
	306	5' / 15" V	1:28	1:30:40	1:30:40	1:34:30	~4	O.K.
		7'	1:28	1:32	1:32	1:38	6	
	412	5' 8" / 11.5" V	1:49:30	~7/8" in 30 minutes			Slow	(F)
	60D	7" V					(F)	

REMARKS 411 7.5' V (F)

TYPE OF SOIL

TESTED BY B. Baker / F. Alfonso ALSO PRESENT

TRENCH DESIGN DATA: AVERAGE PERCOLATION TIME TRENCH WIDTH

INLET DEPTH MAXIMUM BOTTOM DEPTH SQ FT/BEDROOM

5116084

COUNTY #

SOIL PROFILE

0'

Red Br
Heavy Loam 2.5'-4.5'

Tan Sa
Loam
15-20%
Rock and
Saprolite

(212)

Red Br
Heavy Loam 3.5'-4'

Light Or
Br Sa
Loam
~15%
Saprolite

14.5'

SOIL PROFILE

0'

Empty soil profile box

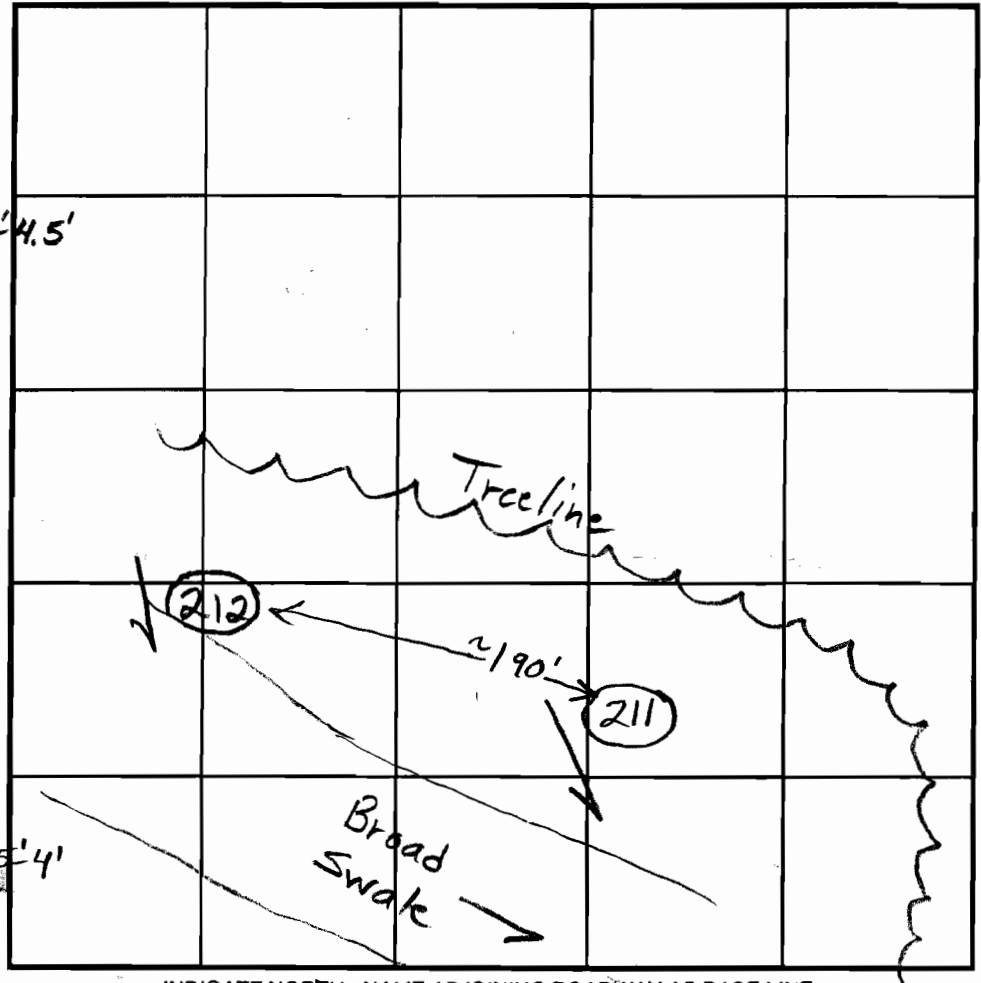

INDICATE NORTH - NAME ADJOINING ROADWAY AS BASE LINE.

DATE	TEST NO.	DEPTH	PRE-WET		TEST - 1" DROP		TIME
			START	STOP	START	STOP	
10/23/02	211	55'/14.5'	1:17	1:20:30	1:20:30	1:26:30	6
		7'	1:17:15	1:19:15	1:19:15	1:23	~4
	212	5'/14.5'	1:34:15	1:36:40	1:36:40	1:42:30	~6
		7'	1:34:30	1:36:20	1:36:20	1:39:30	~3

OK
OK

REMARKS Holes dug per plan

TYPE OF SOIL _____

TESTED BY B. Baker ALSO PRESENT Natzeled

TRENCH DESIGN DATA: AVERAGE PERCOLATION TIME _____ TRENCH WIDTH _____

INLET DEPTH _____ MAXIMUM BOTTOM DEPTH _____ SO. FT/BEDROOM _____

516084
COUNTY#

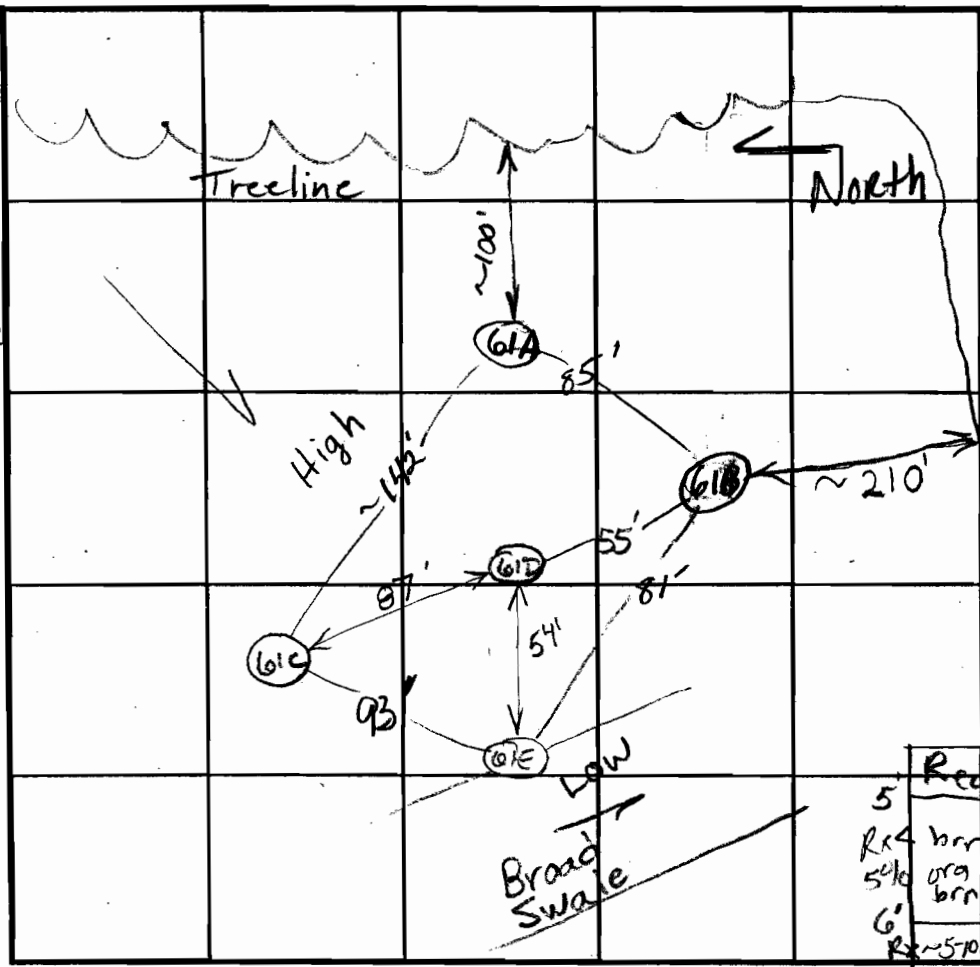

SOIL PROFILE
61C

0'
dense y brn
Lm -
hvy Lm
4 1/2'
brn beige
micaceous
SAND
Bottom 14 1/2'

SOIL PROFILE
61B

0'
dk brn
strong
brn
hvy Lm
Rx < 5%
4 1/2'
tan
y brn
micaceous
sand
Lm
10-15%
Rx
Bottom 14'

61A

Trace Rx
strong
brn
Lm - CLM
4'
brn, y brn
Lm
Rx < 5%
brn
lt brn
y brn
SAND
Rx < 10%
Bottom 14 1/2'

61E
Red Br Heavy loam
5'
Rx 4
brn
5%
org
brn
6'
Rx 5-10%
beige, brn
coarse sand
15'

INDICATE NORTH - NAME ADJOINING ROADWAY AS BASE LINE.

DATE	TEST NO.	DEPTH	PRE-WET		TEST - 1" DROP		TIME	
			START	STOP	START	STOP		
5-15-02	61C	3'10" / 14 1/2'	12:44	12:50	1:04:30	1:04:30	14 1/2	OK
		6 1/2'	12:45:30	12:48	12:48	12:50:30	2 1/2 min	OK
	61A	3'10" / 14 1/2'	1:07:30	1:28	~ 3/8" in	20 minutes	slow	
		4 1/2'	1:12:30	1:15:15	1:15:15	1:24	8 1/2 min	OK
		6 1/2'	1:14:10	1:14:55	1:14:55	1:16:25	1 1/2'	OK
	61D	4.5' / 14'	Visual	SEE	soil profile			OK
	61B	4'8" / 14'	1:28:32	1:32:30	1:32:30	1:41	8 1/2 min	OK
		6 1/2' / 14'	1:28:40	1:31:50	1:31:50	1:40	8 min	OK
	61E	6.5' / 15'	1:40:10	1:41:55	1:41:55	1:44:27	2 1/2 min	OK

REMARKS Holes dug per plan
 TYPE OF SOIL _____
 TESTED BY BB/KG ALSO PRESENT HATFIELD'S
 TRENCH DESIGN DATA: AVERAGE PERCOLATION TIME _____ TRENCH WIDTH _____
 INLET DEPTH _____ MAXIMUM BOTTOM DEPTH _____ SQ. FT./BEDROOM _____

61D

org brn
y brn
Loam
(fine)
Rx < 5%
3 1/2'
org brn
y brn
fine
SAND
Rx 10-15%
Bottom 14 1/2'

