

LAYOUT 3/7/2012 INSP 4 \_\_\_\_\_  
INSP 2 3/8/2012 INSP 5 \_\_\_\_\_  
INSP 3 \_\_\_\_\_ INSP 6 \_\_\_\_\_

ISSUE DATE: 3-1-12  
APPROVAL DATE: 3/9/2012

# PERMIT

P 536749  
A \_\_\_\_\_

Tax ID # 1405447305  
**ON-SITE SEWAGE DISPOSAL SYSTEM**  
**HOWARD COUNTY HEALTH DEPARTMENT**  
**BUREAU OF ENVIRONMENTAL HEALTH**

Trinity Quality Homes Inc. IS PERMITTED TO INSTALL  ALTER   
ADDRESS: 3075 Park Ave ste 301 PHONE NUMBER: (410) 480-0023  
Ellicott City MD 21013  
SUBDIVISION: CASTLEBERRY AT TEN OAKS LOT NUMBER: 28  
ADDRESS: 4051 CANDLE LIGHT DRIVE, PROPERTY OWNER: TRINITY QUALITY  
DAYTON, MD 21036 HOMES

SEPTIC TANK CAPACITY (GALLONS): 2000 OUTLET BAFFLE FILTER REQUIRED   
PUMP CHAMBER CAPACITY (GALLONS): NONE COMPARTMENTED TANK REQUIRED   
NUMBER OF BEDROOMS: 5 APPLICATION RATE: 0.8  
SQUARE FOOTAGE OF HOUSE: 6310 Inlet 4.5'  
Bottom 6.5'  
LINEAR FEET OF TRENCH REQUIRED: 200 40', 70' + 90' Trenches

TRENCHES:	Trenches to be 3 feet wide. Inlet 4 feet below original grade. Bottom maximum depth 6 feet below grade. Effective area begins at 4 feet below original grade with 2 feet of stone below distribution pipe.
LOCATION:	Set septic tank in northeast corner of septic reserve. Set distribution box about 45 feet from northeast septic reserve corner and near septic reserve boundary. Install 5 x 40 ft trenches on contour using full width of reserve area.
NOTES:	<b>Do not</b> order the septic tank until after layout inspection and Sanitarian approval. Stake septic easement corners. Call for layout inspection. Mark utilities. Gravel tickets must be available for Environmental Sanitarians. Stone must be approved by the Howard County Health Department. A written variance request is required for tanks deeper than 3 feet. A traffic bearing lid is required for tanks deeper than 4 feet.

PLANS APPROVED: ROBERT BRICKER DATE: 11/17/2011

- NOTE: PERMIT VOID AFTER 2 YEARS
- NOTE: CONTRACTOR RESPONSIBLE FOR SCHEDULING A PRE-CONSTRUCTION INSPECTION FOR ALL INSTALLATIONS
- NOTE: WATERTIGHT SEPTIC TANKS REQUIRED
- NOTE: ALL PARTS OF SEPTIC SYSTEM SHALL BE 100 FEET FROM ANY WATER WELL
- NOTE: MANHOLE RISERS REQUIRED ON ALL SEPTIC TANKS AND PUMP CHAMBERS
- NOTE: AN ELECTRICAL PERMIT IS REQUIRED FOR INSTALLATION OF ANY ELECTRICAL COMPONENTS OF THE SYSTEM

**NEITHER THE HOWARD COUNTY COUNCIL OR THE HEALTH DEPARTMENT IS RESPONSIBLE FOR THE SUCCESSFUL OPERATION OF ANY SYSTEM PERMITTEE RESPONSIBLE FOR OBTAINING FINAL APPROVAL ON THIS PERMIT CALL 410-313-1771 FOR INSPECTION OF SEPTIC SYSTEM**

HO-95-0456

NOT TO SCALE

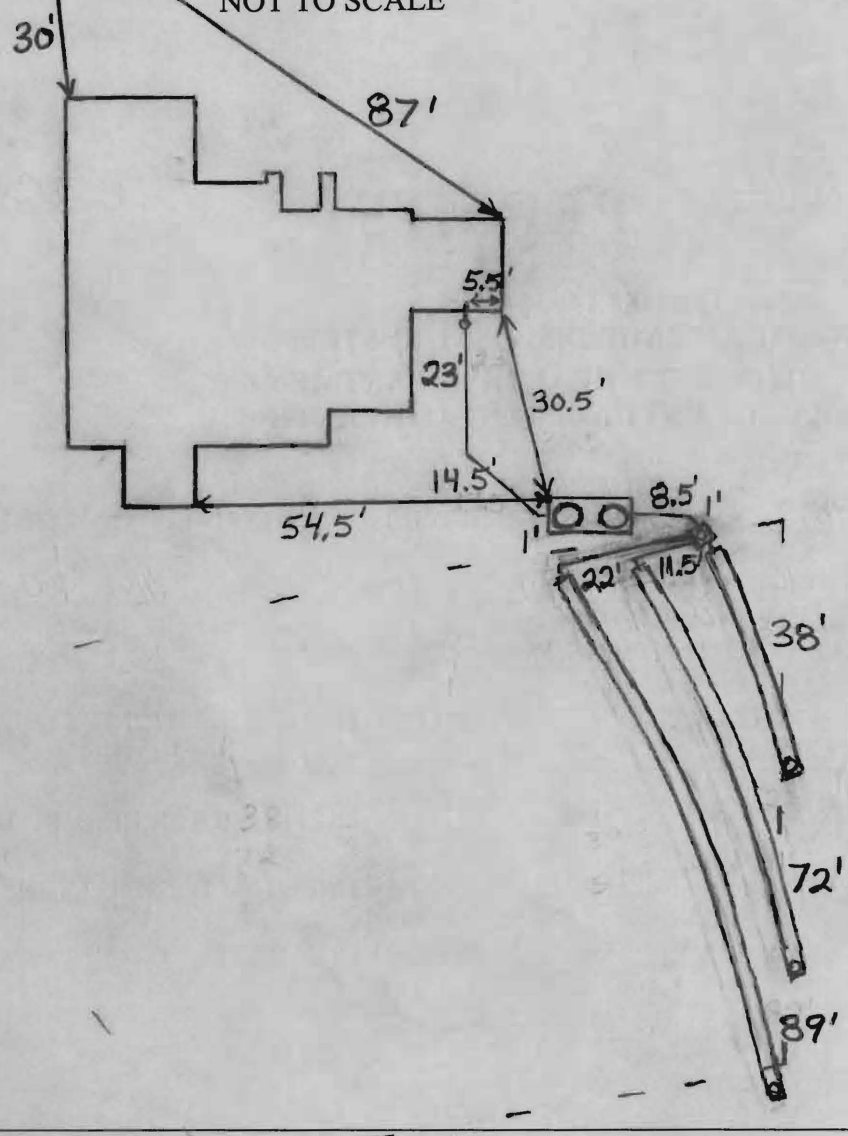

ROAD NAME

30

TRENCH/DRAINFIELD DATA		
WIDTH	INLET	BOTTOM
3'	4.5'-5'	6.5'-7'
NUMBER OF TRENCHES 3		
TOTAL LENGTH 199'		
ABSORPTION AREA 597+Sidewall		
DISTRIBUTION BOX LEVEL Levelers		
DISTRIBUTION BOX BAFFLE Yes		
DISTRIBUTION BOX PORT Yes		

SEPTIC TANK DATA	
SEPTIC TANK 1 LEVEL	Yes
MANUFACTURER	Babylon
CAPACITY	2000 GAL
SEAM LOC	Top
TANK LID DEPTH	1.5'-2.5'
BAFFLES	Yes
BAFFLE FILTER	No
MANHOLE LOC	Front+Rear
6" PORT LOC	None
WATERTIGHT TEST	No
SLOTTED	Yes
DATE ON LID	12/23/2011

PUMP/SEPTIC TANK LEVEL	
MANUFACTURER	
CAPACITY	GAL
SEAM LOC	
TANK LID DEPTH	
BAFFLES	
BAFFLE FILTER	
MANHOLE LOC	
6" PORT LOC	
WATERTIGHT TEST	
SLOTTED	
DATE ON LID	

PRE-CONSTRUCTION:

3/7/2012 Layout done. Place the distribution box near the top eastern easement stake. Install a 40', 70' and 90' trench on contour towards the south. Set the tank close to and parallel to the easement near the distribution box. (BB)

INSTALLATION: 3/8/2012 Tank and distribution box set and plumbed in. (BB)

3/9/2012 System finished except for part of bottom trench, O.K. to backfill. (BB)

FINAL INSPECTOR B. Baker

DATE OF APPROVAL 3/9/2012

CB 28

MARYLAND STATE GRID MERIDIAN (NAD83/91)

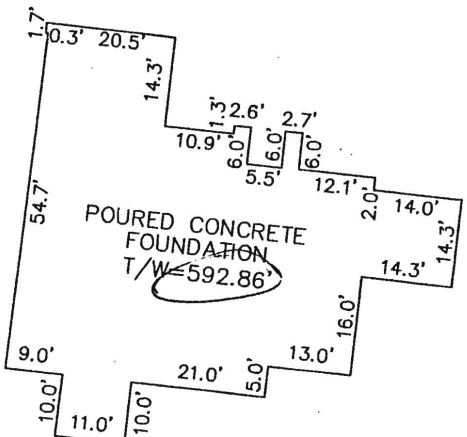

DETAIL: 1"=30'

CANDLE LIGHT DRIVE  
50' RIGHT-OF-WAY

10' PUBLIC TREE MAINTENANCE EASEMENT

R=180.00'  
L=123.64'

45-0456  
EX. WELL

LOT 28  
42,995 SF

SEE DETAIL

House  
< 20' from  
easement  
& variance approved  
10/20/11

LOT 27

LOT 29

LOT 26

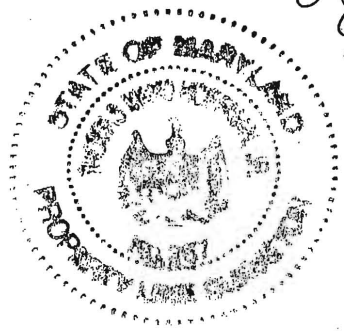

OK  
GWO  
2/21/12

I HEREBY CERTIFY TO THE BEST OF MY KNOWLEDGE, INFORMATION AND BELIEF THAT THE IMPROVEMENTS ARE LOCATED AS SHOWN AND THERE ARE NO ENCROACHMENTS EXCEPT AS SHOWN.

*Thomas M. Hoffman*  
THOMAS M. HOFFMAN JR., PROPERTY LINE SURVEYOR #267 DATE 12-14-11

B.P.# B10004028  
4051 CANDLE LIGHT DRIVE

THIS WALL CHECK DRAWING CONTAINS A HORIZONTAL TOLERANCE IN ACCURACY OF 0.1' AND A VERTICAL TOLERANCE IN ACCURACY OF 0.2'

SCALE 1"= 50'	DATE 12/08/11	<b>ROBERT H. VOGEL ENGINEERING, INC.</b> ENGINEERS - SURVEYORS - PLANNERS 8407 MAIN STREET ELLICOTT CITY, MARYLAND 21043 TEL:410-461-7666 FAX:410-461-8961	<b>WALL CHECK DRAWING</b> LOT 28 CASTLEBERRY AT TEN OAKS PLAT No. 19098 FIFTH ELECTION DISTRICT HOWARD COUNTY, MARYLAND
DRAWN BY B.D.A.	CHECKED BY T.M.H.		
PLAT NUMBER 19096-19109	JOB NUMBER 00-85.00		



*dedicated to excellence and service*

MICHAEL PFAU  
President

October 28, 2011

Mr. Michael Davis, Assistant Director  
Bureau of Environmental Health  
7178 Old Gateway Drive  
Columbia, MD 21046

RE: Septic Variance request for Castleberry at Ten Oaks Lot 28

Dear Mr. Davis,

After conferring with Mr. Robert Bricker regarding the septic setback on Lot 28, I am requesting a variance to reduce the setback from the basement foundation to the septic reserve area in the rear of the house on Lot 28 Castleberry at Ten Oaks.

I am requesting a variance, rather than requesting an adjustment to the septic area. This request is to reduce the amount from 20' to 18.5', an amount of 1.5' which is on a parallel slope.

The house cannot be moved forward on the lot because of the position of the well.

The lot has been sold and we are preparing to dig the foundation, your prompt attention to this matter is greatly appreciated.

Respectfully,

  
Timothy L. Keane

443.324-9806

10/28/11 Approval  
M T Davis