

6/27/85
A.M.

6-27-85
approved
Sittel

PERMIT

P 35-4/3

A 34956

SEWAGE DISPOSAL SYSTEM

MARYLAND STATE DEPARTMENT OF HEALTH

ELLICOTT CITY

HOWARD COUNTY
BUREAU OF ENVIRONMENTAL HEALTH
992-2330

DISTRICT 5th

DATE 6/25/85

INDEXED

Leonard E. Sutton Company IS PERMITTED TO INSTALL ALTER

ADDRESS 2209 Frederick Road, Catonsville, MD 21228 PHONE 744-4552

SUBDIVISION Ken Warfield ROAD 4260 Ten Oaks Road LOT 6

PROPERTY OWNER Dick Myers

ADDRESS _____

IF GARBAGE GRINDER IS USED INCREASE SEPTIC TANK CAPACITY BY 50% AND ABSORPTION AREA BY 22%.

GARBAGE GRINDER? YES _____ NO

SEPTIC TANK CAPACITY 1250 GALLONS NUMBER OF BEDROOMS 4

TRENCHES - 158 sq. ft. per bedroom. Trench to be 2 feet wide. Inlet 3 feet below original grade. Bottom maximum depth 9 feet below original grade. Effective area begins at 3 feet below original grade. 6 feet of stone below distribution pipe. LOCATION: Start the first trench 235 feet from the front (595') lot line and 465' from the right (881' lot line. Run trench(s) along level ground toward right lot line. NOTE: No trench to exceed 100 feet in length. If more than one trench used, a distribution box is required. Trenches to be installed on level ground. Call for inspection of trench(s) before and after gravel is installed. Provide 6" - 8" diameter cleanout and cap to grade or above on septic tank.

PLANS APPROVED BY C. Williams DATE 6/24/85

COVER NO WORK UNTIL INSPECTED AND APPROVED.

NEITHER THE HOWARD COUNTY COUNCIL NOR THE HEALTH DEPARTMENT IS RESPONSIBLE FOR THE SUCCESSFUL OPERATION OF ANY SYSTEM.

NOTE: IF TRENCH IS USED CALL FOR INSPECTION BEFORE AND AFTER PLACING GRAVEL IN TRENCH.

NOTE: NO DRY WELL SHALL EXCEED 15 FOOT IN DIAMETER. NO ABSORPTION TRENCH TO EXCEED 100 FEET IN LENGTH.

NOTE: ALL PIPE FROM HOUSE TO SEPTIC TANK MUST BE CAST IRON OR SCHEDULE 40 PVC OR ABS.

PERMIT VOID AFTER THREE YEARS.

NOTE: INSTALL STAND PIPE ON SEPTIC TANK AND DRY WELL. STAND PIPES MUST BE 6 INCHES IN DIAMETER CAST IRON, CONCRETE OR TERRA COTTA, OR PVC OR ABS ACCEPTED. IF TOP OF SEPTIC TANK IS DEEPER THAN 3 FEET MANHOLE TO GRADE REQUIRED

***INSTALLER IS RESPONSIBLE FOR OBTAINING FINAL APPROVAL ON THIS PERMIT**

*CALL 992-2330 FOR INSPECTION OF SEPTIC SYSTEMS.

EH - 2-1082

A 34956

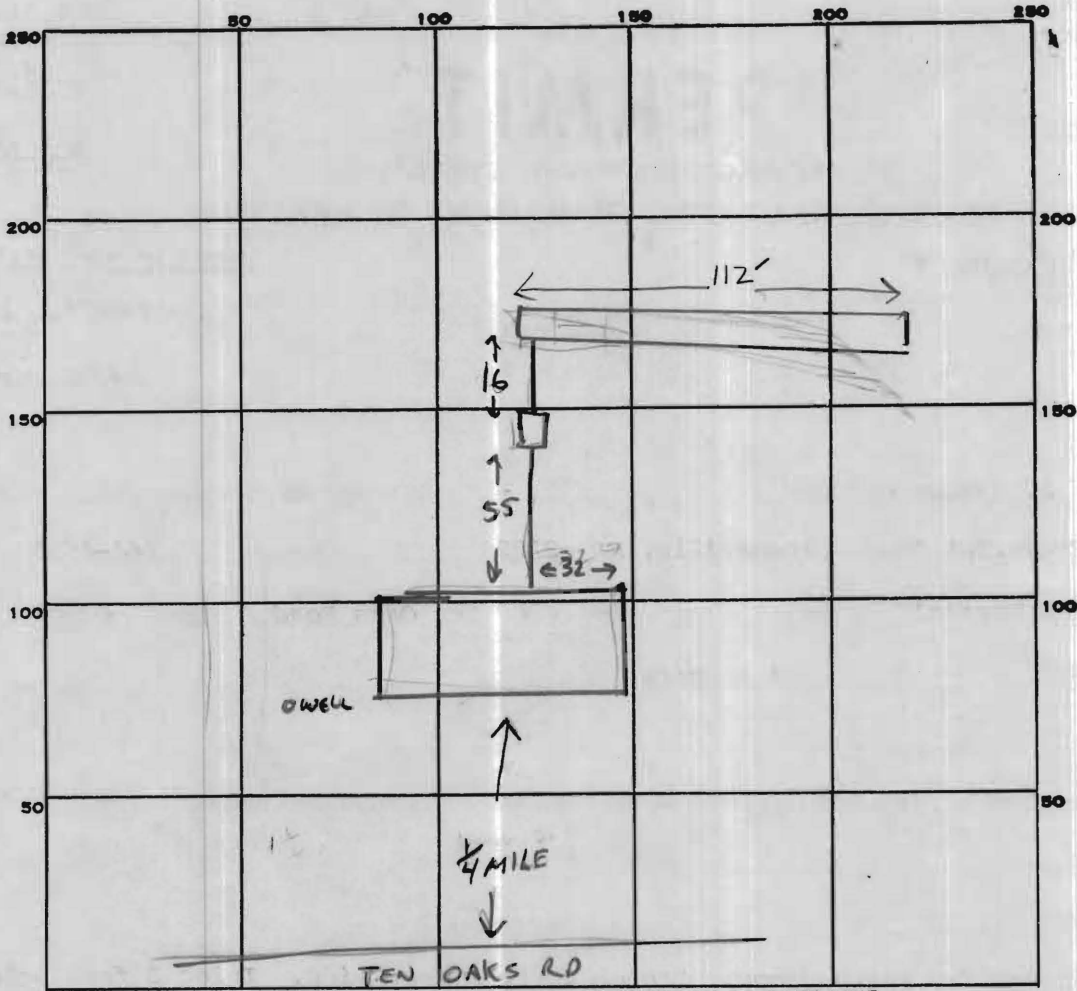

INDICATE NORTH. - NAME ADJOINING ROADWAY AS BASE LINE.

PERMIT CARD

SEPTIC TANK, LEVEL

CLEANOUTS ST

DISTRIBUTION BOX, LEVEL N/A

TILE FIELD, DEPTH 9 FT. TRENCH WIDTH 2+ (CAVED TO 4' IN SOME SPOTS) FT.

INLET 3"

GRAVEL DEPTH 6 FT IN. TOTAL LENGTH 112' FT.

NUMBER OF TRENCHES 1 TOTAL BOTTOM AREA 672 ^{ONE SIDEWALL}

SEEPAGE PITS, INSIDE DIAMETER FT. DEPTH BELOW INLET FT.

ABSORBENT AREA 672 SQ. FT.

REMARKS 6-27-85 OK TO ADD GRAVEL AS TRENCH IS DUG TO PREVENT CAVING. (CW)

OK TO COVER ALL WORK

DATE SYSTEM APPROVED 6-27-85

INSPECTOR SABU