

4/18/01 - PM
4/26/01
Noon

5/2/01 - AM
6/26/01
Septic Final
11:00

Needs House Connection

PERMIT

SEWAGE DISPOSAL SYSTEM
HOWARD COUNTY HEALTH DEPARTMENT
BUREAU OF ENVIRONMENTAL HEALTH
410-313-2640

P 515024-B

A 512694-G

ISSUE DATE 4/5/2001

APPROVAL DATE 6/26/01

INDEXED 03-331369

South Carroll Backhoe, Inc IS PERMITTED TO INSTALL ALTER

ADDRESS 4410 Salem Bottom Road, Westminster, MD 21157 PHONE 410-875-4197

SUBDIVISION Brantwood 2/1 LOT NUMBER 7 ADDRESS 11429 Butterfruit Way

PROPERTY OWNER NV Homes PROPERTY OWNER'S ADDRESS 2200 Defense Hwy.

SEPTIC TANK CAPACITY 1250 GALLONS Crofton, MD 21114

PUMP CHAMBER CAPACITY N/A GALLONS

NUMBER OF BEDROOMS 4 ** TOP SEAMED SEPTIC TANK REQUIRED **

SQUARE FEET PER BEDROOM 180

LINEAR FEET OF TRENCH REQUIRED 240

TRENCHES: Trenches to be 3 feet wide. Inlet 2 feet below original grade. Bottom maximum depth 4 feet below original grade. 2 feet of stone below distribution box.

LOCATION: Starting at the intersection of the 148.40'/208.79' lot lines, place the distribution box 95 feet up the 208.79' lot line and 70 feet off this same lot line. Run (4) 60' trenches toward the 208.79' lot line. 12/6/00 OK (BB)

RUN 2' - 120' TRENCHES TOWARDS LEFT LOT LINE (SRW)

PLANS APPROVED Mark E. Rifkin, R.S. DATE 12/4/2000

PERMIT VOID AFTER 2 YEARS

NOTE: CONTRACTOR RESPONSIBLE FOR SCHEDULING A PRE-CONSTRUCTION INSPECTION FOR ALL INSTALLATIONS

NOTE: TOP OF SEPTIC TANKS ARE TO BE NO DEEPER THAN 3.0 FEET BELOW FINISH GRADE

NOTE: WATERTIGHT SEPTIC TANKS REQUIRED

NOTE: CLEANOUT REQUIRED EVERY 70 FEET OF SEWER LINE AND/OR AT 90° SWEEPS IN LINES FROM HOUSE TO DRAIN FIELDS, 90° ELBOWS ARE NOT ACCEPTABLE

NOTE: ALL PARTS OF SEPTIC SYSTEMS (I.E. TANK, DISTRIBUTION BOX, DRAINFIELDS) TO BE 100 FEET FROM ANY WATER WELL UNLESS OTHERWISE SPECIFICALLY AUTHORIZED

NOTE: NO ABSORPTION TRENCH TO EXCEED 100 FEET IN LENGTH UNLESS SPECIFICALLY AUTHORIZED

NOTE: ALL PIPE FROM HOUSE TO SEPTIC TANK MUST BE CAST IRON OR SCHEDULE 35/40 PVC OR ABS

NOTE: MANHOLE RISERS REQUIRED ON ALL SEPTIC TANKS AND PUMP CHAMBERS

NOTE: DISTRIBUTION BOXES MUST HAVE BAFFLES

NOTE: IF PUMPED SEPTIC SYSTEM REQUIRED, (1) SEPTIC PUMP DETAIL TO BE PROVIDED BY INSTALLER PRIOR TO ISSUANCE OF SEPTIC PERMIT (2) PUMP PERFORMANCE TEST IS NECESSARY PRIOR TO HEALTH DEPARTMENT APPROVAL OF SEPTIC PERMIT

PLANS PERMITS ISSUED AND RETURNED 1/30/02
B00134122 DECK W/STEPS

NEITHER THE HOWARD COUNTY COUNCIL NOR THE HEALTH DEPARTMENT IS RESPONSIBLE FOR THE SUCCESSFUL OPERATION OF ANY SYSTEM
PERMITTEE RESPONSIBLE FOR OBTAINING FINAL APPROVAL ON THIS PERMIT
CALL 410-313-2640 FOR INSPECTION OF SEPTIC SYSTEM

515024-B

NOT TO SCALE

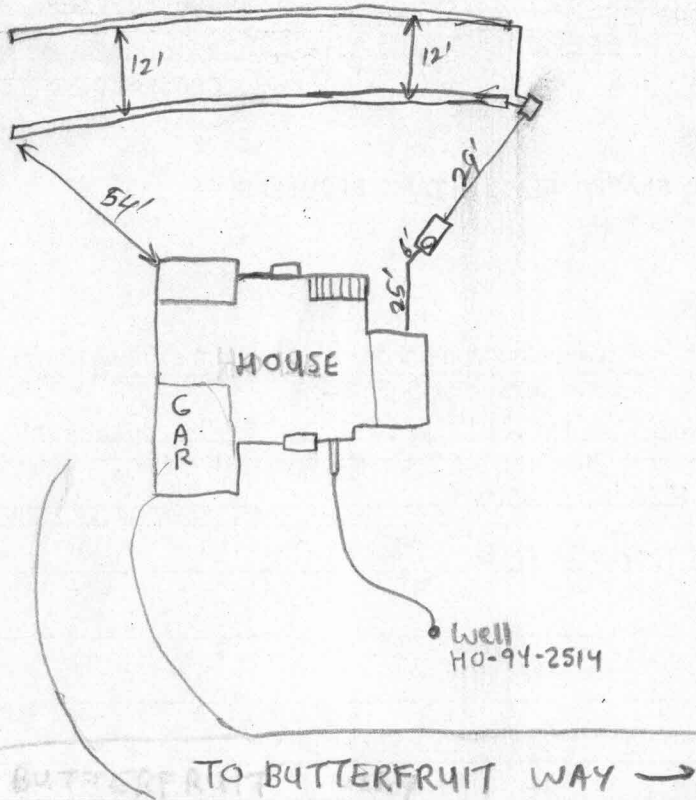

TRENCH DATA

TRENCH WIDTH 3'
 TRENCH INLET DEPTH 2'
 TRENCH BOTTOM DEPTH 4'
 DEPTH OF STONE 2'
 NUMBER OF TRENCHES 2 (120' ea)
 TOTAL TRENCH LENGTH 240 LF
 ABSORBENT AREA 7200 sqft
 DISTRIBUTION BOX LEVEL _____
 BAFFLE IN DISTRIBUTION BOX

SEPTIC TANK DATA

SEPTIC TANK 1500 TS GALLONS
 MANHOLE RISER 422 (18")
 6 INCH INSPECTION PORT NA
 "T" Baffles

PUMP CHAMBER DATA

PUMP CHAMBER GALLONS NA
 MANHOLE RISER _____
 ALARM _____
 PUMP PERFORMANCE TEST _____

PRE-CONSTRUCTION INSPECTION: 4/18/01 - EASEMENT NOT STAKED - JOB SHUT DOWN - SRM
4/20/01 SOA staked - layout confirmed - OK to begin installation
 INSPECTION COMMENTS: 4/30/01 - RUN 2 - 120' TRENCHES INSTEAD OF 3 - 80' TRENCHES - SRM
Needs House Connection, Septic Tank OK, "T" Baffles OK, Dist Box and both drainfield trenches OK to cover. RPP in place 5/2/01
6/20/01 House connection verified - FINAL INSP OK. DKC

INSPECTOR

[Handwritten Signature]

DATE SYSTEM APPROVED

6/20/01