

04-541107

PERMIT

P 515304

SEWAGE DISPOSAL SYSTEM
HOWARD COUNTY HEALTH DEPARTMENT
BUREAU OF ENVIRONMENTAL HEALTH
410-313-2640

A REPAIR

ISSUE DATE 6/26/2001

APPROVAL DATE 7/13/01

INDEXED

7/13/01
10:00

Paul Mueller (South Carroll to be installer) IS PERMITTED TO INSTALL ALTER X

ADDRESS P.O. Box 115, West Friendship, MD 21794 PHONE 410-442-1455

SUBDIVISION Cole Property LOT NUMBER 3 ADDRESS 15650 Bushy Park Road

PROPERTY OWNER Barbara Shaw PROPERTY OWNER'S ADDRESS Same

SEPTIC TANK CAPACITY _____ GALLONS

PUMP CHAMBER CAPACITY _____ GALLONS

NUMBER OF BEDROOMS _____

SQUARE FEET PER BEDROOM _____

LINEAR FEET OF TRENCH REQUIRED _____

TRENCHES: Trenches to be _____ feet wide. Inlet _____ feet below original grade. Bottom maximum depth
_____ feet below original grade. _____ feet of stone below distribution box.

LOCATION: _____

REPAIR - PURPOSE - To connect existing septic system to garage.
Call for repair when ground is opened so sanitarian can recommend repair. 6/26/01

PLANS APPROVED _____ DATE _____

- PERMIT VOID AFTER 2 YEARS
- NOTE: CONTRACTOR RESPONSIBLE FOR SCHEDULING A PRE-CONSTRUCTION INSPECTION FOR ALL INSTALLATIONS
- NOTE: TOP OF SEPTIC TANKS ARE TO BE NO DEEPER THAN 3.0 FEET BELOW FINISH GRADE
- NOTE: WATERTIGHT SEPTIC TANKS REQUIRED
- NOTE: CLEANOUT REQUIRED EVERY 70 FEET OF SEWER LINE AND/OR AT 90° SWEEPS IN LINES FROM HOUSE TO DRAIN FIELDS, 90° ELBOWS ARE NOT ACCEPTABLE
- NOTE: ALL PARTS OF SEPTIC SYSTEMS (I.E. TANK, DISTRIBUTION BOX, DRAINFIELDS) TO BE 100 FEET FROM ANY WATER WELL UNLESS OTHERWISE SPECIFICALLY AUTHORIZED
- NOTE: NO ABSORPTION TRENCH TO EXCEED 100 FEET IN LENGTH UNLESS SPECIFICALLY AUTHORIZED
- NOTE: ALL PIPE FROM HOUSE TO SEPTIC TANK MUST BE CAST IRON OR SCHEDULE 35/40 PVC OR ABS
- NOTE: MANHOLE RISERS REQUIRED ON ALL SEPTIC TANKS AND PUMP CHAMBERS
- NOTE: DISTRIBUTION BOXES MUST HAVE BAFFLES
- NOTE: IF PUMPED SEPTIC SYSTEM REQUIRED, (1) SEPTIC PUMP DETAIL TO BE PROVIDED BY INSTALLER PRIOR TO ISSUANCE OF SEPTIC PERMIT (2) PUMP PERFORMANCE TEST IS NECESSARY PRIOR TO HEALTH DEPARTMENT APPROVAL OF SEPTIC PERMIT

NEITHER THE HOWARD COUNTY COUNCIL NOR THE HEALTH DEPARTMENT IS RESPONSIBLE FOR THE
SUCCESSFUL OPERATION OF ANY SYSTEM
PERMITTEE RESPONSIBLE FOR OBTAINING FINAL APPROVAL ON THIS PERMIT
CALL 410-313-2640 FOR INSPECTION OF SEPTIC SYSTEM

510501

NOT TO SCALE

INDEXED

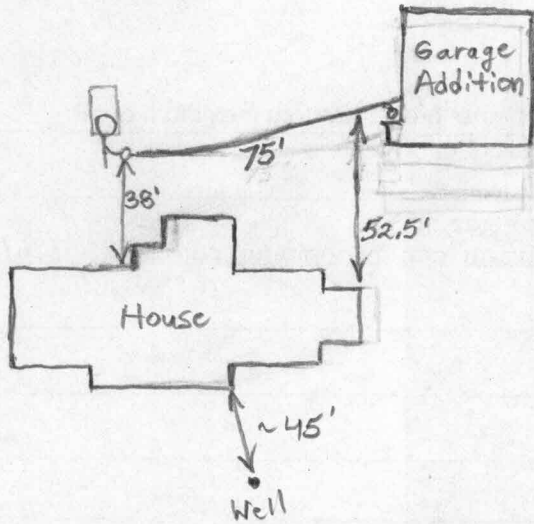

Bushy Park Road

PRE-CONSTRUCTION INSPECTION: _____

INSPECTION COMMENTS: 7/13/01 Connection for garage bathroom made. (BB)

TRENCH DATA

TRENCH WIDTH _____
 TRENCH INLET DEPTH _____
 TRENCH BOTTOM DEPTH _____
 DEPTH OF STONE _____
 NUMBER OF TRENCHES _____
 TOTAL TRENCH LENGTH _____
 ABSORBENT AREA _____
 DISTRIBUTION BOX LEVEL _____
 BAFFLE IN DISTRIBUTION BOX _____

SEPTIC TANK DATA

SEPTIC TANK _____ GALLONS
 MANHOLE RISER _____
 6 INCH INSPECTION PORT _____

PUMP CHAMBER DATA

PUMP CHAMBER GALLONS _____
 MANHOLE RISER _____
 ALARM _____
 PUMP PERFORMANCE TEST _____

INSPECTOR B. Baker DATE SYSTEM APPROVED 7/13/01