

6/14/01
11-50
6/15/01
Final
PM

PERMIT M-360052

P 514988-B

SEWAGE DISPOSAL SYSTEM HOWARD COUNTY HEALTH DEPARTMENT BUREAU OF ENVIRONMENTAL HEALTH 410-313-2640

A 56402

ISSUE DATE 3/19/2001

APPROVAL DATE 6/15/01

INDEXED

Hatfields Equipment IS PERMITTED TO INSTALL ALTER

ADDRESS 13785 Burntwoods Road, Glenelg, MD 21737 PHONE 301-854-6172

UBDIVISION Village of Three Keys LOT NUMBER 3 ADDRESS 15182 Bushy Park Road

PROPERTY OWNER Williamsburg Group LLC PROPERTY OWNER'S ADDRESS 5485 Harpers Farm Road

EPTIC TANK CAPACITY 1250 GALLONS * ~~TOP SHAMEN SEPTIC TANK REQUIRED~~ *
BUILDING PERMIT SIGNED

UMP CHAMBER CAPACITY N/A GALLONS **AND RETURNED**

NUMBER OF BEDROOMS 4 7/21/05 800155102-PRCHA

SQUARE FEET PER BEDROOM 240

LINEAR FEET OF TRENCH REQUIRED 320

TRENCHES: Trenches to be 3 feet wide. Inlet 5 feet below original grade. Bottom maximum depth 6.5 feet below original grade. 1.5 feet of stone below distribution ~~box~~ pipe.

LOCATION: Starting at the intersection of the 372.27' and 321.73' lot lines, place the distribution box 85 feet down the 321.73' lot line and 100 feet off this same lot line as seen from Bushy Park Road. Run trenches along contour in both directions.

2/1/01 OK (BB)

PLANS APPROVED Donna K. Clark, R.S. DATE 1/29/2001

PERMIT VOID AFTER 2 YEARS

NOTE: CONTRACTOR RESPONSIBLE FOR SCHEDULING A PRE-CONSTRUCTION INSPECTION FOR ALL INSTALLATIONS

NOTE: TOP OF SEPTIC TANKS ARE TO BE NO DEEPER THAN 3.0 FEET BELOW FINISH GRADE

NOTE: WATERTIGHT SEPTIC TANKS REQUIRED

NOTE: CLEANOUT REQUIRED EVERY 70 FEET OF SEWER LINE AND/OR AT 90° SWEEPS IN LINES FROM HOUSE TO DRAIN FIELDS, 90° ELBOWS ARE NOT ACCEPTABLE

NOTE: ALL PARTS OF SEPTIC SYSTEMS (I.E. TANK, DISTRIBUTION BOX, DRAINFIELDS) TO BE 100 FEET FROM ANY WATER WELL UNLESS OTHERWISE SPECIFICALLY AUTHORIZED

NOTE: NO ABSORPTION TRENCH TO EXCEED 100 FEET IN LENGTH UNLESS SPECIFICALLY AUTHORIZED

NOTE: ALL PIPE FROM HOUSE TO SEPTIC TANK MUST BE CAST IRON OR SCHEDULE 35/40 PVC OR ABS

NOTE: MANHOLE RISERS REQUIRED ON ALL SEPTIC TANKS AND PUMP CHAMBERS

NOTE: DISTRIBUTION BOXES MUST HAVE BAFFLES

NOTE: IF PUMPED SEPTIC SYSTEM REQUIRED, (1) SEPTIC PUMP DETAIL TO BE PROVIDED BY INSTALLER PRIOR TO ISSUANCE OF SEPTIC PERMIT (2) PUMP PERFORMANCE TEST IS NECESSARY PRIOR TO HEALTH DEPARTMENT APPROVAL OF SEPTIC PERMIT

NEITHER THE HOWARD COUNTY COUNCIL NOR THE HEALTH DEPARTMENT IS RESPONSIBLE FOR THE SUCCESSFUL OPERATION OF ANY SYSTEM
PERMITTEE RESPONSIBLE FOR OBTAINING FINAL APPROVAL ON THIS PERMIT
CALL 410-313-2640 FOR INSPECTION OF SEPTIC SYSTEM

P 514988-B

NOT TO SCALE

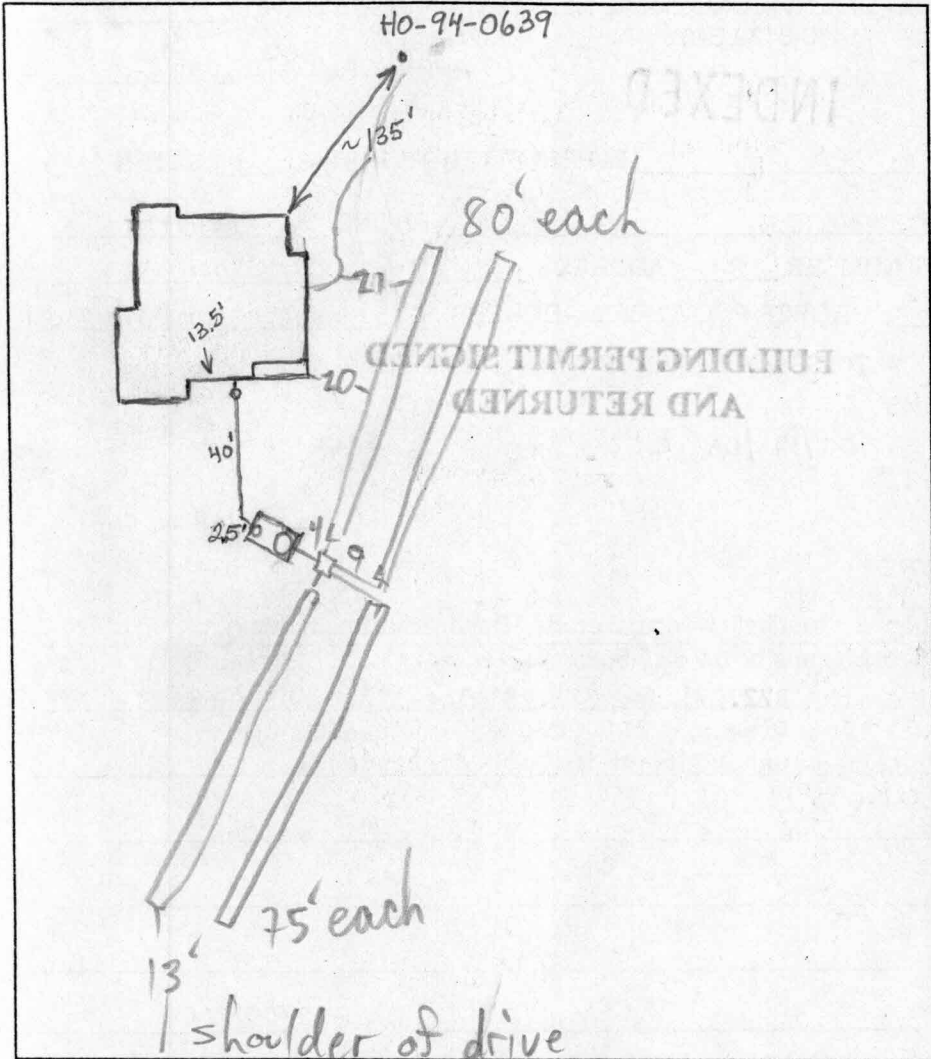

TRENCH DATA

TRENCH WIDTH 3
 TRENCH INLET DEPTH 5
 TRENCH BOTTOM DEPTH 6.5
 DEPTH OF STONE 1.5
 NUMBER OF TRENCHES 4
 TOTAL TRENCH LENGTH 310
 ABSORBENT AREA 930
 DISTRIBUTION BOX LEVEL
 BAFFLE IN DISTRIBUTION BOX

SEPTIC TANK DATA

SEPTIC TANK 1500 TS GALLONS
 MANHOLE RISER
 6 INCH INSPECTION PORT

PUMP CHAMBER DATA

~~PUMP CHAMBER GALLONS _____~~
~~MANHOLE RISER _____~~
~~ALARM _____~~
~~PUMP PERFORMANCE TEST _____~~

PRE-CONSTRUCTION INSPECTION: 6/14/01 Four trenches to be installed as per planned.

O.K. if only 3/0' of trench installed so that repair area is saved. (BB)

INSPECTION COMMENTS: 6/15/01 OK TO COVER (ML)

INSPECTOR M. Ripkin DATE SYSTEM APPROVED 6/15/01