

6/25/01
11:00
(lay out)

6/26/01
Septic Co. PM

6/27/01 - 12pm

04-362365

ISSUE DATE: 6/21/2001

APPROVAL DATE: 8/9/01

PERMIT

P 515300

A 58095-L

ON-SITE SEWAGE DISPOSAL SYSTEM HOWARD COUNTY HEALTH DEPARTMENT BUREAU OF ENVIRONMENTAL HEALTH

INDEXED

Fogles Septic Clean, Inc IS PERMITTED TO INSTALL ALTER

ADDRESS: 580 Obrecht Rd, Sykesville, MD PHONE NUMBER: 410-795-5670

SUBDIVISION: Wellington West II LOT NUMBER: 14

ADDRESS: 15200 Bucks Run Drive PROPERTY OWNER: Pulte Homes

SEPTIC TANK CAPACITY (GALLONS): 1250 (TOP SEAM)

PUMP CHAMBER CAPACITY (GALLONS): N/A

NUMBER OF BEDROOMS: 4

SQUARE FEET PER BEDROOM: 210

LINEAR FEET OF TRENCH REQUIRED: 210

TRENCHES:	Trench to be 2.0 feet wide. Inlet 3.0 feet below original grade. Bottom maximum depth 7.0 feet below original grade. Effective area begins at 3.0 feet below original grade. 4.0 feet of stone below distribution pipe.
LOCATION:	As seen from Bucks Run Drive, place the distribution box 30' down the left lot line and 35' off this same lot line. Run (3) trenches on contour toward house.
NOTES:	Install trenches 10' apart center-to-center to allow adequate room for repairs.

PLANS APPROVED: MER OK SRK 5/11/01 DATE: 5/9/01

- NOTE: PERMIT VOID AFTER 2 YEARS
- NOTE: CONTRACTOR RESPONSIBLE FOR SCHEDULING A PRE-CONSTRUCTION INSPECTION FOR ALL INSTALLATIONS
- NOTE: WATERTIGHT SEPTIC TANKS REQUIRED
- NOTE: ALL PARTS OF SEPTIC SYSTEM SHALL BE 100 FEET FROM ANY WATER WELL
- NOTE: MANHOLE RISERS REQUIRED ON ALL SEPTIC TANKS AND PUMP CHAMBERS

NEITHER THE HOWARD COUNTY COUNCIL NOR THE HEALTH DEPARTMENT IS RESPONSIBLE FOR THE SUCCESSFUL OPERATION OF ANY SYSTEM PERMITTEE RESPONSIBLE FOR OBTAINING FINAL APPROVAL ON THIS PERMIT CALL 410-313-2640 FOR INSPECTION OF SEPTIC SYSTEM

P 515300

NOT TO SCALE

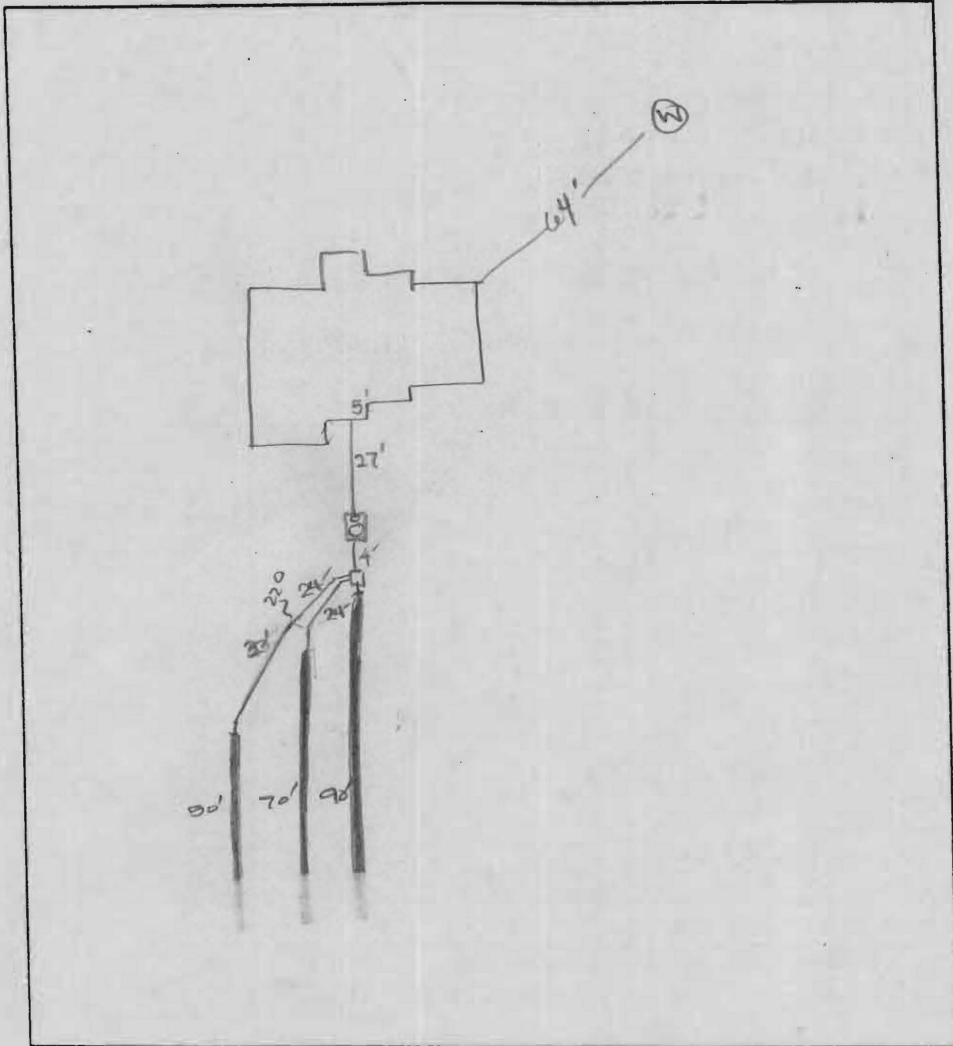

TRENCH DATA

TRENCH WIDTH 2
TRENCH INLET DEPTH 3
TRENCH BOTTOM DEPTH 7
DEPTH OF STONE 4
NUMBER OF TRENCHES 3
TOTAL TRENCH LENGTH 210'
ABSORBENT AREA 840ft²
DISTRIBUTION BOX LEVEL ✓
BAFFLE IN DISTRIBUTION BOX ✓

SEPTIC TANK DATA

SEPTIC TANK 1250 GALLONS
MANHOLE RISER ✓
6 INCH INSPECTION PORT ✓

PUMP CHAMBER DATA

~~PUMP CHAMBER
GALLONS _____
MANHOLE RISER _____
ALARM _____
PUMP PERFORMANCE TEST _____~~

PRE-CONSTRUCTION INSPECTION: 6/25/01 OK TO START w/DB 2' B.G. @

HOUSE END OF LOW TRENCH, TRENCHES AS PER PLAN (MP)

INSPECTION COMMENTS: 6/26/01 Needs house connection. OK to
continue work. DKC

6/27/01 A.M. OK to complete installation. DKE

6/27/01 P.M. OK to cover all septic work- needs
house connection for final approval. DKE

8/9/01- VERIFIED w/BUILDER THAT HOUSE CONN. HAS BEEN MADE (SRK)

INSPECTOR Steven R. Knig DATE SYSTEM APPROVED 8/9/01



BUCKS RUN DRIVE
(PUBLIC STREET-40' R/W)

UNION CHAPEL ROAD
(SCENIC ROAD/MAJOR COLLECTOR-60' R/W)
VEHICULAR INGRESS AND EGRESS RESTRICTED
269.57'

S78°27'10"W 35.36'
N56°32'50"W 54.69'
R=520.00'
L=76.16'
S64°56'22"E 13.01'

6' PUBLIC DITCH ESM'T

SEE DETAIL

24' PRIVATE USE-IN-COMMON
INGRESS/EGRESS ESM'T. FOR
LOTS 14-16 AND LOTS 32-33
SECTION 2, AREA 2

10' TREE MAINT. ESM'T.

LOT 14

LOT 16

LOT 15

6/21/01
House location
consistent with
approved B.P.
plan

BB

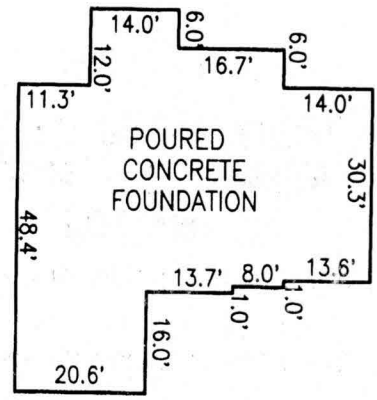

FOUNDATION DETAIL

SCALE: 1" = 30'

TOP OF FOUNDATION WALL ELEV. = 546.0'
OFFSET DIMENSIONS TO PROPERTY LINES ARE ± 1.0'

SURVEYOR'S CERTIFICATE

I HEREBY CERTIFY TO THE BEST OF MY PROFESSIONAL KNOWLEDGE, INFORMATION AND BELIEF, THAT THE DIMENSIONS OF THE BUILDING WALLS SHOWN HEREON ARE CORRECT; THAT THEY ARE BASED ON A FIELD RUN SURVEY PERFORMED BY BENCHMARK ENGINEERING, INC. ON 6/01/01; AND THAT THE PROPERTY OUTLINE SHOWN HEREON IS BASED ON THE PLAT PREPARED BY BENCHMARK ENGINEERING, INC. ENTITLED "WELLINGTON WEST, SECTION 2, AREA ONE", AND RECORDED AMONG THE LAND RECORDS OF HOWARD COUNTY AS PLAT No. 13635.

David M. Harris
DAVID M. HARRIS
REGISTERED PROFESSIONAL LAND SURVEYOR
MD REG. No. 10978
FOR BENCHMARK ENGINEERING, INC.
MD REG. No. 351
RECORD PLAT No. 13635
FEMA FIRM No. 240044 0014 B
ZONE: C
DATED: 12/04/86

BENCHMARK

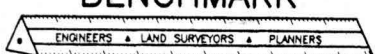

ENGINEERING, INC.

8480 BALTIMORE NATIONAL PIKE ▲ SUITE 418
ELLICOTT CITY, MD 21043
PHONE: 410-465-6105 FAX: 410-465-6644



WALL CHECK

**WELLINGTON WEST
SECTION 2, AREA ONE
LOT No. 14**

15200 BUCKS RUN DRIVE

4TH ELECTION DISTRICT

HOWARD COUNTY, MARYLAND

SCALE: 1" = 60' DATE: 6/01/01