

3/14/02  
10:00

ISSUE DATE: 8/15/01

# PERMIT INDEXED

P 515984 & 5

APPROVAL DATE: 3/15/02

A REPAIR

## ON-SITE SEWAGE DISPOSAL SYSTEM HOWARD COUNTY HEALTH DEPARTMENT BUREAU OF ENVIRONMENTAL HEALTH

**04-337557**

Jack Fyock Septic Service IS PERMITTED TO INSTALL  ALTER

ADDRESS: P.O. Box 89, Glenelg, MD 21737 PHONE NUMBER: 410-988-9270

SUBDIVISION: Brantly LOT NUMBER: 13

ADDRESS: 3356 Brantly Road PROPERTY OWNER: M. Pedrotti-Krueger

SEPTIC TANK CAPACITY (GALLONS): 1250

PUMP CHAMBER CAPACITY (GALLONS): N/A

NUMBER OF BEDROOMS: 5 w/BR added 8/01

SQUARE FEET PER BEDROOM: 210

LINEAR FEET OF TRENCH REQUIRED: 55

TRENCHES:	Trench to be <u>2</u> feet wide. Inlet <u>4</u> feet below original grade. Bottom maximum depth <u>10</u> feet below original grade. Effective area begins at <u>4</u> feet below original grade. <u>6</u> feet of stone below distribution pipe.
LOCATION:	
PURPOSE: <u>?</u>	Existing septic system has failed. Call for inspection when ground is opened so sanitarian can recommend repair.

PLANS APPROVED: \_\_\_\_\_ DATE: \_\_\_\_\_

- NOTE: PERMIT VOID AFTER 2 YEARS
- NOTE: CONTRACTOR RESPONSIBLE FOR SCHEDULING A PRE-CONSTRUCTION INSPECTION FOR ALL INSTALLATIONS
- NOTE: WATERTIGHT SEPTIC TANKS REQUIRED
- NOTE: ALL PARTS OF SEPTIC SYSTEM SHALL BE 100 FEET FROM ANY WATER WELL
- NOTE: MANHOLE RISERS REQUIRED ON ALL SEPTIC TANKS AND PUMP CHAMBERS

**NEITHER THE HOWARD COUNTY COUNCIL NOR THE HEALTH DEPARTMENT IS RESPONSIBLE FOR THE SUCCESSFUL OPERATION OF ANY SYSTEM PERMITTEE RESPONSIBLE FOR OBTAINING FINAL APPROVAL ON THIS PERMIT CALL 410-313-2640 FOR INSPECTION OF SEPTIC SYSTEM**

515984

NOT TO SCALE

**TRENCH DATA**

TRENCH WIDTH 2'  
 TRENCH INLET DEPTH 3.5'  
 TRENCH BOTTOM DEPTH 9.5'  
 DEPTH OF STONE 6'  
 NUMBER OF TRENCHES 1  
 TOTAL TRENCH LENGTH 55  
 ABSORBENT AREA \_\_\_\_\_  
 DISTRIBUTION BOX LEVEL yes  
 BAFFLE IN DISTRIBUTION BOX yes

**SEPTIC TANK DATA**

SEPTIC TANK \_\_\_\_\_ GALLONS  
 MANHOLE RISER \_\_\_\_\_  
 6 INCH INSPECTION PORT \_\_\_\_\_

**PUMP CHAMBER DATA**

PUMP CHAMBER \_\_\_\_\_  
 GALLONS \_\_\_\_\_  
 MANHOLE RISER \_\_\_\_\_  
 ALARM \_\_\_\_\_  
 PUMP PERFORMANCE TEST \_\_\_\_\_

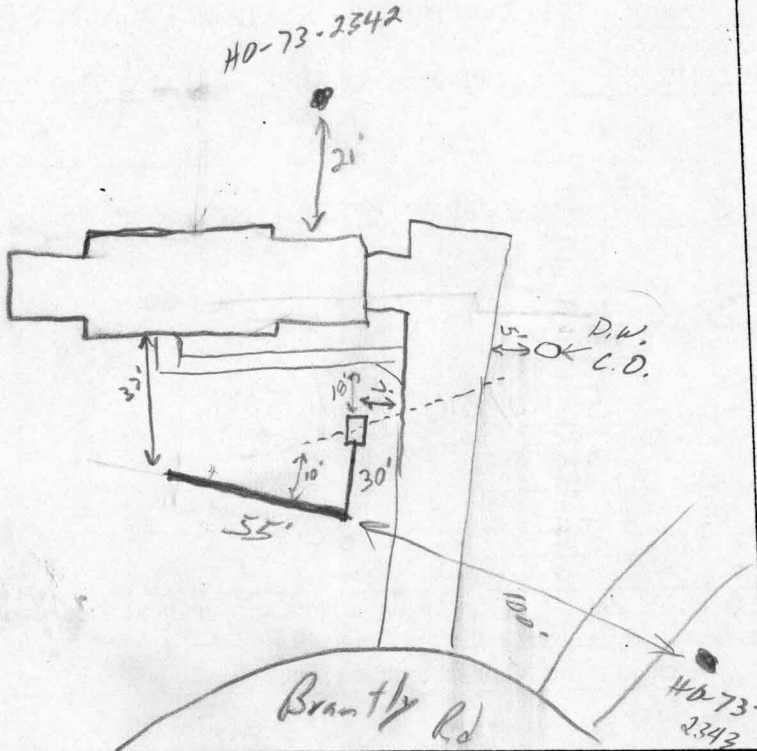

PRE-CONSTRUCTION INSPECTION: \_\_\_\_\_

INSPECTION COMMENTS: 3/14/02 Trench 2/3 installed. Soil appears consistent to 9.5' - Lt orange-brown sandy loam (SC) Existing trench appears to be off contour (SC)

INSPECTOR [Signature] DATE SYSTEM APPROVED 3/15/02