

8/23/01 - Layout 11am

ISSUE DATE: 8/22/2001

APPROVAL DATE: 8/24/01

# PERMIT INDEXED

P 515998-B

A 59868

## ON-SITE SEWAGE DISPOSAL SYSTEM HOWARD COUNTY HEALTH DEPARTMENT BUREAU OF ENVIRONMENTAL HEALTH **03-333760**

Fogles Septic Clean, Inc IS PERMITTED TO INSTALL  ALTER

ADDRESS: 580 Obrecht Road, Sykesville PHONE NUMBER: 410-795-5670

SUBDIVISION: The Paddocks LOT NUMBER: 23

ADDRESS: 13724 Bold Venture Drive PROPERTY OWNER: Pulte Home Co

SEPTIC TANK CAPACITY (GALLONS): 1250

PUMP CHAMBER CAPACITY (GALLONS): N/A

NUMBER OF BEDROOMS: 4

SQUARE FEET PER BEDROOM: 180

LINEAR FEET OF TRENCH REQUIRED: 180

8/24/01 OK TO START  
(2) 90' TRENCHES (MM)

TRENCHES:	Trench to be 2.0 feet wide. Inlet 3.5 feet below original grade. Bottom maximum depth 7.5 feet below original grade. Effective area begins at 3.5 feet below original grade. 4.0 feet of stone below distribution pipe.
LOCATION:	Begin trenches 195 feet down the left lot line and 70 feet off that same lot line as seen when facing the lot from Bold Venture Drive. Run trenches on contour in both directions.
NOTES:	

PLANS APPROVED: Amy Mc Millen 6/21/01 OK (BB) DATE: 6-18-01

- NOTE: PERMIT VOID AFTER 2 YEARS
- NOTE: CONTRACTOR RESPONSIBLE FOR SCHEDULING A PRE-CONSTRUCTION INSPECTION FOR ALL INSTALLATIONS
- NOTE: WATERTIGHT SEPTIC TANKS REQUIRED
- NOTE: ALL PARTS OF SEPTIC SYSTEM SHALL BE 100 FEET FROM ANY WATER WELL
- NOTE: MANHOLE RISERS REQUIRED ON ALL SEPTIC TANKS AND PUMP CHAMBERS

**NEITHER THE HOWARD COUNTY COUNCIL NOR THE HEALTH DEPARTMENT IS RESPONSIBLE FOR THE SUCCESSFUL OPERATION OF ANY SYSTEM PERMITTEE RESPONSIBLE FOR OBTAINING FINAL APPROVAL ON THIS PERMIT CALL 410-313-2640 FOR INSPECTION OF SEPTIC SYSTEM**

**BUILDING PERMIT SIGNED  
AND RETURNED 7-10-02  
800 137411 - DECK**

P515998-B

NOT TO SCALE

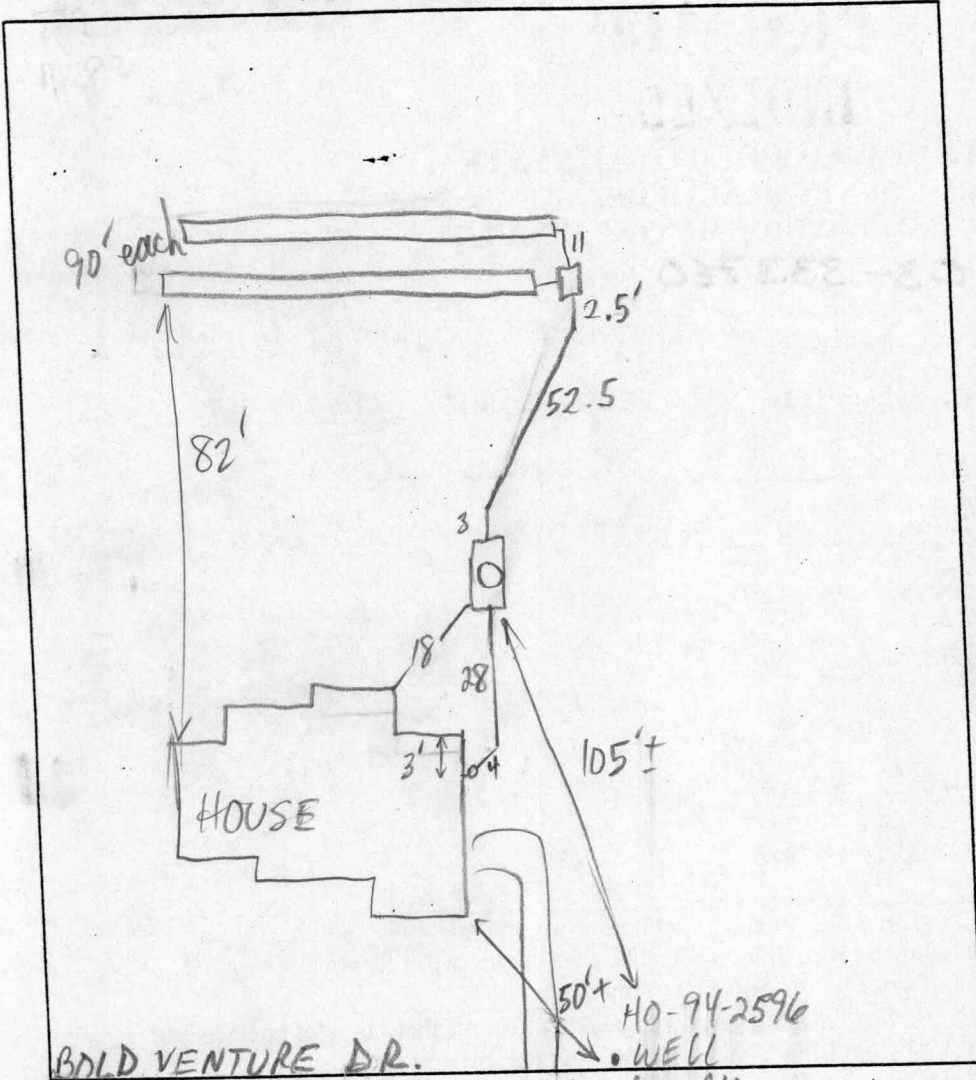

**TRENCH DATA**

TRENCH WIDTH 2  
 TRENCH INLET DEPTH 3.5  
 TRENCH BOTTOM DEPTH 7.5  
 DEPTH OF STONE 4  
 NUMBER OF TRENCHES 2  
 TOTAL TRENCH LENGTH 180  
 ABSORBENT AREA 720  
 DISTRIBUTION BOX LEVEL   
 BAFFLE IN DISTRIBUTION BOX

**SEPTIC TANK DATA**

SEPTIC TANK 1250TS GALLONS  
 MANHOLE RISER   
 6 INCH INSPECTION PORT

**PUMP CHAMBER DATA**

PUMP CHAMBER GALLONS \_\_\_\_\_  
 MANHOLE RISER \_\_\_\_\_  
 ALARM \_\_\_\_\_  
 PUMP PERFORMANCE TEST \_\_\_\_\_

BOLD VENTURE DR.

PRE-CONSTRUCTION INSPECTION: 8/24/01 AM OK TO START w/2 90' TRENCHES MR

INSPECTION COMMENTS: 8/24/01 PM OK TO COVER (MR)

INSPECTOR M. Ripkin

DATE SYSTEM APPROVED 8/24/01