

11/26/01 2-3pm final

11/30/02 10:30am pump test

11/25/02 Pump Test 1:00

ISSUE DATE: 10/16/2001
APPROVAL DATE: 1/30/02

INDEXED PERMIT

P 516073
A 58576-B

ON-SITE SEWAGE DISPOSAL SYSTEM HOWARD COUNTY HEALTH DEPARTMENT BUREAU OF ENVIRONMENTAL HEALTH

05-435765

Kenneth Mayne IS PERMITTED TO INSTALL ALTER

ADDRESS: 11723 Legore Bridge Road, 21757 PHONE NUMBER: 301-898-0955

SUBDIVISION: Beaufort Park LOT NUMBER: 6

ADDRESS: ⁸⁵²⁷8519 Blount's Lane PROPERTY OWNER: Trinity Custom Homes

SEPTIC TANK CAPACITY (GALLONS): 1250
PUMP CHAMBER CAPACITY (GALLONS): 1250
NUMBER OF BEDROOMS: 4
SQUARE FEET PER BEDROOM: 180
LINEAR FEET OF TRENCH REQUIRED: 240

TRENCHES:	Trench to be 3.0 feet wide. Inlet 2.0 feet below original grade. Bottom maximum depth 4.0 feet below original grade. Effective area begins at 3.0 feet below original grade. 2.0 feet of stone below distribution pipe.
LOCATION:	Begin trenches 190 feet up the lot line between Lots 3 & 4 and 10 feet off that same lot line as seen when facing the lot from Blount's Lane. Run trenches on contour.
NOTES:	

PLANS APPROVED: Amy Mc Millen ^{7/12/01 OK BB} DATE: 7-11-01

- NOTE: PERMIT VOID AFTER 2 YEARS
- NOTE: CONTRACTOR RESPONSIBLE FOR SCHEDULING A PRE-CONSTRUCTION INSPECTION FOR ALL INSTALLATIONS
- NOTE: WATERTIGHT SEPTIC TANKS REQUIRED
- NOTE: ALL PARTS OF SEPTIC SYSTEM SHALL BE 100 FEET FROM ANY WATER WELL
- NOTE: MANHOLE RISERS REQUIRED ON ALL SEPTIC TANKS AND PUMP CHAMBERS

NEITHER THE HOWARD COUNTY COUNCIL NOR THE HEALTH DEPARTMENT IS RESPONSIBLE FOR THE SUCCESSFUL OPERATION OF ANY SYSTEM PERMITTEE RESPONSIBLE FOR OBTAINING FINAL APPROVAL ON THIS PERMIT CALL 410-313-2640 FOR INSPECTION OF SEPTIC SYSTEM

SEWER PERMIT SIGNED AND RETURNED 1-26-2002
B00133610
1000 GAL PROPANE TANK

CI.09107

NOT TO SCALE

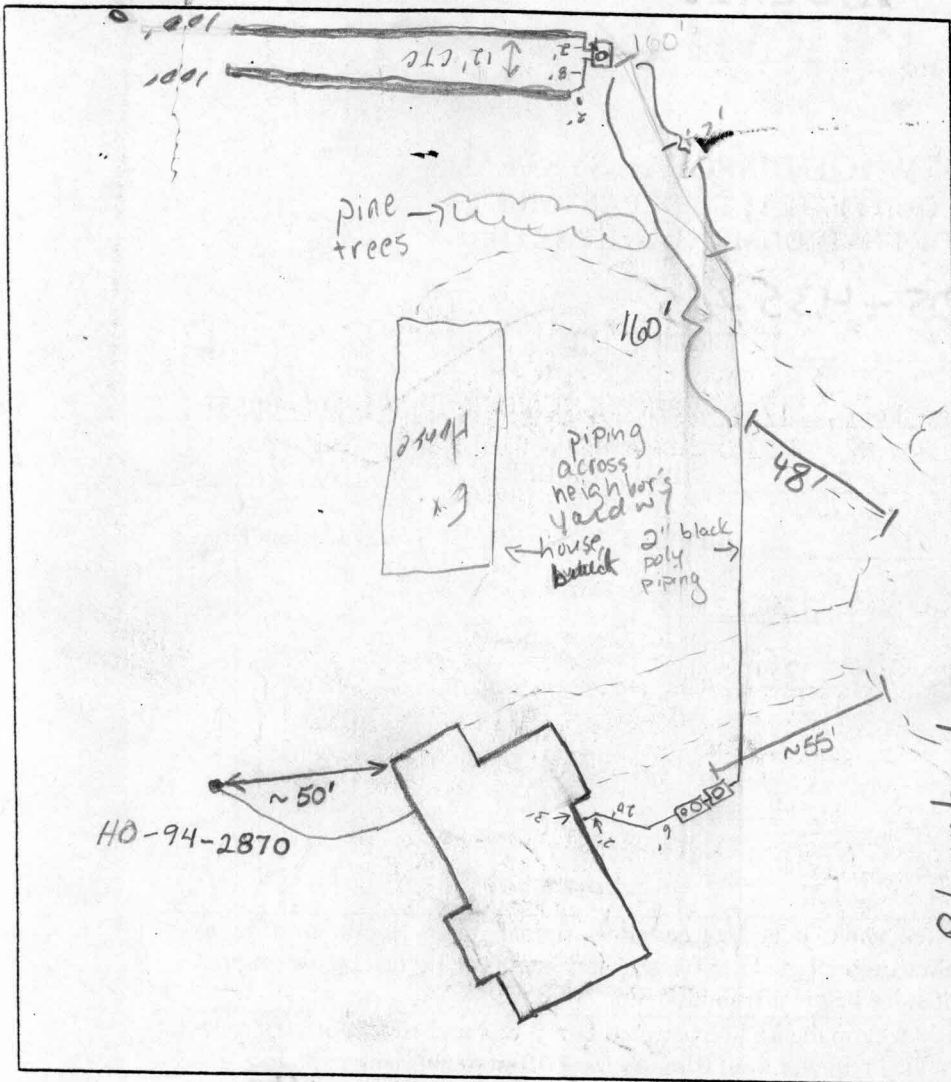

TRENCH DATA

TRENCH WIDTH 2'
 TRENCH INLET DEPTH 2'
 TRENCH BOTTOM DEPTH 4'
 DEPTH OF STONE 2'
 NUMBER OF TRENCHES 2
 TOTAL TRENCH LENGTH 200'
 ABSORBENT AREA 600 sq ft
 DISTRIBUTION BOX LEVEL
 BAFFLE IN DISTRIBUTION BOX

SEPTIC TANK DATA

SEPTIC TANK 1250 TS GALLONS
 MANHOLE RISER Center
 6 INCH INSPECTION PORT front

PUMP CHAMBER DATA

PUMP CHAMBER GALLONS 1250 TS
 MANHOLE RISER Center
 ALARM Functioning
 PUMP PERFORMANCE TEST OK

PRE-CONSTRUCTION INSPECTION: 11/16/01 Electric line suspected to run through part of easement. Miss Utility to mark. If a significant
 INSPECTION COMMENTS: part of easement is unusable then line must be moved. (BB) 11/26/01 Tanks set, house cov. near to be sealed, Trenches in, pressure line was installed when house next door was constructed, contractor connecting to both ends to complete, upper end not connected to DB, contractor will fix line location (SD) 11/25/02 Alarm OK, pump running but no flow. Then breaker trips (E) 11/30/02 Pump & alarm working (KG)

INSPECTOR Spredak DATE SYSTEM APPROVED 11/30/02