

C1 07639

SEQUENCE NO. (MDE USE ONLY)

STATE OF MARYLAND WELL COMPLETION REPORT

THIS REPORT MUST BE SUBMITTED AFTER WELL IS COMPLETED.

COUNTY NUMBER A49409

ST/CO USE ONLY DATE Received

DATE WELL COMPLETED 3/11/00

Depth of Well 300 (TO NEAREST FOOT)

PERMIT NO. FROM "PERMIT TO DRILL WELL" No - 94 - 2591

OWNER Scheidt Susan Bitter Lane Highland Paternal Gift Farm SECTION LOT 20

WELL LOG table with columns: DESCRIPTION, FEET (FROM, TO), check if water bearing. Includes entries like Topsoil, Micaceous Clay, Br. mica, Granite, Fractured Zone, etc.

GROUTING RECORD. WELL HAS BEEN GROUTED (Y). TYPE OF GROUTING MATERIAL: CEMENT (CM), BENTONITE CLAY (BC). NO. OF BAGS 19, NO. OF POUNDS 1900.

CASING RECORD. MAIN CASING TYPE: ST (STEEL). Nominal diameter top (main) casing 6 inches, Total depth of main casing 75 feet.

OTHER CASING (if used) table with columns: diameter inch, depth (feet) from, to.

SCREEN RECORD. screen type or open hole: ST (STEEL). insert appropriate code below.

NUMBER OF UNSUCCESSFUL WELLS: 0. WELL HYDROFRACTURED: Y.

CIRCLE APPROPRIATE LETTER: A (A WELL WAS ABANDONED AND SEALED), E (ELECTRIC LOG OBTAINED), P (TEST WELL CONVERTED TO PRODUCTION WELL).

I HEREBY CERTIFY THAT THIS WELL HAS BEEN CONSTRUCTED IN ACCORDANCE WITH COMAR 26.04.04 "WELL CONSTRUCTION" AND IN CONFORMANCE WITH ALL CONDITIONS STATED IN THE ABOVE CAPTIONED PERMIT...

DRILLERS LIC. NO. MW D 040. DRILLERS SIGNATURE: George F. Fustoling. LIC. NO. MW D 386.

SITE SUPERVISOR (sign. of driller or journeyman responsible for sitework if different from permittee)

DEPTH (nearest ft.) table with columns 1-21. Values: 110, 73, 300. SLOT SIZE 1, 2, 3. DIAMETER OF SCREEN 56 (NEAREST INCH).

GRAVEL PACK IF WELL DRILLED WAS FLOWING WELL INSERT F IN BOX 68.

MDE USE ONLY (NOT TO BE FILLED IN BY DRILLER) T (E.R.O.S.), W Q. TELESCOPE CASING, LOG INDICATOR, OTHER DATA.

PUMPING TEST. HOURS PUMPED (nearest hour) 3. PUMPING RATE (gal. per min.) 10. METHOD USED TO MEASURE PUMPING RATE Bucket. WATER LEVEL (distance from land surface) BEFORE PUMPING 36 ft., WHEN PUMPING 123 ft. TYPE OF PUMP USED (for test) S (submersible).

PUMP INSTALLED. DRILLER INSTALLED PUMP YES (NO). IF DRILLER INSTALLS PUMP, THIS SECTION MUST BE COMPLETED FOR ALL WELLS. TYPE OF PUMP INSTALLED PLACE (A,C,J,P,R,S,T,O) IN BOX 29. CAPACITY: GALLONS PER MINUTE (to nearest gallon) 31-35. PUMP HORSE POWER 37-41. PUMP COLUMN LENGTH (nearest ft.) 43-47. CASING HEIGHT (circle appropriate box and enter casing height) + above, - below. LAND SURFACE 2 (nearest foot).

LOCATION OF WELL ON LOT. SHOW PERMANENT STRUCTURES AND INDICATE NOT LESS THAN TWO DISTANCES (MEASUREMENTS TO WELL). Includes handwritten notes: well, Approx 50', Approx 70'.

B 1 09623

SEQUENCE NO. (MDE USE ONLY)

STATE OF MARYLAND PERMIT TO DRILL WELL please print or type

STATE PERMIT NUMBER

HO-94-2591 fill in this form completely

Date Received (APA) 1/28/00

OWNER INFORMATION RN 8144

Scheidt Susan 12730 Hall Shop Highland, Md. 20777

Howard Paternal Gift Farm Highland 1 MILE FROM TOWN

DRILLER INFORMATION

George F. Easterday M D 040 L. Franklin Easterday, Inc. 9265 Brown Church Rd.. MT. Airv. Md. 21771

Direction of Well from Town (circle box) Biter Lane ON WHICH SIDE OF ROAD (circle appropriate box) DISTANCE FROM ROAD 40 FT TAX MAP: 40 BLK: PARCEL 90

WELL INFORMATION

APPROX. PUMPING RATE (GAL. PER MIN.) 5 APPROX. PUMPING RATE (GAL. PER MIN.) 8 AVERAGE DAILY QUANTITY NEEDED (GAL. PER DAY) 500

USE FOR WATER (circle appropriate box)

- DOMESTIC POTABLE SUPPLY & RESIDENTIAL IRRIGATION FARMING (LIVESTOCK WATERING & AGRICULTURAL IRRIGATION INDUSTRIAL, COMMERCIAL, DEWATERING PUBLIC WATER SUPPLY WELL TEST, OBSERVATION, MONITORING GEO-THERMAL

NOT TO BE FILLED IN BY DRILLER HEALTH DEPARTMENT APPROVAL

Howard A49409 COUNTY NAME COUNTY NO. STATE SIGNATURE INSERT S DATE ISSUED 2/4/00 CO SIGNATURE EXP. DATE 3/4/01 NORTH GRID 487 000 EAST GRID 0812 000

APPROXIMATE DEPTH OF WELL 300 FEET APPROXIMATE DIAMETER OF WELL 6 INCH

METHOD OF DRILLING (circle one)

BORED (or Augered) JETTED Jetted & DRIVEN AIR-ROtary AIR-PERcussion ROTARY (Hydraulic Rotary) CABLE RReverse-ROtary DRive-POINT

REPLACEMENT OR DEEPEMED WELLS (circle appropriate box)

THIS WELL WILL NOT REPLACE AN EXISTING WELL THIS WELL WILL REPLACE A WELL THAT WILL BE ABANDONED AND SEALED THIS WELL WILL REPLACE A WELL THAT WILL BE USED AS A STANDBY-CONTACT LOCAL APPROVING AUTHORITY FOR POLICY ON STANDBY WELLS THIS WELL WILL DEEPEAN AN EXISTING WELL PERMIT NUMBER OF WELL TO BE REPLACED OR DEEPEMED (IF AVAILABLE) 41

Not to be filled in by driller (MDE OR COUNTY USE ONLY)

APPROX. PERMIT NUMBER 54 HO 96 GAP 007 PERMIT No. HO-94-2591

SHOW MAJOR FEATURES OF BOX & LOCATE WELL WITH AN X SOURCES OF DRILLING WATER 1. wells 2. 3. WRITE THE BOX NUMBER FROM THE MAP HERE E 810 2 N 480 7

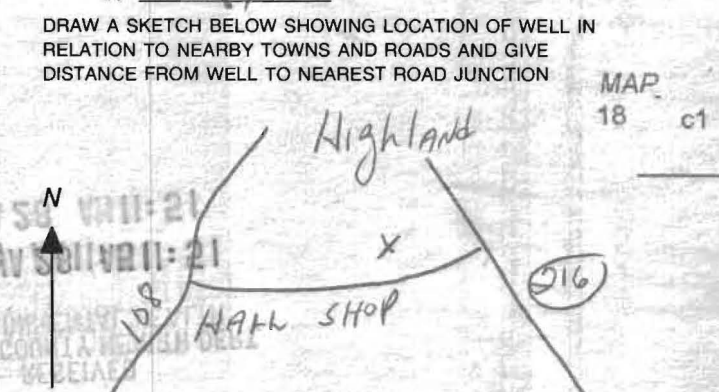

SPECIAL CONDITIONS NOTE - APPROVING AUTHORITIES SHOULD USE SEPARATE SHEET IF NEEDED

HOWARD COUNTY HEALTH DEPARTMENT
BUREAU OF ENVIRONMENTAL HEALTH
WATER AND SEWERAGE PROGRAM
TEL: (410)313-2640 FAX: (410)313-2648

Information Form for the Installation of the Well Pump, Pitless Adapter, and Supply Piping

NOTE: The installer is responsible for requesting an inspection prior to 9 am on the day of the desired inspection. No work is to be covered until approved by the Health Department. All installations must comply with the National Standard Plumbing Code (NSPC, as amended locally) and COMAR 26.04.04 (MD Well Construction Regulations). Submission of a complete form is required prior to Use and Occupancy approval.

Company Name: CHARLES A. KLEIN & SON, INC. Telephone #: (410) 549-6960
Address: 5200 KLEIN MILL ROAD
SPRINGFIELD, MD 21784

(Must circle one) Licensed Plumber Licensed Well Driller Licensed Well Pump Installer
License # and name of individual responsible for the field installation:
Name (Print): CHARLES A. KLEIN, JR. License# 6521

*A licensed individual must perform the actual installation. Apprentices must be under the direct supervision of a licensed journeyman or master plumber, pump installer or well driller. Licenses may be subjected to field verification.

Name of Property Owner: FRANK D'AMBRA Telephone #: 443-622-3965
Subdivision: LATERAL BAY Lot #: 20 Well Tag #: HO-74-2591
Site Address: 7105 BITER LANE
HIGHLAND, MD 20771

Submersible Pump Data

Make: JACUZZI
Model #: 5145-13P-52
Pump Capacity 5 GPM
Well Yield: 10 GPM

Pitless Adapter

Make: HARWARD
Model #: PT-800
Depth: 42" (36" min)
NSF approved:

Well Cap and Electric Conduit

Two piece watertight cap:
Screened, vented well cap:
Cap secured to casing:
Conduit min 18" B.G.:
Conduit secured to well cap:

Depth of well encountered at time of pump installation: 300 (feet)
If pump capacity exceeds well yield, a low water cut off switch is required by NSPC 1990 Section 17.8.4
Torque arrestors or Cable guards are required - Must circle one
Safety rope, if used, attached to inside of well casing with eye bolt

Piping to house

Type: POLYETHYLENE
PSI: (160 psi min)
Depth of supply line: 42 (36" min)

House Connection

PVC sleeved to undisturbed soil at wall penetration: Yes
Approximate length of sleeve:
Sleeve caulked and sealed properly:

The water supply line is required to be at least ten feet from the septic tank, pump chamber, sewage piping, distribution box, drainfields, and sewage reserve area. If this cannot be accomplished, contact this office for approval prior to installation.

Charles A. Klein Jr. date 8/10/01
Signature of company representative responsible for installation

For Health Department Use Only - Not to be completed by Installer

Date Insp. Requested: 6/26/01 Date Insp. Approved: 6/26/01 (DKC) SRN

- Inspection Data: Pitless adapter and water supply line at least 36" below grade
- Two piece cap installed and attached to casing securely
- Elec. conduit extends at least 18" below grade/attached to cap properly
- Safety rope installed inside of well casing
- Correct well tag attached properly and casing 8" above finished grade
- Water supply line sleeved adequately at house connection
- Adequate grout observed below pitless adapter