

# PERMIT

P 515321

SEWAGE DISPOSAL SYSTEM  
HOWARD COUNTY HEALTH DEPARTMENT  
BUREAU OF ENVIRONMENTAL HEALTH  
410-313-2640

A 49416

ISSUE DATE 7/6/2001

APPROVAL DATE 7/11/01

2ND APPR. DATE 3/12/02

**INDEXED**

C & C Utility Service

IS PERMITTED TO INSTALL  ALTER

ADDRESS 7398 Gaither Road, Sykesville, MD 21784 PHONE 410-984-4851

SUBDIVISION Paternal Gift Farm LOT NUMBER 16 ADDRESS 7104 Biter Lane

PROPERTY OWNER Tradition Home Builders PROPERTY OWNER'S ADDRESS 4800 Ten Oaks Road

SEPTIC TANK CAPACITY 1250 GALLONS (TOPSEAM)

PUMP CHAMBER CAPACITY N/A GALLONS

NUMBER OF BEDROOMS 4

SQUARE FEET PER BEDROOM 180

LINEAR FEET OF TRENCH REQUIRED 240

TRENCHES: Trenches to be 3 feet wide. Inlet 5 feet below original grade. Bottom maximum depth 7 feet below original grade. 2 feet of stone below distribution box.

LOCATION: Place the distribution box 75 feet off the right (270.77') lot line and 100 feet off the rear (177.90') lot line as viewed from Biter Lane. Install trenches on contour toward the right and rear property lines.

3/12/02 - SUPPLEMENTAL INSTALLATION OF 60' TRENCH TO SUPPORT 5<sup>th</sup> BR; OK TO INSTALL UNDER ORIG PERMIT; INSTALL AS SHALLOW AS POSSIBLE 10' HIGHER THAN EX. HIGH TRENCH W/2ND D. BOX (MR)

PLANS APPROVED Ronald J. Pinkley, R.S. OK SRK 7/6/01 DATE 11/6/2000

PERMIT VOID AFTER 2 YEARS

NOTE: CONTRACTOR RESPONSIBLE FOR SCHEDULING A PRE-CONSTRUCTION INSPECTION FOR ALL INSTALLATIONS

NOTE: TOP OF SEPTIC TANKS ARE TO BE NO DEEPER THAN 3.0 FEET BELOW FINISH GRADE

NOTE: WATERTIGHT SEPTIC TANKS REQUIRED

NOTE: CLEANOUT REQUIRED EVERY 70 FEET OF SEWER LINE AND/OR AT 90° SWEEPS IN LINES FROM HOUSE TO DRAIN FIELDS, 90° ELBOWS ARE NOT ACCEPTABLE

NOTE: ALL PARTS OF SEPTIC SYSTEMS (I.E. TANK, DISTRIBUTION BOX, DRAINFIELDS) TO BE 100 FEET FROM ANY WATER WELL UNLESS OTHERWISE SPECIFICALLY AUTHORIZED

NOTE: NO ABSORPTION TRENCH TO EXCEED 100 FEET IN LENGTH UNLESS SPECIFICALLY AUTHORIZED

NOTE: ALL PIPE FROM HOUSE TO SEPTIC TANK MUST BE CAST IRON OR SCHEDULE 35/40 PVC OR ABS

NOTE: MANHOLE RISERS REQUIRED ON ALL SEPTIC TANKS AND PUMP CHAMBERS

NOTE: DISTRIBUTION BOXES MUST HAVE BAFFLES

NOTE: IF PUMPED SEPTIC SYSTEM REQUIRED, (1) SEPTIC PUMP DETAIL TO BE PROVIDED BY INSTALLER PRIOR TO ISSUANCE OF SEPTIC PERMIT (2) PUMP PERFORMANCE TEST IS NECESSARY PRIOR TO HEALTH DEPARTMENT APPROVAL OF SEPTIC PERMIT

NEITHER THE HOWARD COUNTY COUNCIL NOR THE HEALTH DEPARTMENT IS RESPONSIBLE FOR THE SUCCESSFUL OPERATION OF ANY SYSTEM  
PERMITTEE RESPONSIBLE FOR OBTAINING FINAL APPROVAL ON THIS PERMIT  
CALL 410-313-2640 FOR INSPECTION OF SEPTIC SYSTEM

7/9/01  
Layout  
1:00  
3/12/02  
11:00  
05-421829

NOT TO SCALE 80'

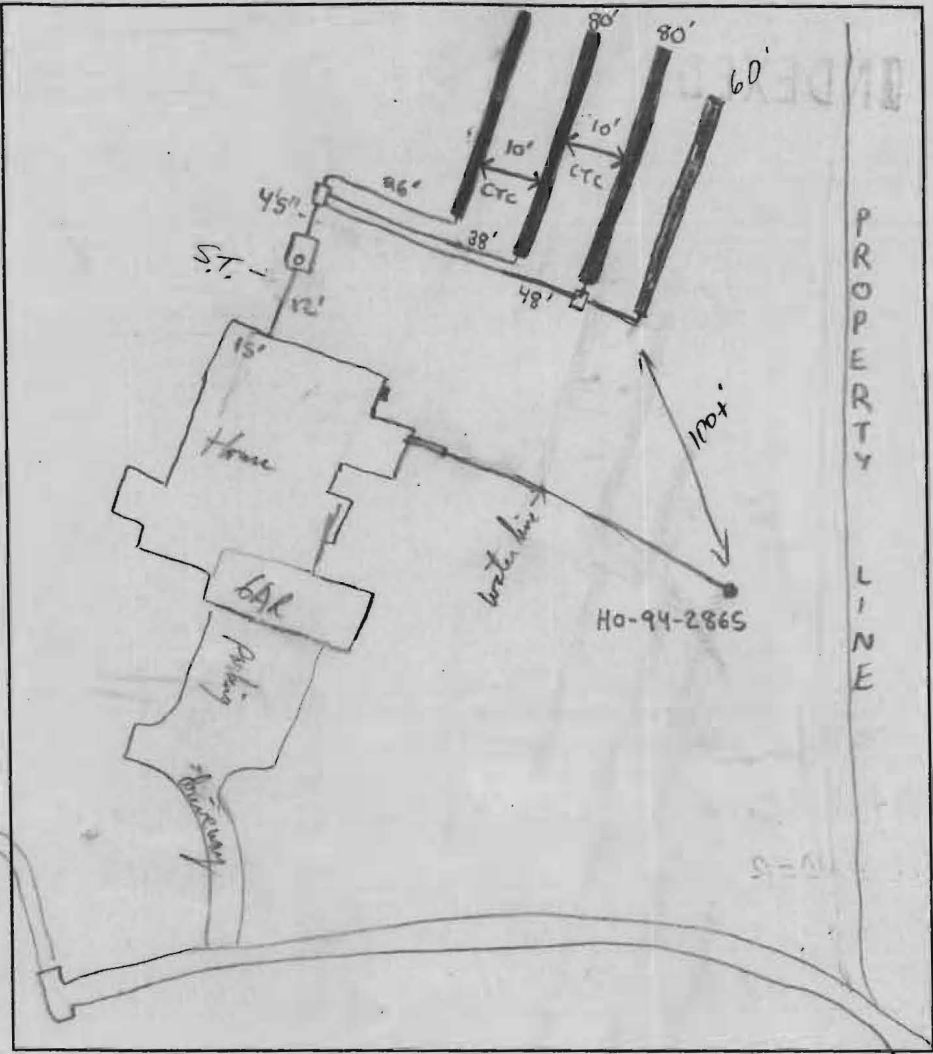

**TRENCH DATA**

TRENCH WIDTH 3'  
 TRENCH INLET DEPTH 5'  
 TRENCH BOTTOM DEPTH 7'  
 DEPTH OF STONE 2'  
 NUMBER OF TRENCHES 3  
 TOTAL TRENCH LENGTH 240' (300')  
 ABSORBENT AREA 720ft<sup>2</sup> (900ft<sup>2</sup>)  
 DISTRIBUTION BOX LEVEL   
 BAFFLE IN DISTRIBUTION BOX

**SEPTIC TANK DATA**

SEPTIC TANK 1250 T.S. GALLONS  
 MANHOLE RISER NA < 18" cover  
 6 INCH INSPECTION PORT on front

**PUMP CHAMBER DATA**

PUMP CHAMBER GALLONS NA  
 MANHOLE RISER NA  
 ALARM NA  
 PUMP PERFORMANCE TEST NA

PRE-CONSTRUCTION INSPECTION: Layout, OK to place 3 x 80' long as long as stay on this property. PR 7/9/01

INSPECTION COMMENTS: Septic tank set, OK to cover to prevent floating if it rains. PR 7/9/01  
7/10/01 OK TO CONTINUE WORK, NEXT 2 TRENCHES TO BE 10' CTC (7'ETE) TO  
SAVE REPAIR AREA (SRK) 7/11/01 OK TO COVER ALL WORK, WPI ON (SRK)  
3/12/02 fourth trench at 7.5' <sup>Bottom</sup>, D.B. installed (SO) 3/12/02 OK to  
cover trench, 18" stone (SO)

INSPECTOR Steven R. Krieg DATE SYSTEM APPROVED 7/11/01

