

# APPLICATION

PERCOLATION TESTING

A 56564J

P \_\_\_\_\_

HOWARD COUNTY HEALTH DEPARTMENT  
BUREAU OF ENVIRONMENTAL HEALTH  
3525-H ELLICOTT MILLS DRIVE/ELLICOTT CITY, MARYLAND 21043  
TELEPHONE: 313-2840

DISTRICT 5TH

DATE 4/17/96

TO: THE COUNTY HEALTH OFFICER  
ELLICOTT CITY, MARYLAND

I HEREBY APPLY FOR THE NECESSARY TEST PRIOR TO APPLICATION FOR PERMIT TO CONSTRUCT (OR RECONSTRUCT) A SEWAGE DISPOSAL SYSTEM.

PROPERTY OWNER C.M.C. CONSTRUCTION, INC.

ADDRESS \_\_\_\_\_ PHONE \_\_\_\_\_

AGENT OR PROSPECTIVE BUYER CHUCK SHARP

ADDRESS 3779 SHARP ROAD. PHONE 410-489-4630

PROPERTY LOCATION: Big Branch Overlook Big Branch Drive

SUBDIVISION ~~CONSTRUCTION~~ LOT NO. # 43

ROAD AND DESCRIPTION HOWARD ROAD 3000'± FROM INTERSECTION  
TRIADELPHIA ROAD (SOUTH)

TAX MAP 27 PARCEL # 19

SIZE OF LOT 3 AC. TYPE BLDG. SINGLE FAMILY DWELLING  
(SINGLE FAMILY DWELLING OR COMMERCIAL)

THE SYSTEM INSTALLED UNDER THIS APPLICATION IS ACCEPTABLE ONLY UNTIL PUBLIC FACILITIES BECOME AVAILABLE. I FULLY UNDERSTAND THE FEE CONNECTED WITH THE FILING OF THIS PERC TEST APPLICATION IS NON-REFUNDABLE UNDER ANY CIRCUMSTANCES. I ALSO AGREE TO COMPLY WITH ALL M.O.S.H.A. REQUIREMENTS IN TESTING THIS LOT.

Chuck Sharp  
(SIGNATURE OF APPLICANT)

APPROVED BY \_\_\_\_\_ FOR \_\_\_\_\_ DATE \_\_\_\_\_

DISAPPROVED BY \_\_\_\_\_ FOR \_\_\_\_\_ DATE \_\_\_\_\_

HOLD PENDING FURTHER TESTS \_\_\_\_\_

REASONS FOR REJECTION OR HOLDING \_\_\_\_\_

PERCOLATION TEST PLAT/PRELIMINARY PLAT - TITLE OR I.D. # \_\_\_\_\_ DATE \_\_\_\_\_

SITE DEVELOPMENT PLAN/FINAL PLAT - TITLE OR I.D. # \_\_\_\_\_ DATE \_\_\_\_\_

# THIS IS NOT A PERMIT

565 64J

← N

SHEET 1 of 2

COUNTY #

SOIL PROFILE

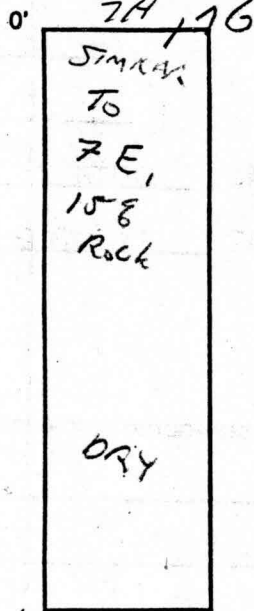

SOIL PROFILE

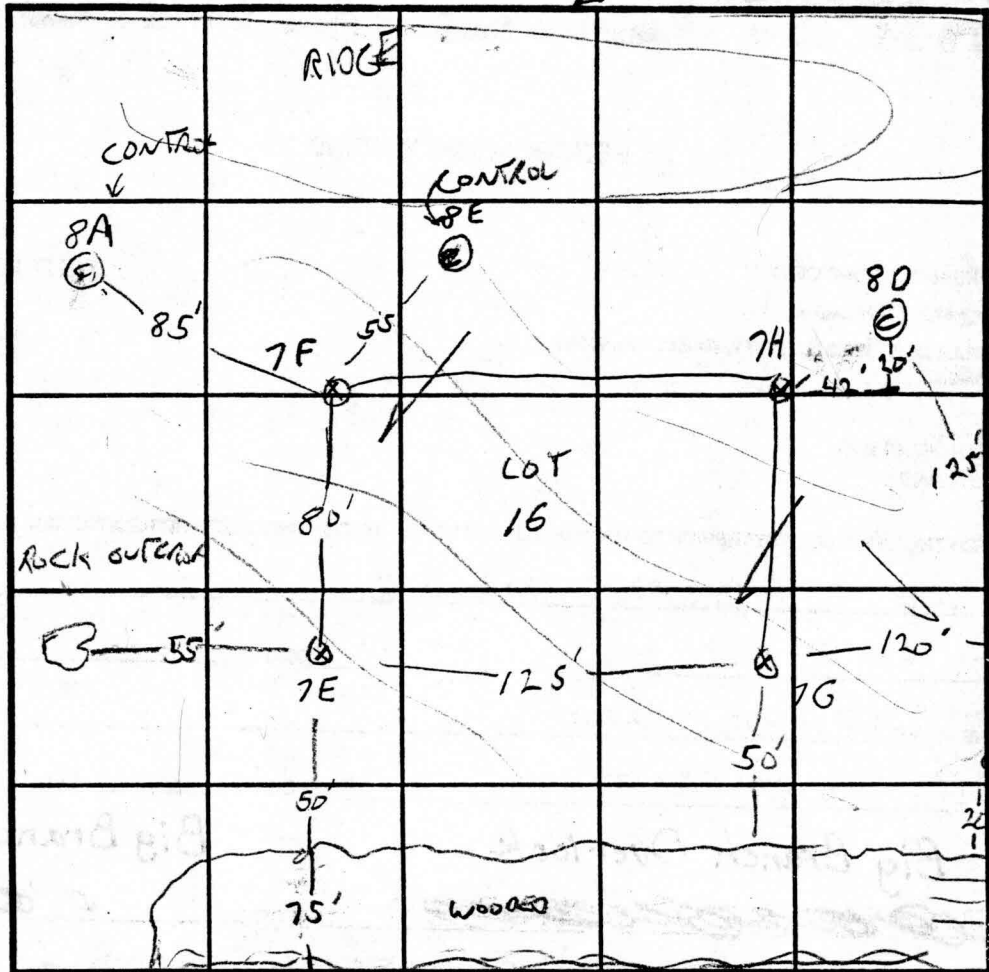
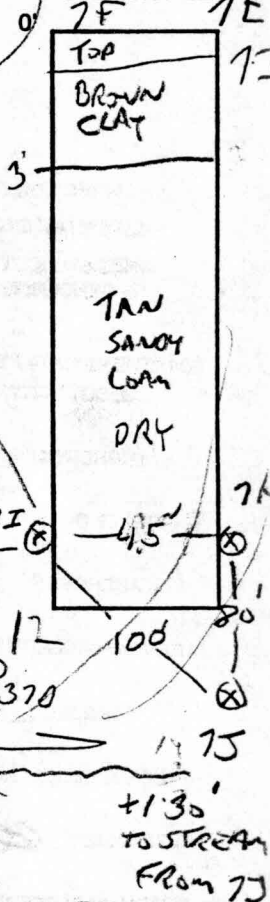

INDICATE NORTH - NAME ADJOINING ROADWAY AS BASE LINE.

FARM ROAD

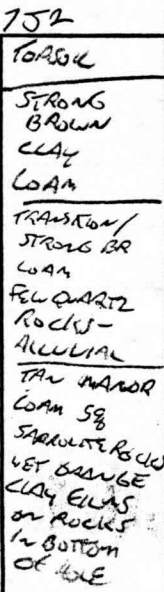
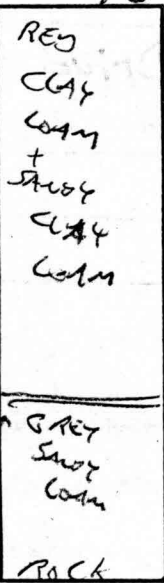

DATE	TEST NO.	DEPTH	PRE-WET		TEST - 1" DROP		TIME	
			START	STOP	START	STOP		
4/29/96	7E	3'6" / 12'	12:55	12:57	12:57	12:59	2 MIN	
	7F	4' / 12'	12:55	12:59	12:59	10:4	5 MIN	
	7H	3' / 12'	1:09	1:11	1:11	1:14	3 MIN	
	7G	4' / 12'	1:10	1:13	1:13	1:19	6 MIN	
	7I	4' / 12'	4:17	4:21	4:21	4:27	6 MIN	
	7J	VISUAL	- MARGINAL - WATER TABLE EVIDENCE					
	7K	VISUAL	- DRY					
3/7/97	370	11.5U	OK, DRY					
10/6/98	752	/ 13						

REMARKS WATCH FOR H<sub>2</sub>O IN 7J LOT 16 42 WATER

TYPE OF SOIL CONFIRMATION USES RILEY 75 476 752

TESTED BY G. SAVAGE ALSO PRESENT CHUCK SWARO

TRENCH DESIGN DATA: AVERAGE PERCOLATION TIME \_\_\_\_\_ TRENCH WIDTH \_\_\_\_\_

INLET DEPTH \_\_\_\_\_ MAXIMUM BOTTOM DEPTH \_\_\_\_\_ SO FT/REDROOM \_\_\_\_\_





TO: Greg Shepard  
FROM: Amy McMillen

Proposed adjustment looks  
O.K.

All

TOTAL P.02

