

APPLICATION

SEWAGE DISPOSAL TESTING

A 14945

P _____

MARYLAND STATE DEPARTMENT OF HEALTH

HOWARD COUNTY *Septic tank to be 1200 gallon* ELLICOTT CITY

*Dry well to be 100 sq. ft. of absorption sidewalk
and follow the inlet pipe pl. bedroom. Inlet pipe
to be 4 ft. below original grade. Max. depth of dry well to be
10 ft. below original grade. Locate dry well.*

DISTRICT 4

DATE 11/7/69

TO: THE COUNTY HEALTH OFFICER
ELLICOTT CITY, MARYLAND

I, HEREBY, APPLY FOR THE NECESSARY TESTS IN ORDER TO CONSTRUCT (OR RECONSTRUCT) A SEWAGE DISPOSAL SYSTEM.

PROPERTY OWNER Fred B. & Ann L. Abeles

ADDRESS Rt. 1, Woodbine, Maryland 21797 PHONE Mr. Podolak

848-2229

PROPERTY LOCATION:

SUBDIVISION Lisbon Meadows LOT NO. 3

ROAD AND DESCRIPTION Oland Drive

OCCUPANT _____ PHONE _____

PERSON TO CONSTRUCT SYSTEM _____

ADDRESS _____ PHONE _____

SIZE OF LOT 41,200 sq. ft. TYPE BLDG. 3 or 4

NUMBER OF BEDROOMS

IF NOT SINGLE RESIDENCE DESCRIBE _____

SIGNATURE OF APPLICANT /s/ Leon Podolak

APPROVED BY James T. Wright FOR Dry well DATE 4/21/71

(KIND OF SYSTEM)

REJECTED BY _____ FOR _____ DATE _____

(KIND OF SYSTEM)

HOLD PENDING FURTHER TESTS _____ DATE _____

REASONS FOR REJECTION OR HOLDING _____

THIS IS NOT A PERMIT

11/13/61
2/8

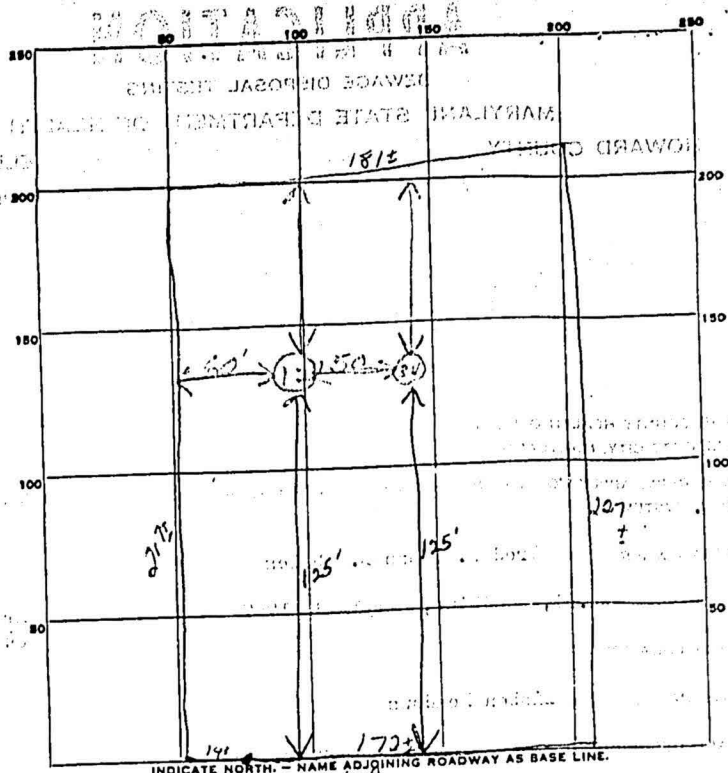

DATE	TEST NO.	DEPTH	PRE-WET		TEST - 1" DROP		TIME
			START	STOP	START	STOP	
11/13/61	1	10'	10 ²⁶	10 ³⁴	10 ³⁴	10 ⁴⁵	11 min
	2	4'	10 ²¹	10 ²²	10 ²²	10 ²⁴	2 min
	3	10'	10 ³⁵	10 ³⁸	10 ³⁸	10 ⁴²	4 min
	4	4'	10 ³⁰	10 ³¹	10 ³¹	10 ³³	2 min

5 min
4

SOIL AUGER FINDING _____

TESTED BY STW

REMARKS _____

PROPERTY OF U.S. ARMY CORP. OF ENGRS. 10/5