

# APPLICATION

A 14943

P \_\_\_\_\_

SEWAGE DISPOSAL TESTING

MARYLAND STATE DEPARTMENT OF HEALTH

HOWARD COUNTY *See the tank to be 1200 gall* ELLICOTT CITY

*Dry well to be 120 ft ft of depth and is identical to the area follow the inlet pipe per previous. Outlet pipe to be 6 ft below original grade. 11 pipe length of dry well to be 12 1/2 ft below original grade. Locate dry well*

DISTRICT 4

DATE 11/7/69

TO: THE COUNTY HEALTH OFFICER  
ELLICOTT CITY, MARYLAND

I, HEREBY, APPLY FOR THE NECESSARY TESTS IN ORDER TO CONSTRUCT (OR RECONSTRUCT) A SEWAGE DISPOSAL SYSTEM.

PROPERTY OWNER Fred B. & Ann L. Abeles

ADDRESS Rt. 1, Woodbine, Maryland 21797

Any questions call:  
Mr. Leon Podolak  
848-2229

PROPERTY LOCATION:

SUBDIVISION Lisbon Meadows

LOT NO. 1

ROAD AND DESCRIPTION Daisy Rd. off Rt. 144 - count 6 houses on right

next door to Lisbon Methodist Parsonage

Oland Drive

OCCUPANT \_\_\_\_\_

PHONE \_\_\_\_\_

PERSON TO CONSTRUCT SYSTEM \_\_\_\_\_

ADDRESS \_\_\_\_\_

PHONE \_\_\_\_\_

SIZE OF LOT 43,200 sq. ft.

TYPE BLDG. 3 or 4

NUMBER OF BEDROOMS

IF NOT SINGLE RESIDENCE DESCRIBE \_\_\_\_\_

SIGNATURE OF APPLICANT /s/ Leon Podolak

APPROVED BY [Signature] FOR Dir. Weiss DATE 4/21/71

REJECTED BY \_\_\_\_\_ FOR \_\_\_\_\_ DATE \_\_\_\_\_

HOLD PENDING FURTHER TESTS \_\_\_\_\_ DATE \_\_\_\_\_

REASONS FOR REJECTION OR HOLDING \_\_\_\_\_

## THIS IS NOT A PERMIT

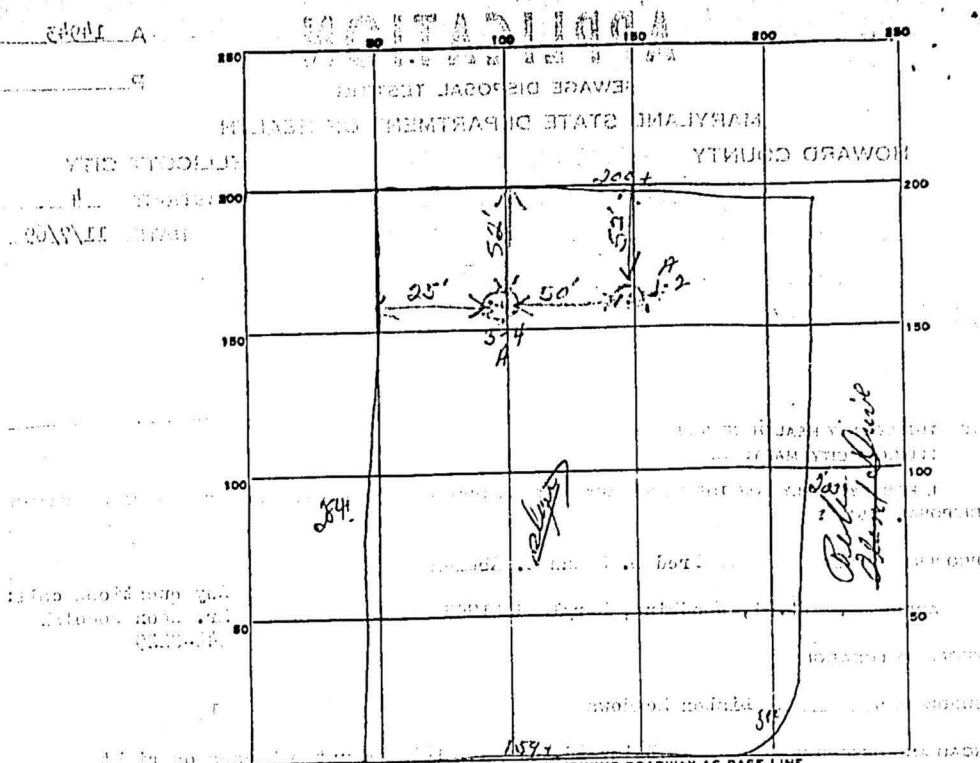

INDICATE NORTH - NAME ADJOINING ROADWAY AS BASE LINE.

*Daisy Road*

| DATE     | TEST NO. | DEPTH  | PRE-WET   |      | TEST - 1" DROP |      | TIME |
|----------|----------|--------|-----------|------|----------------|------|------|
|          |          |        | START     | STOP | START          | STOP |      |
| 11/13/69 | 1        | 9'     | 951       | 954  | 951            | 1000 | 5m   |
|          | 2        | 3 1/2' | 952       |      | 1000           |      |      |
|          | 3        | 0'     | 1000      | 1004 | 1004           | 1009 | 5m   |
|          | 4        | 3 1/2' | 959       |      |                |      |      |
|          | 1A       | 13'    | 245       | 248  | 248            | 253  | 5m   |
|          | 2A       | 6'     | 245       | 246  | 246            | 248  | 2m   |
|          | 3A       | 13'    | Same soil |      | ←              |      |      |
|          | 4A       | 6'     | 245       | 248  | 248            | 252  | 4m   |

7  
9  
4/16  
4 min  
609

SOIL AUGER FINDING *Water down to 13 ft*

TESTED BY *[Signature]*

REMARKS *TOM 21 2100*

