

8/28/01 layout 10:30-11  
8/29/01 Final Noon

ISSUE DATE: 7/26/2001

APPROVAL DATE: 9/20/01

# PERMIT INDEXED

P 515957-B

A 513199-0

## ON-SITE SEWAGE DISPOSAL SYSTEM HOWARD COUNTY HEALTH DEPARTMENT BUREAU OF ENVIRONMENTAL HEALTH

**03-333558**

Hatfield's Equipment IS PERMITTED TO INSTALL  ALTER

ADDRESS: 13785 Burntwoods Road, Glenelg, MD PHONE NUMBER: 301-854-6172

SUBDIVISION: Brantwood 2/2 LOT NUMBER: 13

ADDRESS: 3120 Argent Path PROPERTY OWNER: Williamsburg Group

SEPTIC TANK CAPACITY (GALLONS): ~~1250~~ 1520

PUMP CHAMBER CAPACITY (GALLONS): N/A

NUMBER OF BEDROOMS: ~~4~~ 5 w/ BP

SQUARE FEET PER BEDROOM: 180

LINEAR FEET OF TRENCH REQUIRED: 240

TRENCHES:	Trench to be 3.0 feet wide. Inlet 2.0 feet below original grade. Bottom maximum depth 4.0 feet below original grade. Effective area begins at 2.0 feet below original grade. 2.0 feet of stone below distribution pipe.
LOCATION:	Place the distribution box 145' down the right lot line and 60' off this same lot line. Run (5) 50' trenches on contour in either direction.
NOTES:	

PLANS APPROVED: MER 6/1/01 OK (BB) DATE: 5/31/01

- NOTE: PERMIT VOID AFTER 2 YEARS
- NOTE: CONTRACTOR RESPONSIBLE FOR SCHEDULING A PRE-CONSTRUCTION INSPECTION FOR ALL INSTALLATIONS
- NOTE: WATERTIGHT SEPTIC TANKS REQUIRED
- NOTE: ALL PARTS OF SEPTIC SYSTEM SHALL BE 100 FEET FROM ANY WATER WELL
- NOTE: MANHOLE RISERS REQUIRED ON ALL SEPTIC TANKS AND PUMP CHAMBERS

NEITHER THE HOWARD COUNTY COUNCIL NOR THE HEALTH DEPARTMENT IS RESPONSIBLE FOR THE SUCCESSFUL OPERATION OF ANY SYSTEM  
BUILDING PERMIT SIGNED PERMITTEE RESPONSIBLE FOR OBTAINING FINAL APPROVAL ON THIS PERMIT AND RETURNED CALL 410-313-2640 FOR INSPECTION OF SEPTIC SYSTEM

8-21-03 BOD 143836 - SUWDECK  
2-9-05 BOD 152194 - FINISH BASEMENT w/BDEM

P 010751-B

NOT TO SCALE

INDEXED

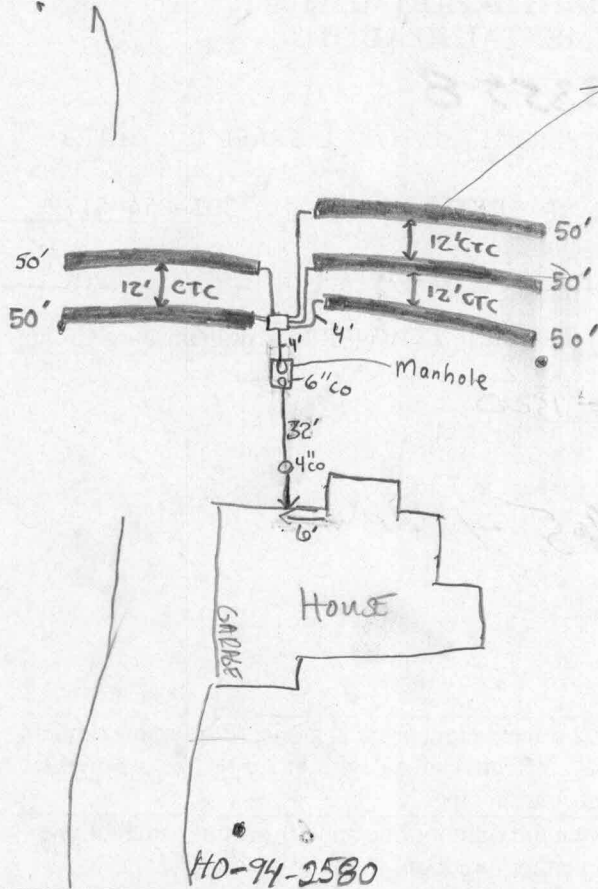

**TRENCH DATA**

TRENCH WIDTH 3'  
 TRENCH INLET DEPTH 2'  
 TRENCH BOTTOM DEPTH 4'  
 DEPTH OF STONE 2'  
 NUMBER OF TRENCHES 5  
 TOTAL TRENCH LENGTH 250'  
 ABSORBENT AREA 750ft<sup>2</sup>  
 DISTRIBUTION BOX LEVEL   
 BAFFLE IN DISTRIBUTION BOX

**SEPTIC TANK DATA**

SEPTIC TANK 1500 <sup>T.S.</sup> GALLONS  
 MANHOLE RISER on rear  
 6 INCH INSPECTION PORT on front

**PUMP CHAMBER DATA**

PUMP CHAMBER GALLONS NA  
 MANHOLE RISER NA  
 ALARM NA  
 PUMP PERFORMANCE TEST NA

ARGENT PATH

PRE-CONSTRUCTION INSPECTION: 8-28-01 LAYOUT PER PLAN (K6)

INSPECTION COMMENTS: 8/29/01- STAFFING DEMANDS DO NOT ALLOW FOR INSP., INSTALLER TO SUBMIT DRAWING, (INSTALLER REPUTABLE), OK TO COVER ALL WORK - (SRK)

9/20/01- DRAWING SUBMITTED BY CONTRACTOR, DRAWING TRANSFERRED TO ABOVE RECORD - (SRK)

BUILDING PERMIT SIGNED AND RETURNED

INSPECTOR Steven R. Krieg

DATE SYSTEM APPROVED 9/20/01